

O.D.O.T. DISTRICT 2 SURVEY OFFICE (USE ONLY)

PERSONNEL \_\_\_\_\_ REFERENCE NO. 15 A SHEET 17 OF 41

NOTES BALBAUGH DATE 4/28/2020 ROUTE SR 53

H.C. LEU WEATHER PTLY CLOUDY COUNTY SENECA

R.C. AUBLE TEMP. 55° TOWNSHIP SENECA

SECTION 22

DWG BY GARRETT PID 104747 T 1 N R 14 E

TYPE MONUMENT MONBOX W/ 1" IPIN

ON SURFACE - ~~BELOW~~ ON \_\_\_\_\_

LEFT - ☉ PAV'T - ~~RIGHT~~ 0.7'

- TO - EDGE PAVEMENT

S.L.M. 151+64.99

Grid: Northing: 497181.144 Easting: 1766418.810

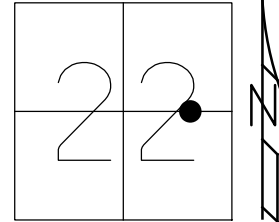

RECORD:  
 FD MAG/WASHER  
 REFA15  
 4/3/16, JFO  
 SET MAG/WASHER  
 NEWREFA15  
 9/5/17, JFO  
 FD MONBOX  
 W/1" IPIN  
 4/25/2020, JLL

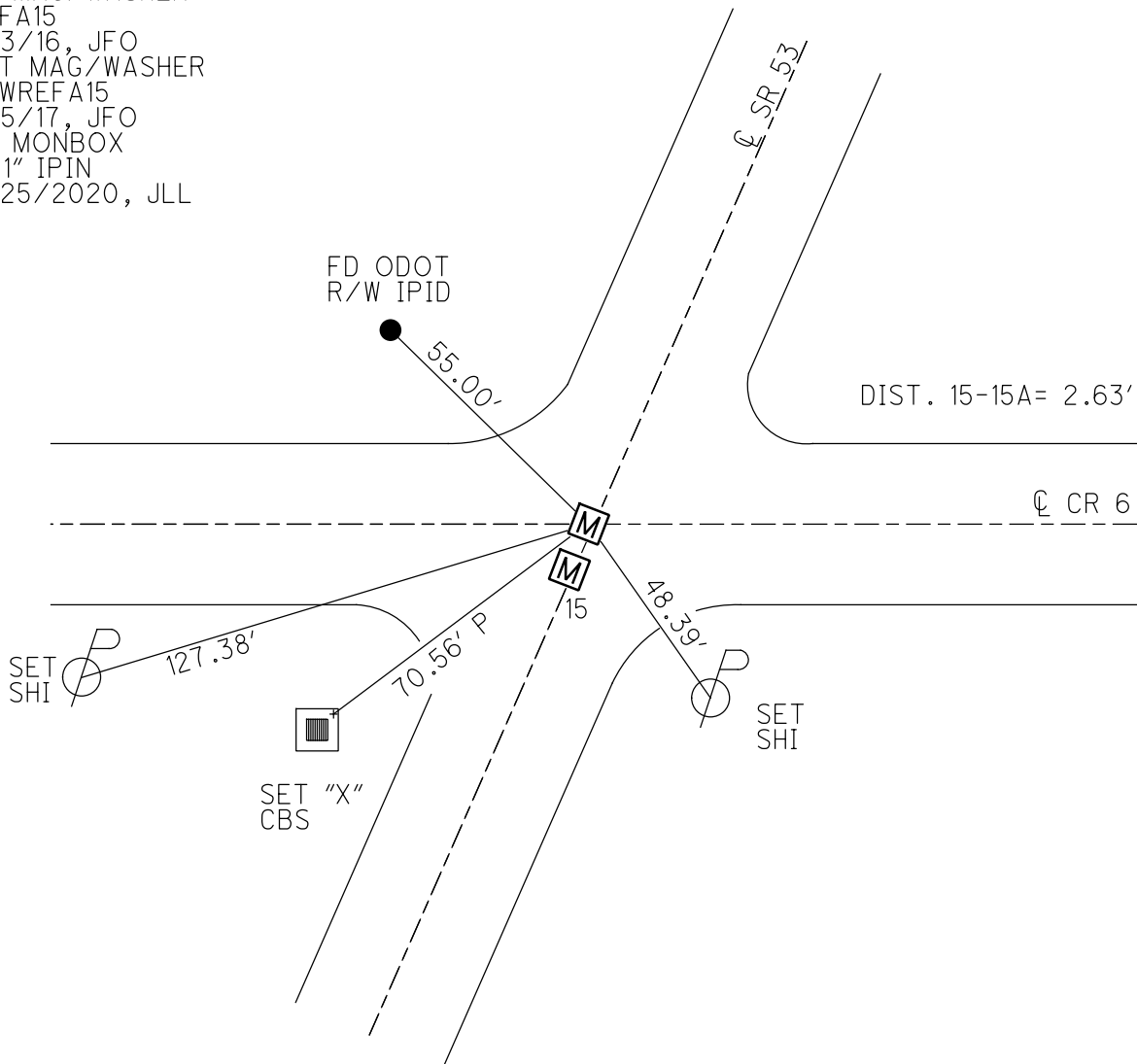

O.D.O.T. DISTRICT 2 SURVEY OFFICE (USE ONLY)

PERSONNEL \_\_\_\_\_ REFERENCE NO. 15 A SHEET 17 OF 41  
 NOTES RHOADES DATE 4/25/17 ROUTE SR 53  
 H.C. O'DONNELL WEATHER CLOUDY COUNTY SENECA  
 R.C. RHOADES TEMP. 58° TOWNSHIP SENECA  
 \_\_\_\_\_ SECTION 22  
 \_\_\_\_\_ T 1 N R 14 E

TYPE MONUMENT MAG NAIL  
 ON SURFACE - ~~BELOW~~ ON  
 LEFT - ☉ PAV'T - RIGHT ON  
9.2' TO LT EDGE PAVEMENT  
 S.L.M. 151+65.39

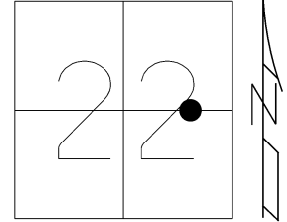

Grid: Northing: 497181.490 Easting: 1766419.019

RECORD:  
 POINT UNKNOWN  
 FD MAG/WASHER  
 REFA15  
 4/3/16, JFO  
 SET MAG/WASHER  
 NEWREFA15  
 9/5/17, JFO

