

O.D.O.T. DISTRICT 2 SURVEY OFFICE (USE ONLY)

PERSONNEL

REFERENCE NO. 34 B

SHEET 44 OF 47

NOTES ASTON

DATE 9/8/23

ROUTE SR 53

H.C. NIESE

WEATHER DRIZZLE

COUNTY SENECA

R.C. RHOADES

TEMP. 66°

TOWNSHIP HOPEWELL

SECTION 25

DWG BY RHOADES PID R/W

T 2 N R 14 E

TYPE MONUMENT MONBOX W/ 1" IPIN

ON SURFACE - ~~BELOW~~ ON

OFFSET Q PAVEMENT ON LT : RT
TO EDGE PAVEMENT

STATION: 442+77.34

HORZ.DATUM: NAD83(2011)

GEOID: NAVD88 2018

GRID: NORTHING: 524262.758

EASTING: 1776882.645

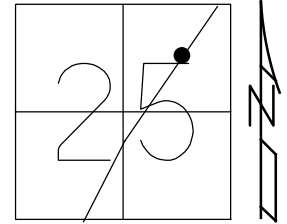

RECORD:
 FD MONBOX
 W/ 1" IPIN
 NEWREFB34
 7/21/21, DSA
 FD MONBOX
 W/1" IPIN
 REFB34
 9/8/23, TDN

SENECA LPD:
 N: 292951.725
 E: 151550.853

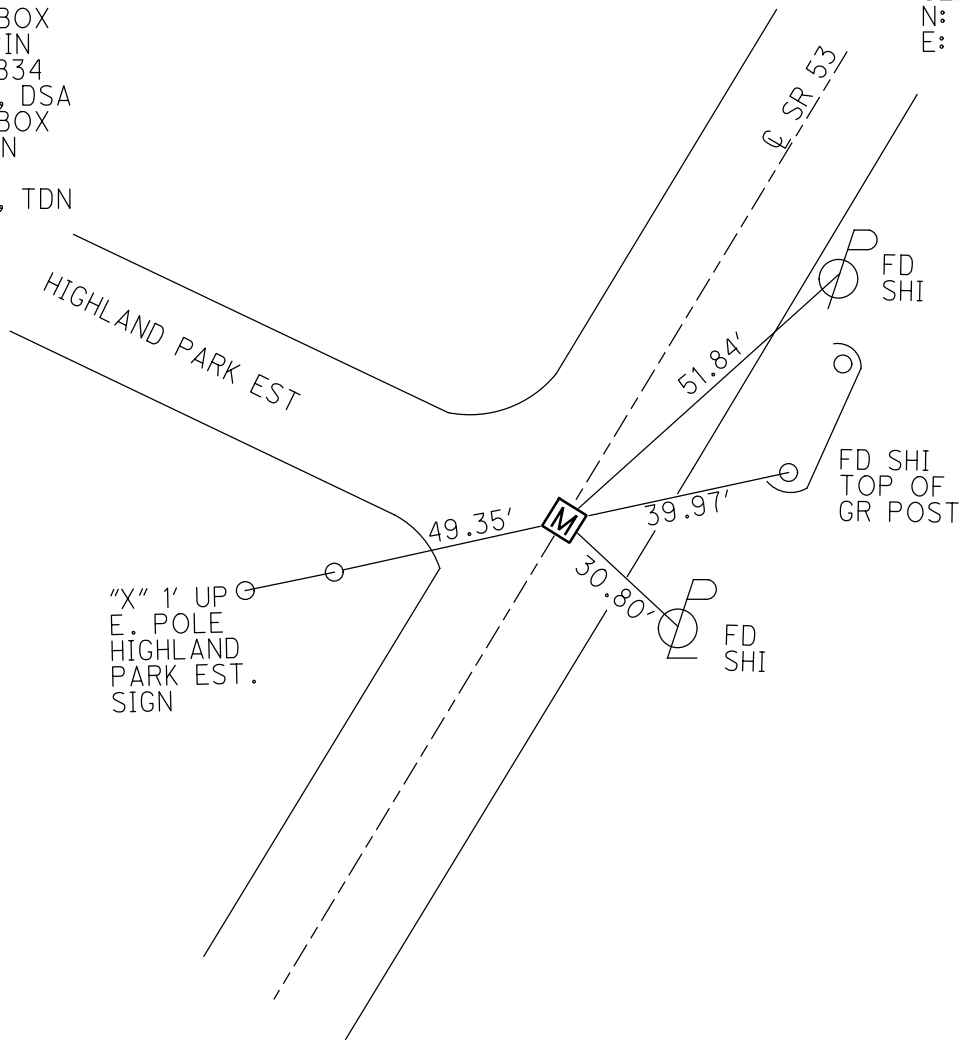

O.D.O.T. DISTRICT 2 SURVEY OFFICE (USE ONLY)

PERSONNEL _____ REFERENCE NO. 34 B SHEET 42 OF 47
 NOTES NIESE DATE 7/21/21 ROUTE SR 53
 H.C. AUBLE WEATHER CLOUDY COUNTY SENECA
 R.C. NIESE TEMP. 68° TOWNSHIP HOPEWELL
 DWG BY WHITAKER PID 95778 SECTION 25
 T 2 N R 14 E

TYPE MONUMENT MONBOX W/ 1" IPIN
 ON SURFACE - ~~BELOW~~ ON
 OFFSET Q PAVEMENT ON LT : RT
_____ TO _____ EDGE PAVEMENT
 STATION: 442+77.34

HORZ.DATUM: NAD83(2011) GEOID: 2012A
 GRID: NORTHING: 524262.758 EASTING: 1776882.645

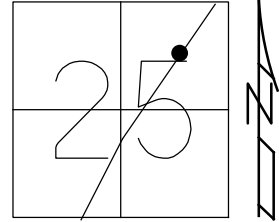

RECORD:
 FD MONBOX
 W/ 1" IPIN
 NEWREFB34
 7/21/21, DSA

