

O.D.O.T. DISTRICT 2 SURVEY OFFICE (USE ONLY)

PERSONNEL _____ REFERENCE NO. 72 SHEET 22 OF 26
 NOTES MOSE DATE 6/14/11 ROUTE SR 53
 H.C. LUMBREZER WEATHER CLOUDY COUNTY SENECA
 R.C. HARBAUGH TEMP. 70° TOWNSHIP PLEASANT
 _____ SECTION 7
 _____ T 3 N R 15 E

TYPE MONUMENT MAG NAIL
~~ON SURFACE~~ - BELOW 3"
 LEFT - Q PAV'T - RIGHT ON
12.0' TO RT EDGE PAVEMENT
 S.L.M. 950+52.74

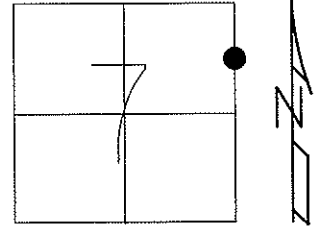

Grid: Northing: 573063.1199 Easting: 1784758.3234

FD MAG NAIL
 DNF MON. BOX.
 RR. GRADE HAS
 BEEN REDONE
 RECENTLY.

GPS, SV118
 6/1/10, KPM

GPS, FIN118
 10/4/11, RJL

SET "+" ON
 S.E. BOLT OF
 R.R. X-ING GATE

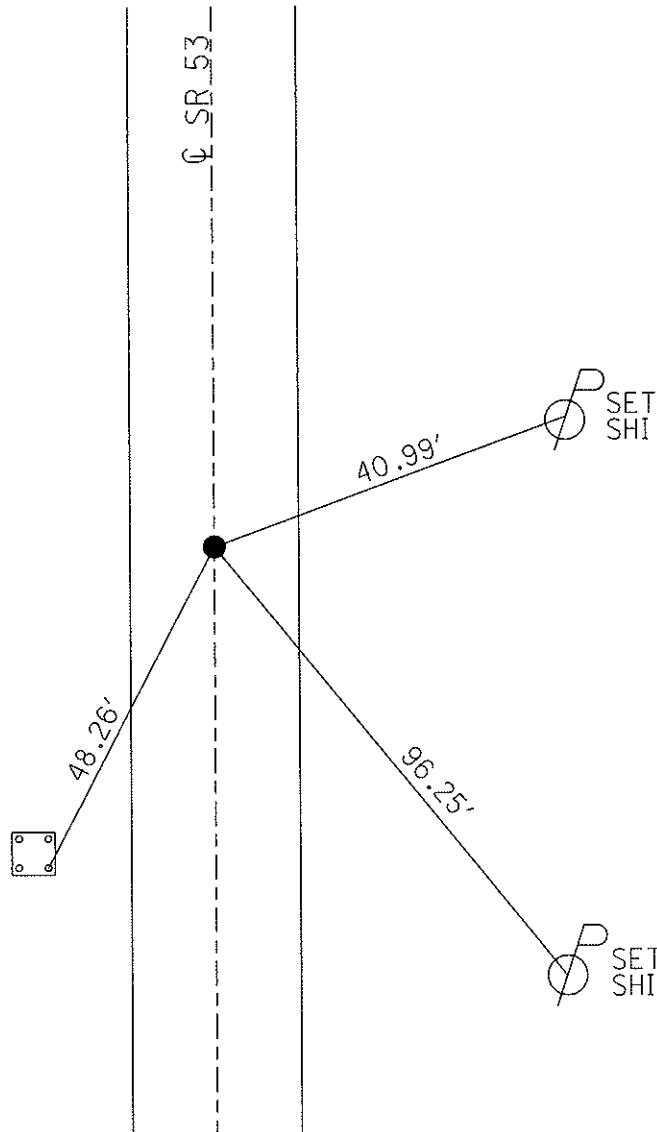

PERSONNEL	TITLE	PERSONNEL	TITLE	COUNTY	DATE
Schneider				Seneca	3-17-77
Mosser				S. R. 53	WEATHER Cloudy
Barbour				SEC. 7 & 8	TEMP. 55°
DESCRIPTION				Tiffin to Squidusky Co. Line	JOB NO.
LEFT		CENTER LINE		RIGHT	

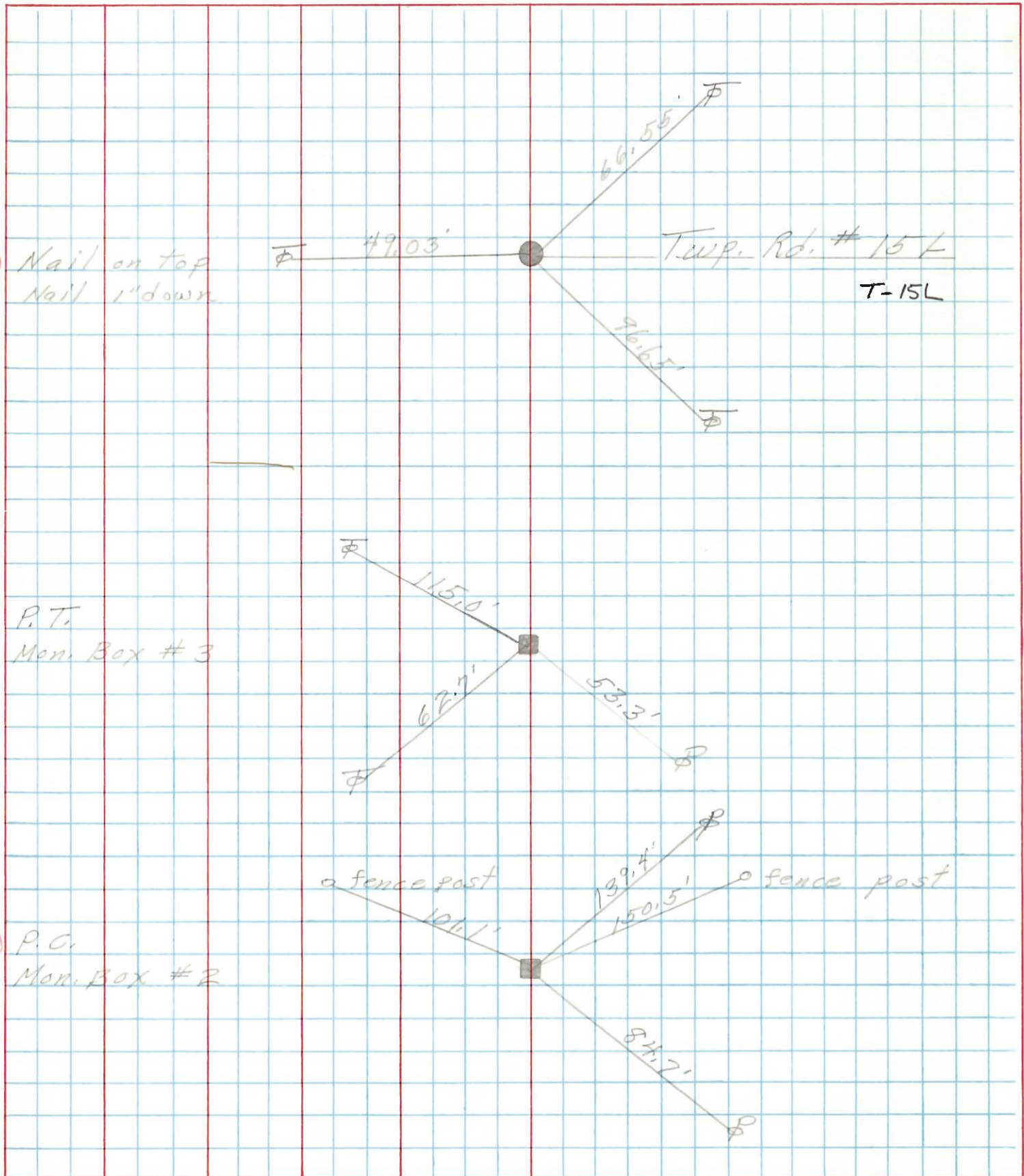

PERSONNEL	TITLE	PERSONNEL	TITLE	COUNTY	DATE
Schneider				Seneca	10-1-69
Mosser				S. R.	53
Barbour				WEATHER	Fair
Potts				SEC.	Tiffin to Seneca Line
DESCRIPTION				TEMP.	75°
Ties for Control Points				JOB NO.	
LEFT		CENTER LINE		RIGHT	

