

O.D.O.T. DISTRICT 2 SURVEY OFFICE (USE ONLY)

PERSONNEL _____ REFERENCE NO. 7 SHEET 8 OF 11

NOTES	<u>RHOADES</u>	DATE	<u>4/3/15</u>	ROUTE	<u>SR 67</u>
H.C.	<u>O'DONNELL</u>	WEATHER	<u>CLOUDY</u>	COUNTY	<u>SENECA</u>
R.C.	<u>LEU</u>	TEMP.	<u>59°</u>	TOWNSHIP	<u>EDEN</u>
				SECTION	<u>27</u>
				T	<u>1</u> N
				R	<u>15</u> E

TYPE MONUMENT P.K./WASHER
 ON SURFACE - ~~BELOW~~ ON _____
 LEFT - ☉ PAV'T - ~~RIGHT~~ 0.5'
9.0' TO LT EDGE PAVEMENT
 S.L.M. 111+05.83

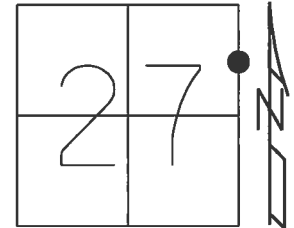

Grid: Northing: 492876.858 Easting: 1799436.293

RECORD:
 ORIGIN UNKNOWN
 FD P.K./WASHER
 5/3/94, CL
 SET P.K./WASHER
 9/26/94, CL
 FD P.K./WASHER
 GPS, REF7
 2/19/14, TMR
 SET MAG/WASHER
 GPS, NEWREF7
 7/13/15, JFO

FD "+" IN CONC.
 RIM M.H.

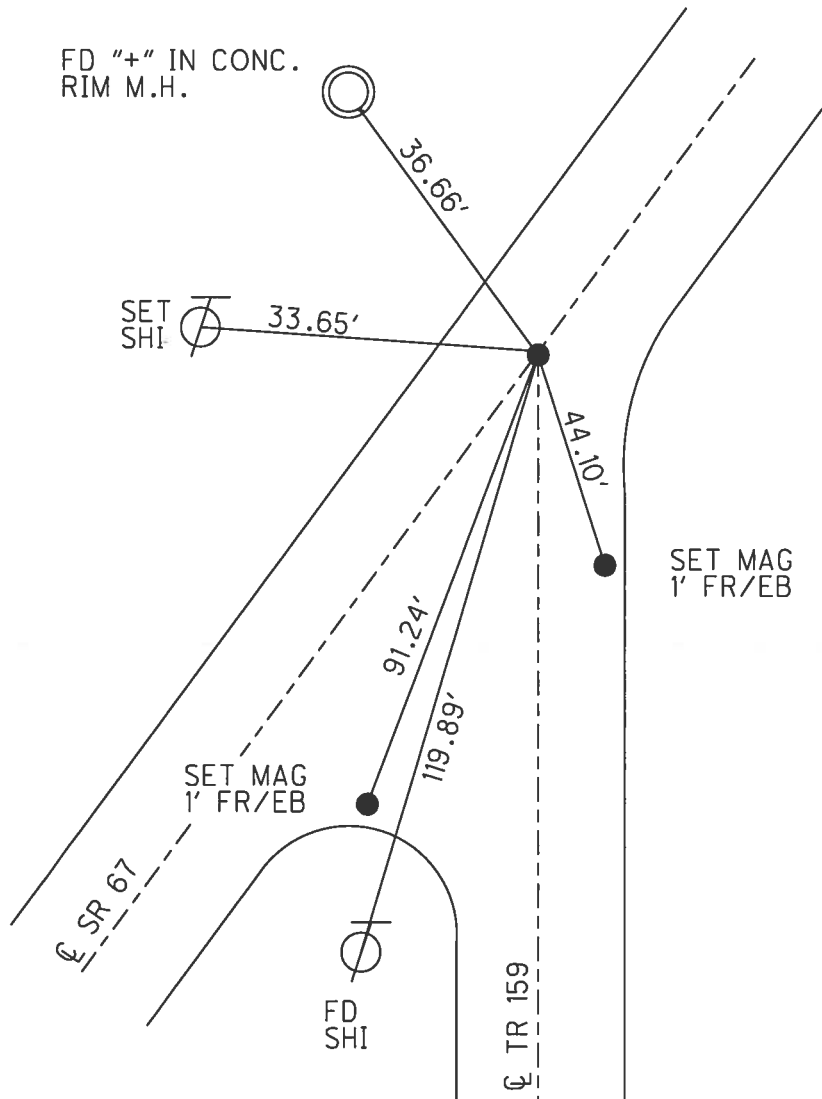

O.D.O.T. DISTRICT 2 SURVEY OFFICE

PERSONNEL _____

REFERENCE NO. 7

SHEET 4 OF 7

NOTES LOHRKE

H.C. RIPLLE

R.C. BARBOUR

GEYMAN

DATE 5-3-94

WEATHER _____

TEMP. _____

ROUTE S.R. 67

COUNTY Seneca

TOWNSHIP Eden

SECTION 27

T 1 N R 15 E

Reset 9-26-94

TYPE MONUMENT P.K. / WASHER

ON SURFACE - BELOW Yes

LEFT- & PAV'T. - ~~RIGHT~~ 0.5' Lt

9.0 TO Lt EDGE PAVEMENT

S.L.M. 111706

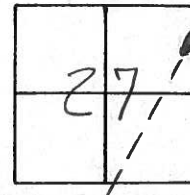

ORIGIN UNK.
MAY OR MAY NOT BE
ON SECTION LINE

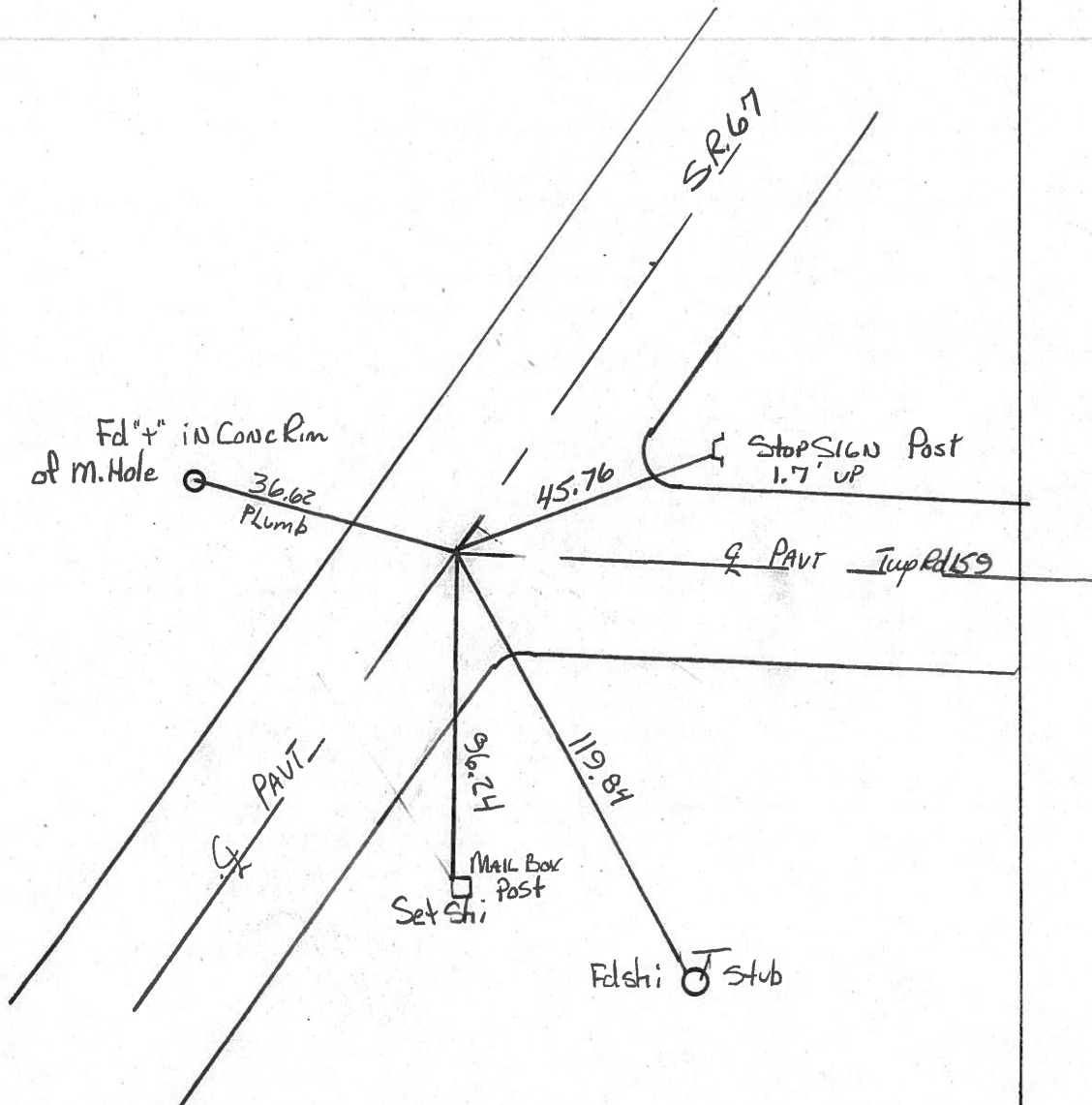

County Seneca S.R. #67

Date 6/08/82

Township Eden

Weather Sunny

Section # 27

Temp. 78°

T1N, R15E

Personnel Cronin

Ripple

Geyman

Mosser

Barbour

#7

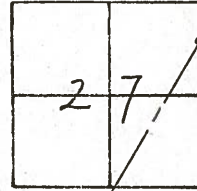

+ in Conc. rim
of M.H.

36.61
Plumb

P.K. 2" below surface

Origin unknown - Reset

P.K. & Washer - May or may not
be on Section line

119.79

95.74

Tap. Rd. # 159

S.R. #67

County Seneca S.R. 67

Date 6-13-79

Township Eden

Weather Fair

Section 27 & 26

Temp. 75°

T₁N, R₁₅E

Personnel Schneider

Mosser

Barbour

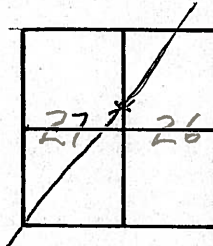

⑦



Q S.R. # 67

"+" in conc-rim

M.H.



36.59'

Found P. K. Nail

1' down

95.74'

119.76'

Co. Rd. #

159

Nail in
Mail Box Post