

O.D.O.T. DISTRICT 2 SURVEY OFFICE (USE ONLY)

PERSONNEL	REFERENCE NO. <u>21</u>	SHEET <u>28</u> OF <u>46</u>
NOTES <u>RHOADES</u>	DATE <u>7/12/21</u>	ROUTE <u>SR 100</u>
H.C. <u>AUBLE</u>	WEATHER <u>CLOUDY</u>	COUNTY <u>SENECA</u>
R.C. <u>NIESE</u>	TEMP. <u>72°</u>	TOWNSHIP <u>EDEN</u>
		SECTION <u>4</u>
DWG BY <u>WHITAKER</u>	PID <u>95778</u>	T <u>1</u> N R <u>15</u> E

TYPE MONUMENT MAG/WASHER
 ON SURFACE - ~~BELOW~~ ON
 OFFSET \odot PAVEMENT 11.2' LT : ~~RT~~
0.2' TO LT EDGE PAVEMENT 7.5' E. OF TR 151
 STATION: 353+17

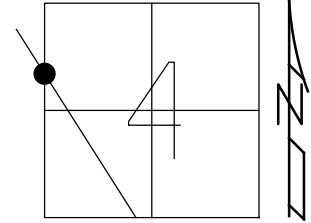

HORZ. DATUM: NAD83(2011) GEOID: 2012A
 GRID: NORTHING: 514520.656 EASTING: 1789050.155

RECORD:
 FD P.K./WASHER
 7/26/00
 SET P.K./WASHER
 10-18-00, MRC
 FD P.K./WASHER
 REF21
 1-24-19
 8-19-19, JFO
 SET MAG/WASHER
 NEWREF21
 11/23/21, DSA

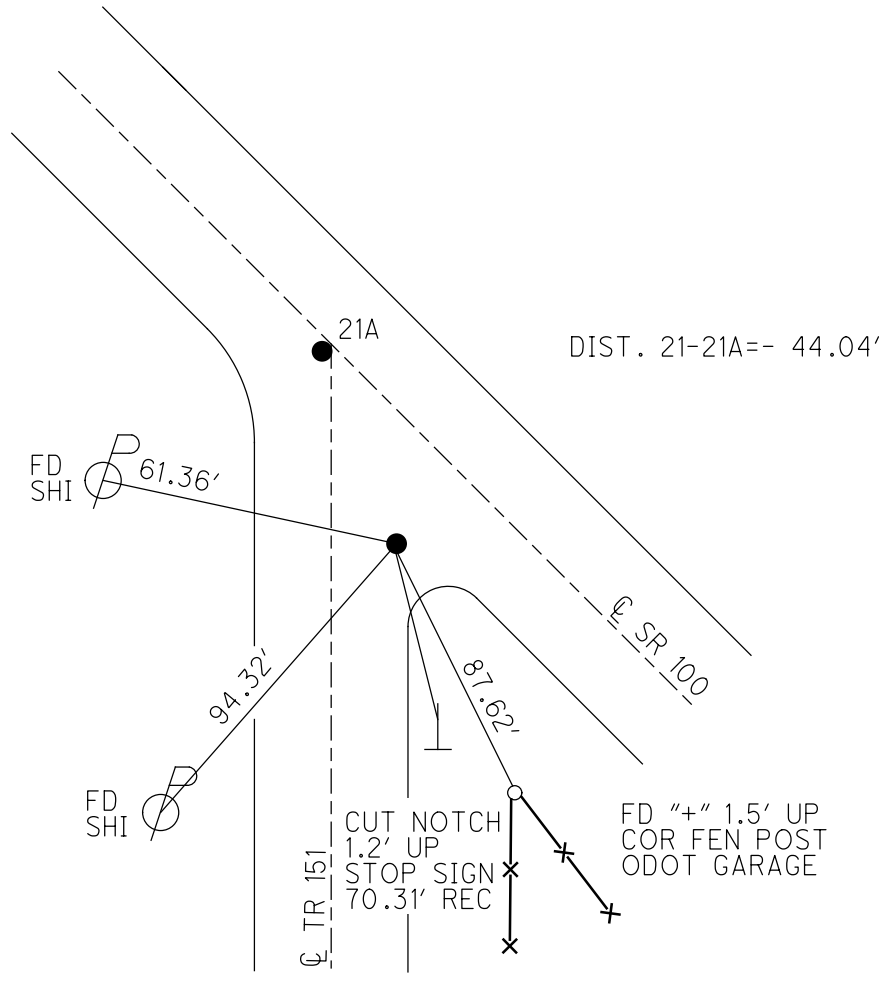

O.D.O.T. DISTRICT 2 SURVEY OFFICE (USE ONLY)

PERSONNEL _____ REFERENCE NO. 21 SHEET 28 OF 38
 NOTES CANTERBURY DATE 7-26-00 ROUTE SR 100
 H.C. MOSER WEATHER CLOUDY COUNTY SENECA
 R.C. CANTERBURY TEMP. 80° TOWNSHIP EDEN
 DWG BY NIESE PID 107060 SECTION 4
 T 1 N R 15 E

TYPE MONUMENT LG R.R. SPIKE
~~ON SURFACE~~ - BELOW 1 1/2"
 OFFSET Q PAVEMENT 11.2' LT : ~~RT~~
0.2' TO LT EDGE PAVEMENT 7.5' E. OF TR 151
 STATION: 353+17

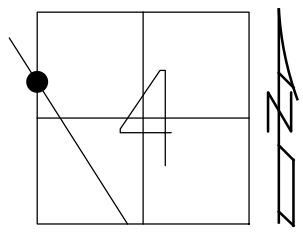

HORZ. DATUM: NAD83(2011) GEOID: 2012A
 GRID: NORTHING: 514520.656 EASTING: 1789050.155

RECORD:
 FD P.K./WASHER
 7/26/00
 SET P.K./WASHER
 10-18-00, MRC
 FD P.K./WASHER
 REF21
 1-24-19
 8-19-19, JFO

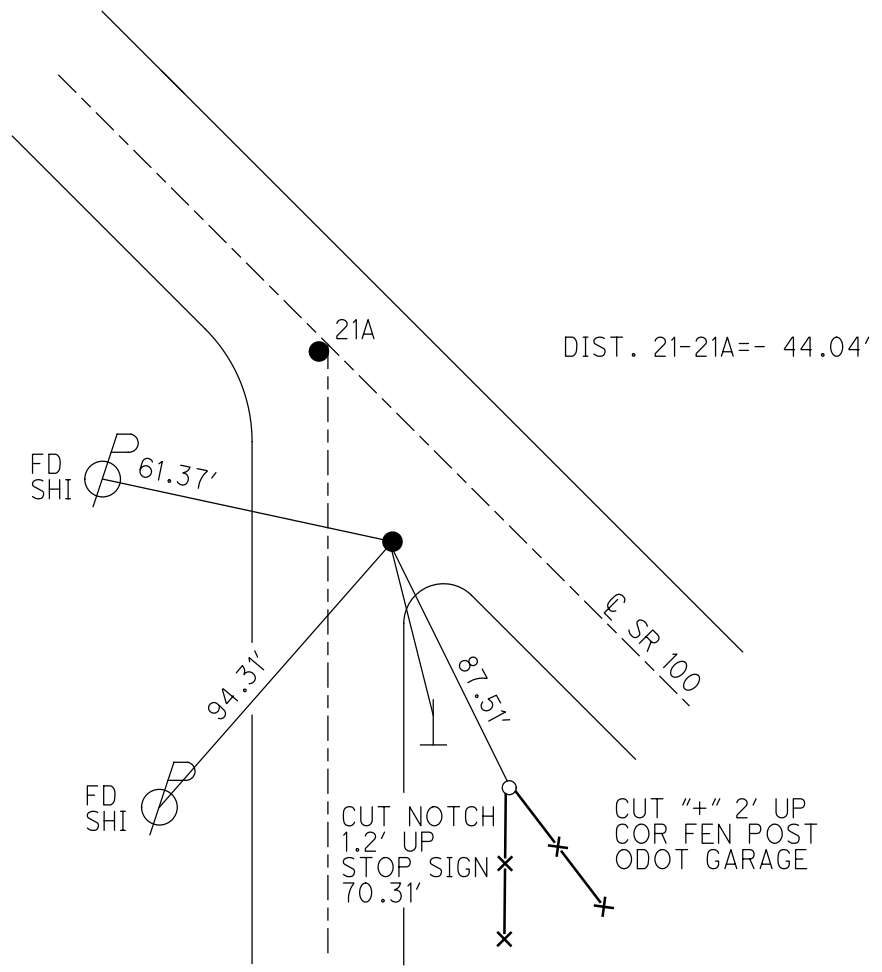

O.D.O.T. DISTRICT 2 SURVEY OFFICE

PERSONNEL _____ REFERENCE NO. 21 SHEET 29 OF 31
 NOTES CANTERBURY
 H.C. MOSEK DATE 7-26-00 ROUTE #100
 R.C. CANTERBURY WEATHER OVERCAST COUNTY SENECA
 _____ TEMP. +80° TOWNSHIP EDEN
 _____ SECTION 4
 _____ T L N R 15 E

PT. "A"	PT. "B"
TYPE MONUMENT <u>P.R. & WASHER</u>	<u>LG R.R. SPR.</u>
ON SURFACE - BELOW <u>SURFACE</u>	<u>1 1/2' DOWN</u>
LEFT- & PAV'T. - RIGHT <u>1 LT &</u>	<u>11.2 LT &</u>
<u>PT "A" 11.7 TO RT EDGE PAVEMENT</u>	<u>PT B = 0.2 LT OF LT EOP</u>
<u>S.L.M. PT A = 353 + 75</u>	<u>PT B = 353 + 17</u>

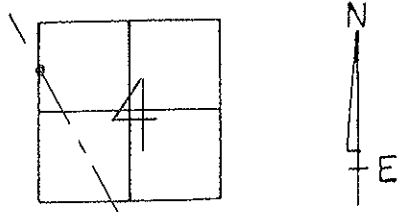

RESET P.R. + WASHER
 10-18-00
 M.R.C.
 NOTE: PT. "B" IS 7.5' E. OF TWP RD #151

