

O.D.O.T. DISTRICT 2 SURVEY OFFICE (USE ONLY)

PERSONNEL _____ REFERENCE NO. 29 SHEET 37 OF 46
 NOTES RHOADES DATE 7/9/21 ROUTE SR 100
 H.C. AUBLE WEATHER CLOUDY COUNTY SENECA
 R.C. NIESE TEMP. 69° TOWNSHIP CLINTON
 _____ SECTION 29
 DWG BY WHITAKER PID 95778 T 2 N R 15 E

TYPE MONUMENT MONBOX W/ 1" IPIN
 ON SURFACE - BELOW ON
 OFFSET \odot PAVEMENT ON LT : RT
-- TO -- EDGE PAVEMENT
 STATION: 440+35

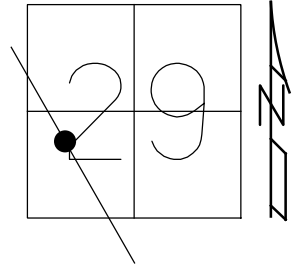

HORZ.DATUM: NAD83(2011) GEOID: 2012A
 GRID: NORTHING: 522187.329 EASTING: 1785180.176

RECORD:
 DGL ENGR. TIES
 12/14/18
 FD P.K. NAIL
 4" DOWN
 REF29
 2-14-19
 8-14-19, JFO
 FD MONBOX
 W/ 1" IPIN
 NEWREF29
 11/18/21, DSA

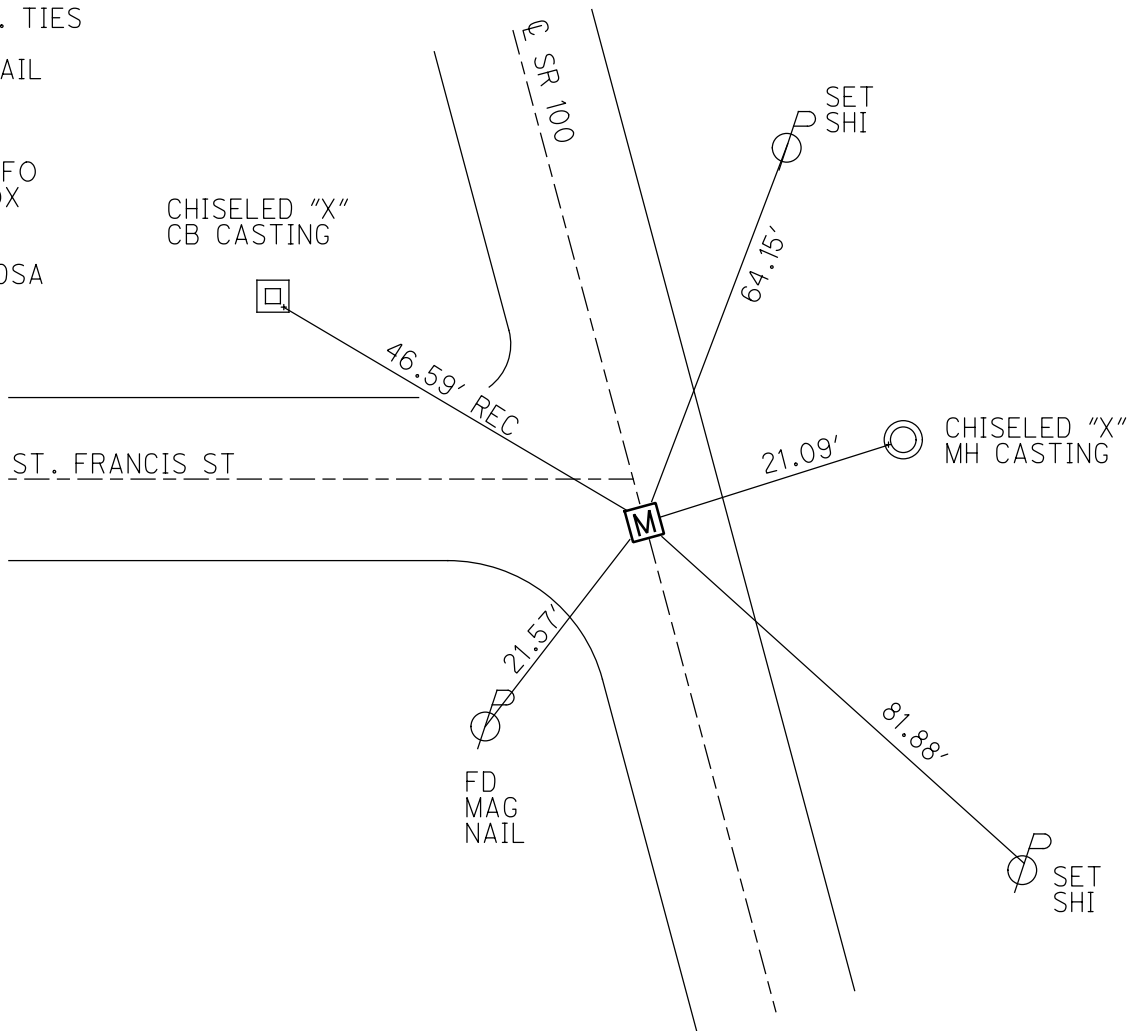

O.D.O.T. DISTRICT 2 SURVEY OFFICE (USE ONLY)

PERSONNEL _____ REFERENCE NO. 29 SHEET 38 OF 38
 NOTES SEA DATE 12-14-18 ROUTE SR 100
 H.C. SEA WEATHER CLOUDY COUNTY SENECA
 R.C. LL TEMP. 45° TOWNSHIP CLINTON
 _____ SECTION 29
 DWG BY NIESE PID 107060 T 2 N R 15 E

TYPE MONUMENT R.R. SPIKE
 ON SURFACE - BELOW --
 OFFSET C PAVEMENT -- LT : RT
-- TO -- EDGE PAVEMENT

STATION: 440+30.82

HORIZ.DATUM: NAD83(2011) GEOID: 2012A

GRID: NORTHING: 522187.329 EASTING: 1785180.176

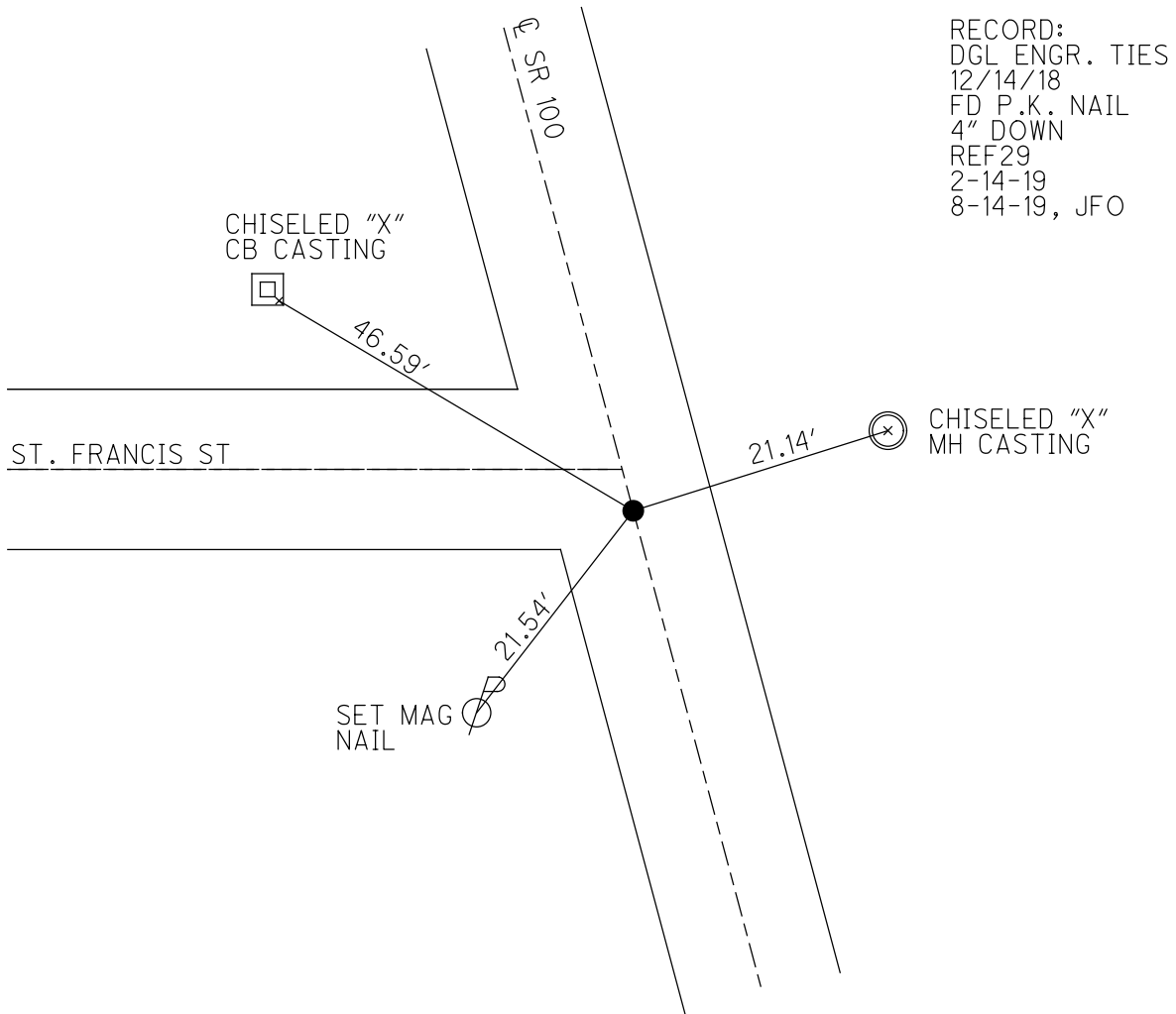
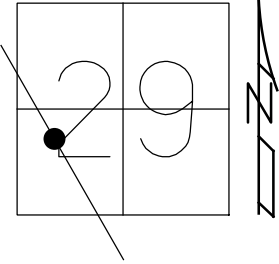

RECORD:
 DGL ENGR. TIES
 12/14/18
 FD P.K. NAIL
 4" DOWN
 REF 29
 2-14-19
 8-14-19, JFO



DGL CONSULTING ENGINEERS, LLC
 3455 BRIARFIELD BLVD, SUITE E
 MAUMEE, OHIO 43537
 419.535.1015

3 POINT REFERENCE TIES

DGL PROJECT NO 18067 ODOT PID 95778

SHEET NO 2 OF 11

CREW TITLE

COUNTY SENECA DATE 12/14/2018

SEA

S.R. STATE ROUTE 100 WEATHER CLOUDY

LL

TOWNSHIP CITY OF TIFFIN TEMP 45°

SECTION TOWN RANGE

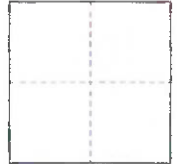

MONUMENT TYPE RAILROAD SPIKE FND

S.L.M. 440+30.82

DGL SURVEY POINT NO MN100 NORTHING 522187.292 EASTING 1785180.139

29

