

O.D.O.T. DISTRICT 2 SURVEY OFFICE (USE ONLY)

PERSONNEL

REFERENCE NO. 33

SHEET 9 OF 46

NOTES RIPPLE

DATE 8/27/90

ROUTE SR 101

H.C. BARBOUR

WEATHER SUNNY

COUNTY SENECA

R.C. GEYMAN

TEMP. 82°

TOWNSHIP PLEASENT

SECTION 25

DWG BY MAHLER PID 100787

T 3 N R 15 E

TYPE MONUMENT P.K./WASHER

ON SURFACE - ~~BELOW~~ ON

OFFSET  $\varnothing$  PAVEMENT ON LT : RT

- TO - EDGE PAVEMENT

STATION: 408+10±

HORZ. DATUM: - GEOID: -

GRID: NORTHING: - EASTING: -

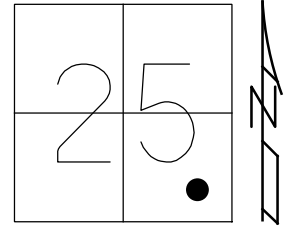

RECORD: P.O.T.  
 STA. 410+04.86  
 FD P.K./WASHER  
 ATOP P.K.NAIL  
 8/27/90, BARBOUR  
 D.N.F.  
 7/14/09, DCH  
 6/14/16, JFO

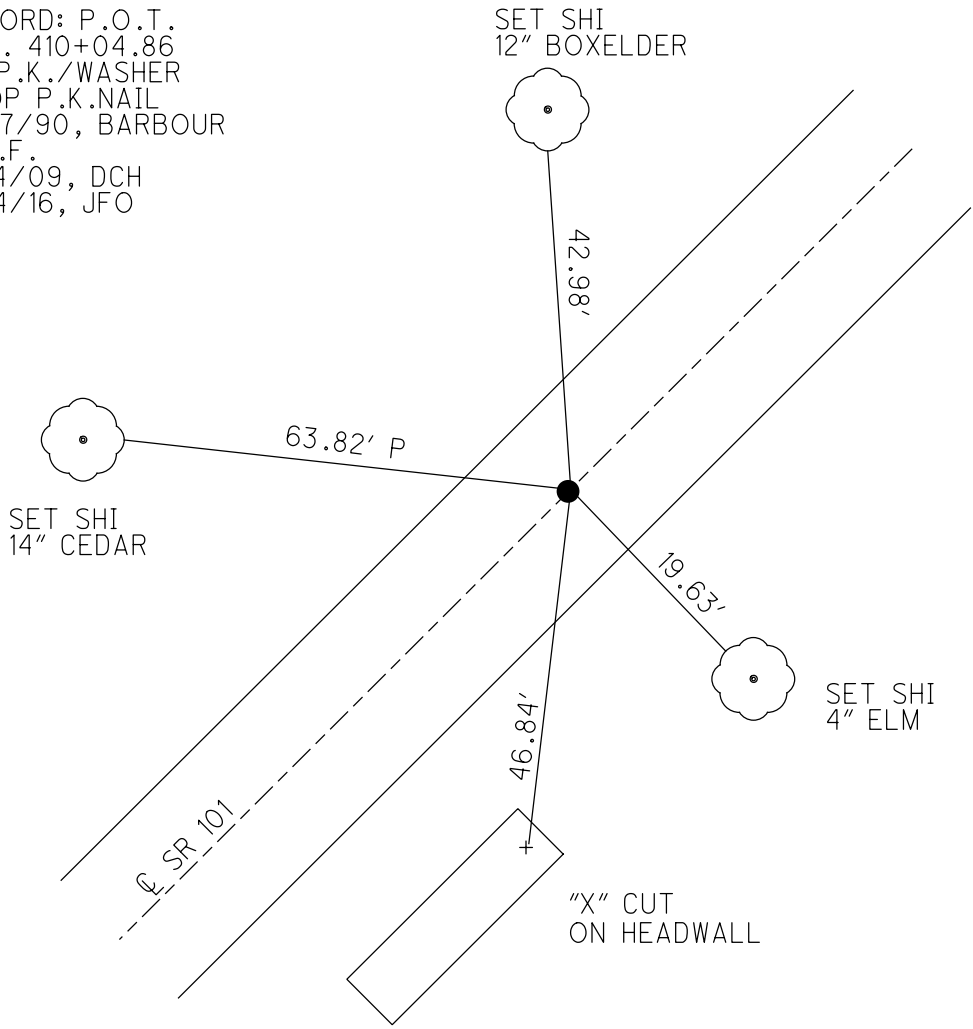

SET SHI  
12" BOXELDER

SET SHI  
14" CEDAR

SET SHI  
4" ELM

"X" CUT  
ON HEADWALL

O.D.O.T. DISTRICT 2 SURVEY OFFICE (USE ONLY)

PERSONNEL \_\_\_\_\_ REFERENCE NO. 33 SHEET 9 OF 46  
 NOTES HOMAN DATE 7/14/09 ROUTE SR 101  
 H.C. HOMAN WEATHER SUNNY COUNTY SENECA  
 R.C. ROUSOS TEMP. 80° TOWNSHIP PLEASANT  
 \_\_\_\_\_ SECTION 25  
 \_\_\_\_\_ T 3 N R 15 E

TYPE MONUMENT P.K./WASHER  
 ON SURFACE - ~~BELOW~~ ON  
 LEFT - ☉ PAV'T - RIGHT ON  
- TO - EDGE PAVEMENT  
 S.L.M. 408+10 ±  
 GRID: NORTHING: - EASTING: -

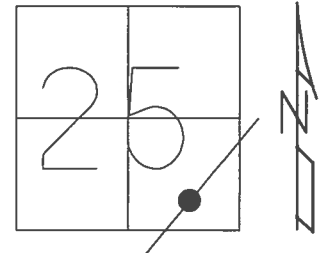

RECORD: P.O.T.  
 STA. 410+04.86  
 FD P.K.NAIL  
 SET P.K./WASHER  
 8/27/90  
 D.N.F.  
 7/14/09, DCH  
 6/14/16, JFO

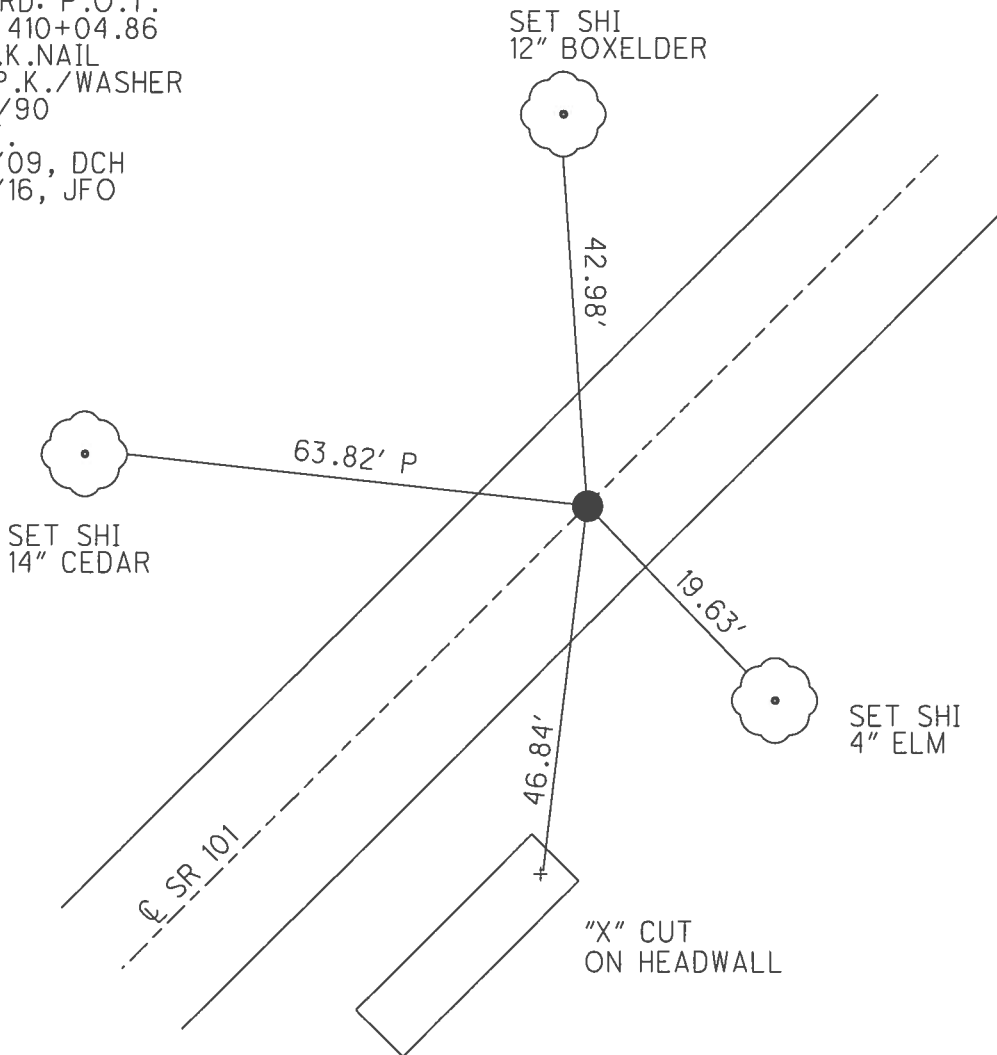

O.D.O.T. DISTRICT 2 SURVEY OFFICE (USE ONLY)

PERSONNEL \_\_\_\_\_ REFERENCE NO. 33 SHEET 9 OF 46  
 NOTES HOMAN DATE 7/14/09 ROUTE SR 101  
 H.C. HOMAN WEATHER SUNNY COUNTY SENECA  
 R.C. ROUSOS TEMP. 80° TOWNSHIP PLEASANT  
 \_\_\_\_\_ SECTION 25  
 \_\_\_\_\_ T 3 N R 15 E

TYPE MONUMENT \_\_\_\_\_ P.K./WASHER  
 ON SURFACE - ~~BELOW~~ \_\_\_\_\_ ON \_\_\_\_\_  
 LEFT - ☉ PAV'T - RIGHT \_\_\_\_\_ ON \_\_\_\_\_  
 \_\_\_\_\_ TO \_\_\_\_\_ EDGE PAVEMENT  
 S.L.M. 408+10 ±

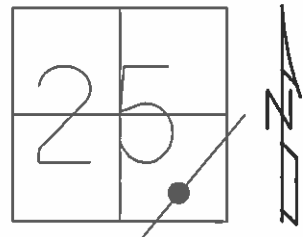

RECORD: P.O.T.  
 STA. 410+04.86  
 FD P.K.NAIL  
 SET P.K./WASHER  
 8/27/90  
 D.N.F.  
 7/14/09, DCH

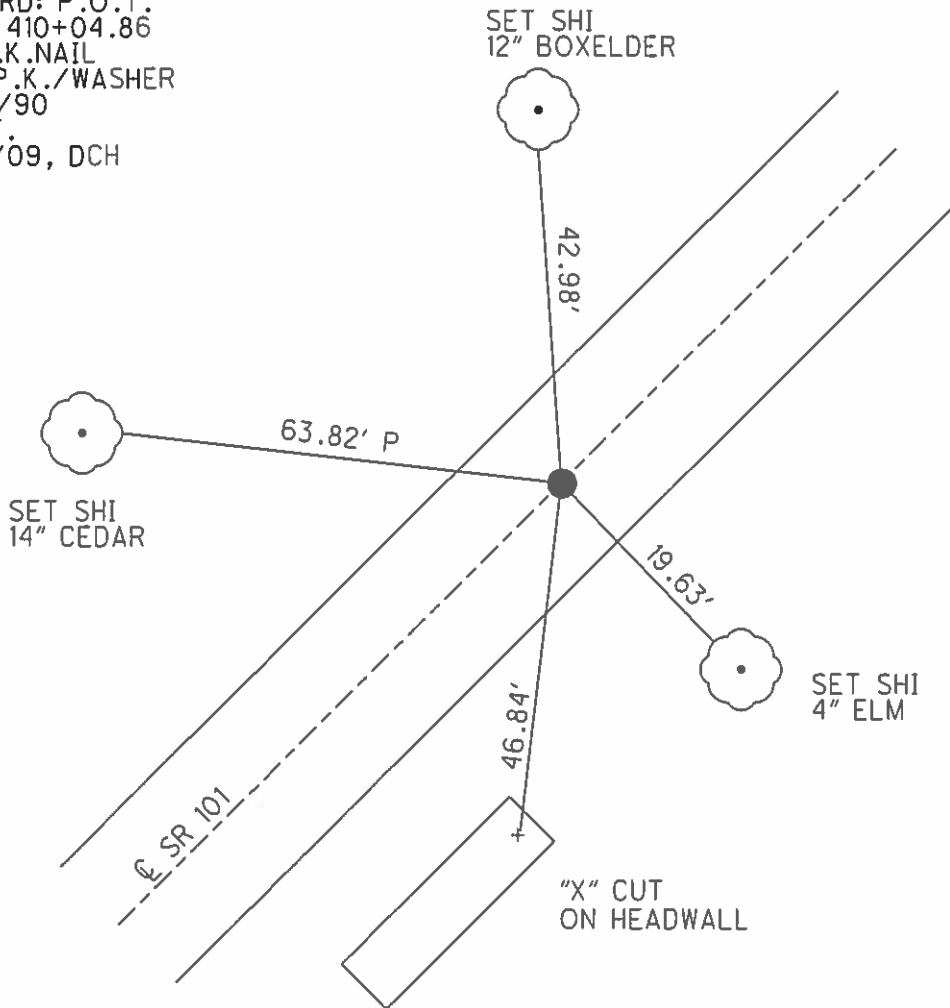

GRID: NORTHING: \_\_\_\_\_ EASTING: \_\_\_\_\_

# O.D.O.T. DISTRICT 2 SURVEY OFFICE

PERSONNEL \_\_\_\_\_

REFERENCE NO. 33

SHEET 7 OF 41

NOTES Ripple

H.C. Barbour

DATE 8/27/90

ROUTE SR#101

R.C. \_\_\_\_\_

WEATHER SUNNY

COUNTY Seneca

TEMP. 82°

TOWNSHIP Pleasant

SECTION 2.5

T.3 N R.15 E

TYPE MONUMENT P.K. & Washer

ON SURFACE - BELOW P.K. Nail

LEFT- & PAV'T. - RIGHT &

TO \_\_\_\_\_ EDGE PAVEMENT

S.L.M. \_\_\_\_\_

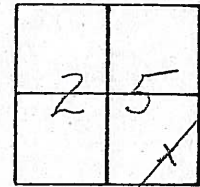

408+10

Need  
Traffic  
Control

P.O.T. 410+04.86

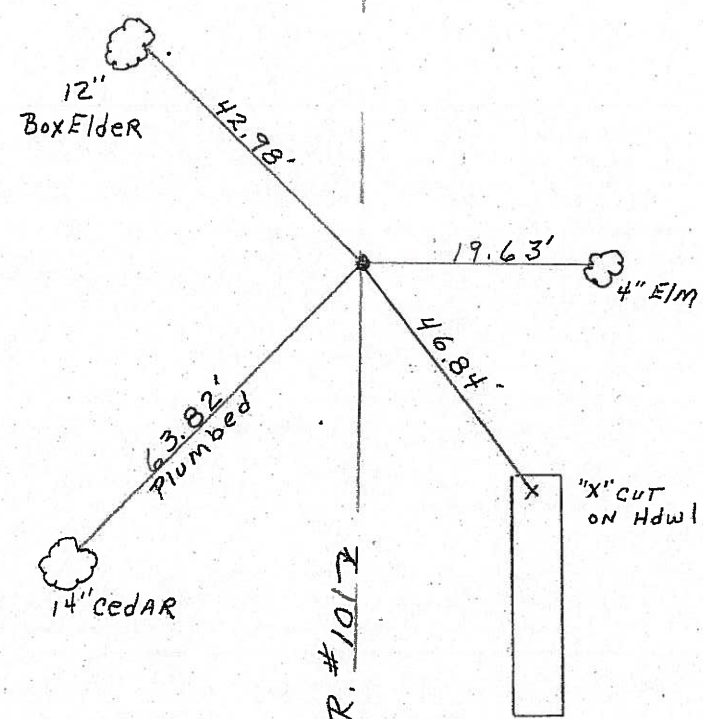

# O.D.O.T. DISTRICT 2 SURVEY OFFICE

PERSONNEL \_\_\_\_\_

REFERENCE NO. 33

SHEET 7 OF 41

NOTES RIPPLE

H.C. BARBOUR

DATE 8/27/90

ROUTE SR#101

R.C. \_\_\_\_\_

WEATHER SUNNY

COUNTY SENECA

TEMP. 82°

TOWNSHIP PLEASANT

SECTION 25

T3 N R 15 E

TYPE MONUMENT P.K. & Washer

ON SURFACE - BELOW P.K. NAIL

LEFT - ℄ PAV'T. - RIGHT ℄

TO \_\_\_\_\_ EDGE PAVEMENT

S.L.M. \_\_\_\_\_

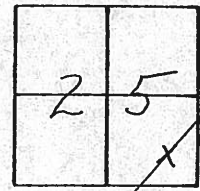

P.O.T. 410+04.86

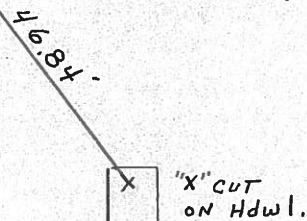
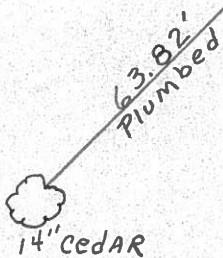
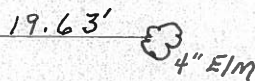
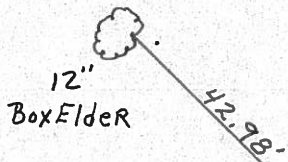

℄ R/W S.R. #1017

Q.D.O.T. DISTRICT 2 SURVEY OFFICE

Sht. \_\_\_ of \_\_\_

County Seneca S.R. 101

Date 6-26-79

Township Pleasant

Weather Fair

Section 25

Temp. 72°

T<sub>3</sub>N, R<sub>15</sub>E

Personnel Schneider

Mosser

Barbour

\_\_\_\_\_

\_\_\_\_\_

33

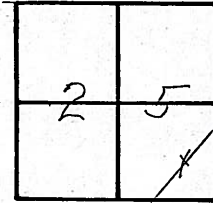

#36



± S.R. # 101

P.O.T.  
 410 + 04.86  
 Reset P.K. Nail

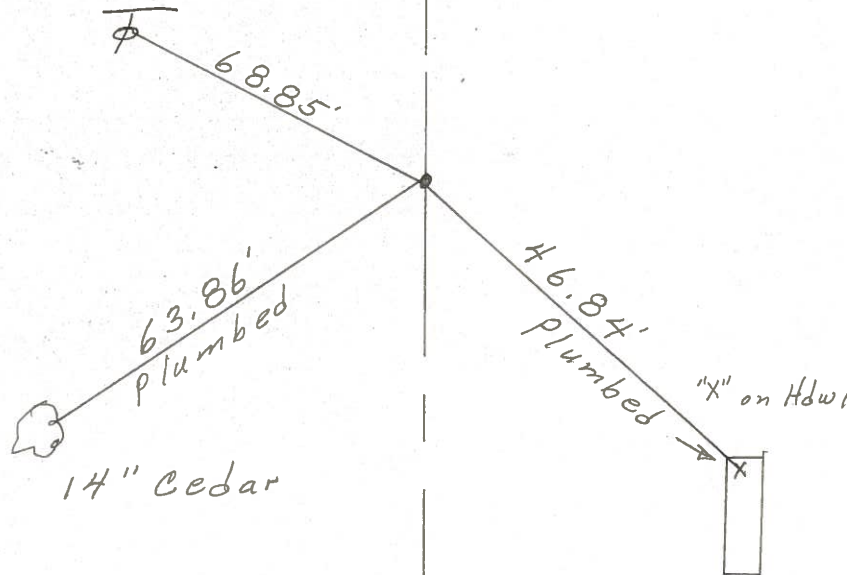

| PERSONNEL        | TITLE | PERSONNEL     | TITLE |
|------------------|-------|---------------|-------|
| <u>Schneider</u> |       | <u>Vinson</u> |       |
| <u>Mosser</u>    |       |               |       |
| <u>Barbour</u>   |       |               |       |
| <u>Geyman</u>    |       |               |       |

COUNTY Seneca DATE 10-4-71  
 S. R. 101 WEATHER Fair  
 SEC. Br. #8.10 TEMP. 72'

DESCRIPTION \_\_\_\_\_ JOB NO. 028270

**35-A**

~~NO~~

P.O.T.  
 426+97.81  
 set small spk.

10" Cottonwood

69.79'

32.75'

26" Ash

Twp. line  
 Twp. Rd. #169 South

**35**

P.I.  
 426+91.80  
 Ed. sq. bolt  
 $\Delta = 0^{\circ} 29' Lt.$

71.70'

35.51'

62.24'

24" Ash

59.85'

**34**

~~NO~~

P.I.  
 414+04.19  
 set small spk.  
 $\Delta = 9^{\circ} 48' Lt.$

26.98'  
 Plumbed

43.25'  
 Plumbed

8" Basewood

21.02'  
 Plumbed

12" Ash

**33**

~~NO~~

P.O.T.  
 410+41.26  
 set P.K. Nail

68.85'  
 Plumbed

63.86'  
 Plumbed

10" Cedar

46.85'  
 Plumbed

"X" on Hdwl.

