

O.D.O.T. DISTRICT 2 SURVEY OFFICE (USE ONLY)

PERSONNEL _____ REFERENCE NO. 2 SHEET 2 OF 39
NOTES RHOADES DATE 6/11/13 ROUTE SR 224
H.C. ROUSOS WEATHER CLOUDY COUNTY SENECA
R.C. WESTFALL TEMP. 66° TOWNSHIP LOUDON
SECTION 31
T 2 N R 13 E

TYPE MONUMENT P.K./WASHER
~~ON SURFACE~~ - BELOW 4"
LEFT - ☉ PAV'T - ~~RIGHT~~ 0.6'
- TO - EDGE PAVEMENT
S.L.M. 20+01.44

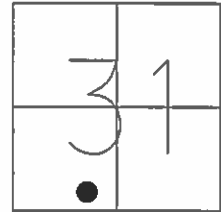

Grid: Northing: 516424.377 Easting: 1716593.993

RECORD: P.O.T.
FD R.R.SPIKE
11/26/63, EK
2/10/12, DCH
GPS, REF2

SET MAG/WASHER
GPS, REF2
5/21/14, EBW

1.5' UP
SET NOTCH
SIGN POST

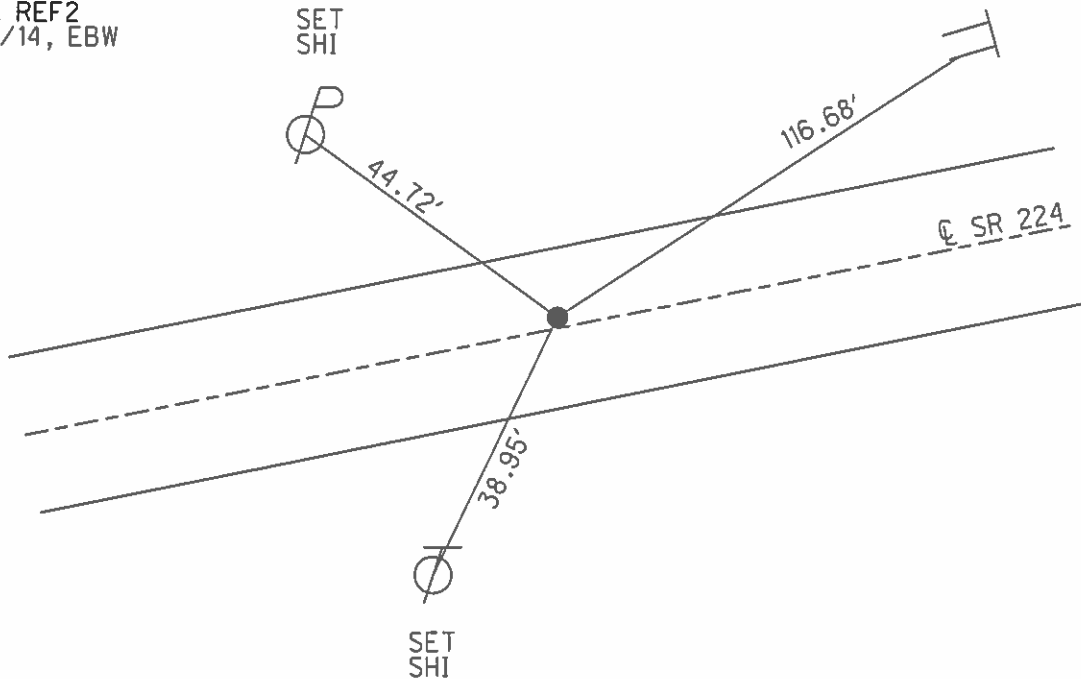

PERSONNEL	TITLE	PERSONNEL	TITLE	COUNTY	DATE	WEATHER	TEMP.
				Seneca	3-18-71	cloudy	32°
				S. R. 224			
				SEC. 0.00			
DESCRIPTION				Seneca - Hancock Co. Line to Tiffin		JOB NO.	
LEFT		CENTER LINE		RIGHT			

did not find Δ

8552-A

"X" on rim M.H. N.E.

③

P.I.
41+56.13
 $\Delta = 5^{\circ} 59' Rt.$
At R.R. track
15.55 S. of W. Rail Joint N.

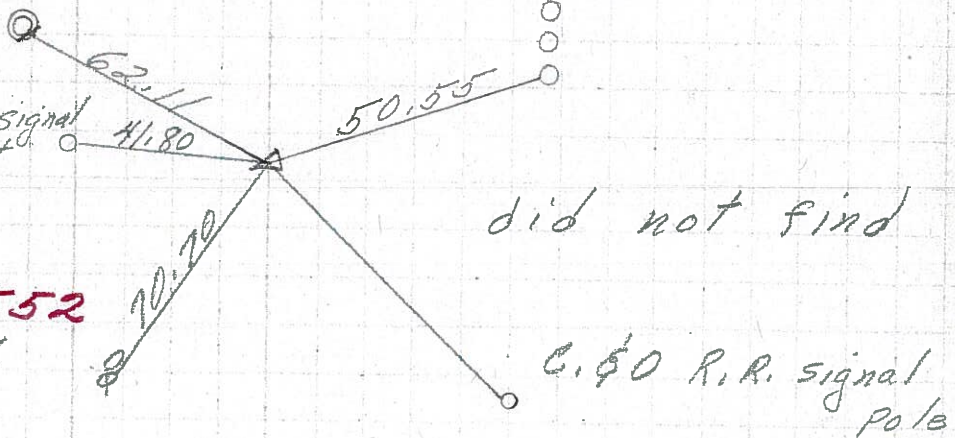

②

P.O.T.
20+00
R.R. spk. on top

8551

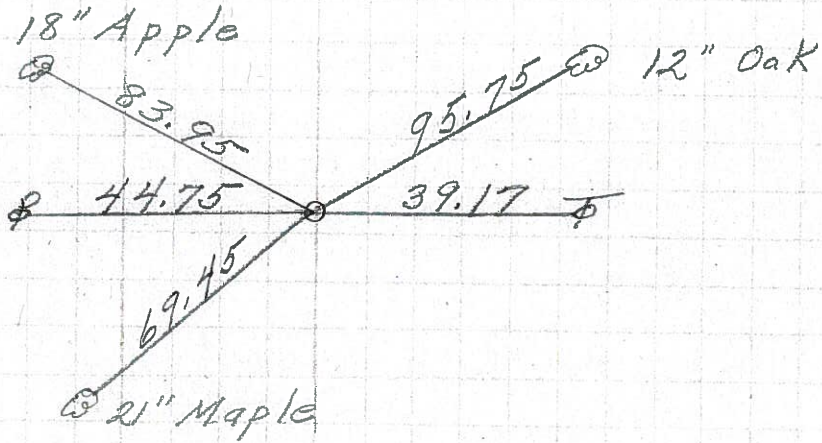

①

0+00
 $\Delta = 0^{\circ} 27' Lt.$
R.R. spk. on top

8550

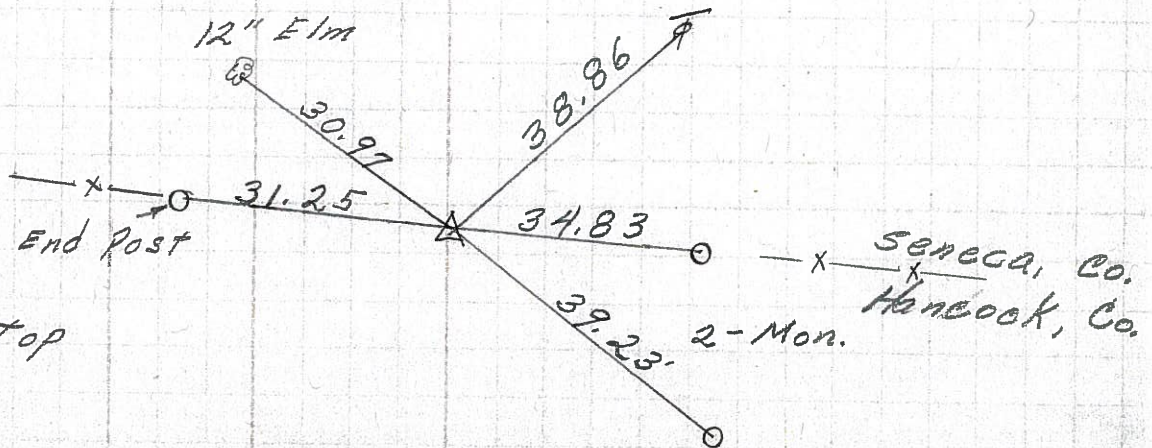

PERSONNEL TITLE PERSONNEL TITLE

COUNTY Seneca DATE 11-26-63

E. Krabill
J. Kowalski
Brooks

S. R. 224 WEATHER

SEC. TEMP.

DESCRIPTION Hancock Co Line To Co Rd 591 JOB NO.

LEFT CENTER LINE RIGHT

