

O.D.O.T. DISTRICT 2 SURVEY OFFICE (USE ONLY)

PERSONNEL \_\_\_\_\_ REFERENCE NO. 7 A SHEET 9 OF 34  
 NOTES RHOADES DATE 11/6/23 ROUTE SR 231  
 H.C. AUBLE WEATHER SUNNY/WINDY COUNTY SENECA  
 R.C. ASTON TEMP. 48° TOWNSHIP EDEN  
 \_\_\_\_\_ NIESE SECTION 19  
 DWG BY RHOADES PID 95780 T 1 N R 15 E

TYPE MONUMENT MAG/WASHER

~~ON SURFACE~~ - BELOW ON

OFFSET  $\odot$  PAVEMENT 0.5' LT : ~~RT~~

10.0' TO LT EDGE PAVEMENT

STATION: 105+94

HORZ. DATUM: NAD83(2011)

GEOID: NAVD88 2018

GRID: NORTHING: 494540.629

EASTING: 1783563.778

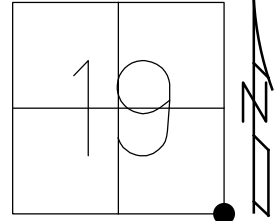

RECORD:  
 FD MAG NAIL  
 REF7A  
 4/18/23, TDN  
 SET MAG/WASHER  
 11/6/23, DSA

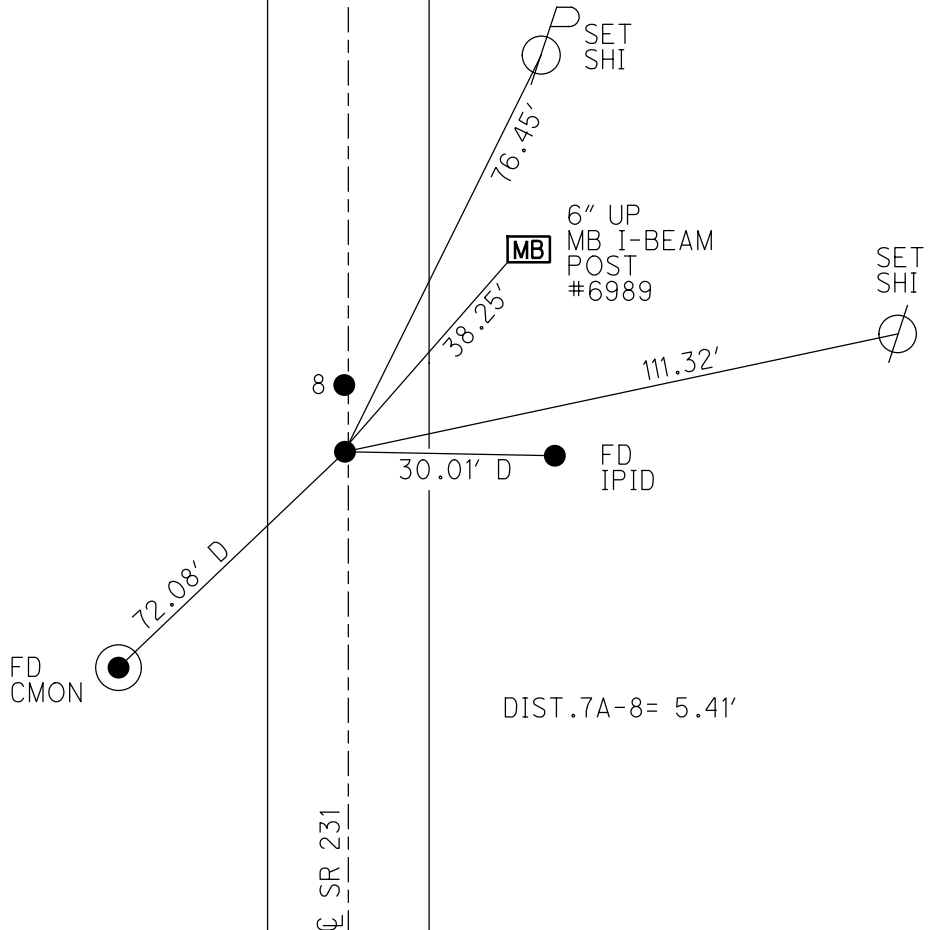

DIST. 7A-8= 5.41'