

O.D.O.T. DISTRICT 2 SURVEY OFFICE (USE ONLY)

PERSONNEL \_\_\_\_\_ REFERENCE NO. 14 SHEET 3 OF 7

NOTES HOMAN DATE 4/26/04 ROUTE SR 635

H.C. ARMS WEATHER SUNNY COUNTY SENECA

R.C. HOOKE TEMP. 60° TOWNSHIP LIBERTY

SECTION 5

T 3 N R 14 E

TYPE MONUMENT 1/2" IPIN

~~ON SURFACE~~ BELOW 1 1/2"

LEFT - ☉ PAV'T - RIGHT ON

- TO - EDGE PAVEMENT

S.L.M. 395+70

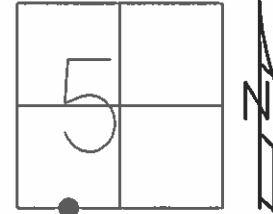

GRID: NORTHING: \_\_\_\_\_ EASTING: \_\_\_\_\_

RECORD:  
ORIGIN UNKNOWN  
SET MAG/WASHER  
8/13/04, DH

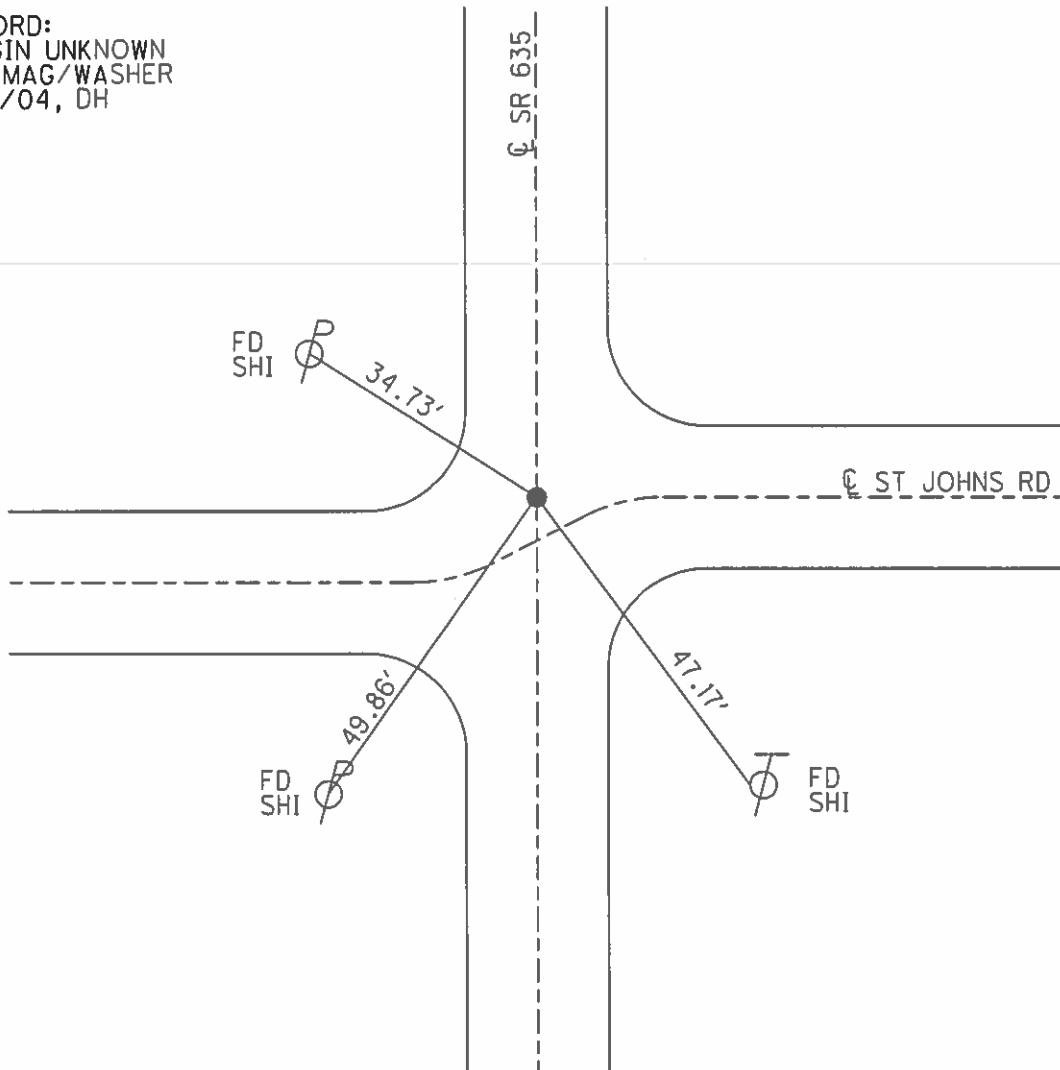

14

Sta 395 + 70

Homan Notes

Hooker RC

Arms HC

4-26-04

Sunny

60°

Fd  
NESH

Set Mag E  
Washer

8-13-04  
DH

1 1/2" Below

34.73'

Fd 1/2" Iron Pin

St. Johns Rd

St Johns Rd

47.17'

49.86'

Fd  
NESH

Fd  
NESH

SR 635

on E 635

on E St Johns to East

