

#1007

FED. RD. DIST. NO.	STATE	PROJECT	FISCAL YEAR
10	OHIO		1945

WILLIAMS COUNTY
SH. 297 SEC. STRYKER (Pt.)

STATE OF OHIO
DEPARTMENT OF HIGHWAYS

BRYAN~WAUSEON ROAD
S.H. 297, SEC. STRYKER (Pt.)
WILLIAMS COUNTY
VILLAGE OF STRYKER

PART 1
For Part 2 See
Fulton County
S.H. 297 & 302
Sec. Archbold (Pt.)

CONVENTIONAL SIGNS

STATE LINE	-----
COUNTY LINE	-----
TOWNSHIP LINE	-----
SECTION LINE	-----
CENTER LINE	-----
PROPERTY LINE	-----
CITY OR VILLAGE LINE	-----
FENCE LINE	-----
STEAM RAILROAD	-----
POLE LINE	-----
GUARD RAIL	-----
DRAIN PIPE, NEW	-----
DRAIN PIPE, OLD	-----

INDEX OF SHEETS

TITLE SHEET	1
TYPICAL SECTION	2
PLAN & PROFILE	3
GENERAL NOTES	4
PAVEMENT COMPUTATIONS	4
SUMMARY	4

LINE DATA
Beginning of Project, Sta. 20+00
End of Project, Sta. 28+84.57
Gross Length of Project = 884.57 Lin. Ft.
Additions - None
Deduction - No work at N.Y.C. R.R. Crossing,
Sta. 22+11.10 to Sta. 22+59.7 = 48.60 Lin. Ft.
Net Length of Project = 835.97 Lin. Ft. or 0.158 Miles.

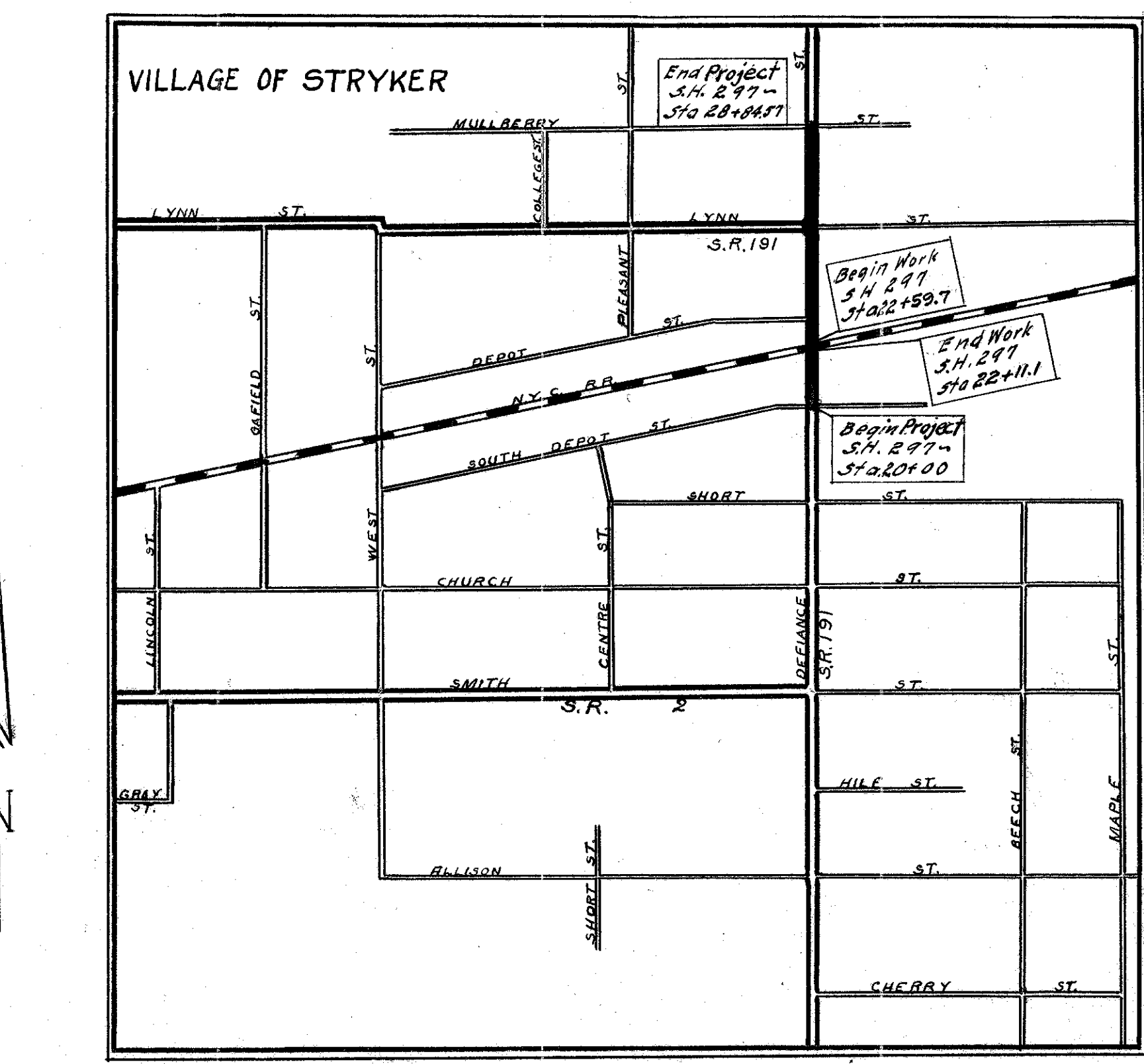

Delivery Point - Stryker, Ohio Average Haul = 0.50 Mile.

LOCATION PLAN

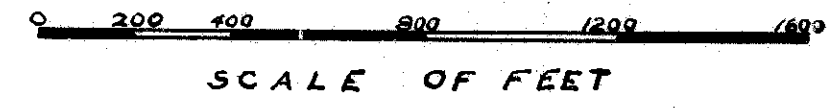

PORTION TO BE IMPROVED
STATE HIGHWAYS
OTHER HIGHWAYS

SCALES

PLAN 1" = 50'
PROFILE - HORIZONTAL 1" = 50'
PROFILE - VERTICAL 1" = 5'

The Standard Specifications of The State of Ohio, Department of Highways, including changes and Supplemental Specifications listed in the Proposal shall govern this improvement.

I hereby approve these plans and declare that the making of this improvement will not require the closing to traffic of the highway and that provisions for the maintenance and safety of traffic will be as set forth on the plans and estimates.

The Right-of-Way necessary for this improvement will be provided by the State of Ohio.

Approved [Signature]
Date 4/6/44 Resident Division Deputy Director.

Approved _____
Date _____ Chief Engineer, Bureau of Maintenance.

Approved _____
Date _____ Chief Engineer Bureau of Bridges & R.R. Crossings.

Approved [Signature]
Date 1-24-45 Chief Engineer, Bureau of Location & Right-of-Way.

Approved [Signature]
Date 7-14-45 First Ass't Director & Chief Engineer

Approved [Signature]
Date 7-12-45 Director of Highways.

FILE NO	WILLIAMS - SH. 297 SEC. STRYKER (Pt.)
DATE OF LETTING	194
CONTRACT NO.	

STANDARD DRAWINGS	
G-7-07	G-1-42

SUPPLEMENTAL SPECIFICATIONS	
M-102.12	8-2-43
176	Rev. 4-21-44

CONSTRUCTION BUREAU
JUN 22 1955
GROUND PHOTOLAB

383

383

10 OHIO 1945 3
 4
 SH 297 Sec. Stryker (Pl)
 Williams County.

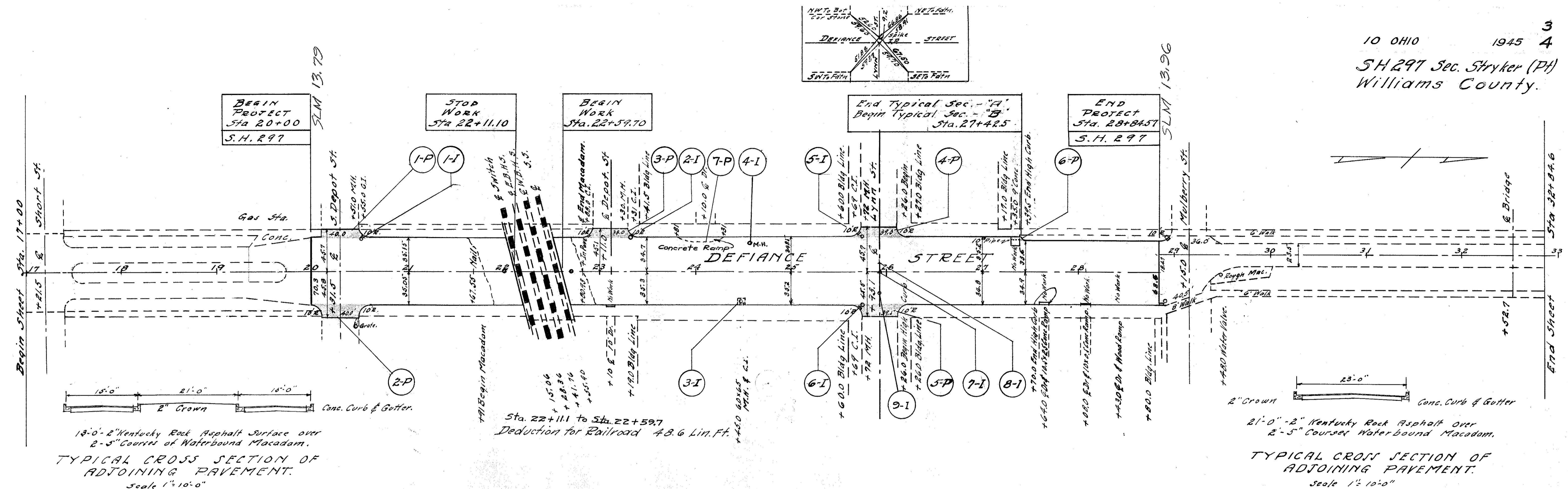

13'-0" - 2" Kentucky Rock Asphalt Surface over
 2'-5" Courses of Waterbound Macadam.
**TYPICAL CROSS SECTION OF
 ADJOINING PAVEMENT.**
 Scale 1" = 10'-0"

Sta. 22+11.1 to Sta. 22+59.7
 Deduction for Railroad 48.6 Lin. Ft.

21'-0" - 2" Kentucky Rock Asphalt over
 2'-5" Courses Waterbound Macadam.
**TYPICAL CROSS SECTION OF
 ADJOINING PAVEMENT.**
 Scale 1" = 10'-0"

**INCIDENTAL
 CONSTRUCTION "I"**

Ref. No.	Station	Side	I-8 Adjust MH Tops To Grade Each	E-8 Removal & Disposal of Existing Brick Wearing Course Sq. Yds.	I-8 Adjust I.P.s To Grade Each
1-I	20+55	Lt	1		
2-I	23+31	Lt	1		
3-I	24+45	Rt	1	2	
4-I	24+58	Lt	1		
5-I	25+72	Lt	1		
6-I	25+72	Rt	1		
7-I	25+93.1	C			1
8-I	25+93.1	Lt			1
9-I	25+93.1	Rt		3	
TOTALS			6	5	2

**EXTRA
 PAVEMENT "P"**

Ref. No.	Station	Side	T-35 1 1/2" Surface Course Sq. Yds.	B-35 3/4" Leveling Course Sq. Yds.	T-30 Prime Coat Sq. Yds.	E-8 Removal of Existing Concrete Ramp Sq. Yds.
1-P	20+31.5	Lt	52.3	26.1	52.3	
2-P	20+31.5	Rt	52.3	26.4	52.3	
3-P	23+11.0	Lt	48.7	24.4	48.7	
4-P	25+93.1	Lt	51.2	25.6	51.2	
5-P	25+93.1	Rt	50.9	25.4	50.9	
6-P	27+40.0	Lt	0.3	0.2	0.3	
7-P	24+06	Lt				3
TOTALS			256.2	128.1	256.2	3

BM. USGS 719
 6' N. of N.E. Cor. Pub. School
 2' N. of N. side Building.
 Elevation 718.93.

BM Top of SE. Hose
 Connection Cap
 55' Lt. Sta. 21+70
 Elevation 718.80

BM. Top of 1/2" Vertical
 pipe for flag pole,
 36' Rt. Sta. 27+91
 Elevation 712.20.

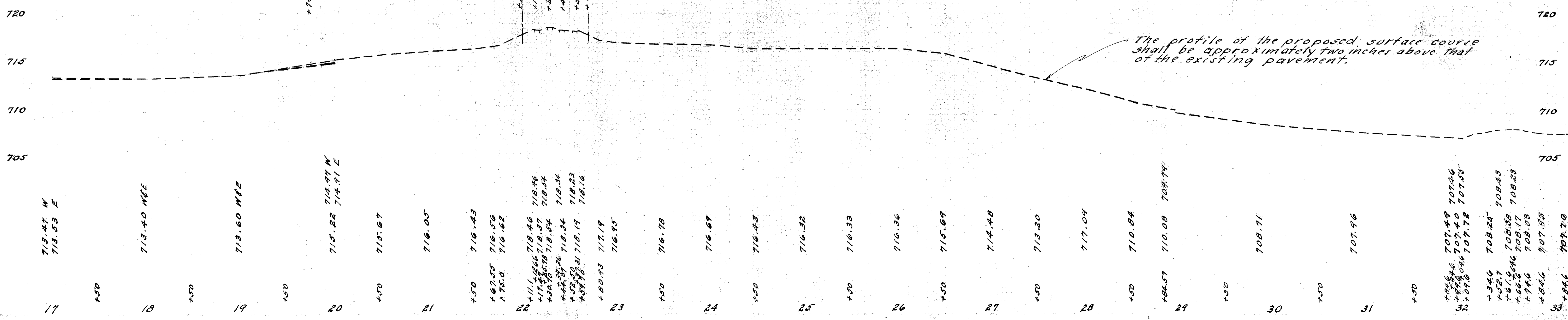

The profile of the proposed surface course shall be approximately two inches above that of the existing pavement.