

O.D.O.T. DISTRICT 2 SURVEY OFFICE (USE ONLY)

PERSONNEL	REFERENCE NO. <u>49</u>	SHEET <u>16</u> OF <u>17</u>
NOTES <u>HOMAN</u>	DATE <u>7/10/2012</u>	ROUTE <u>SR 2</u>
H.C. <u>ROUSOS</u>	WEATHER <u>SUNNY</u>	COUNTY <u>WILLIAMS</u>
R.C. <u>HOMAN</u>	TEMP. <u>75°</u>	TOWNSHIP <u>SPRINGFIELD</u>
		SECTION <u>17</u>
		<u>T 6 N R 4 E</u>

TYPE MONUMENT 60 D SPIKE
~~ON SURFACE~~ - BELOW 2"
~~LEFT~~ - CL PAV'T - ~~RIGHT~~ OF BOTH
11.2' TO RT EDGE PAVEMENT
 S.L.M. 658+29

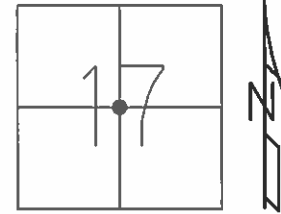

GRID: NORTHING: 665770.829 EASTING: 1440054.593

RECORD: P.I.
 STA. 84+49.39
 $\Delta = 0^\circ 08''$ LT
 R/W PLANS
 SH 310, 1935
 SET P.K./WASHER
 6/22/94
 FD 60D SPIKE
 2" DOWN
 7/10/12
 SET MAG/WASHER
 2/6/13, DCH

NOTE:
 SR 34 REF49

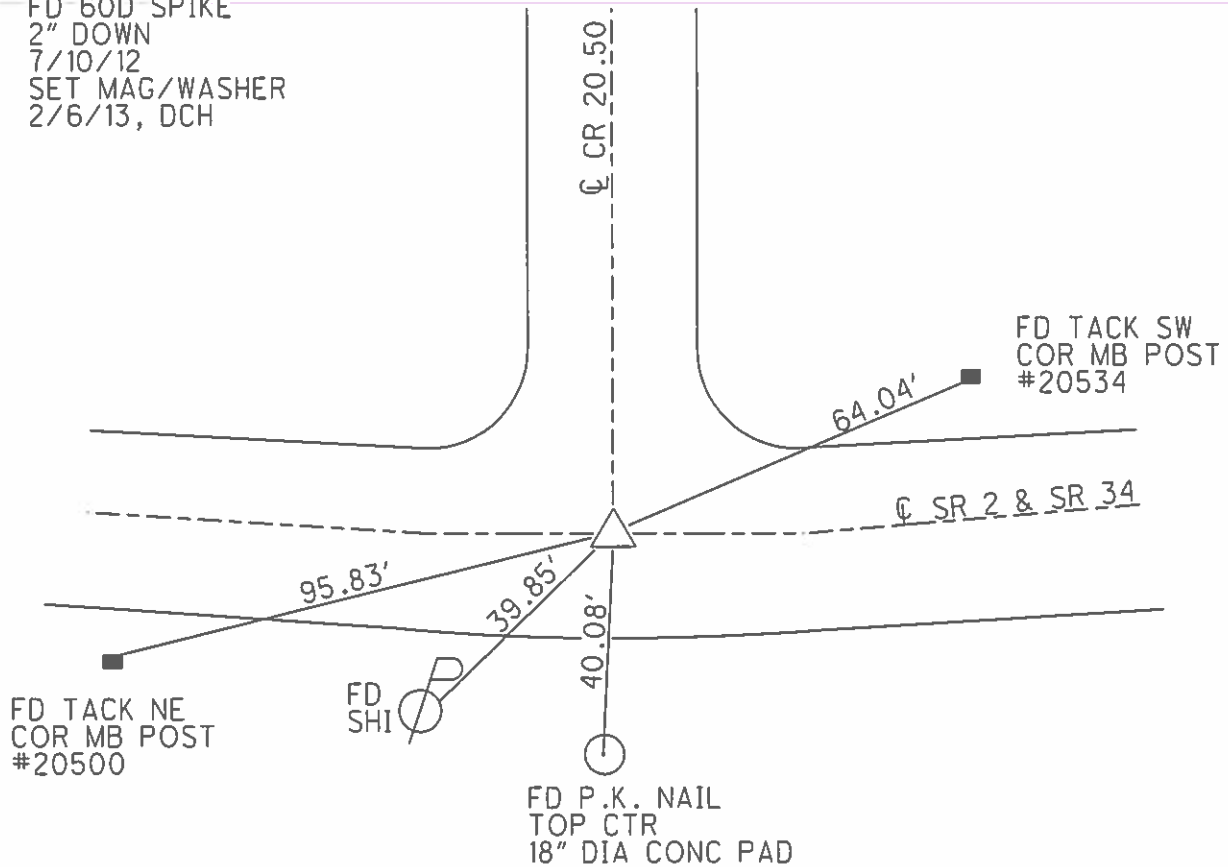

O.D.O.T. DISTRICT 2 SURVEY OFFICE

PERSONNEL

REFERENCE NO. 49

SHEET 23 OF 24

NOTES LOEHRKE

H.C. CANTERBURY

R.C. HERMILLER

DATE 5-4-94

WEATHER CLOUDY

TEMP. +55

ROUTE S.R. 2

COUNTY Williams

TOWNSHIP SPRINGFIELD

SECTION 17

T. 6 N R. 4 E

Set P.K./washer
6-22-94

TYPE MONUMENT 60-d Spike

ON SURFACE - BELOW Yes

LEFT - ☐ PAV'T. - RIGHT Both

11.2 TO Rt EDGE PAVEMENT

S.L.M. 658729

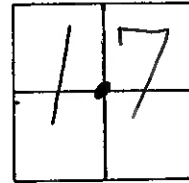

RECORD:

P.I. Sta 84+49.39

$\Delta = 0^{\circ}08'Lt$

R/W PLANS

S.H. 310, 1935

9 PAVT Co Rd. 2050

Set tack S.W.
CORNER Mail Box Post
20534

9 PAVT

63.96

S.R. 2 E 34

48.46

Set Tack
N.E. CORNER MAILBOX
Post # 20500

39.89
Set Shi
NE/S

40.15

Fd. P.K. Nail Set
IN TOP Ctr of
18" DIA CONC. PAD

