

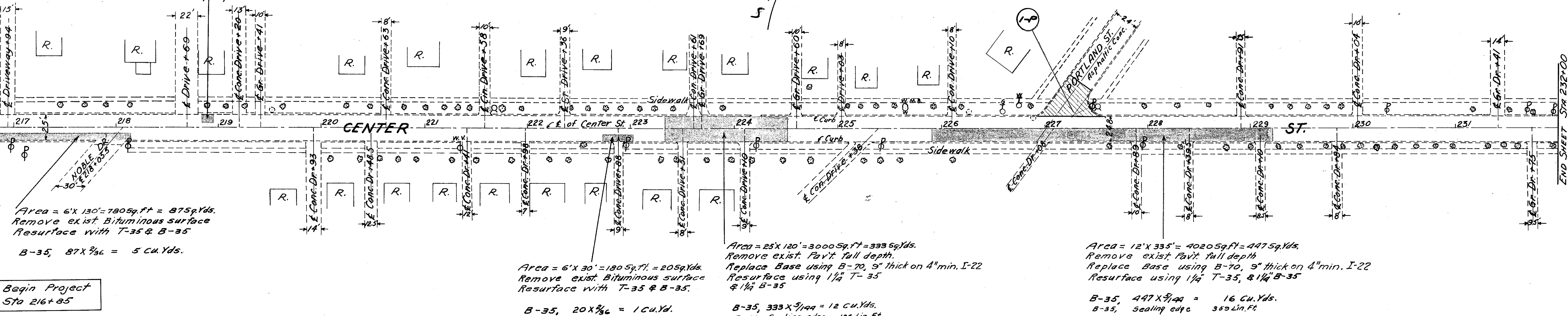

Area = 8' x 10' = 80 sq. ft = 0.90 Yds.  
 Remove exist. Pavt. full depth.  
 Replace Base using B-70, 3" thick on 4" Min. I-22  
 Resurface using 1 1/4" T-35  
 & 1 1/4" B-35  
 B-35, 9' x 3/16" = 0.40 Cu. Yd.  
 B-35, Sealing edge 36 Lin. Ft.



Area = 6' x 130' = 780 sq. ft = 8.75 Yds.  
 Remove exist. Bituminous surface  
 Resurface with T-35 & B-35  
 B-35, 87' x 3/16" = 5 Cu. Yds.  
 Begin Project  
 Sta 216+85

Area = 6' x 30' = 180 sq. ft = 2.05 Yds.  
 Remove exist. Bituminous surface  
 Resurface with T-35 & B-35.  
 B-35, 20' x 3/16" = 1 Cu. Yd.

Area = 25' x 120' = 3000 sq. ft = 33.33 Yds.  
 Remove exist. Pavt. full depth.  
 Replace Base using B-70, 3" thick on 4" min. I-22  
 Resurface using 1 1/4" T-35  
 & 1 1/4" B-35  
 B-35, 333' x 3/16" = 12 Cu. Yds.  
 B-35, Sealing edge 173 Lin. Ft.

Area = 12' x 335' = 4020 sq. ft = 44.75 Yds.  
 Remove exist. Pavt. full depth  
 Replace Base using B-70, 3" thick on 4" min. I-22  
 Resurface using 1 1/4" T-35, & 1 1/4" B-35  
 B-35, 447' x 3/16" = 16 Cu. Yds.  
 B-35, Sealing edge 350 Lin. Ft.

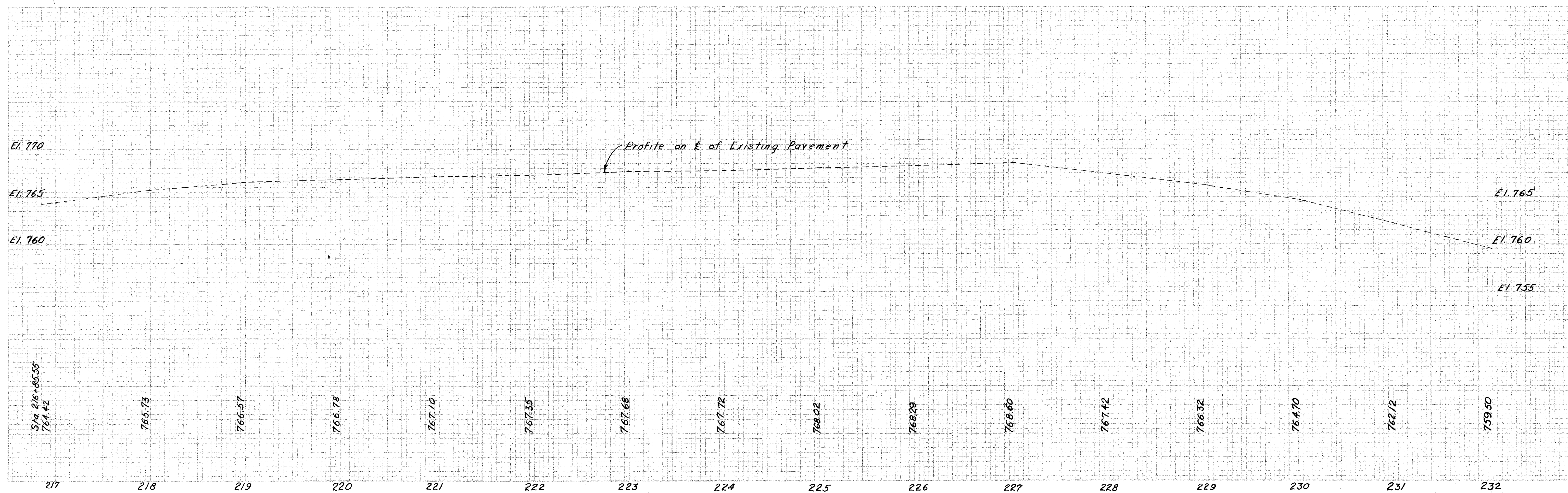

STA 216+85.55 to STA. 232+00

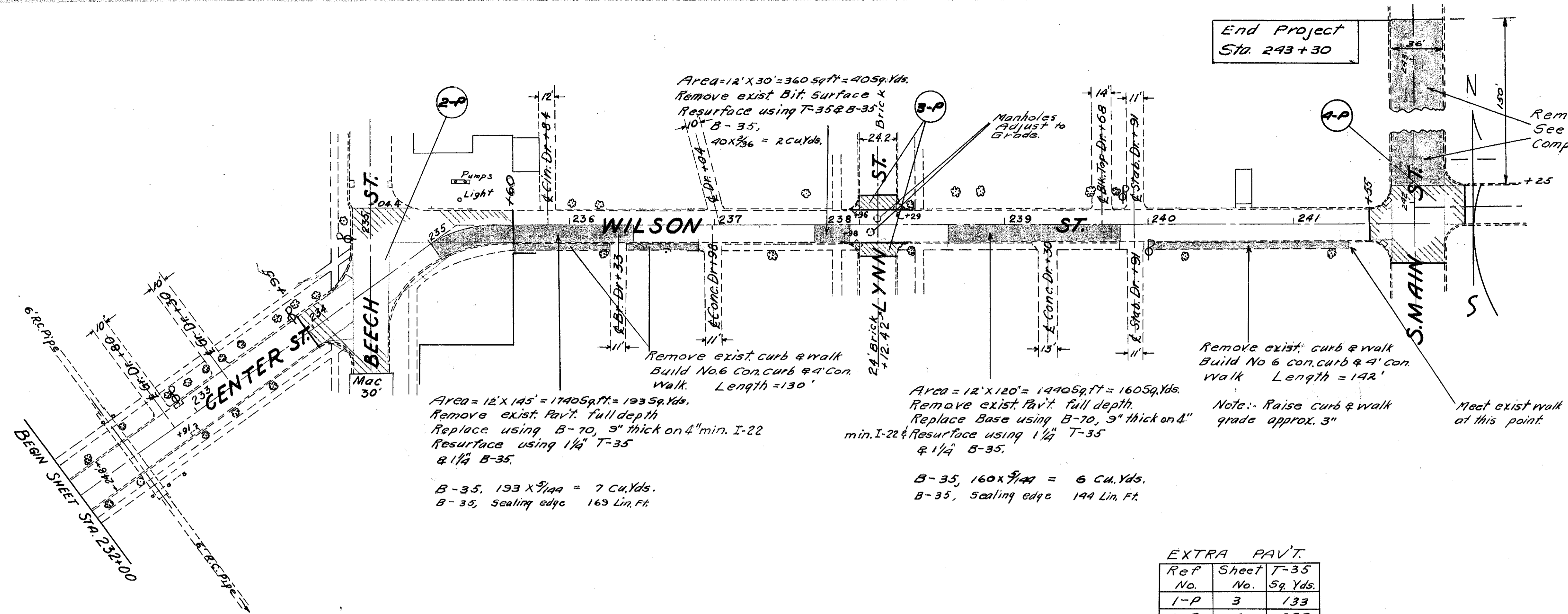

EXTRA PAVT.

Ref No.	Sheet No.	T-35 Sq. Yds.
1-P	3	133
2-P	4	833
3-P	4	69
4-P	4	355
Total		1390

