

O.D.O.T. DISTRICT 2 SURVEY OFFICE (USE ONLY)

PERSONNEL \_\_\_\_\_ REFERENCE NO. 4 SHEET 2 OF 41  
 NOTES TRENKA DATE 7/16/18 ROUTE US 6  
 H.C. LEU WEATHER CLOUDY COUNTY WILLIAMS  
 R.C. HAGEMEYER TEMP. 75° TOWNSHIP ST. JOSEPH  
 DWG BY NIESE PID 102827 SECTION 28  
 T 6 N R 1 E

TYPE MONUMENT MAG NAIL  
 ON SURFACE - ~~BELOW~~ ON  
 OFFSET 0.9' ET : RT  
- TO - EDGE PAVEMENT  
 STATION: 157+14.22

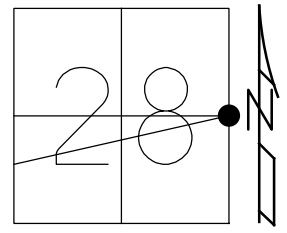

HORIZ.DATUM: NAD83 2011 GEOID: NAVD88 2012A  
 GRID: NORTHING: 656918.931 EASTING: 1352271.364

RECORD:  
 FD IPIN  
 4" DOWN  
 5/3/00, MB  
 SET P.K./WASHER  
 8/1/00, MRC  
 FD 3/4" IPIN  
 6" DOWN  
 5/20/09, DCH  
 SET MAG/WASHER  
 REF4  
 2/22/17, DCH  
 SET MAG/WASHER  
 9/20/19, JLL

NOTE: REF 4 SR 49

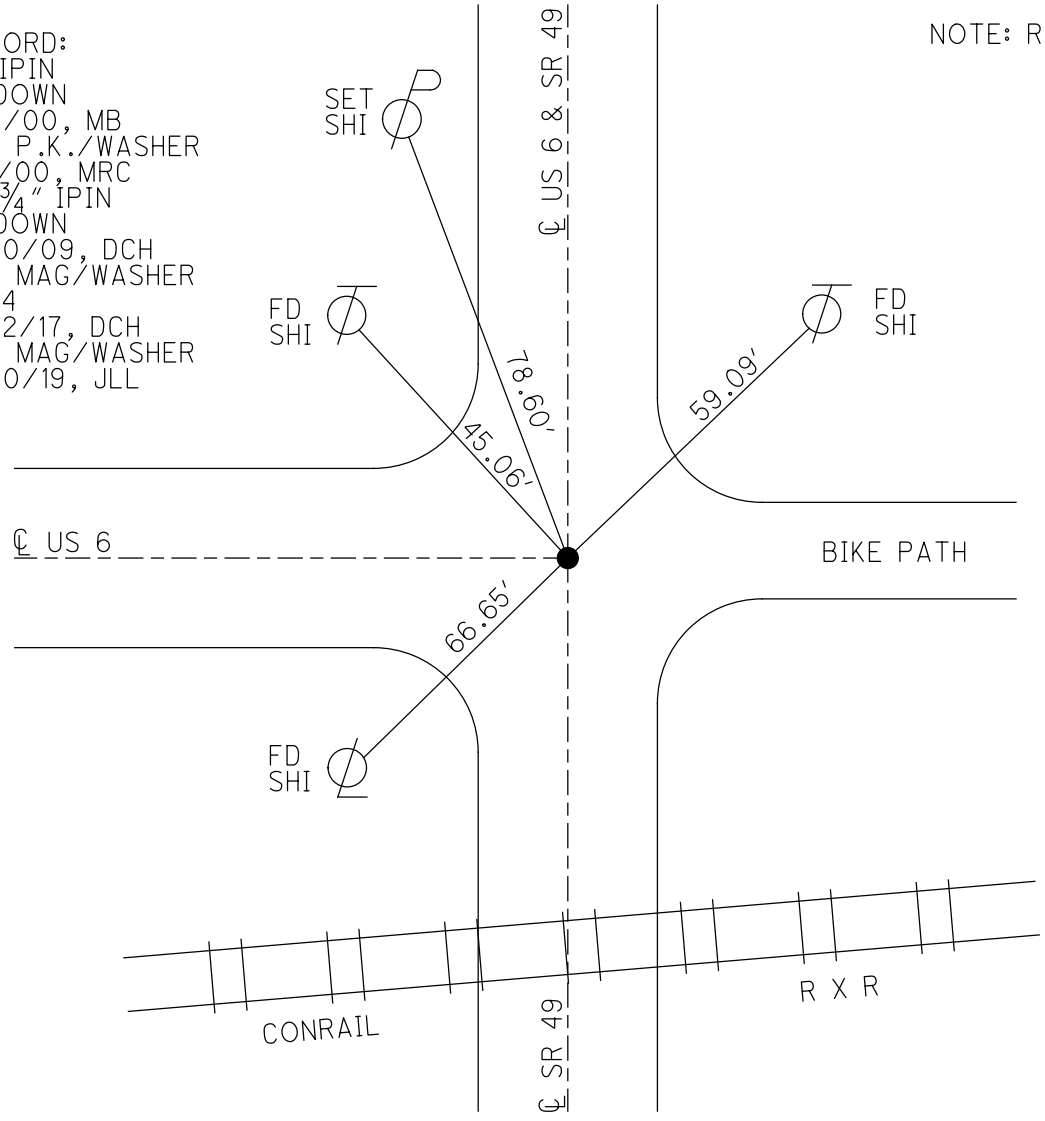

# O.D.O.T. DISTRICT 2 SURVEY OFFICE

PERSONNEL \_\_\_\_\_

REFERENCE NO. 4

SHEET 5 OF 32

NOTES CANTERBURY

H.C. MOSEK

DATE 5-3-00

ROUTE US 6

R.C. BARWISSEL III

WEATHER FAIR

COUNTY WILLIAMS

TEMP. +68°

TOWNSHIP St. Joseph

SECTION 28

T 6 N R 1 E

TYPE MONUMENT IRON ROD

ON SURFACE - BELOW 4"

LEFT - C PAV'T. - RIGHT US 6 WEST & NORTH

- TO - EDGE PAVEMENT

S.L.M. 157+25

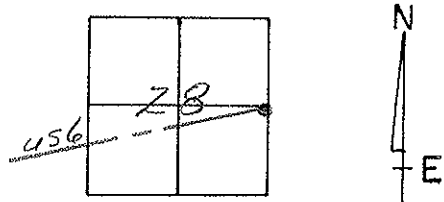

Reset PK/WASHER  
B-1-00  
M.R.C.

