

O.D.O.T. DISTRICT 2 SURVEY OFFICE (USE ONLY)

PERSONNEL _____ REFERENCE NO. 12 A SHEET 16 OF 40
 NOTES NIESE DATE 4/28/22 ROUTE SR 15
 H.C. AUBLE WEATHER SUNNY COUNTY WILLIAMS
 R.C. PARADYZ TEMP. 38° TOWNSHIP MADISON
 DWG BY RHOADES PID 95786 SECTION 28
 T 9 S R 2 W

TYPE MONUMENT MONBOX W/ 1" IPIN
 ON SURFACE - ~~BELOW~~ ON
 OFFSET Q PAVEMENT 0.5' ~~ET~~ : RT
- TO - EDGE PAVEMENT
 STATION: 143+19.27

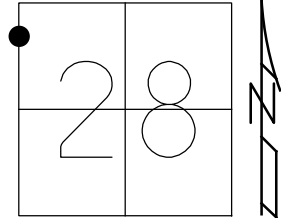

HORZ.DATUM: NAD83 2011 GEOID: NAVD88 2012B
 GRID: NORTHING: 733933.233 EASTING: 1407446.911

RECORD:
 FD MONBOX
 5/29/07, RGN
 FD MONBOX
 W/ 1" IPIN
 REFA12
 3/24/20, JLL
 4/28/22
 9/20/22, DSA

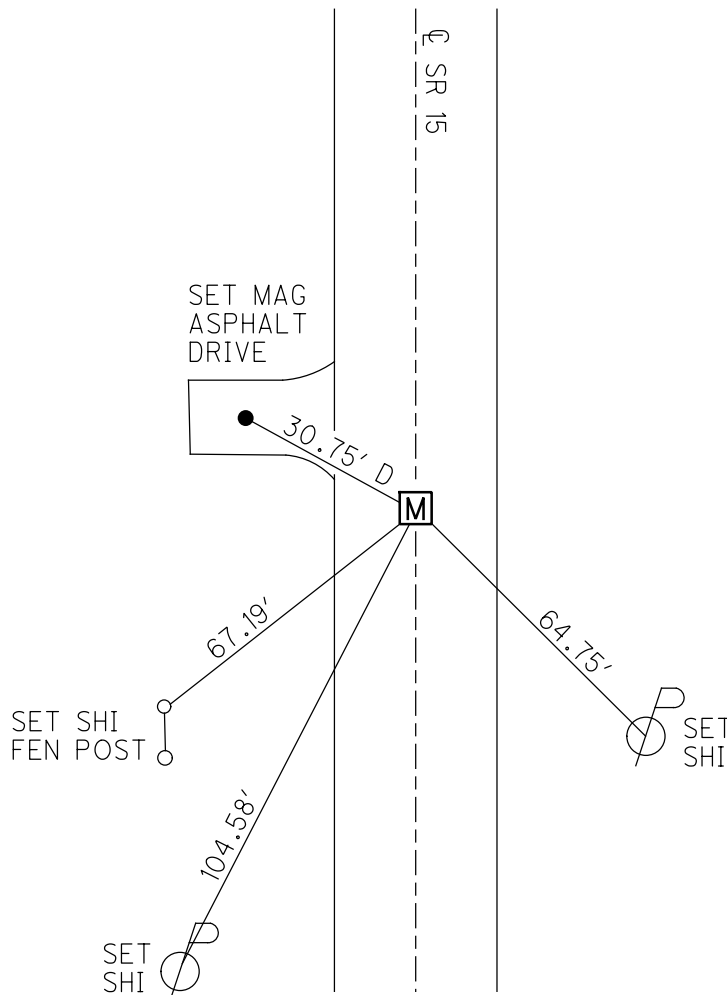

O.D.O.T. DISTRICT 2 SURVEY OFFICE (USE ONLY)

PERSONNEL _____ REFERENCE NO. 12 A SHEET 15 OF 39
NOTES NUHFER DATE 5/29/07 ROUTE SR 15
H.C. HUSS WEATHER SUNNY COUNTY WILLIAMS
R.C. HOUDSHELL TEMP. 74° TOWNSHIP MADISON
SECTION 21
T 9 S R 2 W

TYPE MONUMENT _____ IPIN IN MON.BOX _____
ON SURFACE - ~~BELOW~~ ON _____
LEFT - Q PAV'T - RIGHT ON _____
- TO - EDGE PAVEMENT _____
S.L.M. 143+27

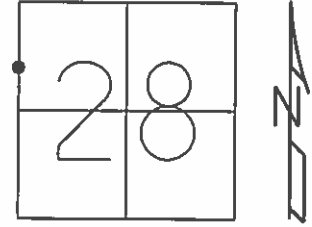

GRID: NORTHING: 733933.371 EASTING: 1407446.932

NOTE: ESTABLISHED WIL-15-2.78 PLAN

