

O.D.O.T. DISTRICT 2 SURVEY OFFICE (USE ONLY)

PERSONNEL

REFERENCE NO. 12 B

SHEET 17 OF 40

NOTES NIESE DATE 4/28/22
 H.C. AUBLE WEATHER SUNNY
 R.C. PARADYZ TEMP. 40°

ROUTE SR 15
 COUNTY WILLIAMS
 TOWNSHIP MADISON
 SECTION 28
 T 9 S R 2 W

DWG BY RHOADES PID 95786

TYPE MONUMENT MONBOX W/ 1" IPIN

ON SURFACE - ~~BELOW~~ ON

OFFSET ☉ PAVEMENT ON LT : RT

- TO - EDGE PAVEMENT

STATION: 150+19.13

HORZ.DATUM: NAD83 2011

GEOID: NAVD88 2012B

GRID: NORTHING: 734860.263

EASTING: 1407464.081

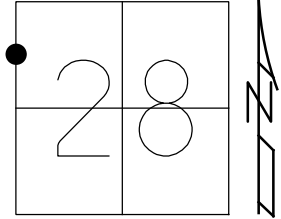

RECORD:
 FD MONBOX
 5/29/07, RGN
 3/24/20, JLL
 FD MONBOX
 W/ 1" IPIN
 REFB12
 4/28/22
 9/20/22, DSA

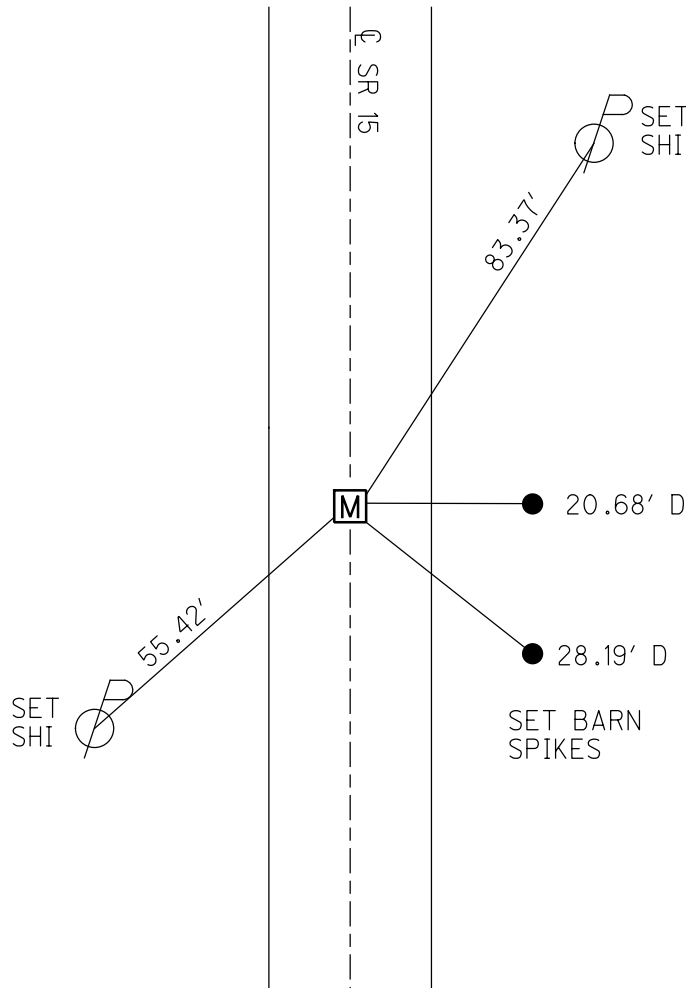

O.D.O.T. DISTRICT 2 SURVEY OFFICE (USE ONLY)

PERSONNEL _____ REFERENCE NO. 12 B SHEET 16 OF 39
NOTES NUHFER DATE 5/29/07 ROUTE SR 15
H.C. HUSS WEATHER SUNNY COUNTY WILLIAMS
R.C. HOUDSHELL TEMP. 74° TOWNSHIP MADISON
SECTION 21
T 9 S R 2 W

TYPE MONUMENT IPIN IN MON.BOX
ON SURFACE - ~~BELOW~~ ON
LEFT - ☉ PAV'T - RIGHT ON
- TO - EDGE PAVEMENT
S.L.M. 150+26.88

GRID: NORTHING: 733233.491 EASTING: 1407433.900

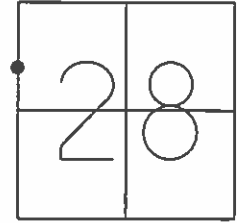

NOTE: ESTABLISHED WIL-15-2.78 PLAN

