

O.D.O.T. DISTRICT 2 SURVEY OFFICE (USE ONLY)

PERSONNEL _____ REFERENCE NO. 57 A SHEET 9 OF 11
 NOTES LEU DATE 4/10/2017 ROUTE US 20
 H.C. HOMAN WEATHER CLOUDY COUNTY WILLIAMS
 R.C. LEU TEMP. 65° TOWNSHIP MILLCREEK
 _____ SECTION 22
 _____ T 9 S R 1 W

TYPE MONUMENT 3/4" IPIPE
~~ON SURFACE~~ - BELOW 9"
 LEFT - ☉ PAV'T - RIGHT ON
- TO - EDGE PAVEMENT
 S.L.M. 1160+41

Grid: Northing: 734121.887 Easting: 1447881.053

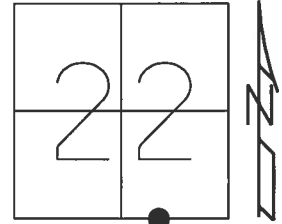

RECORD:
 FD 1" IPIPE
 5" DOWN
 5/21/97, CL
 SET P.K./WASHER
 8/12/97, CL
 FD 1" IPIPE
 9" DOWN
 REFA57
 4/10/17, JLL
 SET MAG/WASHER
 8/11/17, DCH

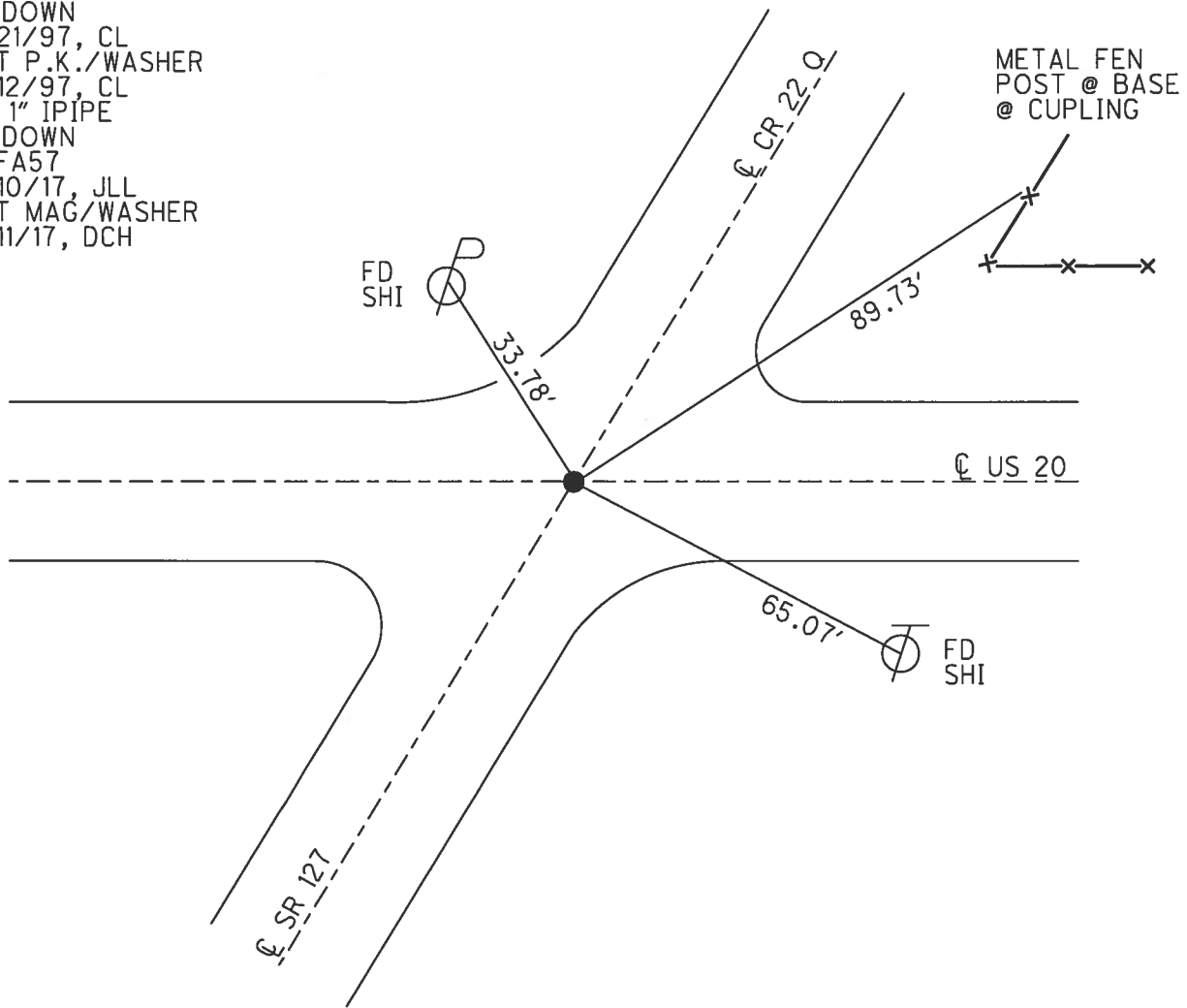

O.D.O.T. DISTRICT 2 SURVEY OFFICE

PERSONNEL

REFERENCE NO. 57-A

SHEET 15 OF 17

NOTES LOEHKE

H.C. CORDES D

DATE 5-21-97

ROUTE 20

R.C. MOSEK

WEATHER SUN

COUNTY WILLIAMS

N HUSS

TEMP. +58°F

TOWNSHIP MILLCREEK

Set PK/WASHP
8-10-97

SECTION 22

T 9 S R L W

TYPE MONUMENT 1" I PIPE

~~ON~~ SURFACE - BELOW 5"

~~LEFT~~ - ~~C~~ PAV'T. - ~~RIGHT~~ YES

TO EDGE PAVEMENT

S.L.M. 1160441

