

O.D.O.T. DISTRICT 2 SURVEY OFFICE (USE ONLY)

PERSONNEL _____ REFERENCE NO. 57 B SHEET 10 OF 11

NOTES	<u>LEU</u>	DATE	<u>4/12/2017</u>	ROUTE	<u>US 20</u>
H.C.	<u>HOMAN</u>	WEATHER	<u>SUNNY</u>	COUNTY	<u>WILLIAMS</u>
R.C.	<u>LEU</u>	TEMP.	<u>42°</u>	TOWNSHIP	<u>MILLCREEK</u>
				SECTION	<u>22</u>
				T <u>9</u> S	R <u>1</u> W

TYPE MONUMENT P.K./WASHER
 ON SURFACE - ~~BELOW~~ ON
 LEFT - ☉ PAV'T - RIGHT ON
11.5' TO LT EDGE PAVEMENT
 S.L.M. 1164+73

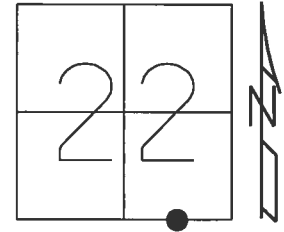

Grid: Northing: 734111.902 Easting: 1448309.799

RECORD:
 FD 1" IPIPE
 2" DOWN
 5/21/97, CL
 SET P.K./WASHER
 8/12/97, CL
 FD P.K./WASHER
 REFB57
 4/12/17, JLL
 SET MAG/WASHER
 8/11/17, DCH

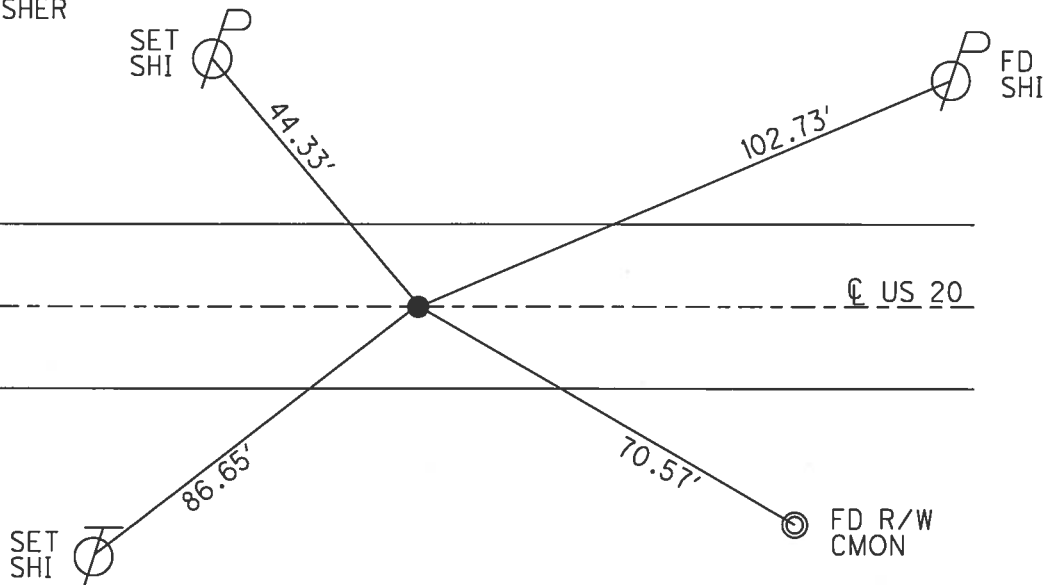

O.D.O.T. DISTRICT 2 SURVEY OFFICE

PERSONNEL

REFERENCE NO. 57-B

SHEET 16 OF 17

NOTES LOEHRKE

H.C. CORDES W

R.C. MOSER

HUSS

DATE 5-21-97

WEATHER SUN

TEMP. +60°F

ROUTE 20

COUNTY WILLIAMS

TOWNSHIP MILLCREEK

SECTION 22

T 9 S R 1 W

Set P.K. / WASHED
8-12-97

TYPE MONUMENT 1" I PIPE

~~ON SURFACE~~ - BELOW 2"

LEFT - ~~PAV'T~~ - RIGHT 0.7 LT

11.5 TO LT EDGE PAVEMENT

S.L.M. 1164+73

