

O.D.O.T. DISTRICT 2 SURVEY OFFICE (USE ONLY)

PERSONNEL

REFERENCE NO. 35 C

SHEET 3 OF 17

NOTES LOEHRKE DATE 4/20/94
 H.C. CANTERBURY WEATHER CLOUDY
 R.C. HERMILLER TEMP. 55°
VOGEL

ROUTE SR 34
 COUNTY WILLIAMS
 TOWNSHIP PULOSKI
 SECTION 18

DWG BY RHOADES PID _____

T 6 N R 3 E

TYPE MONUMENT 1/2" IPIN

~~ON SURFACE~~ - BELOW 1"

OFFSET \odot PAVEMENT ON _____ LT : RT

24.9' TO LT EDGE PAVEMENT

STATION: 854+89

HORZ. DATUM: _____

GEOID: _____

GRID: NORTHING: _____

EASTING: _____

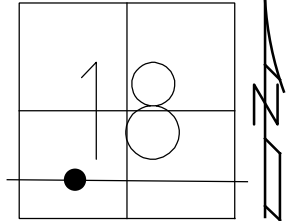

RECORD:
 FD 1/2" IPIN
 1" DOWN
 4/20/94, CL
 SET P.K./WASHER
 6/22/94, CL

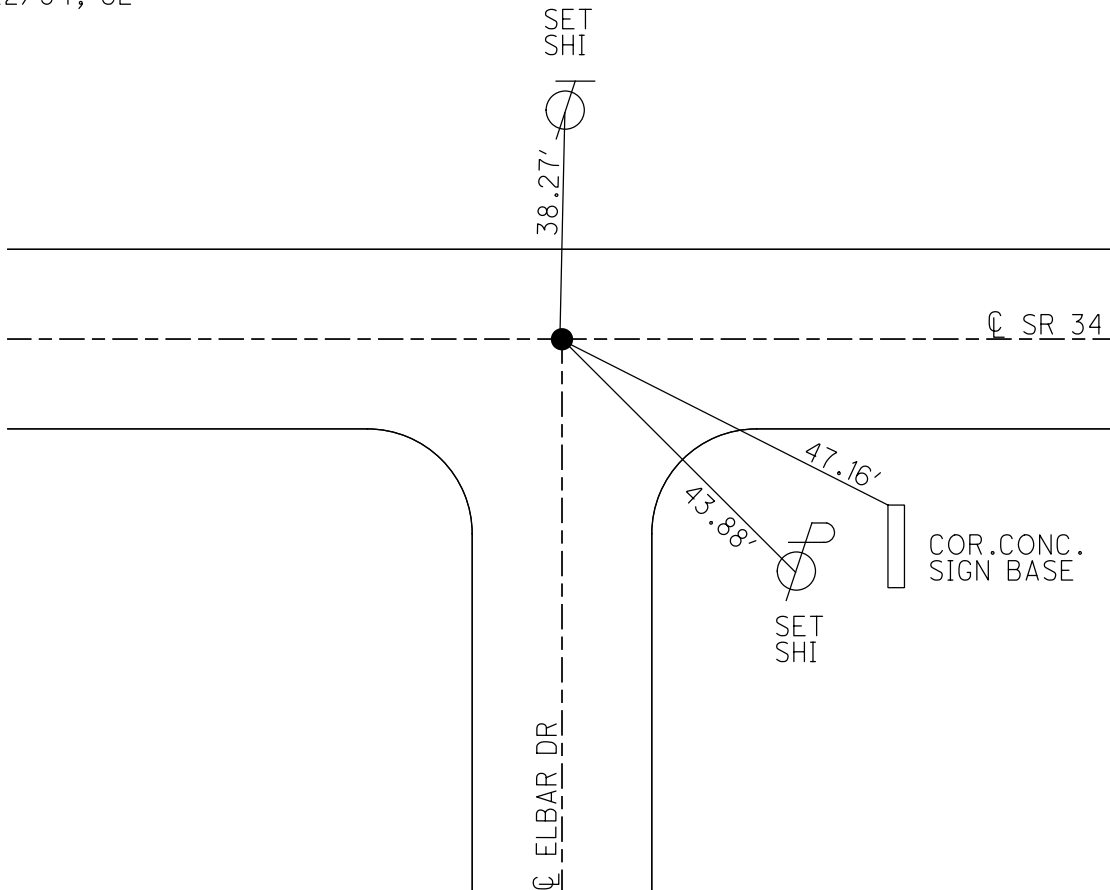

O.D.O.T. DISTRICT 2 SURVEY OFFICE

PERSONNEL

REFERENCE NO. 35C

SHEET 6 OF 19

NOTES LOEHRKE

H.C. CANTERBURY

R.C. HERMILLER

VOGEL

DATE 4.20-94

WEATHER CLOUDY

TEMP. +55

Set PK./WASHER

6-27-94

C.L.

ROUTE S.R. 34

COUNTY WILLIAMS

TOWNSHIP PULASKI

SECTION 18

T 6 N R 3 E

TYPE MONUMENT 1/2" IRON P.N

ON SURFACE - BELOW 1"

LEFT - & PAV'T. - RIGHT YES

24.9 TO Lt EDGE PAVEMENT

S.L.M. 854789

