

O.D.O.T. DISTRICT 2 SURVEY OFFICE (USE ONLY)

PERSONNEL

REFERENCE NO. 35 G

SHEET 8 OF 17

NOTES LOEHRKE

DATE 4/20/94

ROUTE SR 34

H.C. CANTERBURY

WEATHER NICE

COUNTY WILLIAMS

R.C. HERMILLER

TEMP. 55°

TOWNSHIP PULOSKI

VOGEL

SECTION 18

DWG BY RHOADES PID _____

T 6 N R 3 E

TYPE MONUMENT BRASS PIN

ON SURFACE - ~~BELOW~~ ON

OFFSET CL PAVEMENT 8.2' ~~RT~~ : RT

37.1' TO LT EDGE PAVEMENT

STATION: 865+16

HORZ. DATUM: _____

GEOID: _____

GRID: NORTHING: _____

EASTING: _____

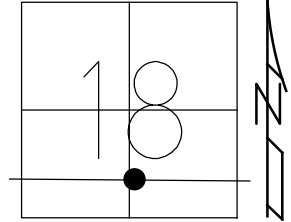

RECORD:
FD BRASS PIN
4/20/94, CL
SET P.K./WASHER
6/21/94, CL

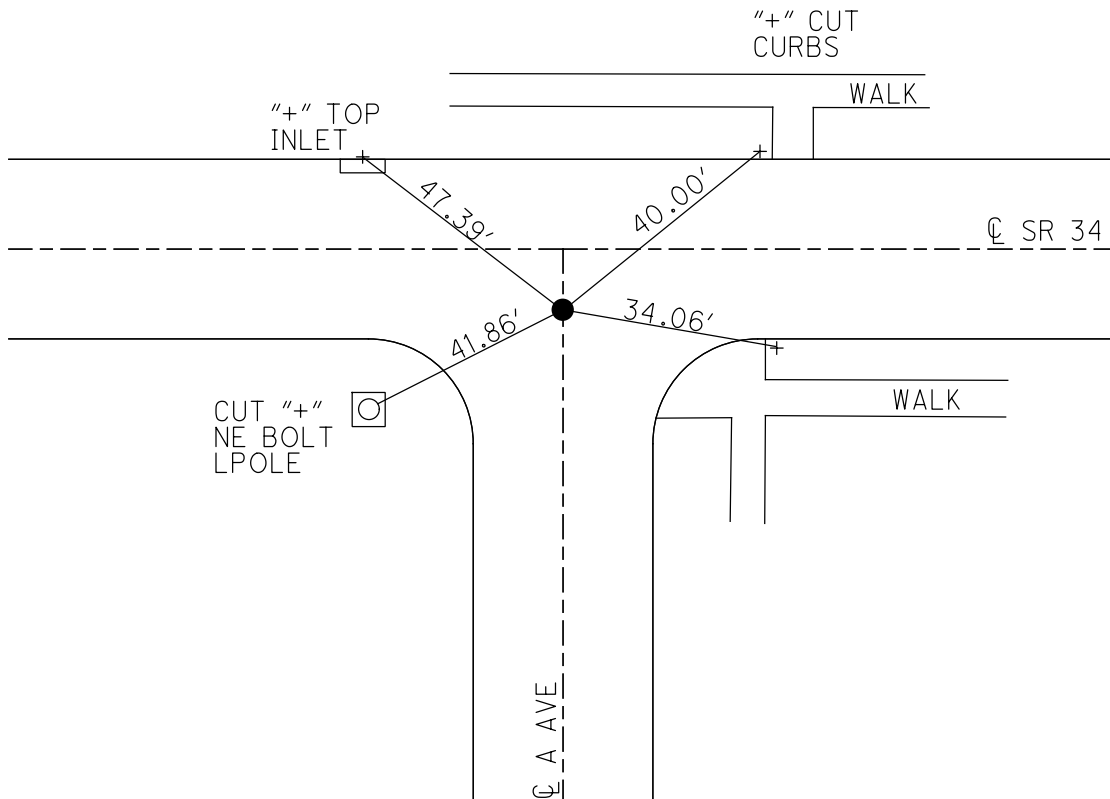

O.D.O.T. DISTRICT 2 SURVEY OFFICE

PERSONNEL

REFERENCE NO. 35 G

SHEET 10 OF 19

NOTES LOEHRKE

H.C. CANTERBURY

DATE 4-20-94

ROUTE S.R. 34

R.C. HERMILLER

WEATHER Nice

COUNTY WILLIAMS

VOGEL

TEMP. +55

TOWNSHIP PULASKI

SECTION 18

T. 6 N. R. 3 E

TYPE MONUMENT BRASS PIN

Set P.K./WASHER
6-21-94

ON SURFACE - ~~BELOW~~ Yes

~~LEFT~~ - & PAV'T. - RIGHT 8.2' Rt

371 TO Lt EDGE PAVEMENT

S.L.M. 865+16

