

O.D.O.T. DISTRICT 2 SURVEY OFFICE (USE ONLY)

PERSONNEL

REFERENCE NO. 35 K

SHEET 12 OF 17

NOTES LOEHRKE

DATE 4/27/94

ROUTE SR 34

H.C. CANTERBURY

WEATHER WINDY

COUNTY WILLIAMS

R.C. HERMILLER

TEMP. 70°

TOWNSHIP PULOSKI

VOGEL

SECTION 18

DWG BY RHOADES PID _____

T 6 N R 3 E

TYPE MONUMENT TABLET

~~ON SURFACE~~ - BELOW ON

OFFSET Q PAVEMENT 8' ~~±~~ : RT

- TO - EDGE PAVEMENT

STATION: 874+23

HORIZ. DATUM: _____

GEOID: _____

GRID: NORTHING: _____

EASTING: _____

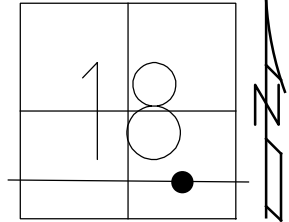

RECORD:
FD TABLET
4/27/94, CL
SET P.K./WASHER
6/21/94, CL

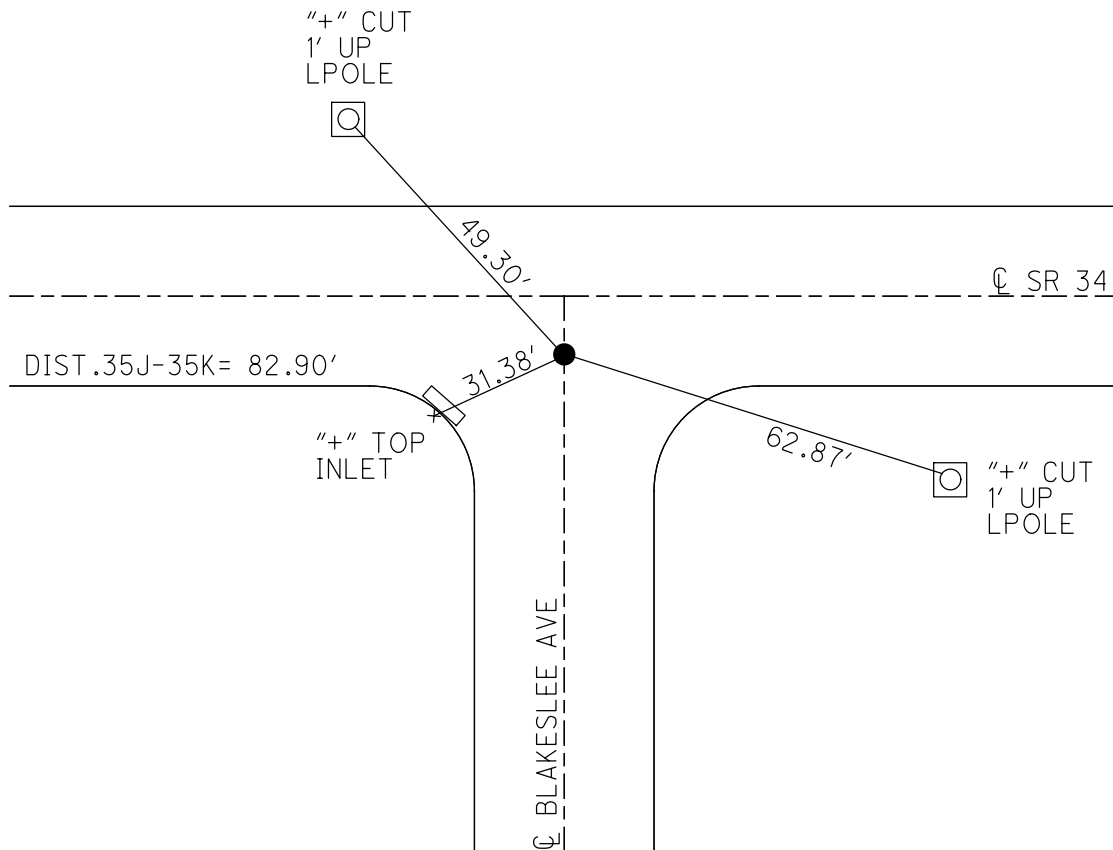

O.D.O.T. DISTRICT 2 SURVEY OFFICE

PERSONNEL

REFERENCE NO. 35 K

SHEET 14 OF 19

NOTES LOEHRKE

H.C. CANTERBURY

DATE 4-27-94

ROUTE S.R. 34

R.C. HERMILLER

WEATHER WINDY

COUNTY WILLIAMS

VOGEL

TEMP. +70

TOWNSHIP PULASKI

Set P.K. WASHER
6-21-94

SECTION 18

T. 6 N. R. 3 E

TYPE MONUMENT TABLET

ON SURFACE - BELOW Yes

LEFT- & PAV'T. - RIGHT 8.0

TO EDGE PAVEMENT

S.L.M. 874+23

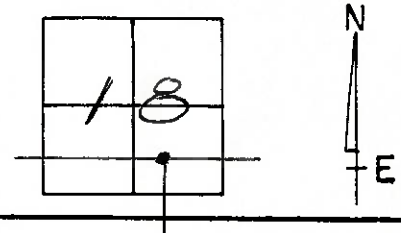

N



Cut
"4" 1ft up Near FACE
OF LIGHT POLE



cut "4" Top Steel
CURB Inlet Cap

E BLAKESLEE AVE. PAV'T

62.87



Cut "4" 1ft up, Near face
OF LIGHT POLE