

O.D.O.T. DISTRICT 2 SURVEY OFFICE (USE ONLY)

PERSONNEL

REFERENCE NO. 35 "O"

SHEET 16 OF 17

NOTES LOEHRKE
 H.C. CANTERBURY
 R.C. HERMILLER
VOGEL

DATE 4/27/94
 WEATHER WINDY
 TEMP. 68°

ROUTE SR 34
 COUNTY WILLIAMS
 TOWNSHIP PULOSKI
 SECTION 17
 T 6 N R 3 E

DWG BY RHOADES PID _____

TYPE MONUMENT TABLET W/PUNCH HOLE

ON SURFACE - ~~BELOW~~ ON

OFFSET \varnothing PAVEMENT ON _____ LT : RT
 - TO - EDGE PAVEMENT

STATION: 892+57

HORZ. DATUM: _____ GEOID: _____

GRID: NORTHING: _____ EASTING: _____

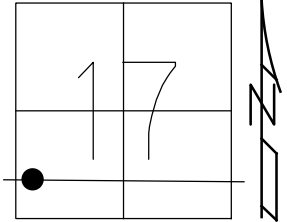

RECORD:
 FD TABLET
 W/PUNCH HOLE
 4/27/94, CL
 SET P.K./WASHER
 6/22/94, CL

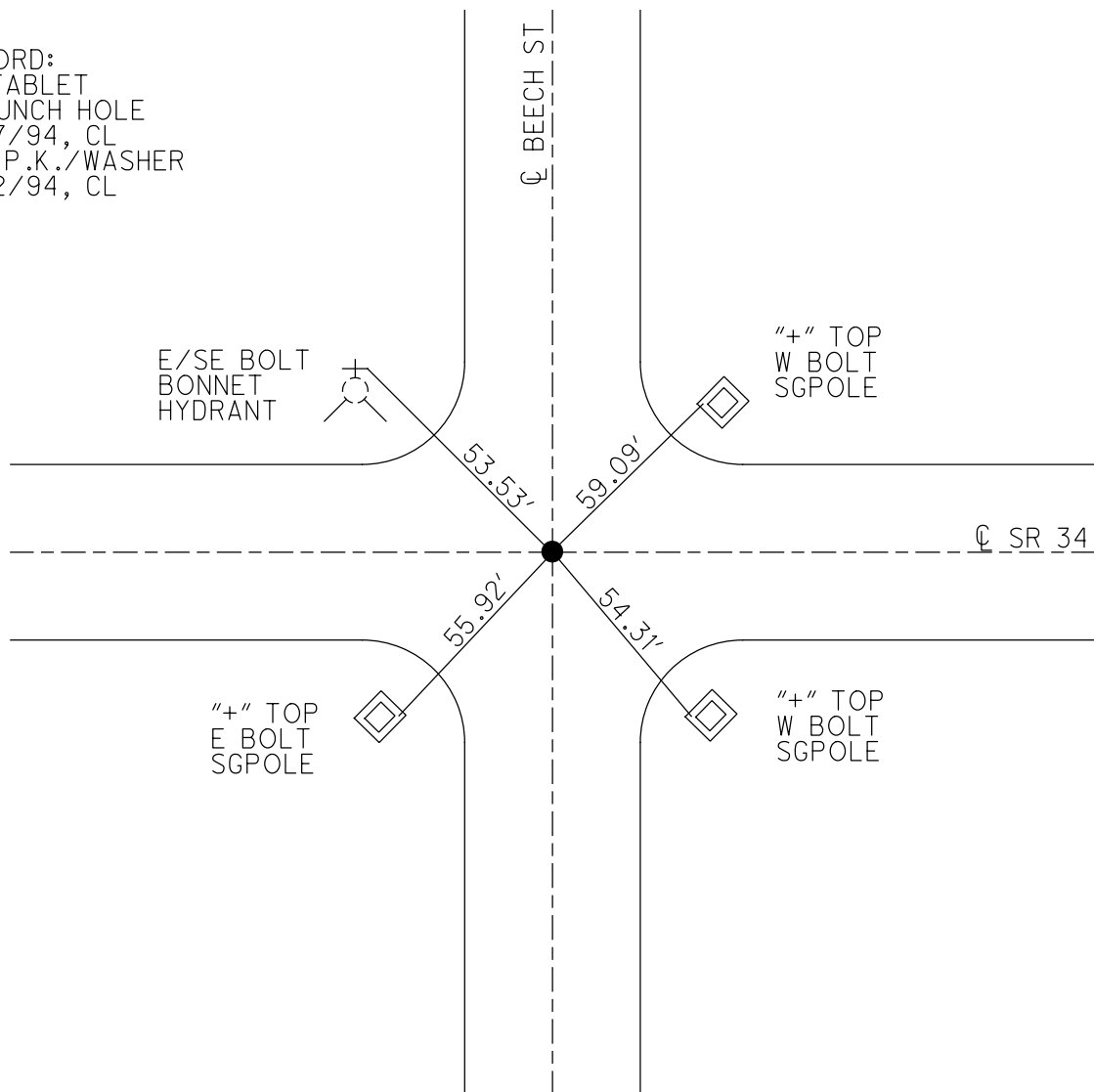

O.D.O.T. DISTRICT 2 SURVEY OFFICE

PERSONNEL

REFERENCE NO. 35"0"

SHEET 18 OF 19

NOTES LOENRKE

H.C. CANTERBURY

R.C. HERMILLER

VOGEL

DATE 4-27-94

WEATHER WINDY

TEMP. 68

ROUTE S.R. 34

COUNTY WILLIAMS

TOWNSHIP PULASKI

SECTION 17

T 4 N R 3 E

Set P.K./WASHER - 6-22-94

TYPE MONUMENT TABLET W/ PUNCH Hole

ON SURFACE - BELOW CR Both PAVT'S

LEFT- & PAV'T. - RIGHT _____

TO _____ EDGE PAVEMENT

S.L.M. B92 + 57

