

FED. AID DIST. NO.	STATE	FED. AID PROJECT	FISCAL YEAR
10	OHIO		1927

1/6

I.C.H. No. 307 Sec. "West Unity North" WILLIAMS COUNTY

**SCALES**

Plan 1" = 100'  
 Profile (Vertical) 1" = 10'  
 Profile (Horizontal) 1" = 100'  
 Cross Sections 1" = 5'

STATE OF OHIO  
 DEPARTMENT OF HIGHWAYS AND PUBLIC WORKS  
 DIVISION OF HIGHWAYS

**BRYAN-WEST UNITY ROAD**

I.C.H. No. 307. Sec. "West Unity North" Pet. No. 6398.

**WILLIAMS COUNTY**

BRADY TOWNSHIP

DEC. 1927.

**CONVENTIONAL SIGNS**

State line \_\_\_\_\_  
 County line \_\_\_\_\_  
 Township line \_\_\_\_\_  
 Section line \_\_\_\_\_  
 Property line not fenced \_\_\_\_\_  
 Center line \_\_\_\_\_  
 City or village line \_\_\_\_\_  
 Fence \_\_\_\_\_  
 Telephone or Telegraph T T T T  
 Steam railroad \_\_\_\_\_  
 Electric line \_\_\_\_\_  
 Guard Rail \_\_\_\_\_  
 Drain Pipe-new \_\_\_\_\_  
 Drain Pipe-old \_\_\_\_\_

**INDEX**

Title Page p. 1  
 Typical Cross Section p. 2-3  
 Plan and Profile p. 4  
 Cross Sections p. 5-6  
 Structural Plans p. 6  
 Summary of Quantities p. 6

We, the Commissioners of Williams County, hereby approve these plans and certify that the right-of-way, 60 feet wide, is available for the construction, maintenance and repair of the above highway.

*Geo. E. Smith*

*Geo. S. Golding*

*F. A. Qualster*

Date, Jan. 2, 1928 County Commissioners.

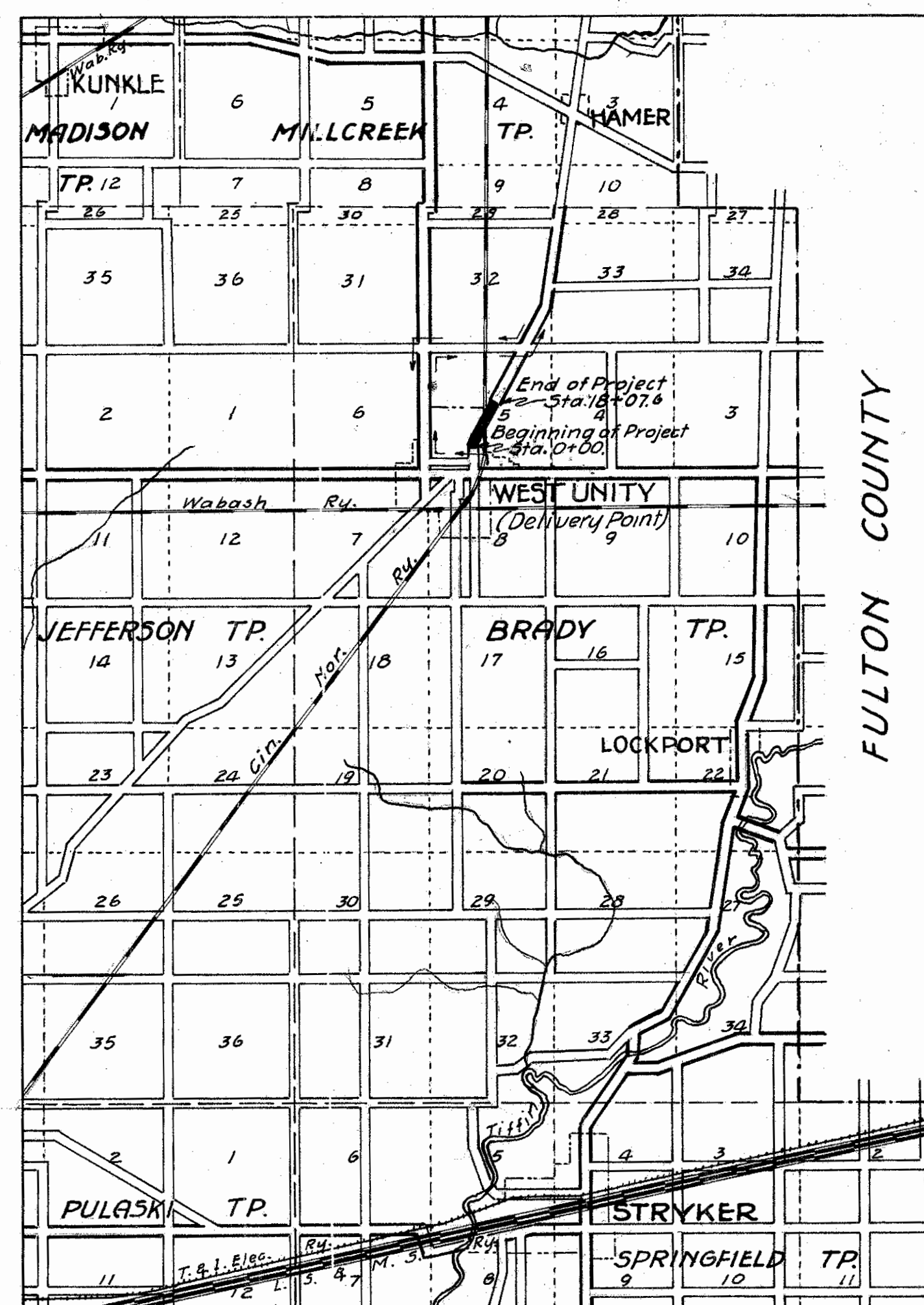

**LOCATION PLAN**

SCALE OF MILES  
 0 1 2 3

PORTION TO BE IMPROVED \_\_\_\_\_  
 DETOURS SHOWN THUS \_\_\_\_\_  
 IMPROVED ROADS \_\_\_\_\_

The Standard Specifications of the State of Ohio Division of Highways in force on date of contract will govern this improvement.

I hereby approve these plans and declare that the making of this improvement will require the closing to traffic of the highway and that detours will be provided as shown on the plans and estimates.

Approved: *W. L. Willick*  
 Date, 1-3-'28 Resident Engineer.

Approved: *M. J. Henshaw*  
 Date, 2-4-'28 Resident Deputy State Highway Commissioner.

Approved: \_\_\_\_\_  
 Date, \_\_\_\_\_ Chief Engineer Bureau of Construction.

Approved: \_\_\_\_\_  
 Date, \_\_\_\_\_ Chief Engineer Bureau of Maintenance.

Approved: \_\_\_\_\_  
 Date, \_\_\_\_\_ Chief Engineer Bureau of Bridges.

Approved: \_\_\_\_\_  
 Date, \_\_\_\_\_ State Highway Engineer.

Approved: \_\_\_\_\_  
 Date, \_\_\_\_\_ Director of Highways and Public Works.

Recommended for Approval: \_\_\_\_\_  
 Date, \_\_\_\_\_ District Engineer Bureau of Public Roads.

Recommended for Approval: \_\_\_\_\_  
 Date, \_\_\_\_\_ Chief Engineer Bureau of Public Roads.

Approved: \_\_\_\_\_  
 Date, \_\_\_\_\_ Chief of Bureau.

CONSTRUCTION BUREAU  
 JUL 22 1955  
 GROUND PHOTOLAB

FED. AID DIST. NO.	STATE	FED. AID PROJECT	FISCAL YEAR
10	OHIO		1927

I. C. H. No. 307, Sec. West Unity North  
WILLIAMS COUNTY.

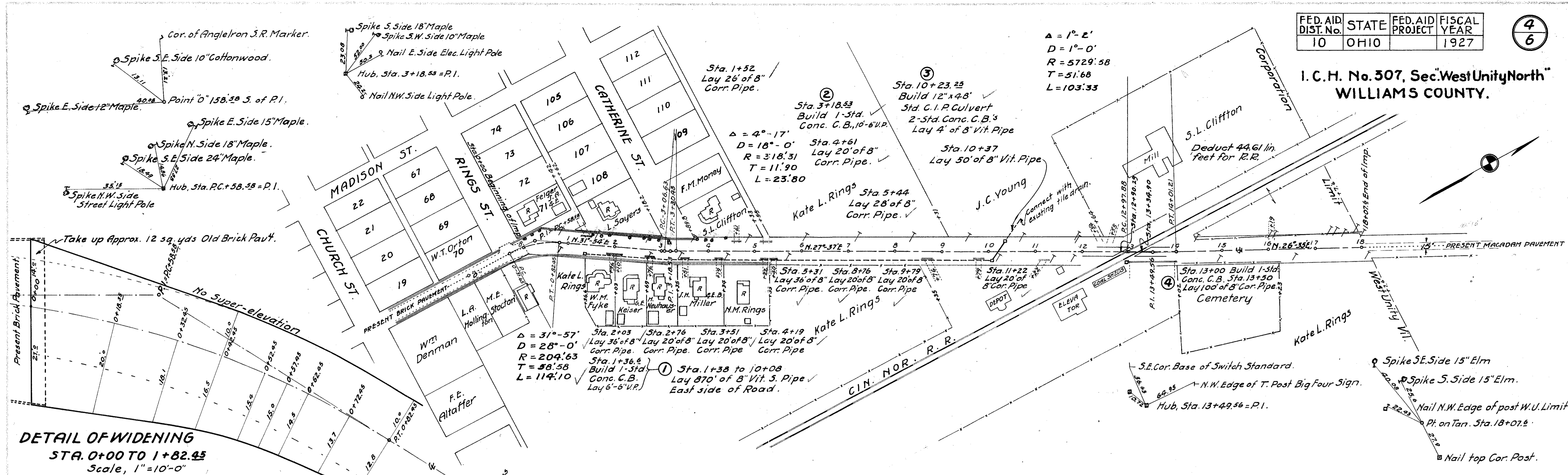

**DETAIL OF WIDENING**  
**STA. 0+00 TO 1+82.45**  
 Scale, 1"=10'-0"  
 Extra Pavement for widening 78 sq. yds.

B.M. Sta. 0+13  
Spike SE Side 24"  
Maple El. - 803.05

B.M. Sta. 13+25  
SE Cor. Base Switch  
Standard El. - 798.18

B.M. Sta. 18+00  
Spike S. Side 15"  
Elm SW. El. - 789.31

**NOTE** - Waste material to be placed on streets and lands to be designated by the Mayor of West Unity, O., maximum haul, 2000 ft.

