

O.D.O.T. DISTRICT 2 SURVEY OFFICE (USE ONLY)

PERSONNEL

REFERENCE NO. 5 A

SHEET 6 OF 9

NOTES JAMES  
 H.C. O'DONNELL  
 R.C. JAMES

DATE 3/1/19  
 WEATHER SUNNY  
 TEMP. 27°

ROUTE US 127  
 COUNTY WILLIAMS  
 TOWNSHIP PULASKI  
 SECTION 32  
 T 6 N R 3 E

DWG BY NIESE PID 101219

TYPE MONUMENT "+" CUT

ON SURFACE - ~~BELOW~~ ON

OFFSET CL PAVEMENT ON LT : RT

- TO - EDGE PAVEMENT

STATION: 54+91.20

HORZ.DATUM: NAD83(2011)

GEOID: NAVD88 2012A

GRID: NORTHING: 653303.685

EASTING: 1406329.866

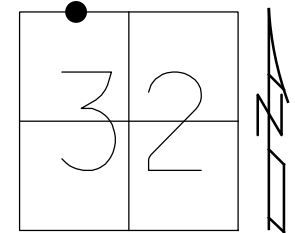

RECORD: P.I.  
 STA. 54+38.4  
 $\Delta = 0^\circ 21' 30''$  RT  
 SET SM.R.R.SPIKE  
 11/23/95, CL

NOTE: US 6 REF A14  
 STA. 707+49  
 CALCREF A14  
 STA 708+15.85  
 N : 653347.466  
 E : 1406434.450

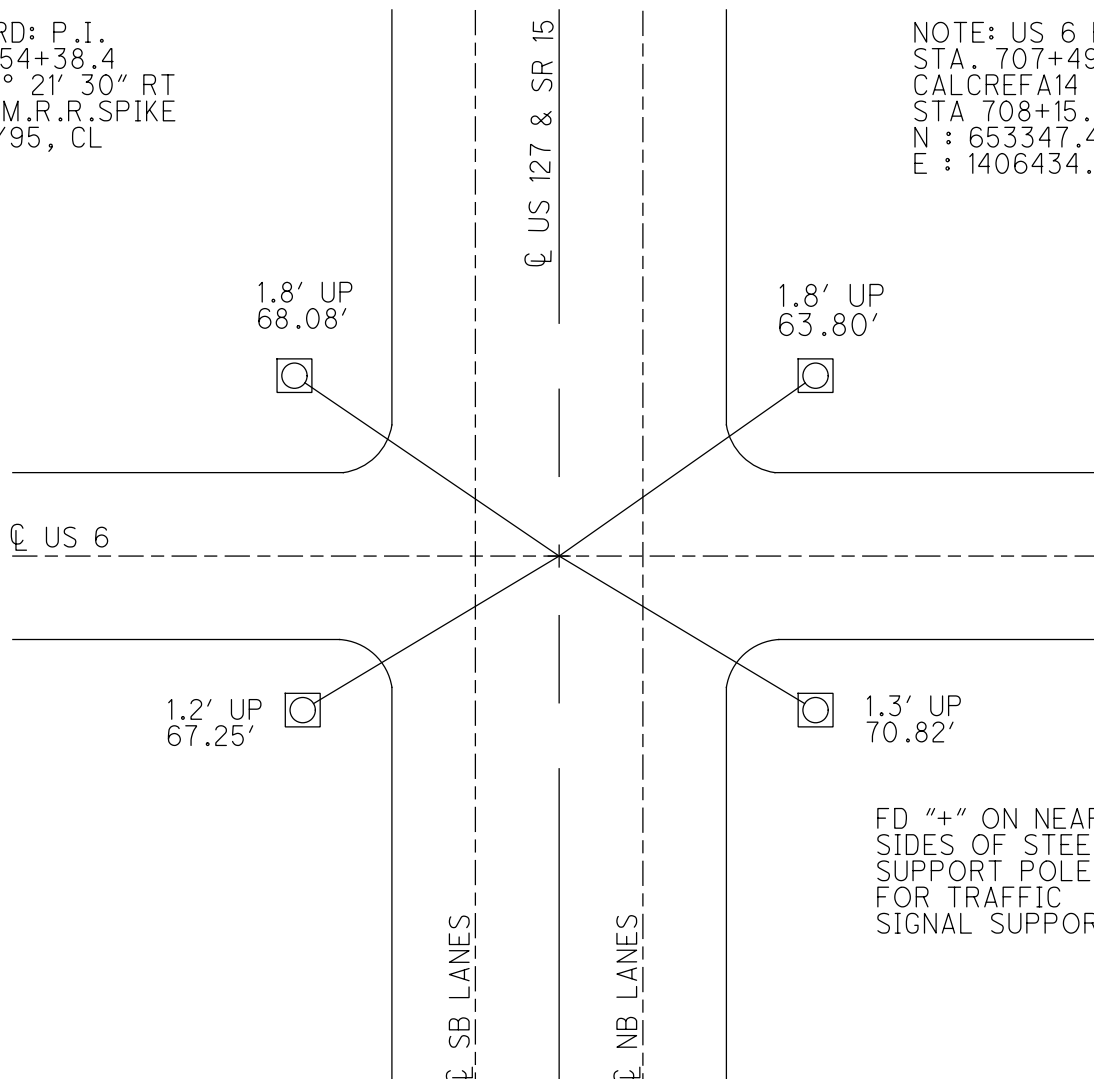

FD "+" ON NEAR  
 SIDES OF STEEL  
 SUPPORT POLES  
 FOR TRAFFIC  
 SIGNAL SUPPORTS

O.D.O.T. DISTRICT 2 SURVEY OFFICE (USE ONLY)

PERSONNEL \_\_\_\_\_ REFERENCE NO. 5 A SHEET 6 OF 9

NOTES HOFFMAN DATE 10/14/99 ROUTE US 127  
 H.C. BARNHISEL WEATHER CLEAR COUNTY WILLIAMS  
 R.C. LOEHRKE TEMP. 46° TOWNSHIP PULASKI  
 \_\_\_\_\_ SECTION 32  
 \_\_\_\_\_ T 6 N R 3 E

TYPE MONUMENT R.R.SPIKE  
 ON SURFACE - ~~BELOW~~ 2"  
 LEFT - CL PAV'T - RIGHT ON  
- TO - EDGE PAVEMENT  
 S.L.M. 54+91.20  
 GRID: NORTHING: - EASTING: -

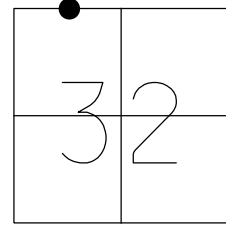

RECORD: P.I.  
 STA, 54+38.4  
 $\Delta = 0^\circ 21' 30''$  RT  
 SET SM.R.R.SPIKE  
 11/23/95, CL

NOTE: US 6 REF 14A  
 STA. 707+49  
 CALCREFA14  
 STA 708+15.85  
 N : 653347.466  
 E : 1406434.450

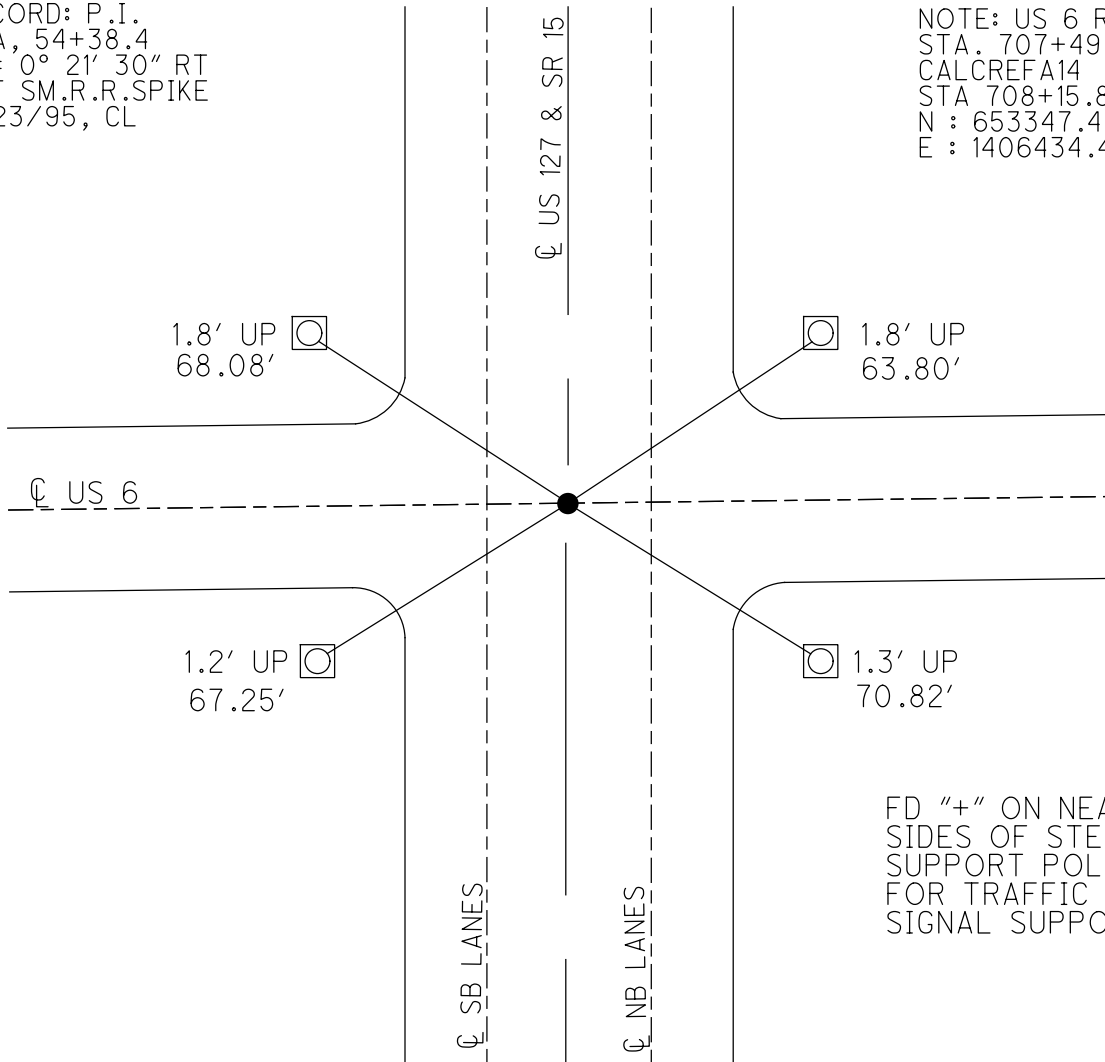

FD "+" ON NEAR  
 SIDES OF STEEL  
 SUPPORT POLES  
 FOR TRAFFIC  
 SIGNAL SUPPORTS