

O.D.O.T. DISTRICT 2 SURVEY OFFICE (USE ONLY)

PERSONNEL

REFERENCE NO. 8

SHEET 9 OF 9

NOTES MAHLER

DATE 7-28-20

ROUTE US 127

H.C. AUBLE

WEATHER SUNNY

COUNTY WILLIAMS

R.C. RHOADES

TEMP. 74°F

TOWNSHIP PULASKI

DWG BY MAHLER PID 101219

SECTION 29

T 6 N R 3 E

TYPE MONUMENT MONBOX W/ 3/4" IPIN

ON SURFACE - ~~BELOW~~ ON

OFFSET ☉ PAVEMENT ON, 3.6' S OF ☉ E LT : RT

- TO - EDGE PAVEMENT

STATION: 107+63

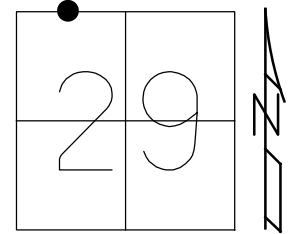

HORZ.DATUM: NAD83 2011

GEOID: NAVD88 2012A

GRID: NORTHING: 658622.035

EASTING: 1406402.254

RECORD:  
FD MONBOX  
6/5/92, MB  
FD MONBOX  
W/ 3/4" IPIN  
REF8  
7-28-20, DSA

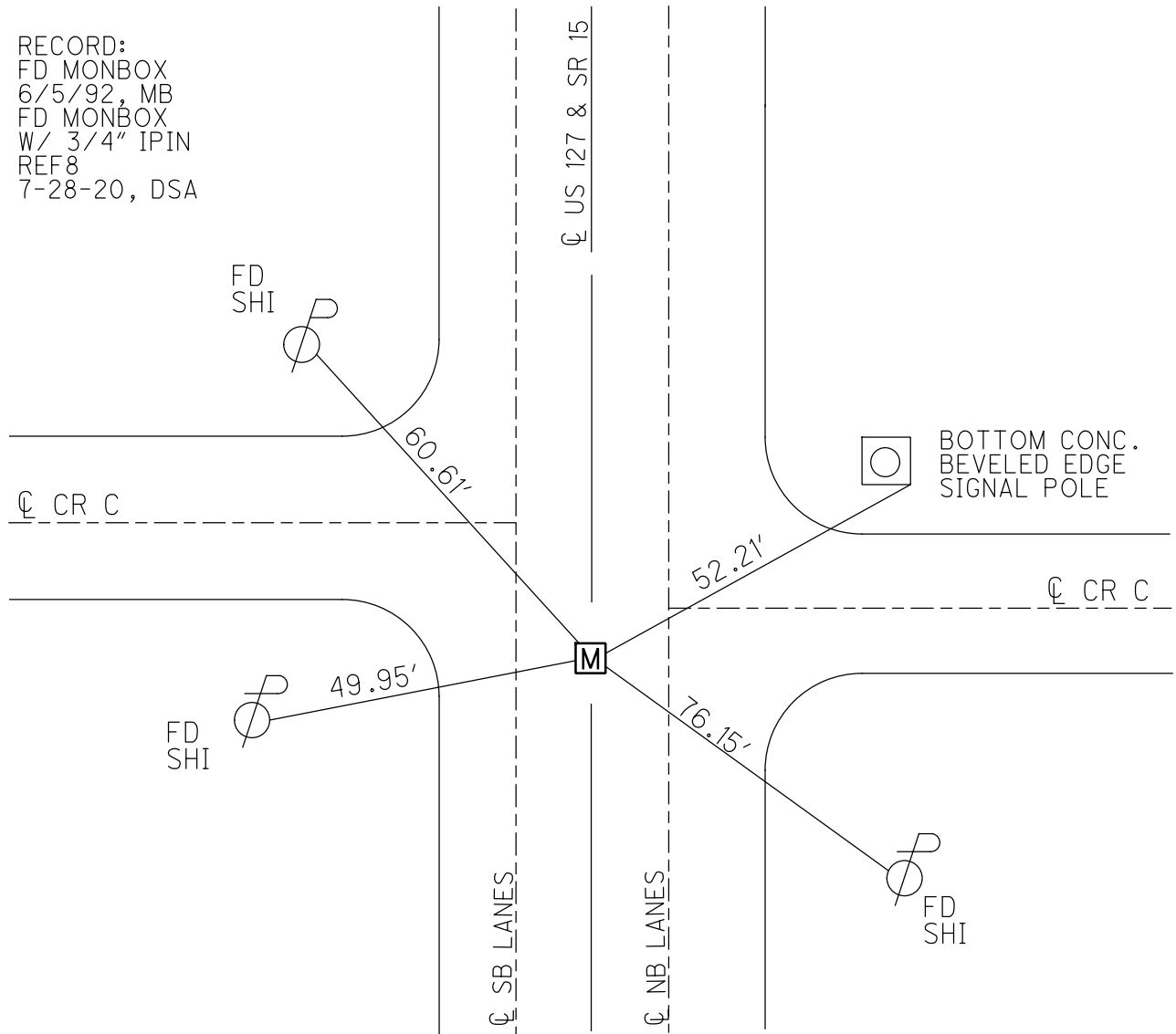

O.D.O.T. DISTRICT 2 SURVEY OFFICE (USE ONLY)

PERSONNEL \_\_\_\_\_ REFERENCE NO. 8 SHEET 9 OF 9  
 NOTES ROUSOS DATE 8/2/2011 ROUTE US 127  
 H.C. HARBUAGH WEATHER CLOUDY COUNTY WILLIAMS  
 R.C. HOMAN TEMP. 82° F TOWNSHIP PULASKI  
 \_\_\_\_\_ SECTION 29  
 \_\_\_\_\_ T 6 N R 3 E

TYPE MONUMENT MONBOX  
 ON SURFACE - ~~BELOW~~ ON  
 LEFT - ☉ PAV'T - RIGHT ON, 3.6' S.OF ☉ EAST  
- TO - EDGE PAVEMENT  
 S.L.M. 107+63  
 GRID: NORTHING: 658621.928 EASTING: 1406402.159

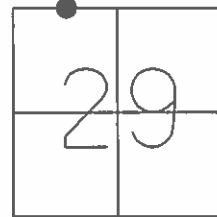

RECORD:  
 FD MONBOX  
 6/5/92, MB

