

O.D.O.T. DISTRICT 2 SURVEY OFFICE (USE ONLY)

PERSONNEL \_\_\_\_\_ REFERENCE NO. 10 C SHEET 1 OF 4  
 NOTES BARNHESEL DATE 6/24/92 ROUTE US 127  
 H.C. VAN DUSEN WEATHER CLOUDY COUNTY WILLIAMS  
 R.C. KUSZ TEMP. 65° TOWNSHIP PULASKI  
 \_\_\_\_\_ BURNETT \_\_\_\_\_ SECTION 17  
 \_\_\_\_\_ T 6 N R 3 E

TYPE MONUMENT MONBOX

ON SURFACE - ~~BELOW~~ ON \_\_\_\_\_

LEFT - ☉ PAV'T - RIGHT ON, 4.5' N OF ☉ W  
 \_\_\_\_\_ TO \_\_\_\_\_ EDGE PAVEMENT

S.L.M. 201+81

Grid: Northing: 668034.635 Easting: 1406556.266

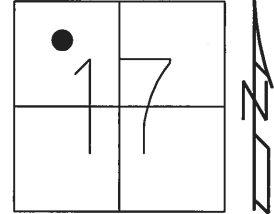

RECORD:  
 FD MONBOX  
 DID NOT OPEN  
 6/24/92, MB  
 FD MONBOX W/IPIN  
 REFA8  
 9/24/13, SDC

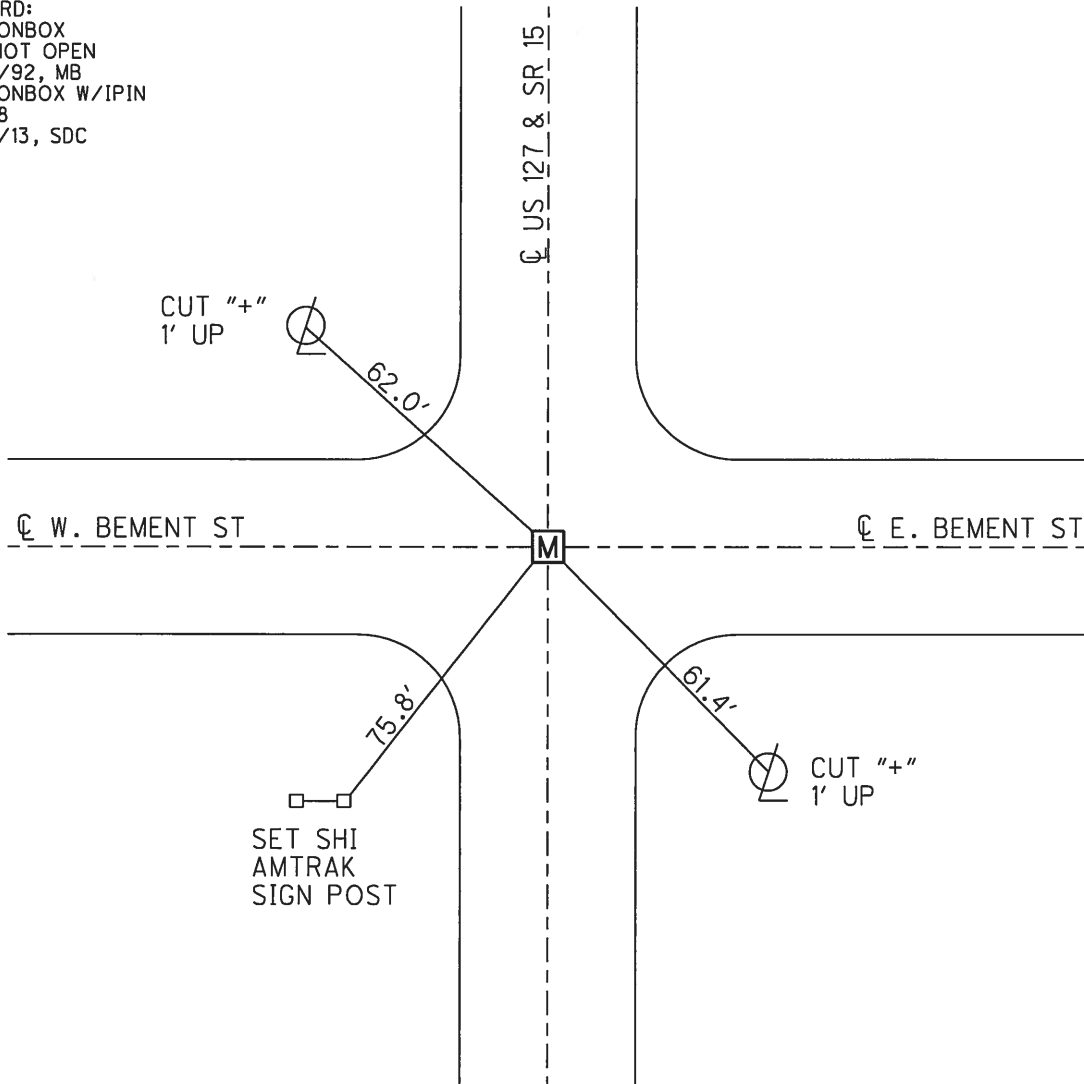

# O.D.O.T. DISTRICT 2 SURVEY OFFICE

PERSONNEL

REFERENCE NO. 10 C

SHEET 20 OF 23

NOTES BARNHISEL

H.C. VAN DUSEN

R.C. KUSZ

BURNETT

DATE 6-24-92

WEATHER cloudy

TEMP. +65°

ROUTE U.S. 127

COUNTY Williams

TOWNSHIP PULASKI

SECTION 17

T. 6 N. R. 3 E.

TYPE MONUMENT Mon. Box

ON SURFACE - ~~BELOW~~ yes

~~LEFT - & PAV'T. - RIGHT~~ yes

- TO - EDGE PAVEMENT

S.L.M. 201 + 81

ON  $\frac{1}{2}$  EAST  
4.5 W. OF  $\frac{1}{2}$  WEST

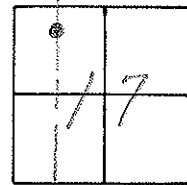

DID NOT OPEN  
MON. BOX

CUT 4" 1' UP  
ON FACE  
SE/S



62.0

& PAV'T W. BEMENT

& PAV'T  
E. BEMENT ST.

75.8

61.4

AM-TRAK  
SCT shi  
E/POST  
NE/S



CUT 4" 1' UP  
ON FACE  
NW/S

S.B. LANES

N.B. LANES

U.S. 127  
+ SR 15

U.S. 127  
+ SR 15