

O.D.O.T. DISTRICT 2 SURVEY OFFICE (USE ONLY)

PERSONNEL _____ REFERENCE NO. 11 SHEET 3 OF 9

NOTES BARNHISEL DATE 6/24/92 ROUTE US 127
 H.C. VAN DUSEN WEATHER CLOUDY COUNTY WILLIAMS
 R.C. KUSZ TEMP. 65° TOWNSHIP PULASKI
BURNETT SECTION 17
 T 6 N R 3 E

TYPE MONUMENT MONBOX

ON SURFACE - ~~BELOW~~ ON

LEFT - ☉ PAV'T - RIGHT ON, 1' N OF ☉ W
27.2' TO RT EDGE PAVEMENT

S.L.M. 214+43

Grid: Northing: 669296.457 Easting: 1406578.769

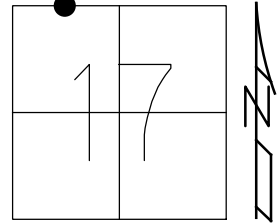

FD MONBOX
 DID NOT OPEN
 6/24/92, MB
 FD MONBOX W/IPIN
 REFA9
 9/24/13, SDC

DIST.11-12= 80.05'

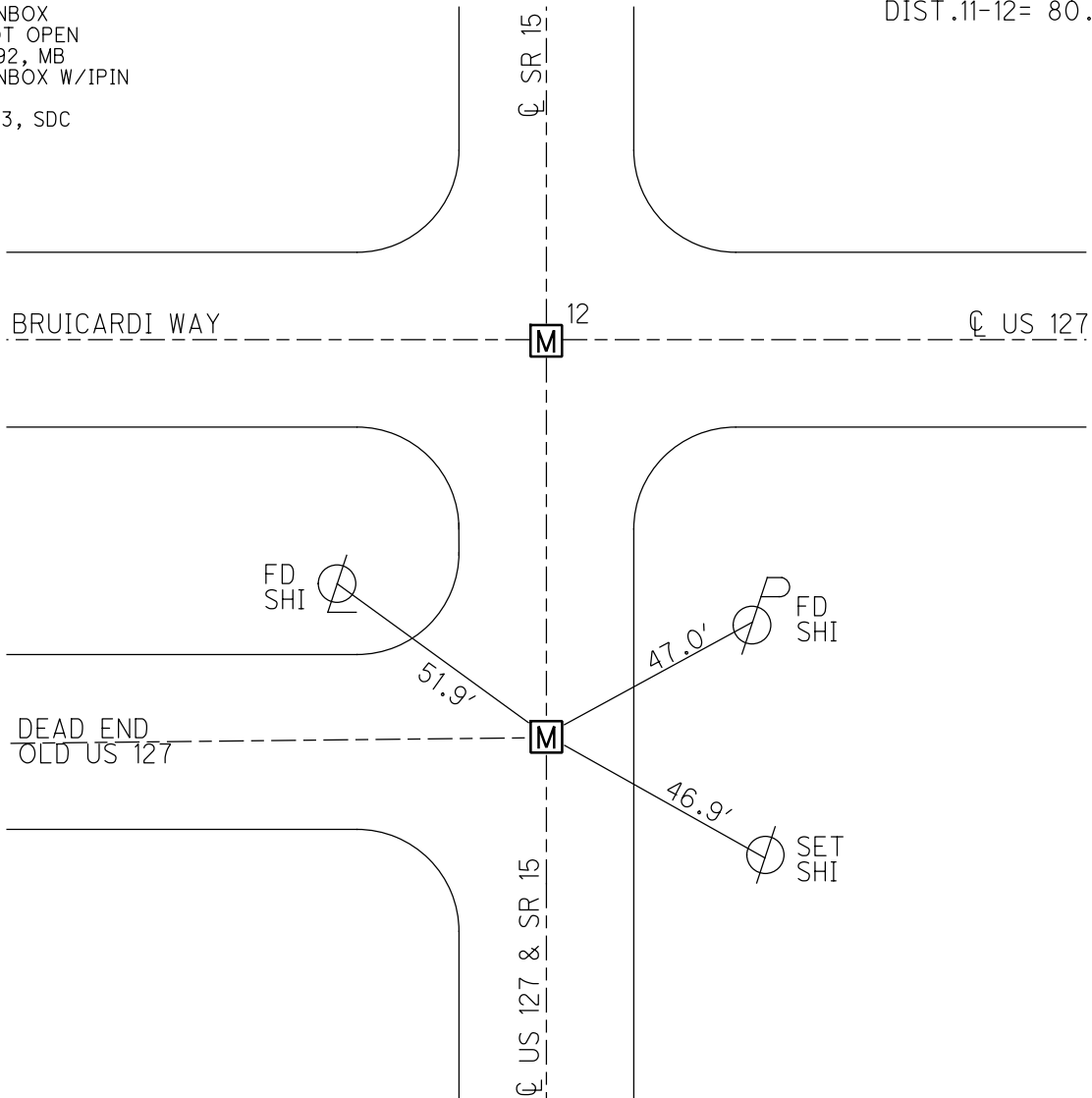

O.D.O.T. DISTRICT 2 SURVEY OFFICE

PERSONNEL

REFERENCE NO. 11

SHEET 22 OF 23

NOTES BARNHISEL

H.C. VAN DUSEN

R.C. KUSZ

BURNETT

DATE 6-24-92

WEATHER SUNNY

TEMP. +68°

ROUTE U.S. 127

COUNTY WILLIAMS

TOWNSHIP PULASKI

SECTION 17

T 6 N R 3 E

TYPE MONUMENT Mon. Box

ON SURFACE - BELOW YES

~~LEFT~~ - C. PAV'T. - RIGHT YES

27.2 TO RT EDGE PAVEMENT

S.L.M. 214+43

1' N. OF E WEST

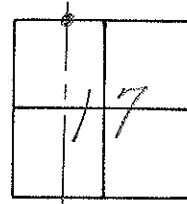

DID NOT OPEN
MON. BOX

U.S. 127
+ SR 15

U.S. 127
+ SR 15

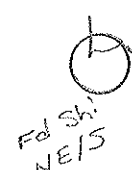

51.9



47.0

E Pav't Co. Rd "E"

46.9



S.B. LANES

N.B. LANES