

O.D.O.T. DISTRICT 2 SURVEY OFFICE (USE ONLY)

PERSONNEL

REFERENCE NO. 12 A

SHEET 5 OF 9

NOTES JAMES

DATE 5/10/19

ROUTE US 127

H.C. O'DONNELL

WEATHER CLOUDY/WINDY

COUNTY WILLIAMS

R.C. MILLER

TEMP. 51°

TOWNSHIP PULASKI

DWG BY NASON PID 102821

SECTION 8

T 6 N R 3 E

TYPE MONUMENT MONBOX/ 1" IPIN

ON SURFACE - ~~BELOW~~ ON

OFFSET Q PAVEMENT 0.9' LT : ~~RT~~

11.8' TO LT. EDGE PAVEMENT

STATION: 237+48.94

HORIZ.DATUM: NAD83(2011)

GEOID: 2012A

GRID: NORTHING: 669338.581

EASTING: 1408713.390

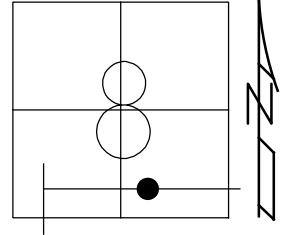

RECORD:
 FD MONBOX
 6/24/92, MB
 FD MONBOX
 W/1" IPIN
 REFA8
 9/24/13, SDC
 FD MONBOX
 W/1" IPIN
 REFA12
 6/5/17
 8/8/19, JFO

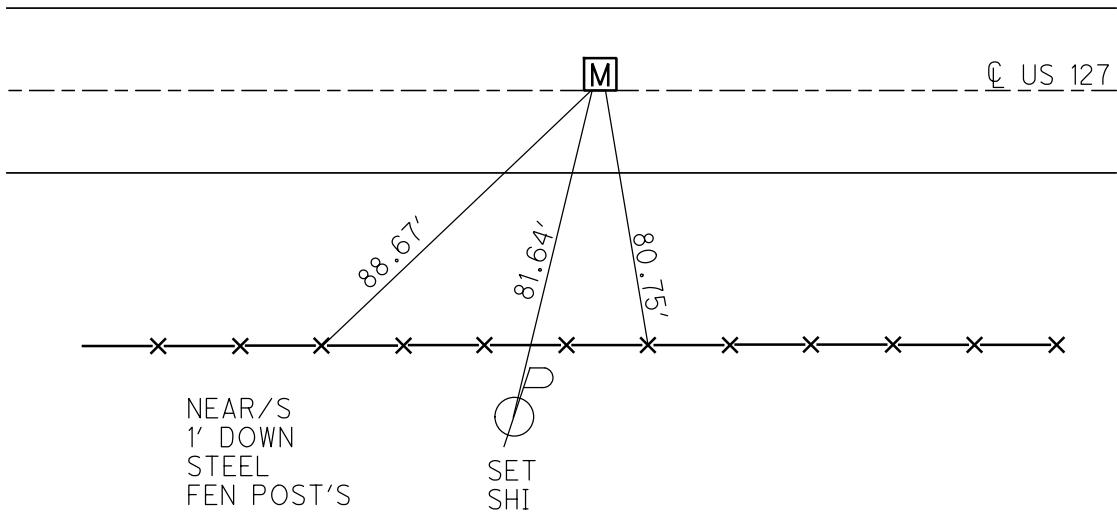

O.D.O.T. DISTRICT 2 SURVEY OFFICE

PERSONNEL

REFERENCE NO. 12-A

SHEET 1 OF 6

NOTES CANTERBURY

H.C. MOSEK

DATE 5-2-00

ROUTE 127

R.C. BARNISEL III

WEATHER SUNNY

COUNTY WILLIAMS

TEMP. +67°

TOWNSHIP PULASKI

SECTION 8

T 6 N R 3 E

TYPE MONUMENT Mon. Box *DID NOT OPEN*

ON SURFACE - BELOW yes

LEFT - & PAV'T. - RIGHT 0.9'

11.8 TO LT. EDGE PAVEMENT

S.L.M. 236+68

