

O.D.O.T. DISTRICT 2 SURVEY OFFICE (USE ONLY)

PERSONNEL _____ REFERENCE NO. 14 SHEET 7 OF 9
 NOTES JAMES DATE 5/10/19 ROUTE US 127
 H.C. O'DONNELL WEATHER SUNNY COUNTY WILLIAMS
 R.C. MILLER TEMP. 52° TOWNSHIP PULASKI
 DWG BY NASON PID 102821 SECTION 9
 T 6 N R 3 E

TYPE MONUMENT MONBOX/ 1" IPIN
 ON SURFACE - ~~BELOW~~ ON _____
 OFFSET \odot PAVEMENT 0.3' ~~LT~~ : RT
12.0' TO RT EDGE PAVEMENT
 STATION: 276+36.57

HORIZ.DATUM: NAD83(2011) GEOID: 2012A
 GRID: NORTHING: 669183.862 EASTING: 1412597.900

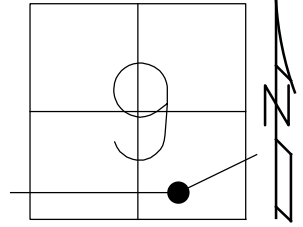

RECORD: P.C.
 FD MONBOX
 REF 14
 6/5/17, JFO
 FD MONBOX
 W/1" IPIN
 REF 14
 5/10/19
 8/8/19, JFO

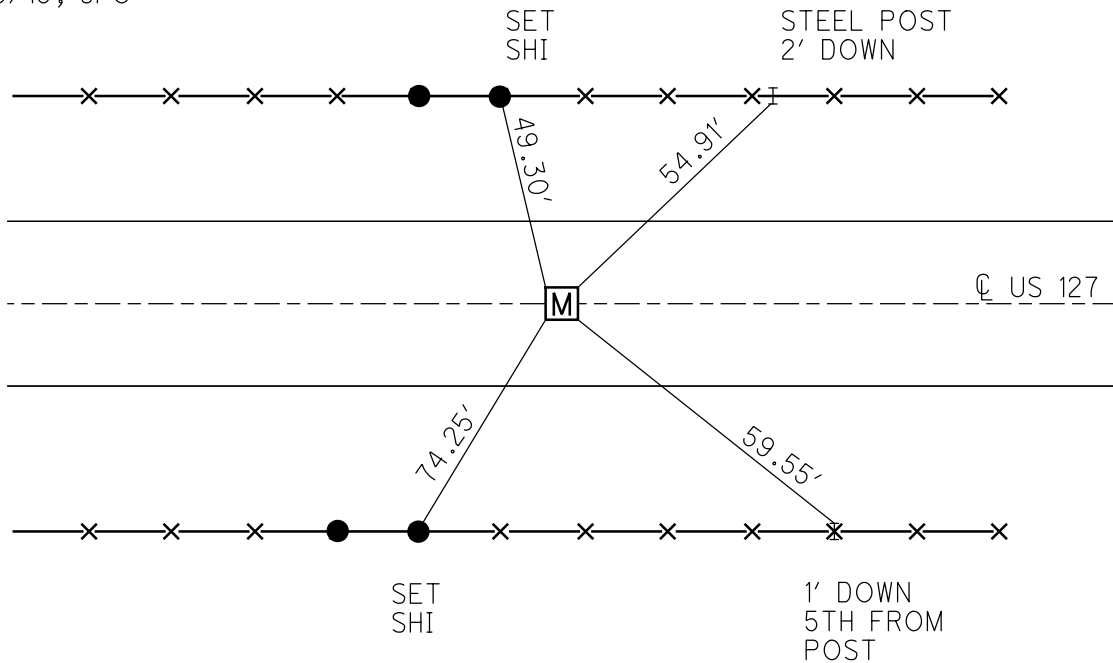

O.D.O.T. DISTRICT 2 SURVEY OFFICE

PERSONNEL

REFERENCE NO. 14

SHEET 3 OF 6

NOTES CANTERBURY

H.C. MOSEK

DATE 5-2-00

ROUTE 127

R.C. BARANISEL III

WEATHER SUNNY

COUNTY WILLIAMS

TEMP. +67°

TOWNSHIP PULASKI

SECTION 9

T 6 N R 3 E

TYPE MONUMENT Mon. Box DID NOT OPEN

ON SURFACE - BELOW yes

LEFT - PAV'T. - RIGHT 0.3'

12.0' TO RT EDGE PAVEMENT

S.L.M. Z75+53

