

O.D.O.T. DISTRICT 2 SURVEY OFFICE (USE ONLY)

PERSONNEL _____ REFERENCE NO. 14 B SHEET 9 OF 9
 NOTES JAMES DATE 5/10/19 ROUTE US 127
 H.C. O'DONNELL WEATHER CLOUDY COUNTY WILLIAMS
 R.C. MILLER TEMP. 53° TOWNSHIP PULASKI
 DWG BY NASON PID 102821 SECTION 9
 T 6 N R 3 E

TYPE MONUMENT MONBOX/ 1" IPIN
 ON SURFACE - ~~BELOW~~ ON
 OFFSET Q PAVEMENT ON LT : RT
12.1' TO RT EDGE PAVEMENT
 STATION: 292+04.31

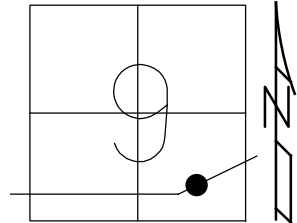

HORIZ.DATUM: NAD83(2011) GEOID: 2012A
 GRID: NORTHING: 669586.974 EASTING: 1414077.481

RECORD:
 FD MONBOX
 REFB14
 6/5/17, JFO
 FD MONBOX
 W/1" IPIN
 BENT
 REFB14
 5/10/19
 8/8/19, JFO

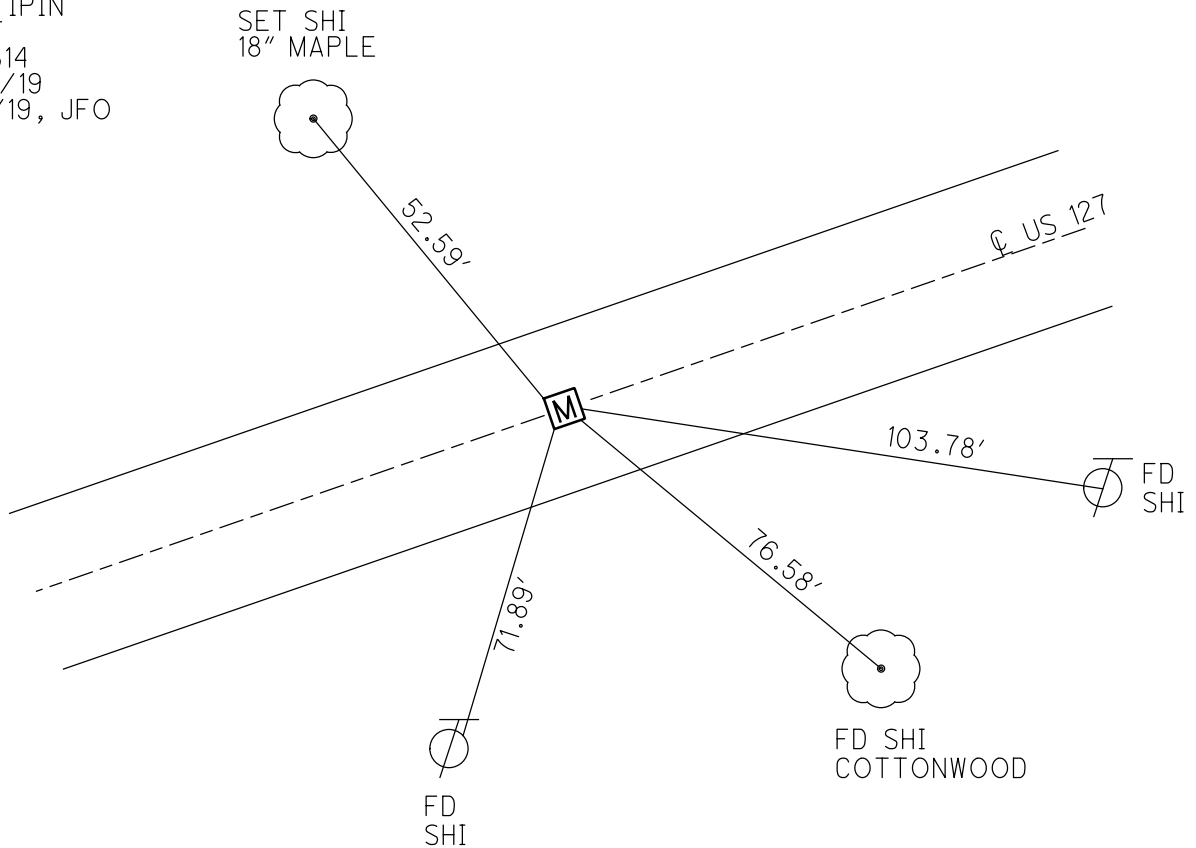

O.D.O.T. DISTRICT 2 SURVEY OFFICE

PERSONNEL

REFERENCE NO. 14-B

SHEET 5 OF 6

NOTES CANTERBURY

H.C. MOSEK

DATE 5-2-00

ROUTE 127

R.C. BARNHISEL III

WEATHER SUNNY

COUNTY WILLIAMS

TEMP. +67°

TOWNSHIP PULASKI

SECTION 9

T. 2 N. R. 3 E.

TYPE MONUMENT Mod. Box DID NOT OPEN

ON SURFACE - ~~BELOW~~ yes

LEFT - & PAV'T. - ~~RIGHT~~ yes

12.1' TO RT EDGE PAVEMENT

S.L.M. 291+21

