

O.D.O.T. DISTRICT 2 SURVEY OFFICE (USE ONLY)

PERSONNEL

REFERENCE NO. 29

SHEET 31 OF 56

NOTES RHOADES

DATE 4/9/19

ROUTE US 127

H.C. O'DONNELL

WEATHER SUNNY/WINDY

COUNTY WILLIAMS

R.C. RHOADES

TEMP. 50°

TOWNSHIP JEFFERSON

DWG BY NASON PID 102821

SECTION 27

T 7 N R 3 E

TYPE MONUMENT MAG/WASHER

ON SURFACE - ~~BELOW~~ ON

OFFSET ☉ PAVEMENT ON LT : RT

9.9' TO LT EDGE PAVEMENT

STATION: 497+66.93

HORZ.DATUM: NAD83(2011)

GEOID: 2012A

GRID: NORTHING: 687315.051

EASTING: 1420844.766

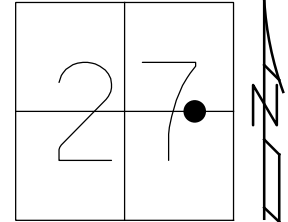

RECORD: P.I.  
 FD SM.R.R.SPIKE  
 6/8/02, MB  
 SET MAG/WASHER  
 8/22/03, MDB  
 FD MAG/WASHER  
 6/15/11  
 SET MAG/WASHER  
 F28  
 2/15/12, SAH  
 FD MAG/WASHER  
 REF29  
 6/7/17, JFO  
 SET MAG/WASHER  
 8/14/19, JFO

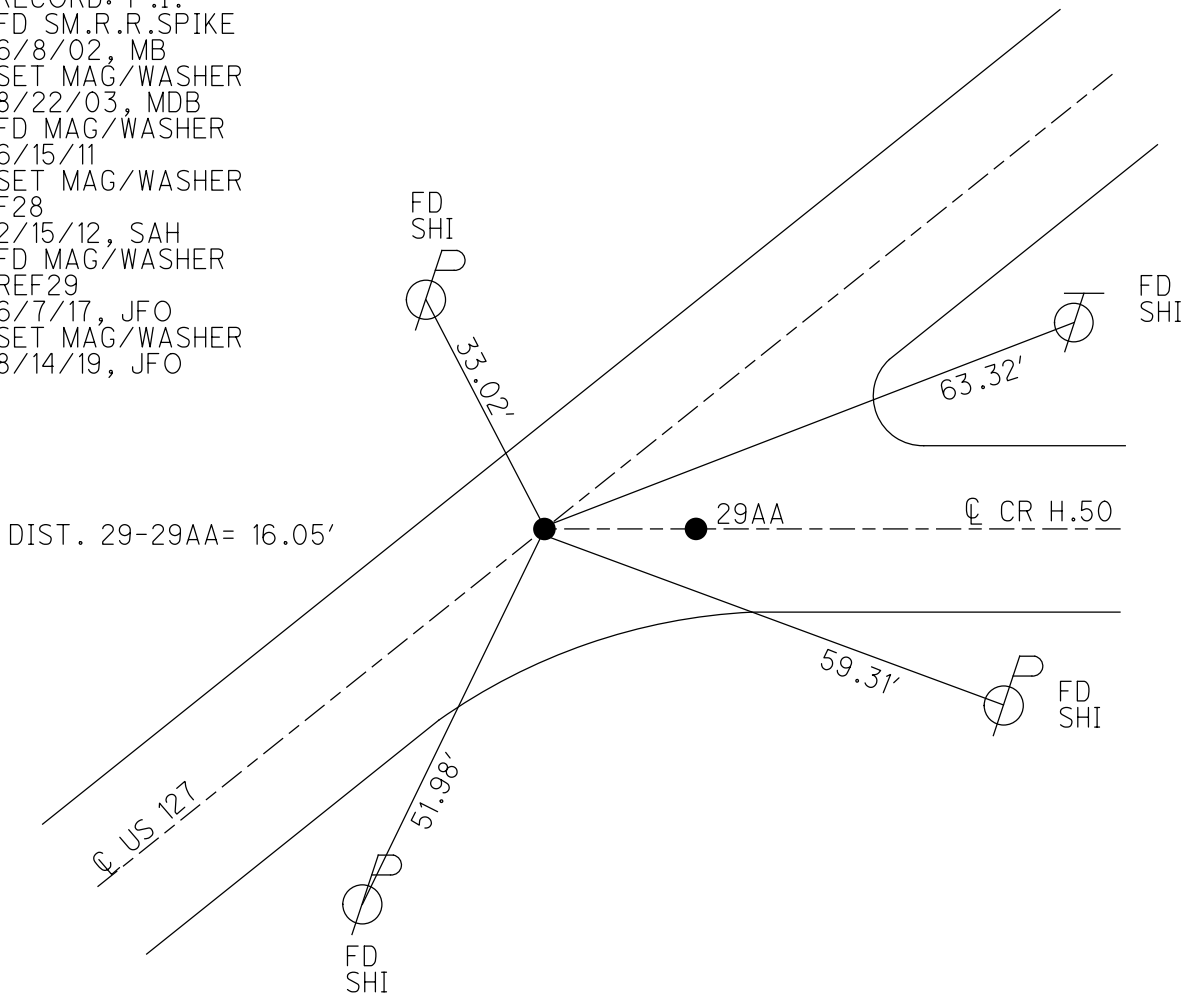

O.D.O.T. DISTRICT 2 SURVEY OFFICE (USE ONLY)

PERSONNEL \_\_\_\_\_ REFERENCE NO. 29 SHEET 31 OF 56  
 NOTES CANTERBURY DATE 6/8/02 ROUTE US 127  
 H.C. BARNHISEL WEATHER SUNNY COUNTY WILLIAMS  
 R.C. MOSER TEMP. 75° TOWNSHIP JEFFERSON  
 \_\_\_\_\_ SECTION 27  
 \_\_\_\_\_ T 7 N R 3 E

TYPE MONUMENT SM.R.R.SPIKE  
~~ON SURFACE~~ - BELOW 2"  
 LEFT - ☉ PAV'T - RIGHT ON  
9.9' TO LT EDGE PAVEMENT  
 S.L.M. 483+86  
 Grid: Northing: 687315.055 Easting: 1420844.703

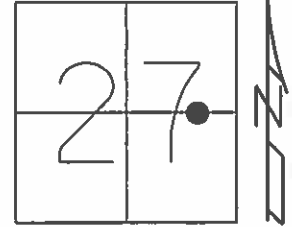

RECORD:  
 SET MAG/WASHER  
 8/22/03, MDB  
 FD MAG/WASHER  
 6/15/11  
 SET MAG/WASHER  
 GPS, F28  
 2/15/12, SAH

