

O.D.O.T. DISTRICT 2 SURVEY OFFICE (USE ONLY)

PERSONNEL \_\_\_\_\_ REFERENCE NO. 30 E SHEET 40 OF 56  
 NOTES RHOADES DATE 4/10/19 ROUTE US 127  
 H.C. O'DONNELL WEATHER SUNNY COUNTY WILLIAMS  
 R.C. RHOADES TEMP. 40° TOWNSHIP JEFFERSON  
 DWG BY NASON PID 102821 SECTION 23  
 T 7 N R 3 E

TYPE MONUMENT MAG/WASHER  
 ON SURFACE - ~~BELOW~~ ON  
 OFFSET 1.0' LT : RT  
12.2' TO RT EDGE PAVEMENT  
 STATION: 545+59.8

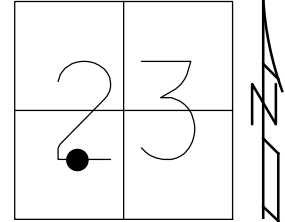

HORZ.DATUM: NAD83(2011) GEOID: 2012A  
 GRID: NORTHING: 691259.666 EASTING: 1423330.817

RECORD: P.I.  
 $\Delta = 24^\circ 29' 05.7$  RT  
 FD SM.R.R.SPIKE  
 6/10/02, KPM  
 SET MAG/WASHER  
 9/15/03, MDB  
 FD MAG/WASHER  
 6/21/11  
 SET MAG/WASHER  
 FE30  
 2/17/12, SAH  
 FD MAG/WASHER  
 REFE30  
 6/8/17, JFO  
 SET MAG/WASHER  
 8/14/19, JFO

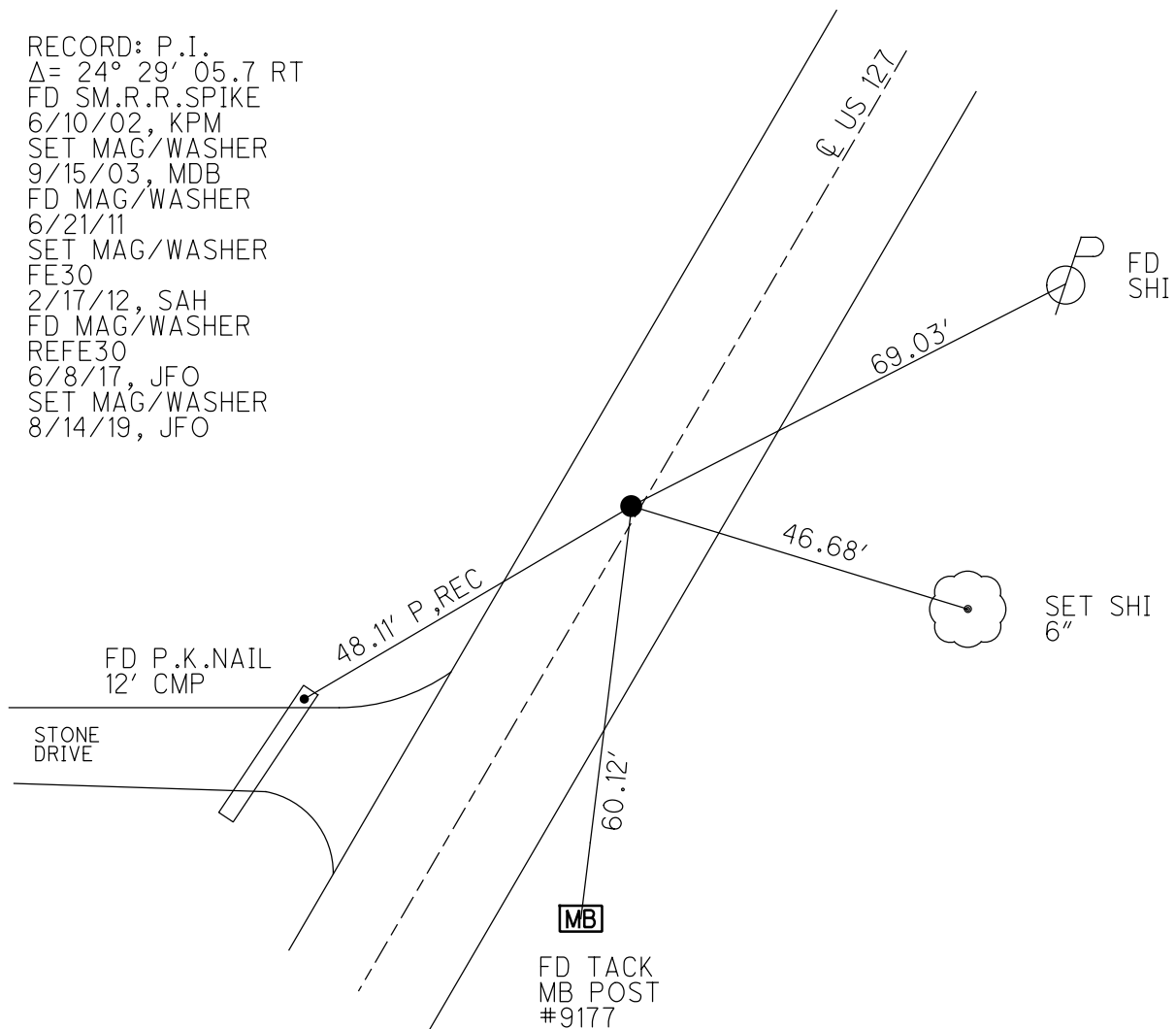

**O.D.O.T. DISTRICT 2 SURVEY OFFICE (USE ONLY)**

PERSONNEL \_\_\_\_\_ REFERENCE NO. 30 E SHEET 40 OF 56  
 NOTES CHLEBECK DATE 6/10/02 ROUTE US 127  
 H.C. MOSER WEATHER SUNNY COUNTY WILLIAMS  
 R.C. SIEFRING TEMP. 85° TOWNSHIP JEFFERSON  
BEAUMONT SECTION 23  
 T 7 N R 3 E

TYPE MONUMENT SM.R.R.SPIKE  
 ON SURFACE - ~~BELOW~~ ON \_\_\_\_\_  
 LEFT - ☉ PAV'T - ~~RIGHT~~ 1.0'  
12.2' TO RT EDGE PAVEMENT  
 S.L.M. 531+80  
 Grid: Northing: 691259.678 Easting: 1423330.697

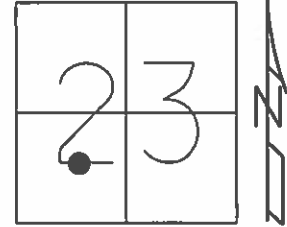

RECORD:  
 SET MAG/WASHER  
 9/15/03, MDB  
 FD MAG/WASHER  
 6/21/11  
 SET MAG/WASHER  
 GPS, FE30  
 2/17/12, SAH

NOTE:  
 POINT IS  
 MID-POINT  
 OF CURVE

