

O.D.O.T. DISTRICT 2 SURVEY OFFICE (USE ONLY)

PERSONNEL _____ REFERENCE NO. 4 M SHEET 14 OF 21
 NOTES O'DONNELL DATE 4/1/16 ROUTE US 20A
 H.C. RHOADES WEATHER CLOUDY COUNTY WILLIAMS
 R.C. O'DONNELL TEMP. 43° TOWNSHIP JEFFERSON
 _____ SECTION 32
 _____ T 8 N R 3 E

TYPE MONUMENT P.K./WASHER
 ON SURFACE - ~~BELOW~~ ON _____
 LEFT - ☉ PAV'T - ~~RIGHT~~ 3.2'
8.6' TO LT EDGE PAVEMENT
 S.L.M. 196+87

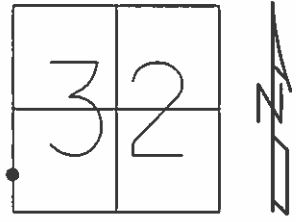

GRID: NORTHING: 711863.739 EASTING: 1406312.385

NOTE:
 SR 15 REF29B

RECORD: P.I.
 FD P.K./WASHER
 7/16/92
 SET P.K./WASHER
 9/22/92, CL
 FD P.K.SHANK
 10/22/13
 REFB29
 10/23/13, TMR
 SET MAG/WASHER
 NEWREFB29
 9/1/16, JFO

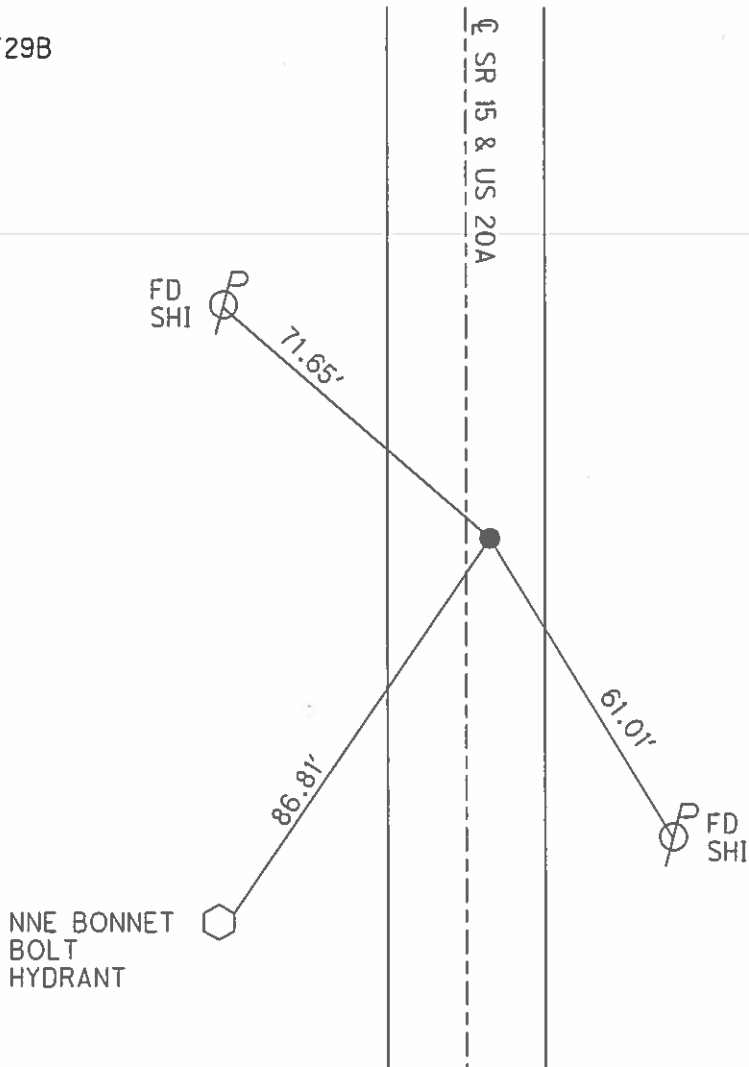

O.D.O.T. DISTRICT 2 SURVEY OFFICE (USE ONLY)

PERSONNEL _____ REFERENCE NO. 29 B SHEET 14 OF 40
 NOTES O'DONNELL DATE 4/1/16 ROUTE SR 15
 H.C. RHOADES WEATHER CLOUDY COUNTY WILLIAMS
 R.C. O'DONNELL TEMP. 43° TOWNSHIP JEFFERSON
 _____ SECTION 32
 _____ T 8 N R 3 E

TYPE MONUMENT P.K./WASHER
 ON SURFACE - ~~BELOW~~ ON _____
 LEFT - ☉ PAV'T - ~~RIGHT~~ 3.2'
8.6' TO LT EDGE PAVEMENT
 S.L.M. 559+23.26

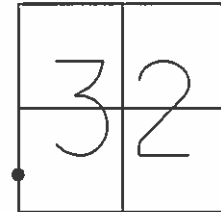

GRID: NORTHING: 711863.739 EASTING: 1406312.385

NOTE:
US 20A REF4M

RECORD: P.I.
 FD P.K./WASHER
 7/16/92
 SET P.K./WASHER
 9/22/92, CL
 FD P.K.SHANK
 10/22/13
 REFB29
 10/23/13, TMR
 SET MAG/WASHER
 NEWREFB29
 9/1/16, JFO

