

O.D.O.T. DISTRICT 2 SURVEY OFFICE (USE ONLY)

PERSONNEL \_\_\_\_\_ REFERENCE NO. 5 SHEET 11 OF 15  
 NOTES ASTON DATE 3/29/24 ROUTE SR 576  
 H.C. RHOADES WEATHER CLEAR COUNTY WILLIAMS  
 R.C. ASTON TEMP. 44° TOWNSHIP CENTER  
 \_\_\_\_\_ SECTION 26  
 DWG BY NIESE PID CHIP SEAL T 6 N R 2 E

TYPE MONUMENT P.K./WASHER  
 ON SURFACE - ~~BELOW~~ \_\_\_\_\_ ON \_\_\_\_\_  
 OFFSET  $\odot$  PAVEMENT 3.5' ~~LT~~ : RT  
6.7' TO RT EDGE PAVEMENT  
 STATION: 79+59

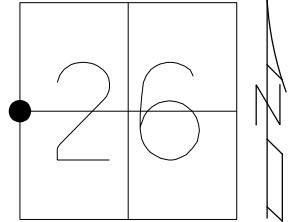

HORIZ.DATUM: NAD83 2011 GEOID: NAVD88 2018  
 GRID: NORTHING: 656237.087 EASTING: 1389448.902

RECORD:  
 SET P.K./WASHER  
 8/24/93, MB  
 FD P.K.NAIL  
 FD LG.R.R.SPIKE  
 3" DOWN  
 7/06/12, DCH  
 SET P.K./WASHER  
 NEWREF10  
 7/26/12, DCH  
 FD P.K./WASHER  
 12/15/20, JFO  
 FD P.K./WASHER  
 REF5  
 6/28/23,  
 3/29/24, JMR

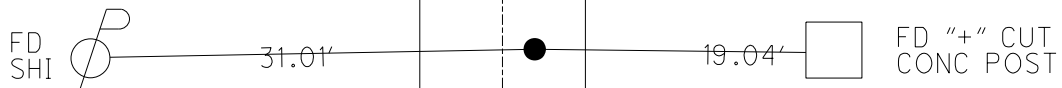

C-SR-576

O.D.O.T. DISTRICT 2 SURVEY OFFICE (USE ONLY)

PERSONNEL \_\_\_\_\_ REFERENCE NO. 5 SHEET 10 OF 14  
 NOTES RHOADES DATE 12/15/20 ROUTE SR 576  
 H.C. \_\_\_\_\_ WEATHER FAIR COUNTY WILLIAMS  
 R.C. \_\_\_\_\_ TEMP. 25° TOWNSHIP CENTER  
 DWG BY NIESE PID NO PID SECTION 26  
 T 6 N R 2 E

TYPE MONUMENT P.K./WASHER  
 ON SURFACE - ~~BELOW~~ \_\_\_\_\_ ON \_\_\_\_\_  
 OFFSET  $\varnothing$  PAVEMENT 3.5' ~~LT~~ : RT  
6.7' TO RT EDGE PAVEMENT  
 STATION: 79+59

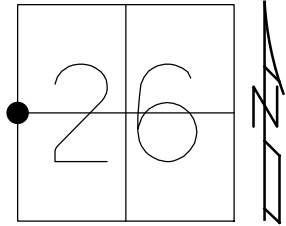

HORIZ.DATUM: NAD83 2011 GEOID: NAVD88 2018  
 GRID: NORTHING: 656237.087 EASTING: 1389448.902

RECORD:  
 SET P.K./WASHER  
 8/24/93, MB  
 FD P.K.NAIL  
 FD LG.R.R.SPIKE  
 3" DOWN  
 7/06/12, DCH  
 SET P.K./WASHER  
 NEWREF10  
 7/26/12, DCH  
 FD P.K./WASHER  
 12/15/20, JMR

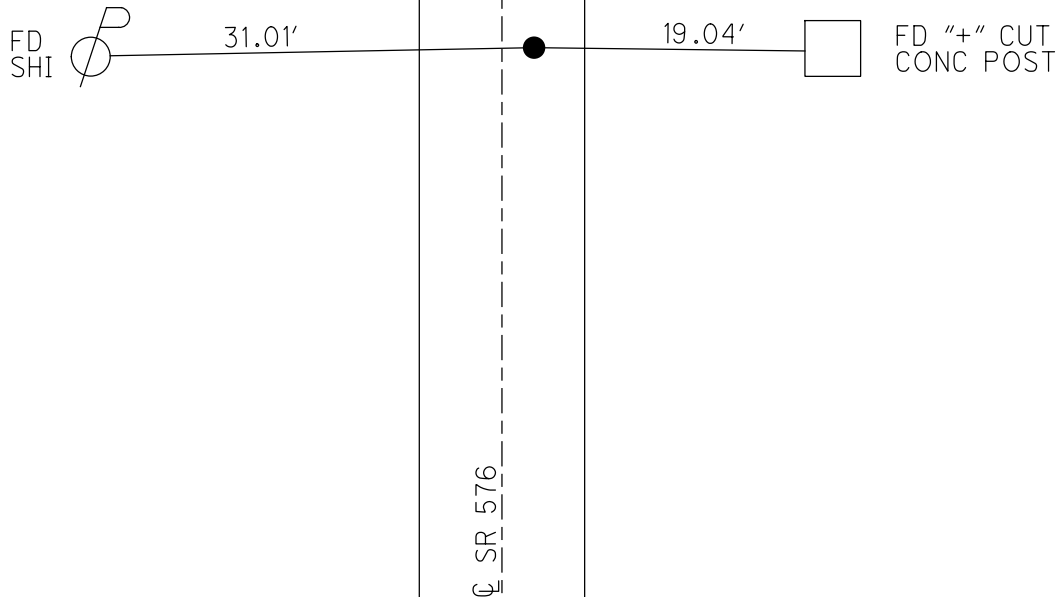

O.D.O.T. DISTRICT 2 SURVEY OFFICE (USE ONLY)

PERSONNEL \_\_\_\_\_ REFERENCE NO. 5 SHEET 10 OF 14  
NOTES HOMAN DATE 7-06-12 ROUTE SR 576  
H.C. HOMAN WEATHER SUNNY COUNTY WILLIAMS  
R.C. HARBAUGH TEMP. 90° TOWNSHIP CENTER  
SECTION 26  
T 6 N R 2 E

TYPE MONUMENT LG RR SPIKE  
~~ON SURFACE~~ - BELOW 3"  
~~LEFT~~ - CL PAV'T - RIGHT 3.5'  
6.7 TO RT EDGE PAVEMENT  
S.L.M. 79+59

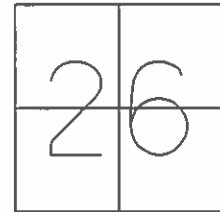

Grid: Northing: 656237.087 Easting: 1389448.902

RESET PK/WASHER  
8-24-93, MB

FD PK  
REF10  
7-06-12, DCH

GPS, NEWREF10  
SET PK/WASHER  
7-26-12, DCH

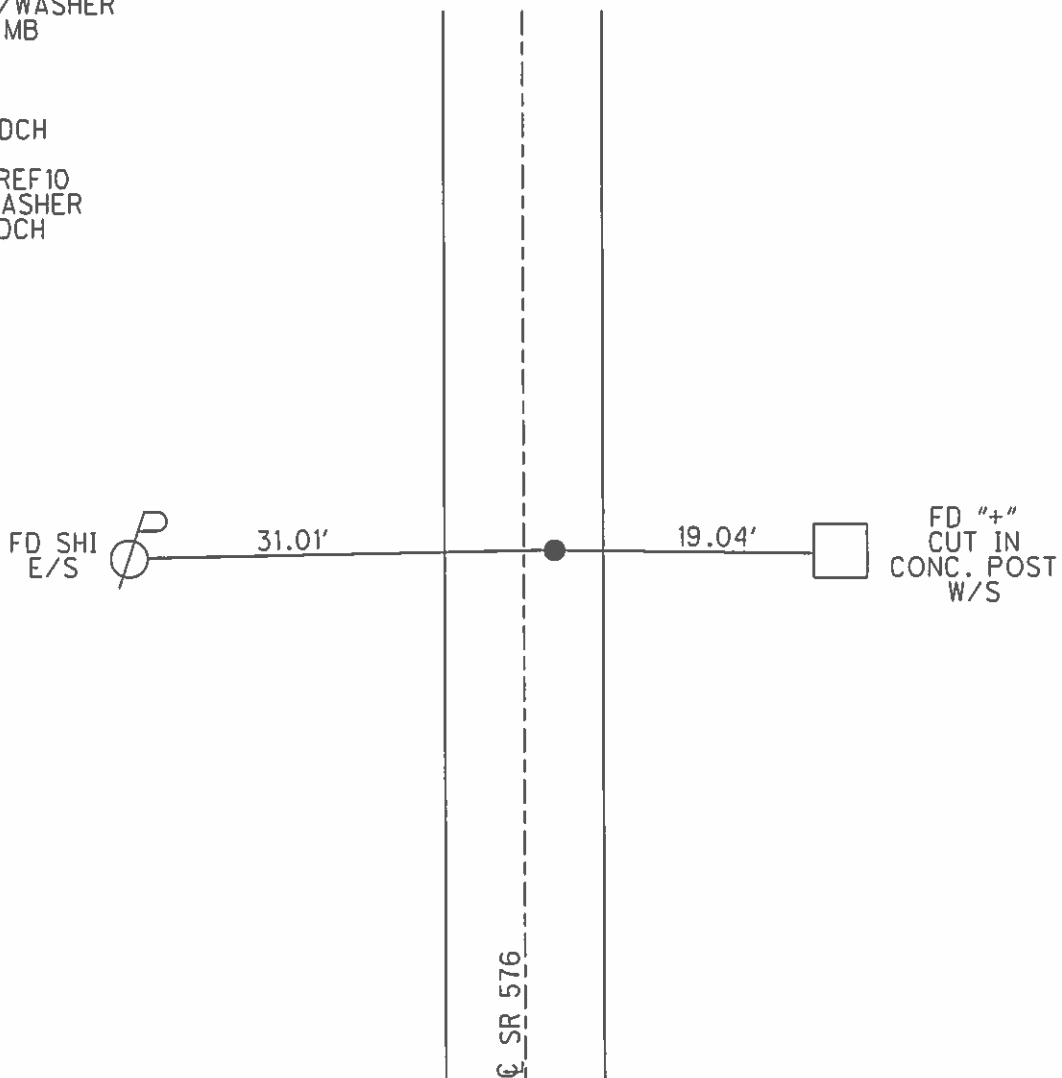

# O.D.O.T. DISTRICT 2 SURVEY OFFICE

PERSONNEL

REFERENCE NO. 5

SHEET 6 OF 16

NOTES BARNHISEL  
 H.C. CORDS  
 R.C. VAN DUSEN  
OTTO

DATE 6-10-93  
 WEATHER CLOUDY  
 TEMP. +60°

ROUTE 576  
 COUNTY WILLIAMS  
 TOWNSHIP CENTER  
 SECTION 26  
T. 6 N R. 2 E

TYPE MONUMENT PK NAIL  
 ON SURFACE - ~~NO~~ YES  
~~LEFT~~ - & PAV'T. - RIGHT 3.5  
4.7 TO RT EDGE PAVEMENT  
 S.L.M. 29+59

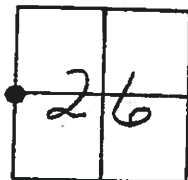

Reset PK & WASHER  
 8-24-93  
 MB

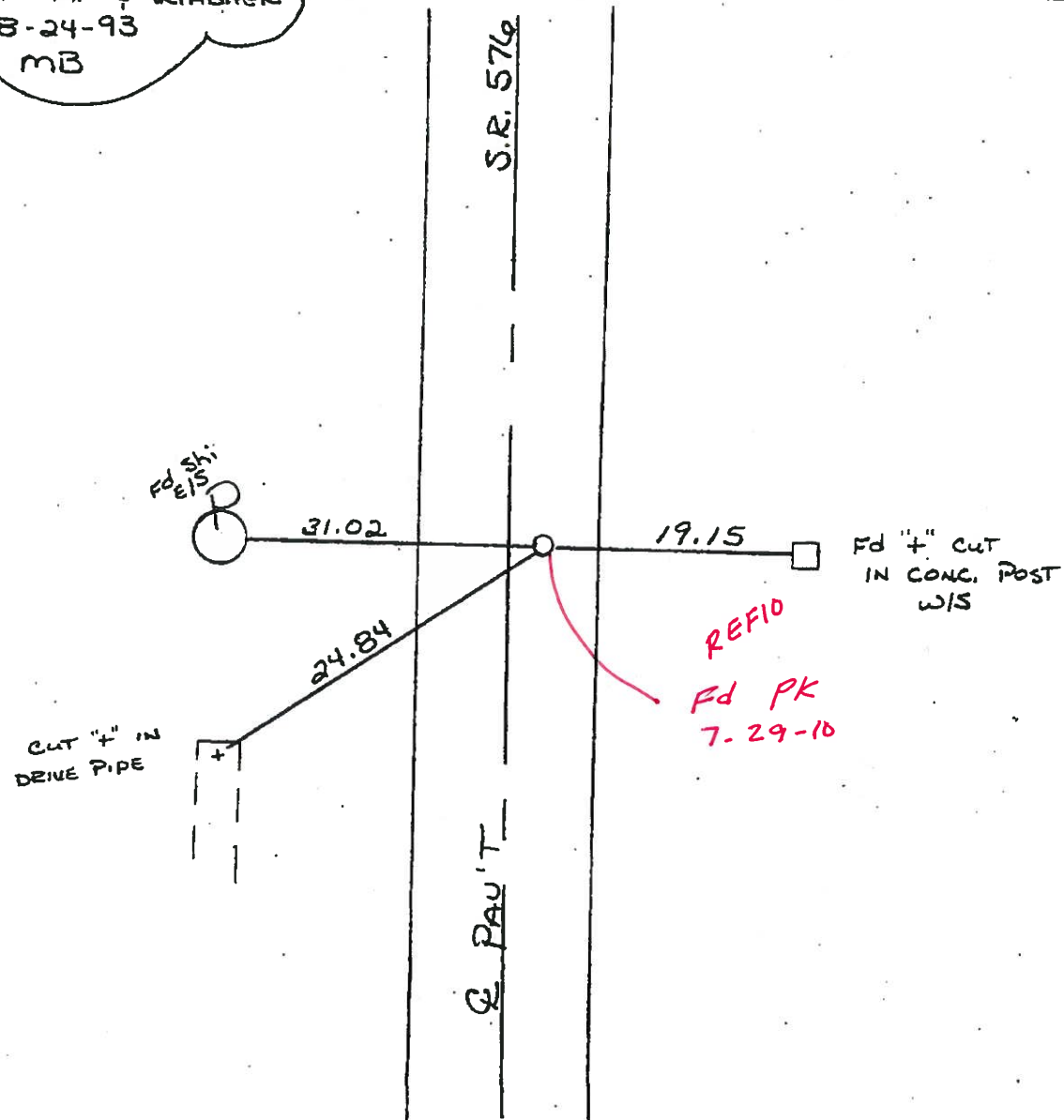

# O.D.O.T. DISTRICT 2 SURVEY OFFICE

PERSONNEL

REFERENCE NO. 5

SHEET 6 OF       

NOTES L. Stone

H.C. D. Curtis

R.C. R. Michelak

J. Householder

DATE 6 Sept. 85

WEATHER Rain

TEMP. 75°

ROUTE SR#576

COUNTY Williams

TOWNSHIP Center

SECTION 26

T        R       

TYPE MONUMENT 1/2" I. Pipe

ON SURFACE - BELOW 3" below

LEFT - ☉ PAV'T. - RIGHT       

       TO        EDGE PAVEMENT

S.L.M. 79+65

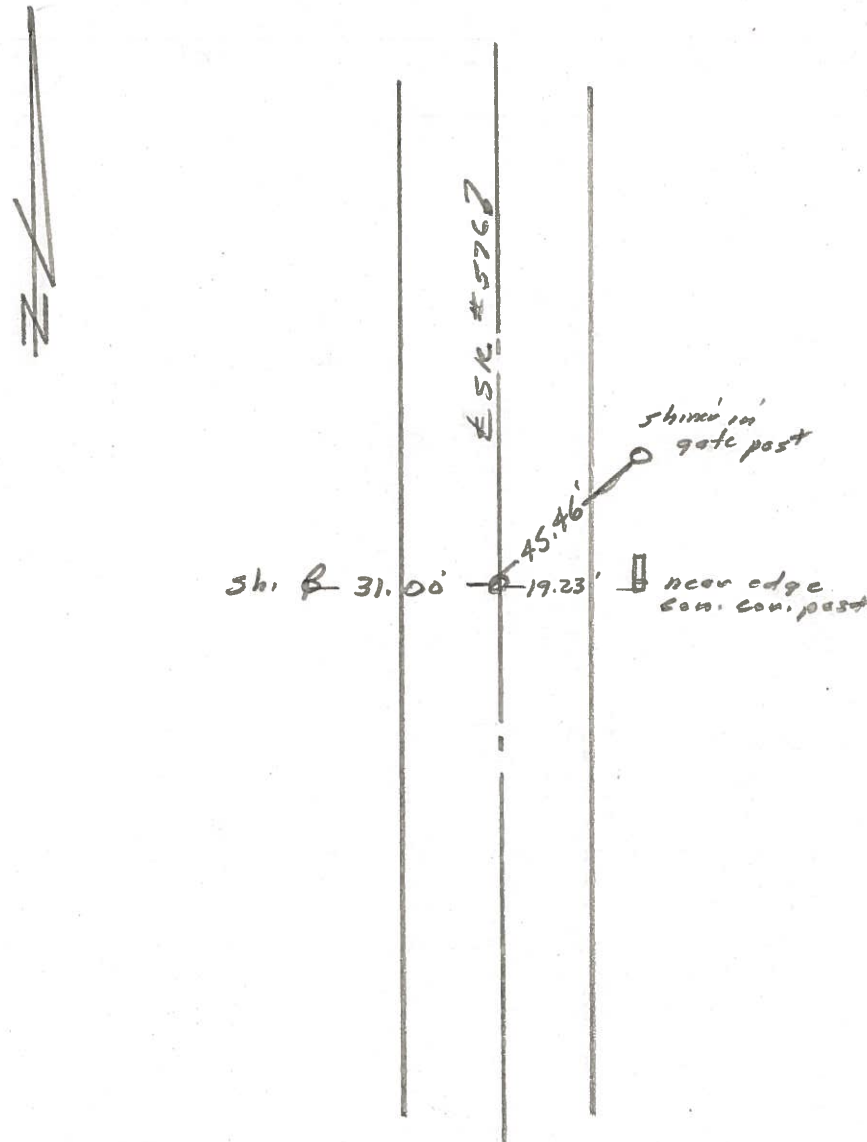
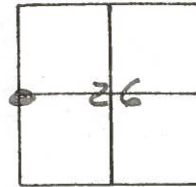

County Williams S.R. 576

Date 18 Aug. 80

Township Center

Weather Fair

Section 26

Temp. 75°

T N, R E

Personnel L. Stone

L. Michalak

P. Neuser

D. Curtis

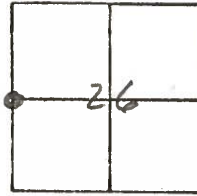

REF. No. **5**

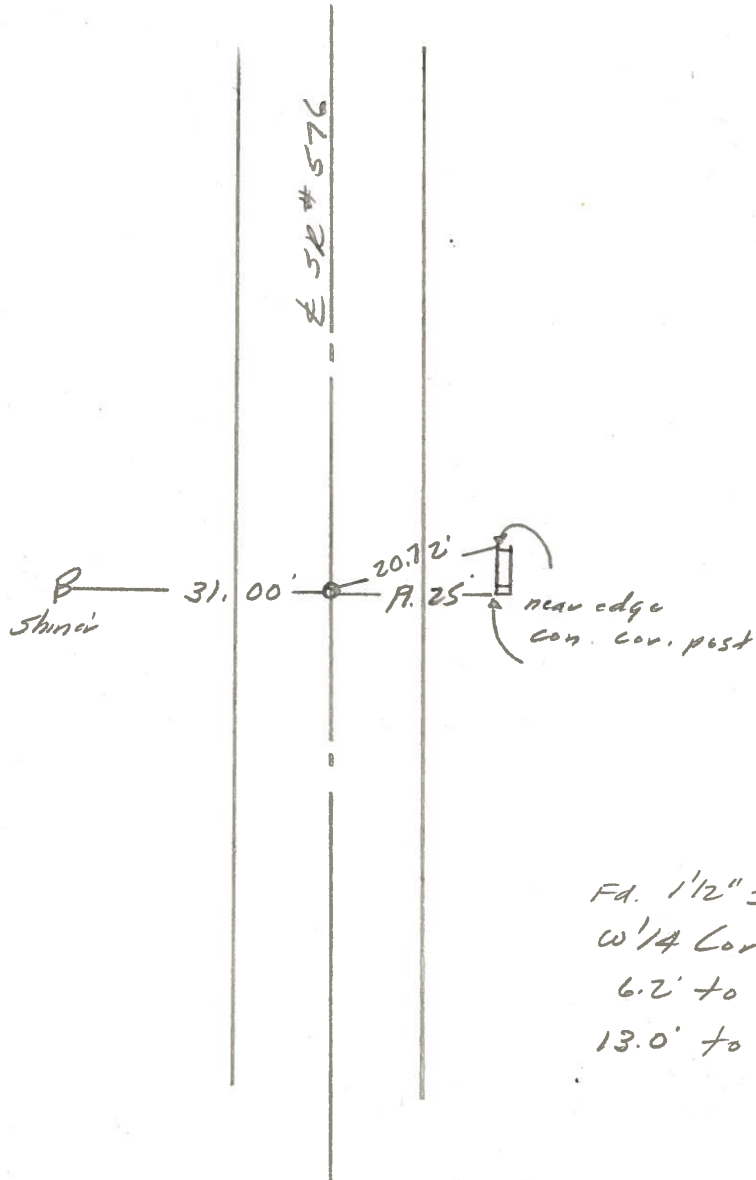

Fd. 1 1/2" I. Pipe To Surface  
w/ 1/4 Cor. Sec. 26  
6.2' to E. edge put  
13.0' to W. edge put.

PERSONNEL	TITLE	PERSONNEL	TITLE	COUNTY	DATE
Louys				Wi.	4-7-50
Hoover				S. R.	576
Beach				SEC.	Defiance Co. Line to Pt. 34
				WEATHER	Fair.
				TEMP.	50°

DESCRIPTION	WITNESSES TO CONTROL POINTS	JOB NO.
	LEFT CENTER LINE RIGHT	

