

O.D.O.T. DISTRICT 2 SURVEY OFFICE (USE ONLY)

PERSONNEL _____

REFERENCE NO. 33

SHEET 1 OF 10

NOTES NIESE

DATE 7-20-21

ROUTE SR 576

H.C. AUBLE

WEATHER SUNNY

COUNTY WILLIAMS

R.C. NIESE

TEMP. 80°

TOWNSHIP BRIDGEWATER

DWG BY GARRETT

PID PAVE TRAIN

SECTION 27

T 9 S R 3 W

TYPE MONUMENT MAG/WASHER

ON SURFACE - ~~BELOW~~ ON

OFFSET Q PAVEMENT ON LT : RT

10.6' TO LT EDGE PAVEMENT

STATION: 900+53

HORZ. DATUM: NAD83 (2011)

GEOID: 18

GRID: NORTHING: 729988.232

EASTING: 1386150.636

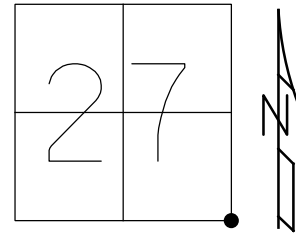

RECORD:
 SET P.K./WASHER
 8-19-02, MDB
 FD P.K./WASHER
 SV133
 5/20/10, SH
 12/15/10, MC
 FD P.K./WASHER
 REF33
 8/7/18, JLL
 FD P.K. WASHER
 REF 33
 7-20-21, DSA
 SET MAG/WASHER
 REF33
 9-15-22, DSA

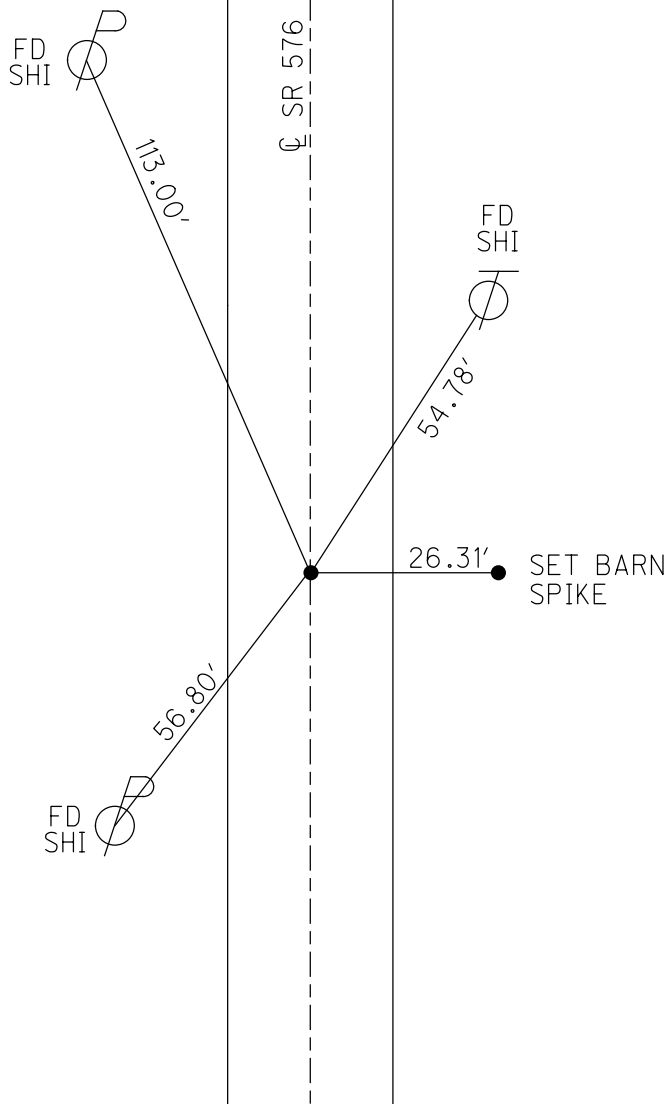

O.D.O.T. DISTRICT 2 SURVEY OFFICE (USE ONLY)

PERSONNEL _____ REFERENCE NO. 33 SHEET 1 OF 9
 NOTES LEU DATE 08/07/18 ROUTE SR 576
 H.C. LEU WEATHER LIGHT MIST COUNTY WILLIAMS
 R.C. HAGEMeyer TEMP. 72 F TOWNSHIP BRIDGEWATER
 _____ SECTION 27
 DWG BY GARRETT PID PAVE TRAIN T 9 S R 3 W

TYPE MONUMENT P.K./WASHER
 ON SURFACE - ~~BELOW~~ ON
 OFFSET \varnothing PAVEMENT ON LT : RT
10.6' TO LT EDGE PAVEMENT
 STATION: 900+53

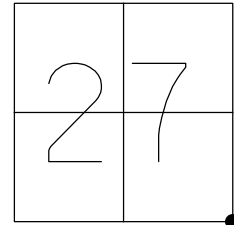

HORIZ.DATUM: NAD83 (2011) GEOID: 2012A
 GRID: NORTHING: 729988.237 EASTING: 1386150.649

RECORD:
 SET P.K./WASHER
 8-19-02, MDB
 SV133
 5/20/10, SH
 CHIPPED OUT POINT
 12/15/10, MC
 FD P.K./WASHER
 REF33
 8/7/18, JLL

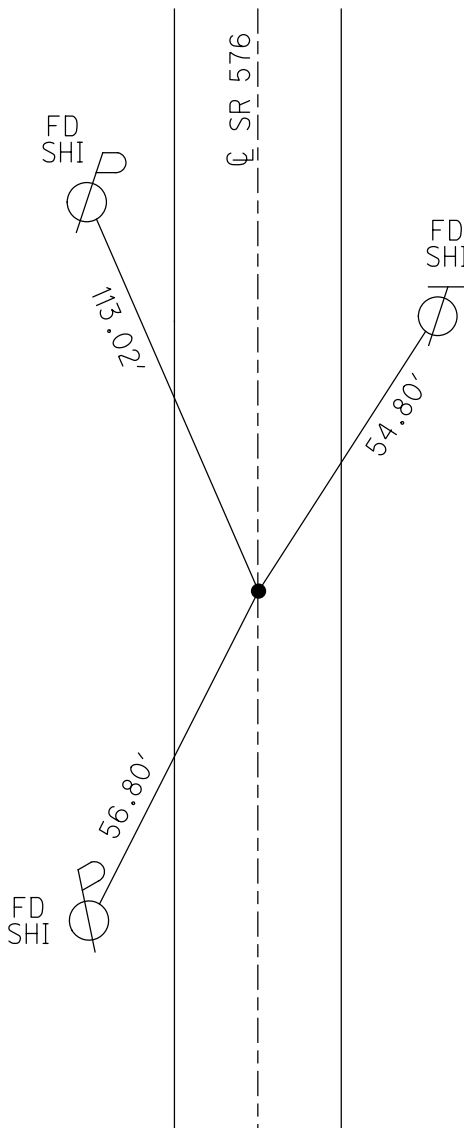

O.D.O.T. DISTRICT 2 SURVEY OFFICE (USE ONLY)

PERSONNEL _____ REFERENCE NO. 33 SHEET 1 OF 9
 NOTES HUSS DATE 5/20/10 ROUTE SR 576
 H.C. HUSS WEATHER SUNNY COUNTY WILLIAMS
 R.C. FINTEL TEMP. 66° TOWNSHIP BRIDGEWATER
 _____ SECTION 27
 _____ T 9 S R 3 W

TYPE MONUMENT P.K./WASHER
 ON SURFACE - ~~BELOW~~ ON _____
 LEFT - ☉ PAV'T - RIGHT ON _____
10.0' TO LT EDGE PAVEMENT
 S.L.M. 900+53
 GRID: NORTHING: 729988.212 EASTING: 1386150.582

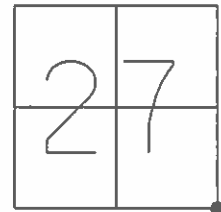

RESET PK & WASHER
 8-19-02 MDB
 GPS SV133
 5/20/10, SH
 CHIPPED OUT POINT
 12/15/10 MC, SH

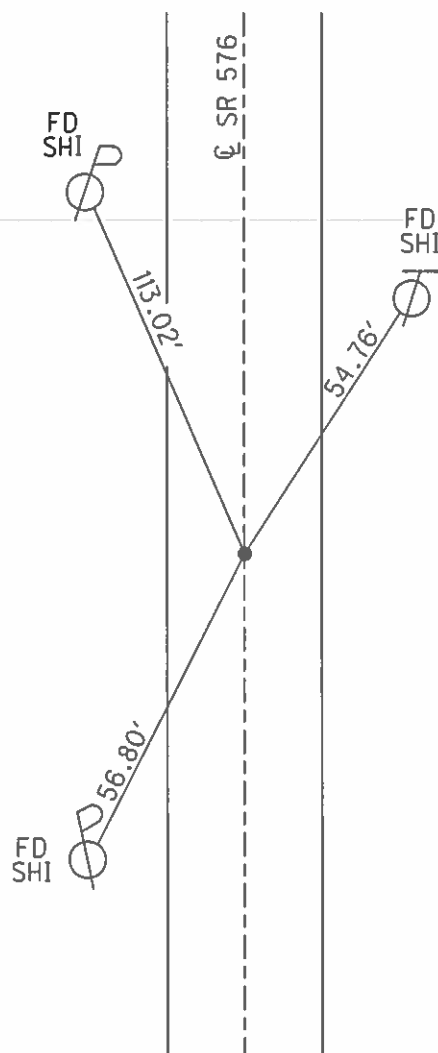

O.D.O.T. DISTRICT 2 SURVEY OFFICE

PERSONNEL

REFERENCE NO. 33

SHEET 1 OF 9

NOTES BARNHISEL

DATE 5-18-02

ROUTE 576

H.C. MOSER

WEATHER CLOUDY

COUNTY WILLIAMS

R.C. BARNHISEL

TEMP. +50°

TOWNSHIP BRIDGEWATER

SECTION 27

T 9 S R 3 W

TYPE MONUMENT LARGE RR SPIKE

~~ON SURFACE~~ - BELOW 3"

~~LEFT - CL PAV'T - RIGHT~~ YES

10.0' TO LT EDGE PAVEMENT

S.L.M. 900+53

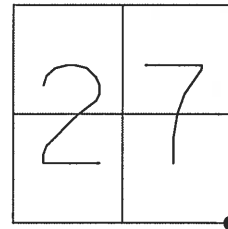

RESET PK & WASHER
8-19-02
MDB

