

O.D.O.T. DISTRICT 2 SURVEY OFFICE (USE ONLY)

PERSONNEL

REFERENCE NO. 39 A

SHEET 9 OF 10

NOTES NIESE
 H.C. AUBLE
 R.C. NIESE

DATE 7-20-21
 WEATHER FAIR
 TEMP. 71°

ROUTE SR 576
 COUNTY WILLIAMS
 TOWNSHIP BRIDGEWATER
 SECTION 10
T 9 S R 3 W

DWG BY RHOADES PID 99575

TYPE MONUMENT MAG/WASHER

ON SURFACE - ~~BELOW~~ ON

OFFSET C PAVEMENT 1.3' LT : ~~RT~~
9.5' TO LT EDGE PAVEMENT

STATION: 1083+29

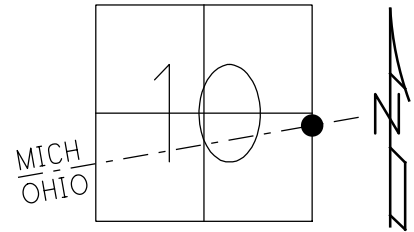

HORIZ.DATUM: NAD83 (2011)

GEOID: NAVD88 2018

GRID: NORTHING: 748224.390

EASTING: 1386554.421

RECORD:
 SET P.K./WASHER
 8/19/02, MDB
 FD P.K./WASHER
 SVA139
 5/17/10, SH
 12/15/10, MC
 FD MAG/WASHER
 REFA39
 1/11/21, JFO
 FD P.K./WASHER
 REF34A
 7/20/21, DSA
 SET MAG/WASHER
 REF34A
 9/15/22, DSA

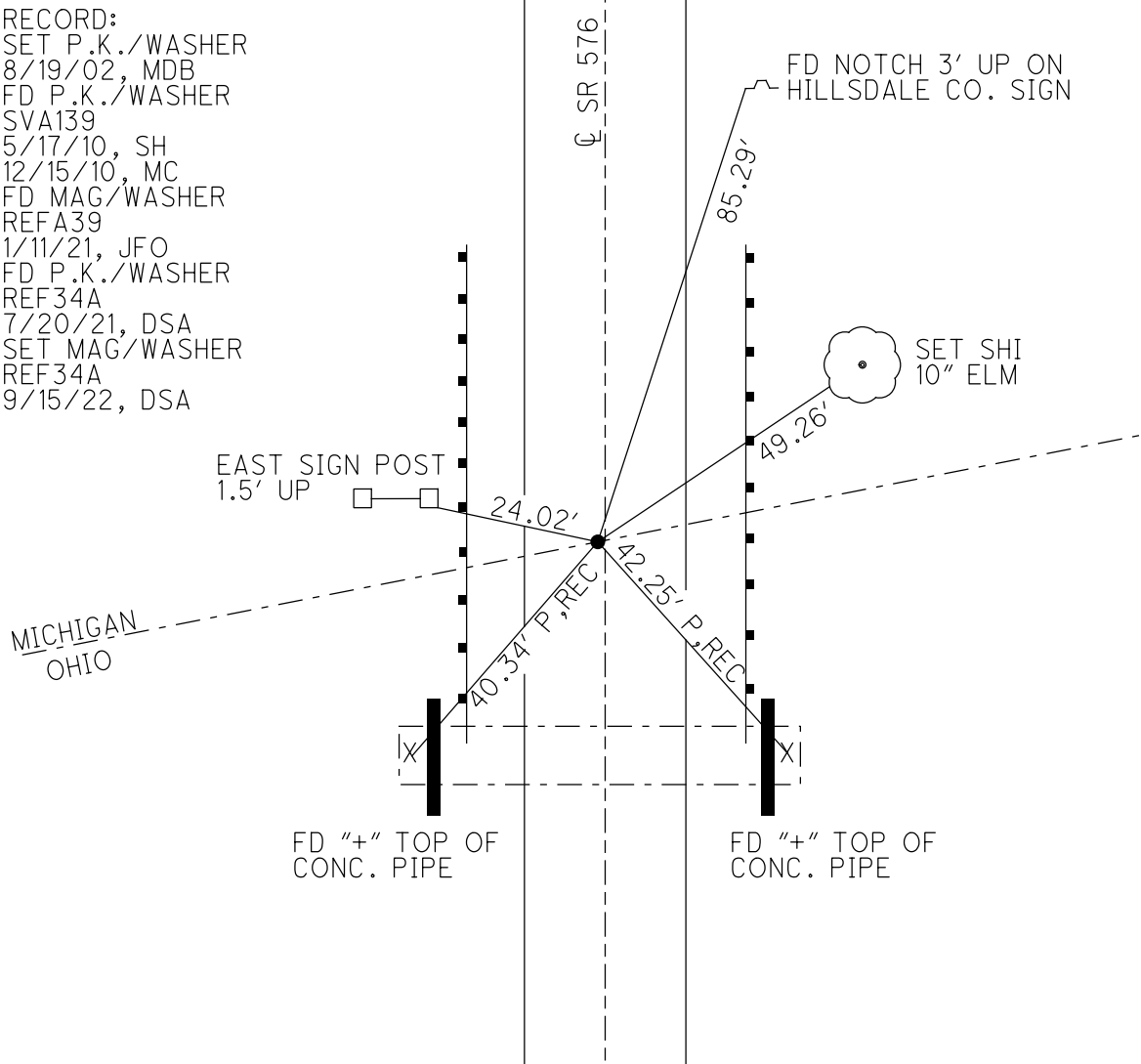

O.D.O.T. DISTRICT 2 SURVEY OFFICE (USE ONLY)

PERSONNEL

REFERENCE NO. 39 A

SHEET 9 OF 9

NOTES HUSS

DATE 5/17/10

ROUTE SR 576

H.C. CANTERBURY

WEATHER CLOUDY

COUNTY WILLIAMS

R.C. FINTEL

TEMP. 58°

TOWNSHIP BRIDGEWATER

SECTION 10

DWG BY NIESE

PID 101348

T 9 S R 3 W

TYPE MONUMENT P.K.NAIL

ON SURFACE - ~~BELOW~~ ON

OFFSET CL PAVEMENT 1.3' ~~LT~~ : RT

9.5' TO LT EDGE PAVEMENT

STATION: 1083+29

HORIZ.DATUM: NAD83(2011)

GEOID: 2018

GRID: NORTHING: 748224.382

EASTING: 1386554.439

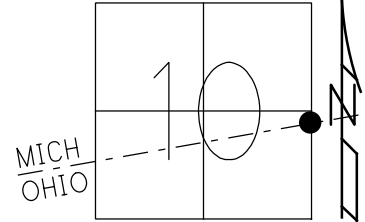

RESET PK & WASHER
8/19/02, MDB
GPS SVA139
5/17/10, SH
CHIPPED OUT POINT
12/15/10, MC
FD MAG/WASHER
REFA39
1/11/21, JFO

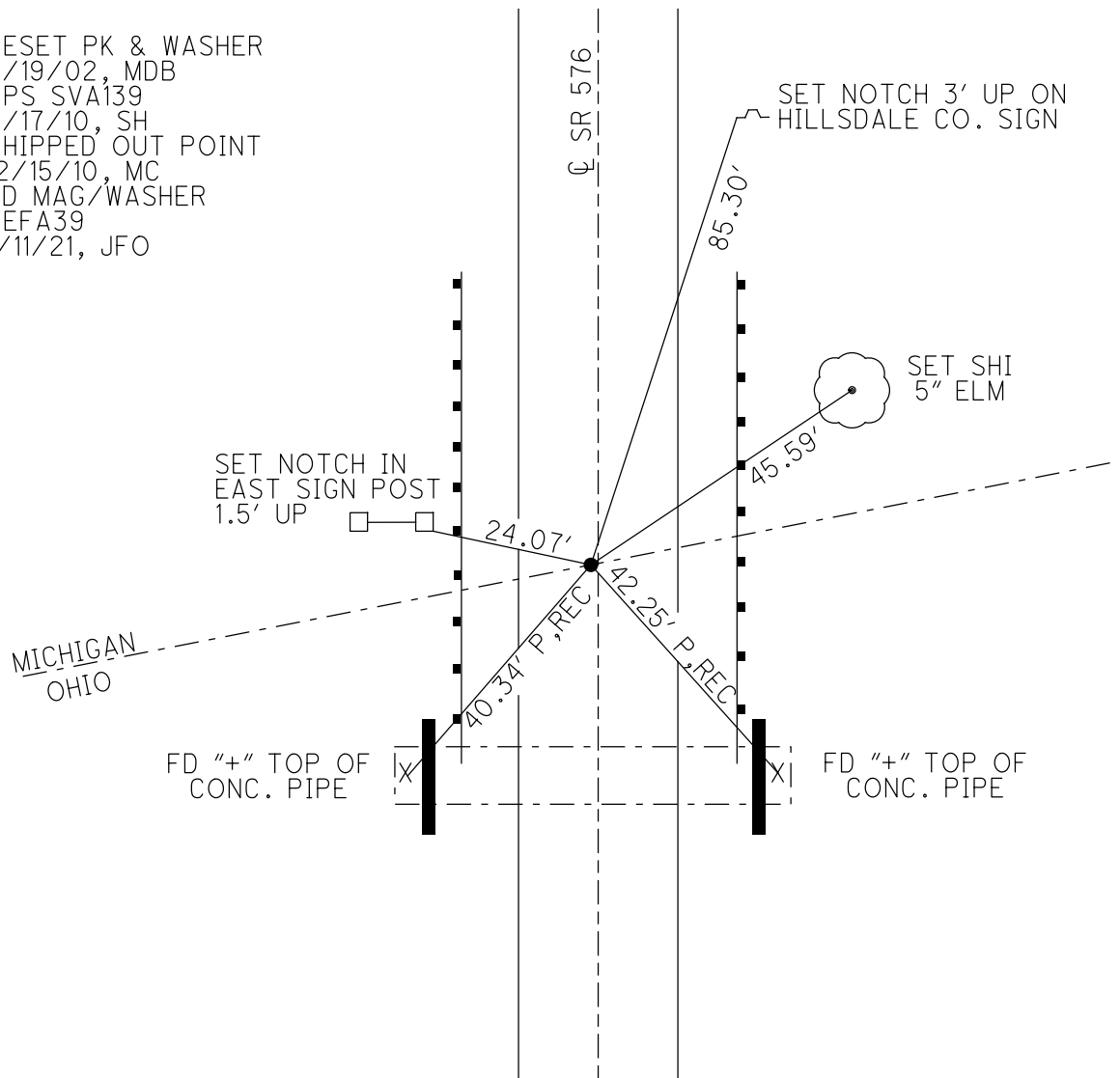

O.D.O.T. DISTRICT 2 SURVEY OFFICE (USE ONLY)

PERSONNEL _____ REFERENCE NO. 39 A SHEET 9 OF 9
 NOTES HUSS DATE 5/17/10 ROUTE SR 576
 H.C. CANTERBURY WEATHER CLOUDY COUNTY WILLIAMS
 R.C. FINTEL TEMP. 58° TOWNSHIP BRIDGEWATER
 SECTION 10
T 9 S R 3 W

TYPE MONUMENT P.K.NAIL
 ON SURFACE - ~~BELOW~~ ON _____
~~LEFT~~ - ℄ PAV'T - RIGHT 1.3'
9.5' TOLT EDGE PAVEMENT
 S.L.M. 1083+29

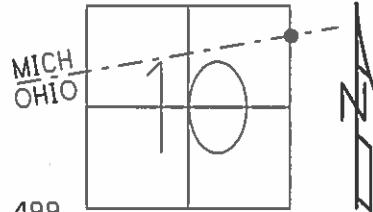

GRID: NORTHING: 748224.448 EASTING: 1386554.499

RESET PK & WASHER
 8-19-02 MDB

GPS SVA139
 5/17/10, SH

CHIPPED OUT POINT
 12/15/10, MC

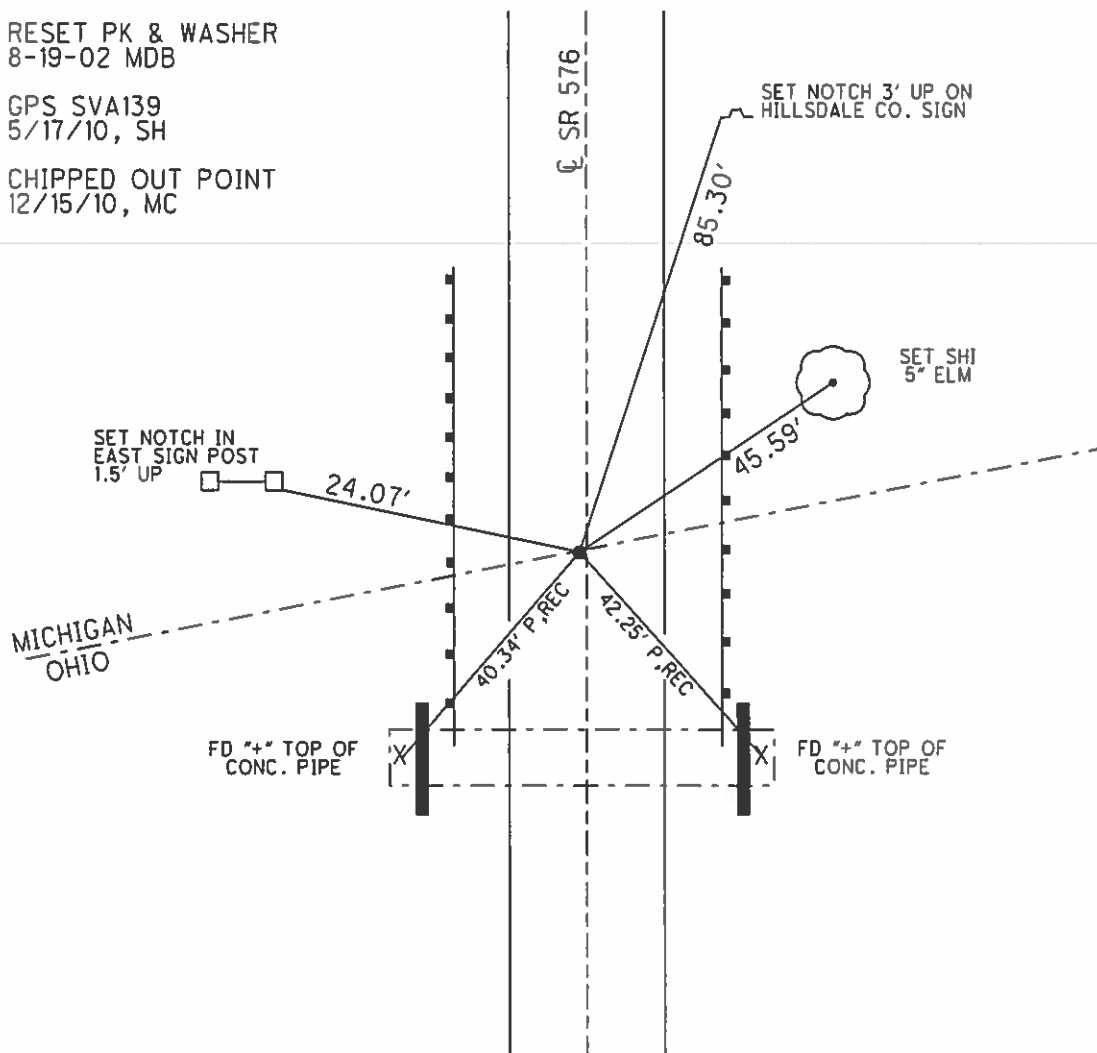

O.D.O.T. DISTRICT 2 SURVEY OFFICE

PERSONNEL

REFERENCE NO. 39-A

SHEET 9 OF 9

NOTES BARNHISEL

DATE 5-18-02

ROUTE 576

H.C. MOSER

WEATHER CLOUDY

COUNTY WILLIAMS

R.C. BARNHISEL

TEMP. +50°

TOWNSHIP BRIDGEWATER

SECTION 10

T 9 S R 3 W

TYPE MONUMENT PK NAIL

~~ON SURFACE~~ - BELOW 1"

~~LEFT~~ - CL PAV'T - RIGHT 1.3'

9.3' TO LT EDGE PAVEMENT

S.L.M. 1083+29

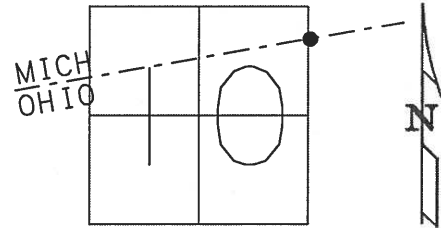

RESET PK & WASHER
8-19-02
MDB

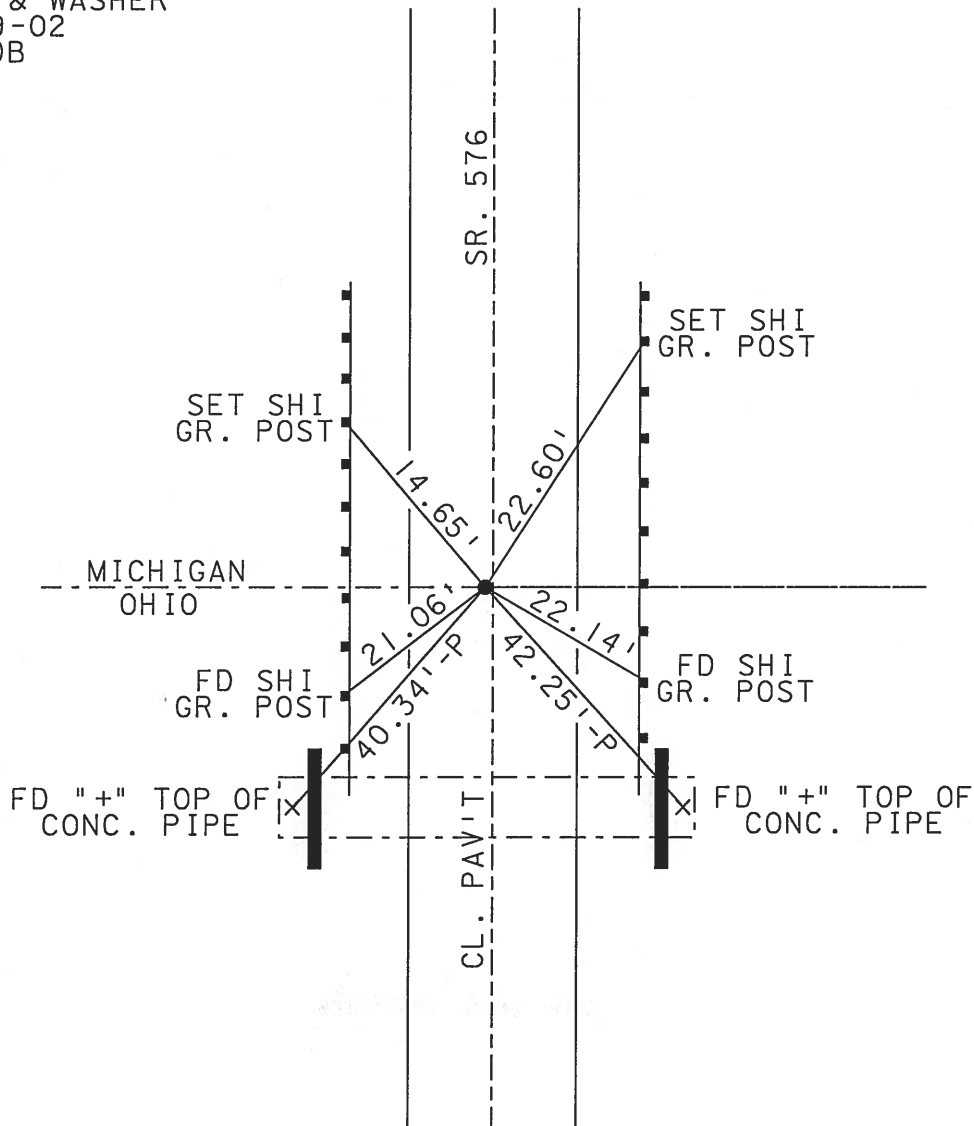

O.D.O.T. DISTRICT 2 SURVEY OFFICE

PERSONNEL

REFERENCE NO. 39-A SHEET 8 OF

NOTES 1. Stone

H.C. D. Curtis

R.C. E. bicu

DATE 8 May 90

WEATHER Mild

TEMP. 720

ROUTE SR#576

COUNTY Williams

TOWNSHIP Bridgewater

SECTION

T R

TYPE MONUMENT PK Nail

ON SURFACE - BELOW Surface

LEFT- & PAV'T. - RIGHT

 TO EDGE PAVEMENT

S.L.M. 1082 + 935

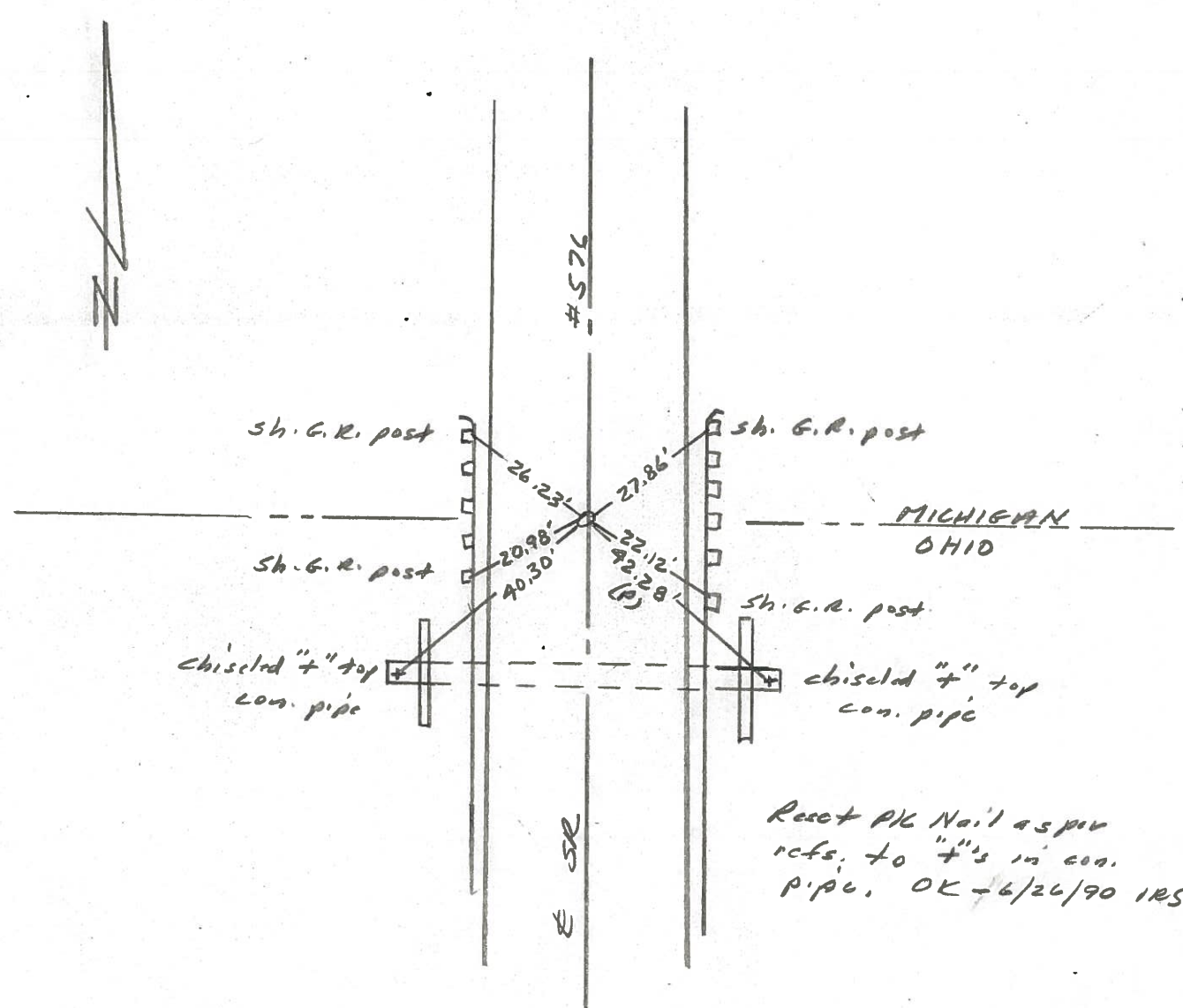
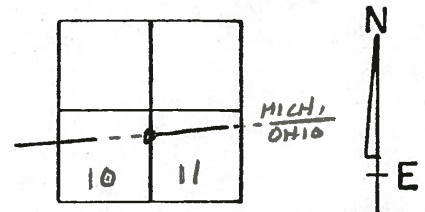

County Williams S.R. 576

Township BRIDGEWATER

Section 10-11

T^S9N, R^W3E

Personnel HOFFMAN

HOUSEHOLDER

LOHRKE

BARNHISEL

39-A

Date December 16, 1982

Weather Partly Clear

Temp. +37°

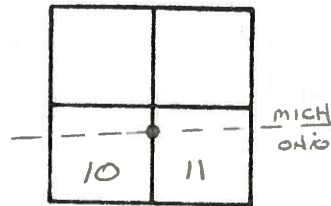

Fd R.R. spk 2" Below Surface

9.9' TO LT. F.P.

10.3' TO RT. F.P.

STA 209+11.66 P.O.T. (Record)

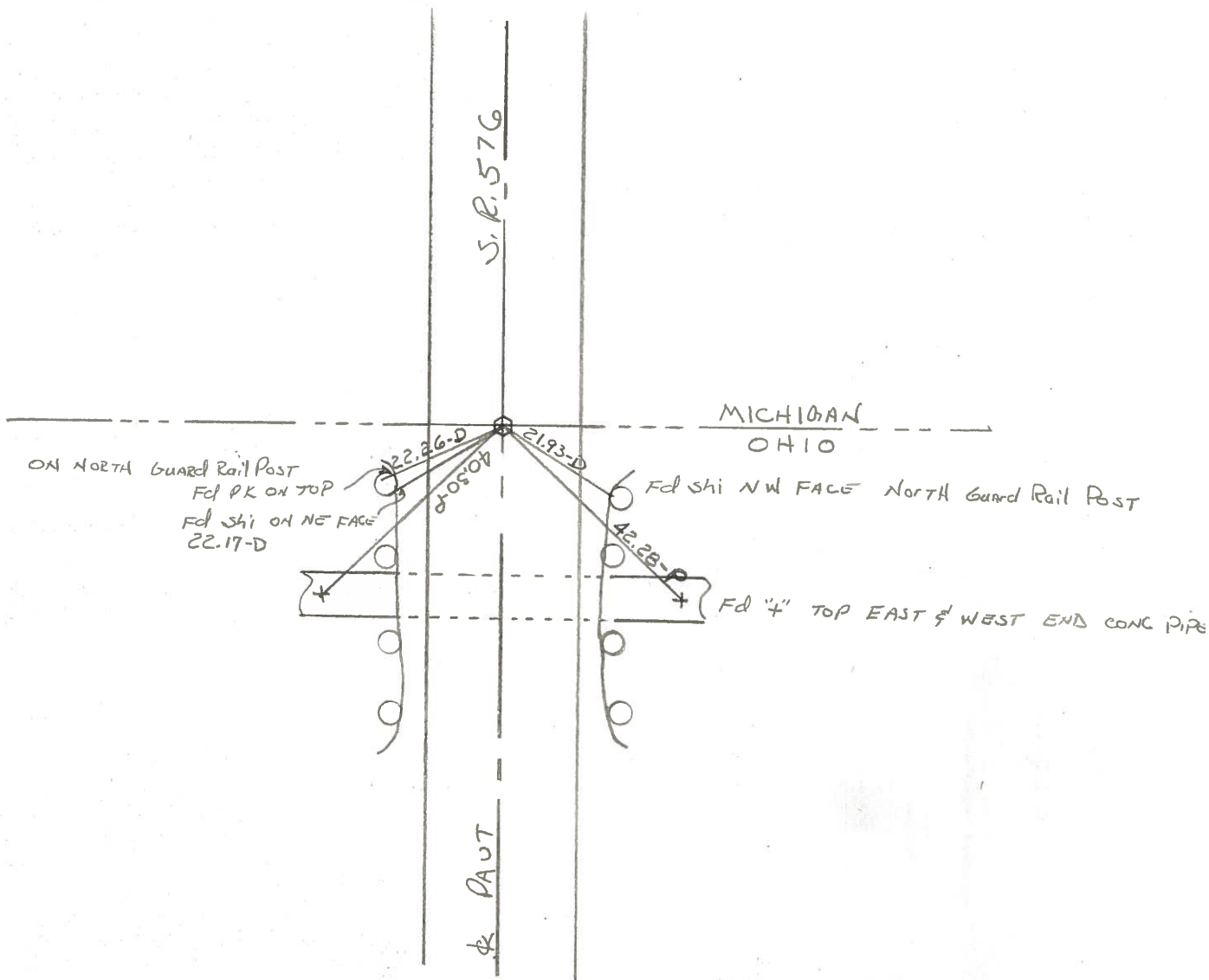

PERSONNEL	TITLE	PERSONNEL	TITLE	COUNTY	DATE
Beach				Williams	4 April 1956
Hoover				S. R. 571	WEATHER Overcast
Ruffer-Instr.				SEC. Bridge # 571-3.58	TEMP. 39°
Knape					
Heff					
DESCRIPTION				ALIGNMENT	JOB NO. 02185
LEFT		CENTER LINE		RIGHT	

