

8000

1
12
FILE No.

File # 546

STATE HIGHWAY DEPARTMENT OF OHIO
 Bureau of Construction
SEC. B BOWLING GREEN - NAPOLEON ROAD
 I.C.H. N° 286 PET. N° 3876
WOOD COUNTY
 WESTON & PLAIN TOWNSHIPS

INDEX

Title Page Sheet P 1
 Typical Cross Section Sheet P 2
 Plans and Profiles " P 3 - 6
 Cross Sections " P 7 - 12
 Summary "

SCALES

Plans 1 Inch = 100 Feet.
 Profiles 1 Inch = 100 Ft. Horizontal & 1 Inch = 10 Ft. Vertical.
 Cross Sections 1 Inch = 5 Feet Vertical & Horizontal.
 Details 3/8 inch = 1 Foot.

CONVENTIONAL SIGNS

Township Line - - - - -
 Section Line - - - - -
 Corporation Line - - - - -
 Property Line - - - - -
 Fence Line - - - - -
 Center Line of Survey - - - - -
 Telephone or Telegraph Poles T T T T T
 Railroad - + - + - + - + - + -

SPECIFICATIONS

1920 Specifications STATE HIGHWAY DEPARTMENT OF OHIO to apply to this Project.

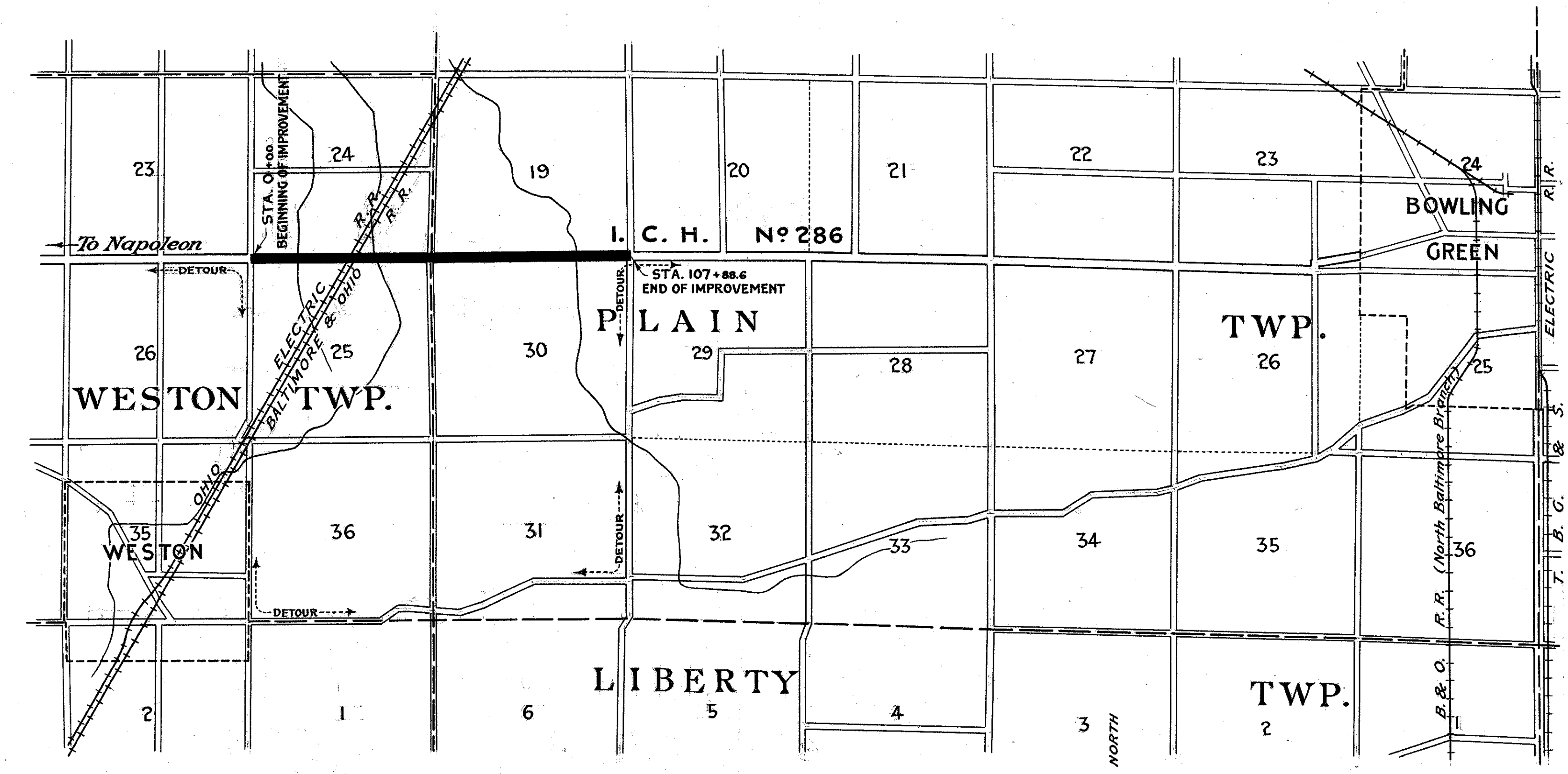

LOCATION PLAN
 Scale: 2 Inches = 1 Mile
 Portion to be improved **█**

We, the County Commissioners of Wood County, Ohio, hereby approve these plans for Section B, I.C.H. N° 286 Wood County, Ohio, and certify that the right-of-way is available for the construction of this improvement.

APPROVED: Date, May 3, 1920
F. M. Adams
 WOOD COUNTY COMMISSIONERS
b. V. Eggleston
A. L. Steinbaugh
 WOOD COUNTY SURVEYOR
 Date, May 3, 1920

I, hereby, approve these plans and declare that the making of this improvement will require the closing to traffic of the highway and that the detours will be indicated by signs as shown on the plans and estimates.

APPROVED:
Chas. H. Hildy
 STATE DIVISION ENGINEER
 Date, 5/19/20
T. J. Pugh
 STATE CHIEF HIGHWAY ENGINEER
 Date, 5/19/20
A. R. Taylor
 STATE HIGHWAY COMMISSIONER
 Date, 8-17-20

CONSTRUCTION BUREAU
 AUG 1 1955
 GROUND PHOTOLAB

CROSS - SECTIONS

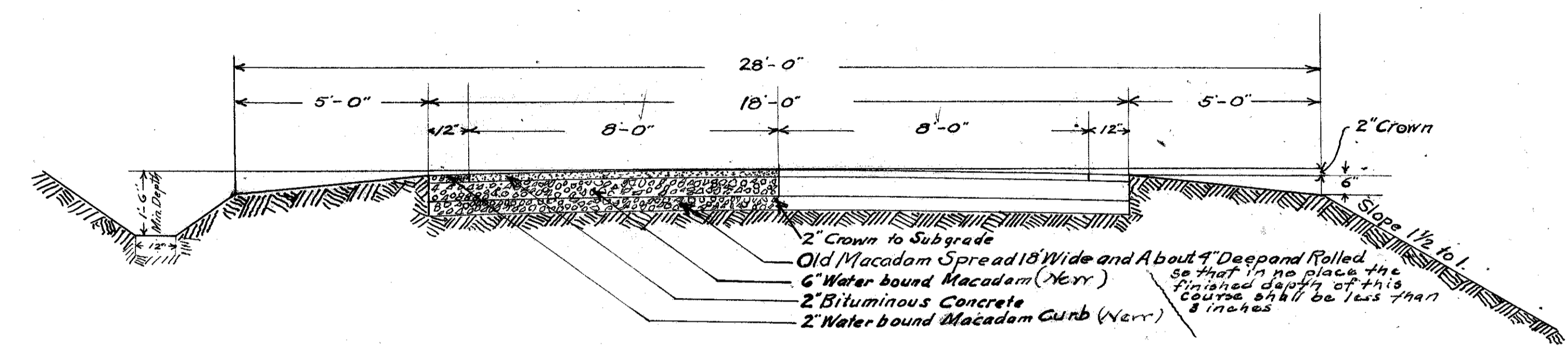

Bituminous Concrete with Macadam Base.
Type A

To be Used From Sta. 0+00 To Sta. 53+10

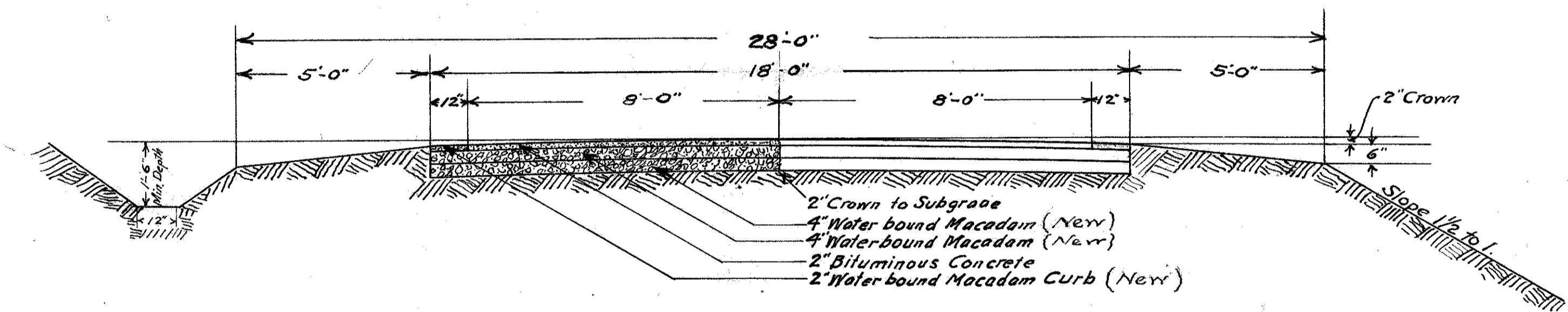

Bituminous Concrete with Macadam Base.
Type B

To be Used From Sta. 53+10 To Sta 107+88.6.

CONSTRUCTION
BUREAU
NOV 1917

I. C. H. N° 286-Sec. B
Wood County.

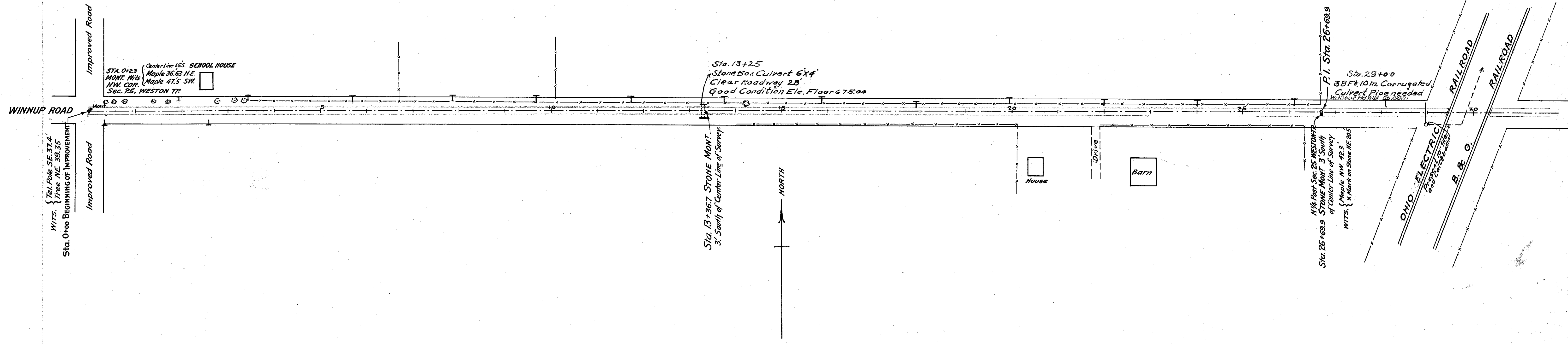

NOTE: New center line sub-grade and old surface elevations are given thus, 674.15
with new sub-grade elevations underneath, 675.35
Gutter grades are given thus, (674.60)

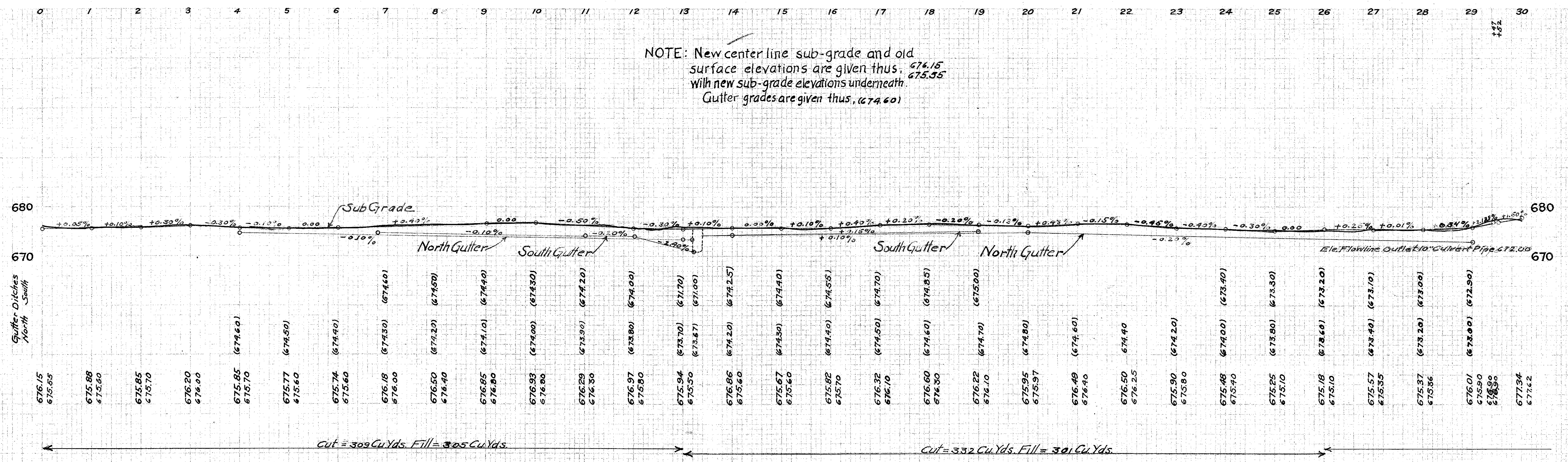

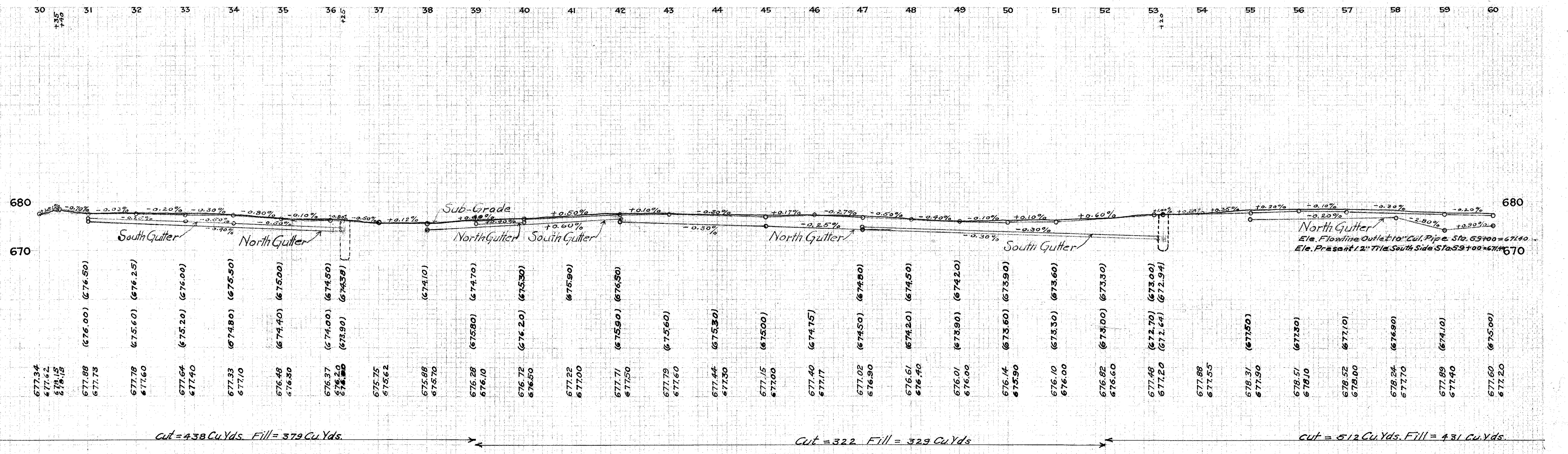
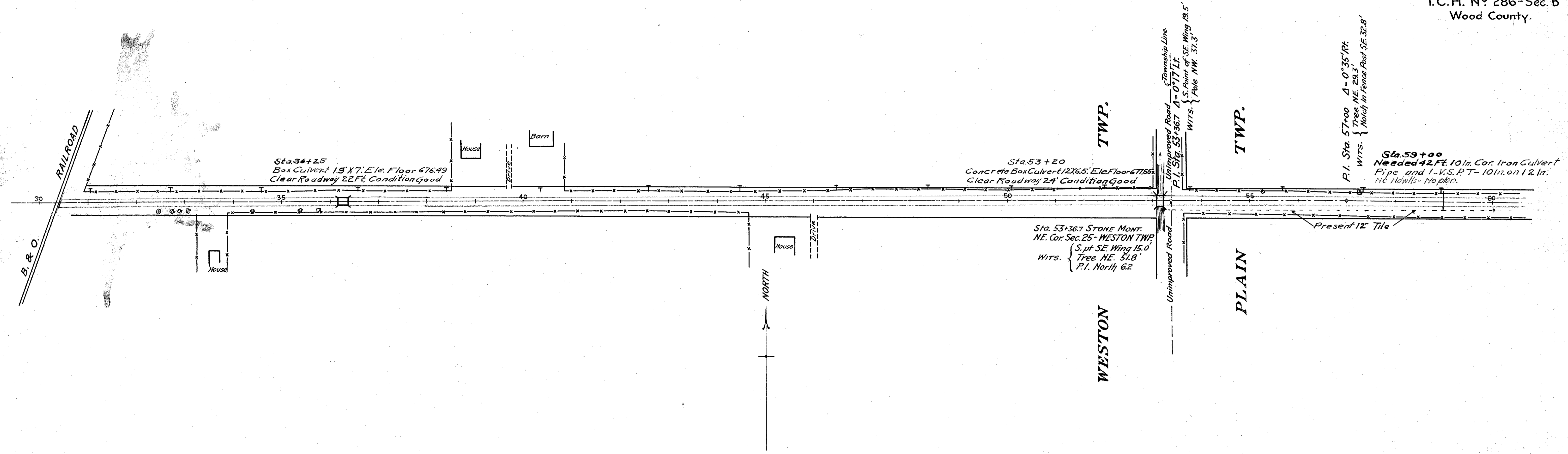

Cut = 438 Cu.Yds. Fill = 379 Cu.Yds.

Cut = 322 Fill = 329 Cu.Yds.

Cut = 512 Cu.Yds. Fill = 431 Cu.Yds.

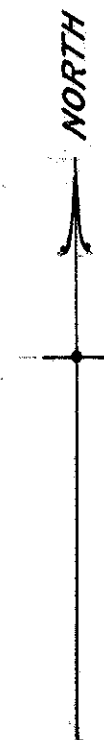
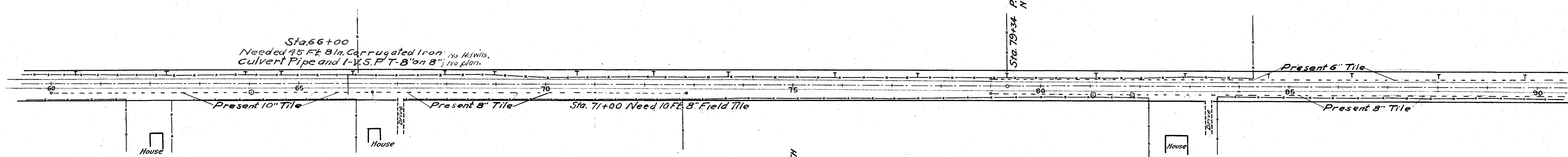

60 61 62 63 64 65 66 67 68 69 70 71 72 73 74 75 76 77 78 79 80 81 82 83 84 85 86 87 88 89 90

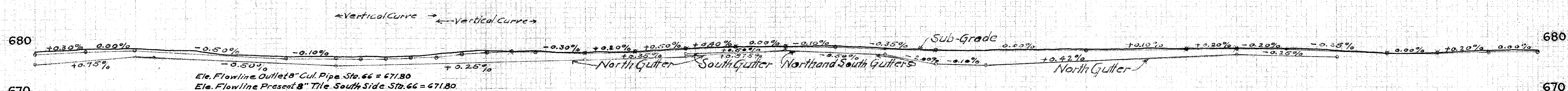

Ele. Flowline Outlet 8" Cul. Pipe Sta. 66 = 671.80
Ele. Flowline Present 8" Tile South Side Sta. 66 = 671.80

Gutter Ditches
North
South

677.60	675.00	678.04	675.75	678.01	676.50	677.62	676.00	676.70	675.50	676.41	675.00	676.31	674.50	675.90	675.89	676.25	674.75	675.97	674.13	676.97	675.00	676.40	674.91	677.41	675.25	677.22	677.36	677.47	676.50	677.30	677.02	676.75	679.19	676.05	677.20	677.91	676.35	676.50	678.22	676.93	677.08	679.10	678.15	677.50	677.50	678.10	677.24	677.00	677.17	676.50	677.65	677.35	674.50	677.50	677.32	674.40	677.30	677.51	674.82	677.50	677.55	675.24	677.50	677.61	675.66	677.40	677.71	676.08	677.50	677.84	676.50	677.70	677.85	676.25	677.50	677.56	676.00	677.15	676.85	676.90	676.91	676.80	677.22	677.00	677.20	675.50	677.00
--------	--------	--------	--------	--------	--------	--------	--------	--------	--------	--------	--------	--------	--------	--------	--------	--------	--------	--------	--------	--------	--------	--------	--------	--------	--------	--------	--------	--------	--------	--------	--------	--------	--------	--------	--------	--------	--------	--------	--------	--------	--------	--------	--------	--------	--------	--------	--------	--------	--------	--------	--------	--------	--------	--------	--------	--------	--------	--------	--------	--------	--------	--------	--------	--------	--------	--------	--------	--------	--------	--------	--------	--------	--------	--------	--------	--------	--------	--------	--------	--------	--------	--------	--------	--------	--------	--------	--------

cut = 512 Cu.Yds. Fill = 431 Cu.Yds

cut = 565 Cu.Yds. Fill = 461 Cu.Yds

cut = 367 Cu.Yds. Fill = 331 Cu.Yds

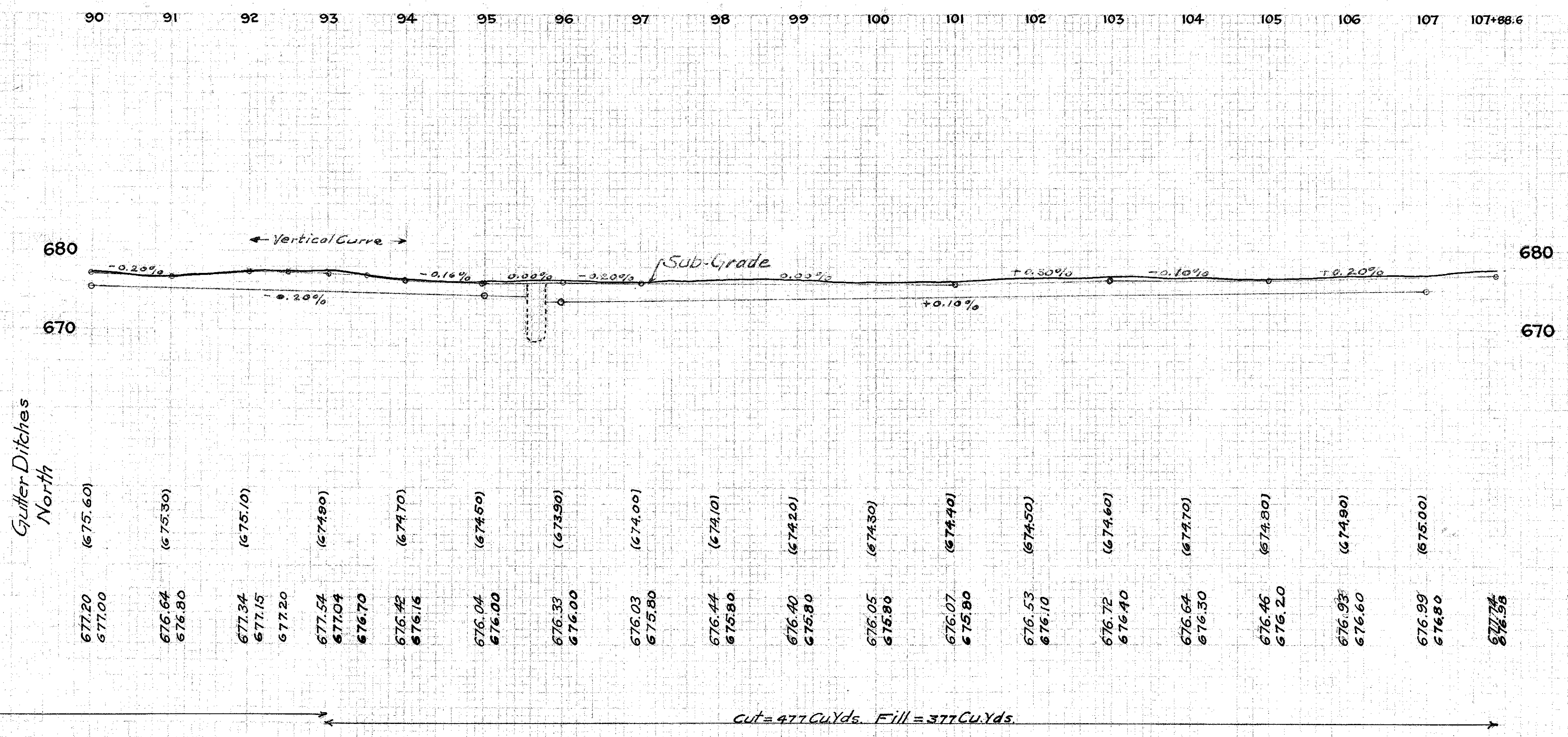
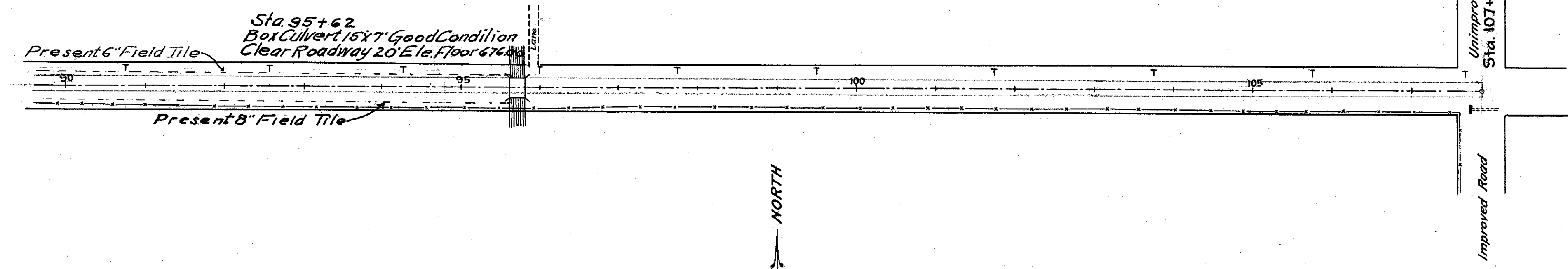

CROSS-SECTIONS
I.C.H. 286, SEC. B.
SHEET N° 1

CU.YDS
CUT
F 44

SUB-GRADE
ELEVATION

SURFACE
ELEVATION

CU.YDS
FILL
22

CU.YDS
CUT
30

SUB-GRADE
ELEVATION

SURFACE
ELEVATION

CU.YDS
FILL
17

7
12

I.C.H. N° 286 - Sec. B.
Wood County.

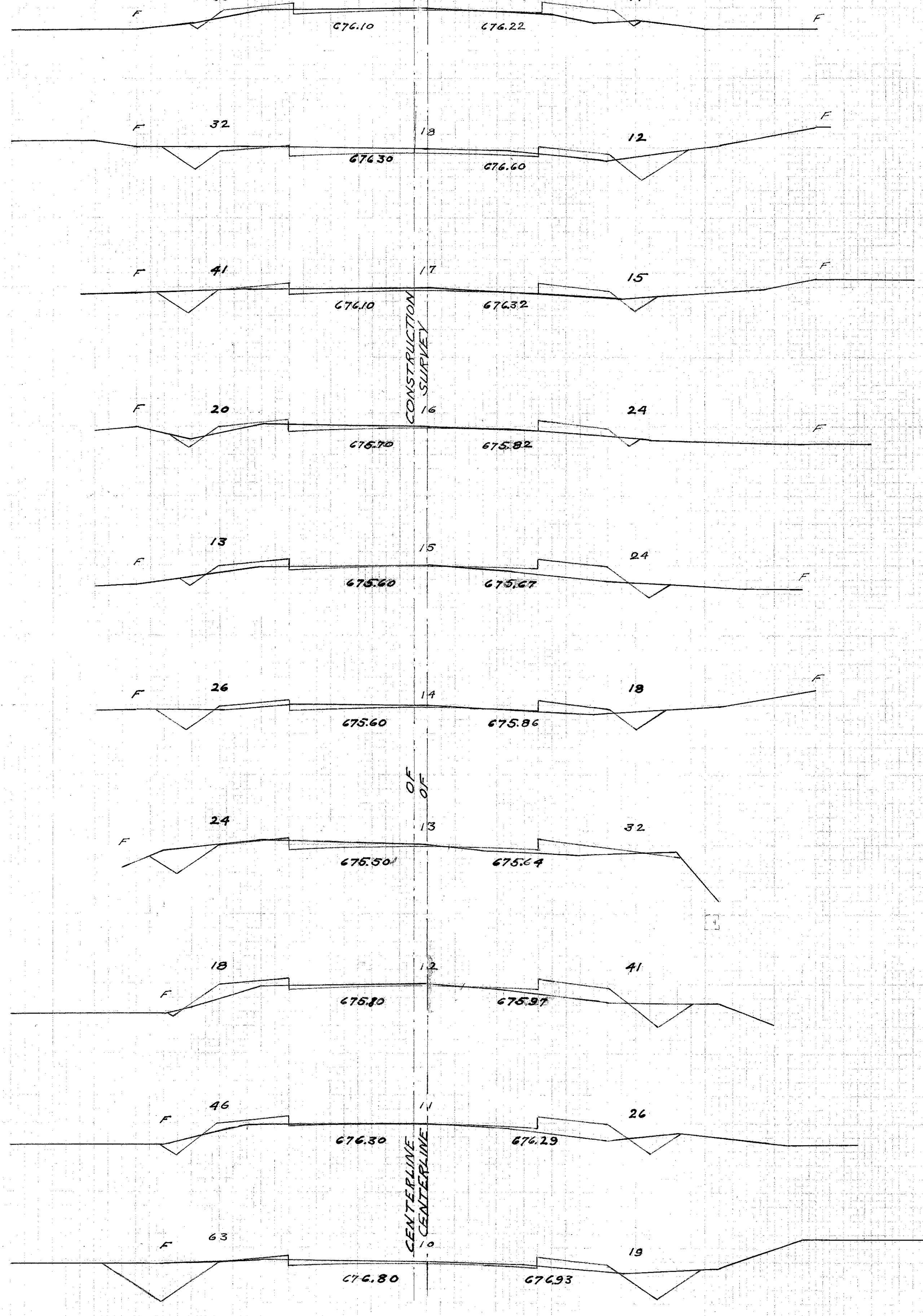
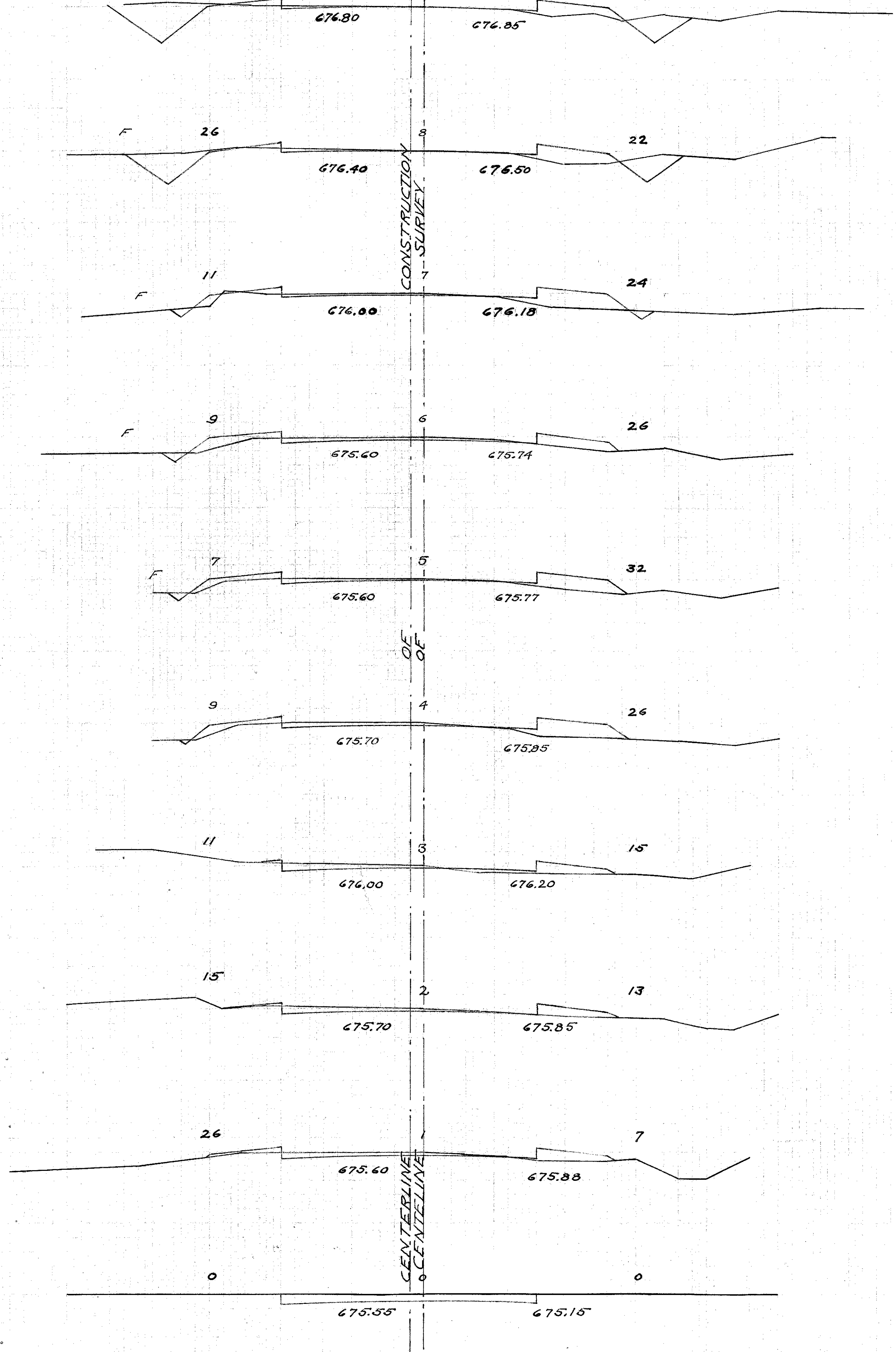

CONSTRUCTION SURVEY

CONSTRUCTION SURVEY

OF

OF

CENTERLINE

CENTERLINE

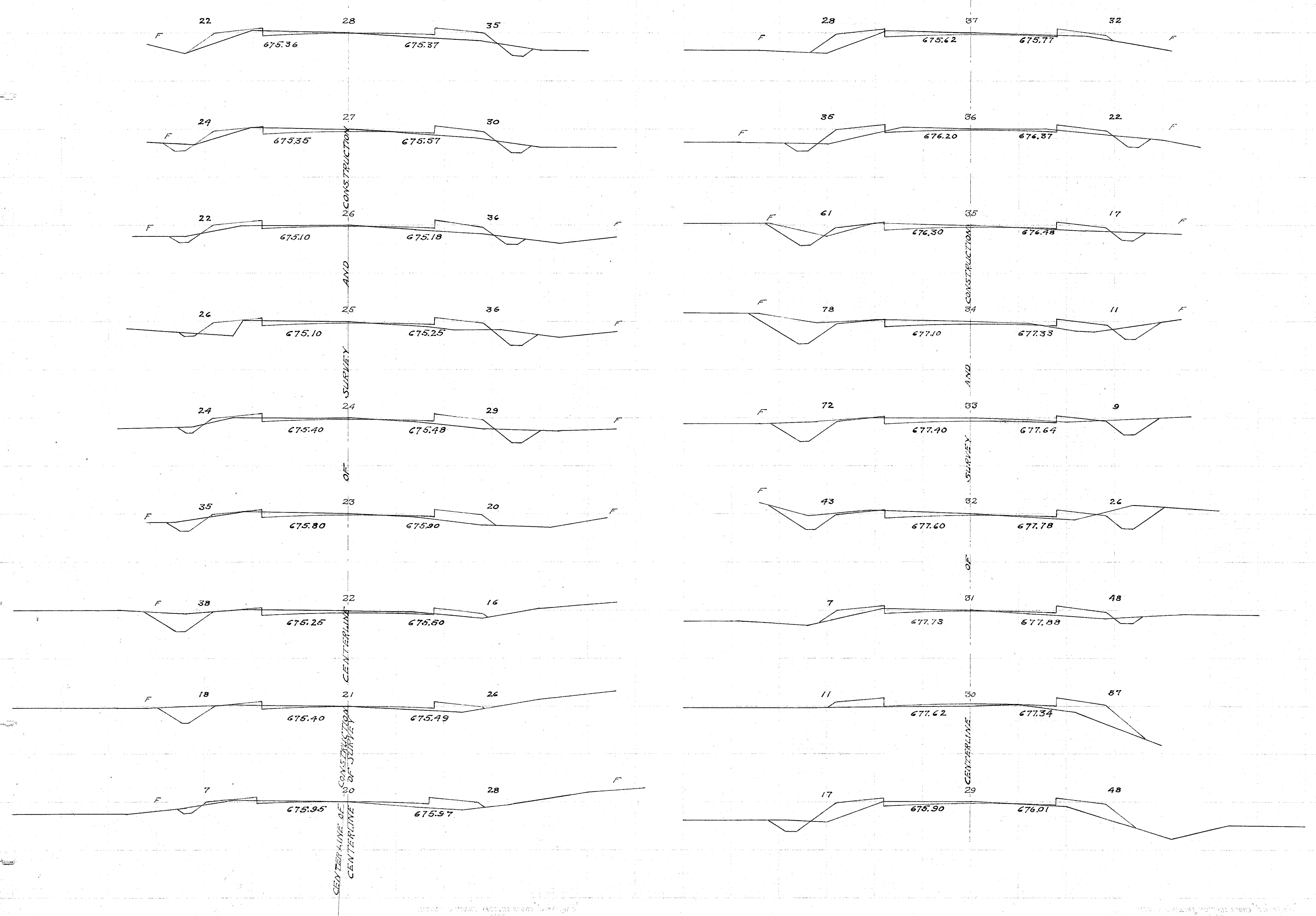

CU.YDS.
CUT

SUB-GRADE
ELEVATION

SURFACE
ELEVATION

CU.YDS.
FILL

CU.YDS.
CUT

SUB-GRADE
ELEVATION

SURFACE
ELEVATION

CU.YDS.
FILL

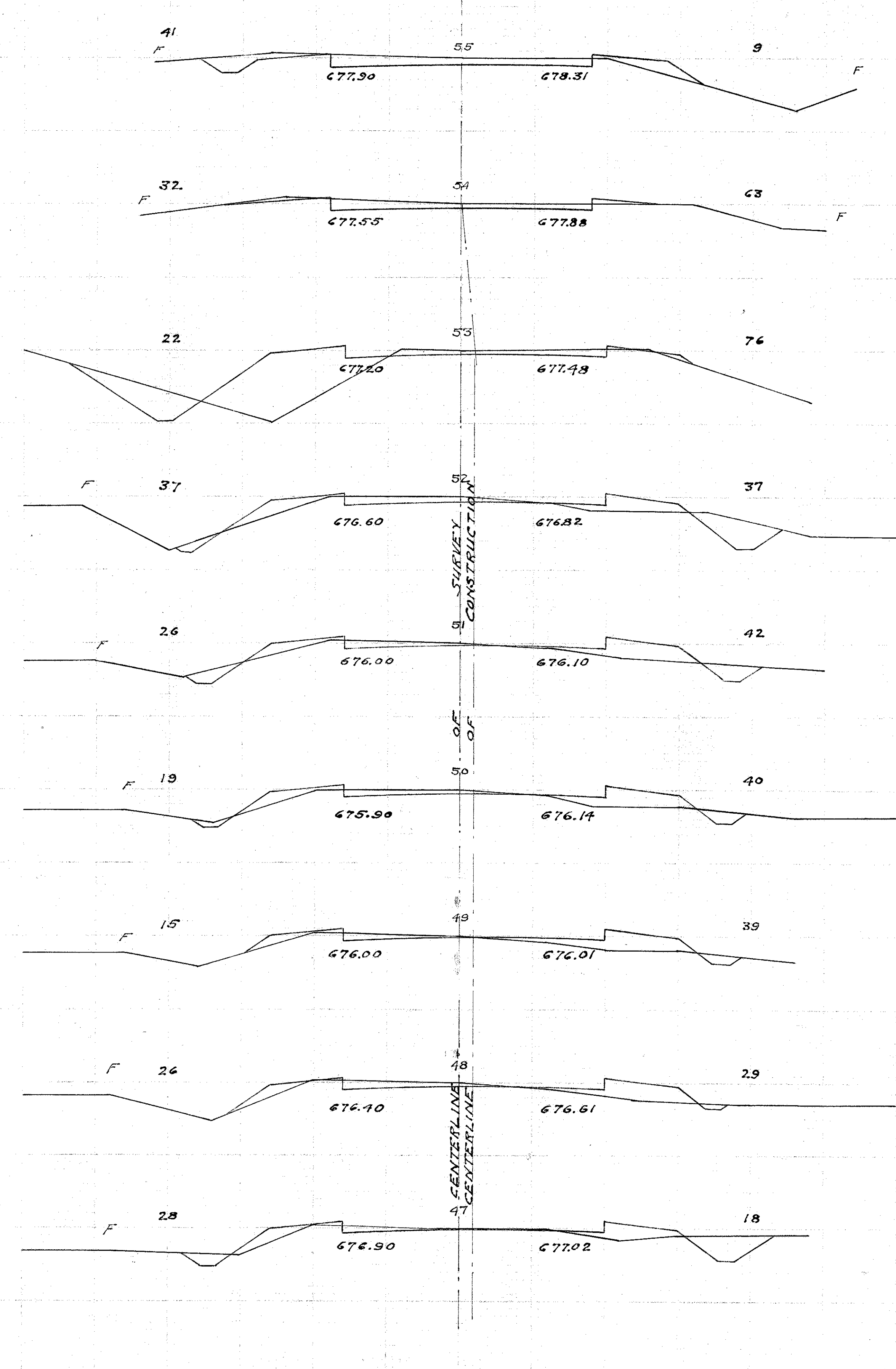
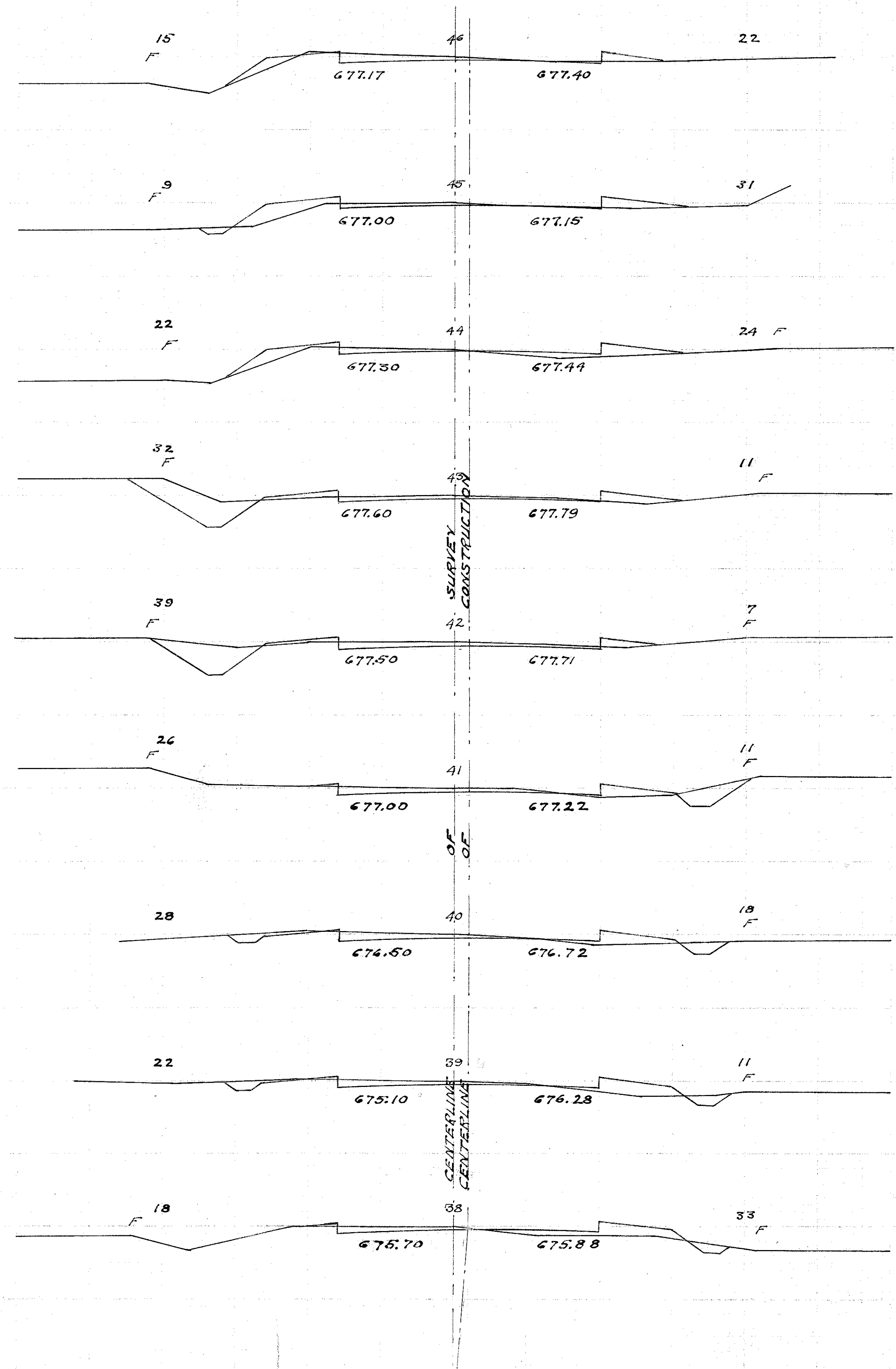

SURVEY CONSTRUCTION

OF OF OF

CENTERLINE CENTERLINE

SURVEY CONSTRUCTION

OF OF OF

CENTERLINE CENTERLINE

CROSS-SECTIONS
CUT
I. C. H. N° 286 - SEC. B
SHEET N° 4

SUB-GRADE
ELEVATION

SURFACE
ELEVATION

CUTYDS
FILL

CUTYDS
CUT

SUB-GRADE
ELEVATION

SURFACE
ELEVATION

CUTYDS
FILL

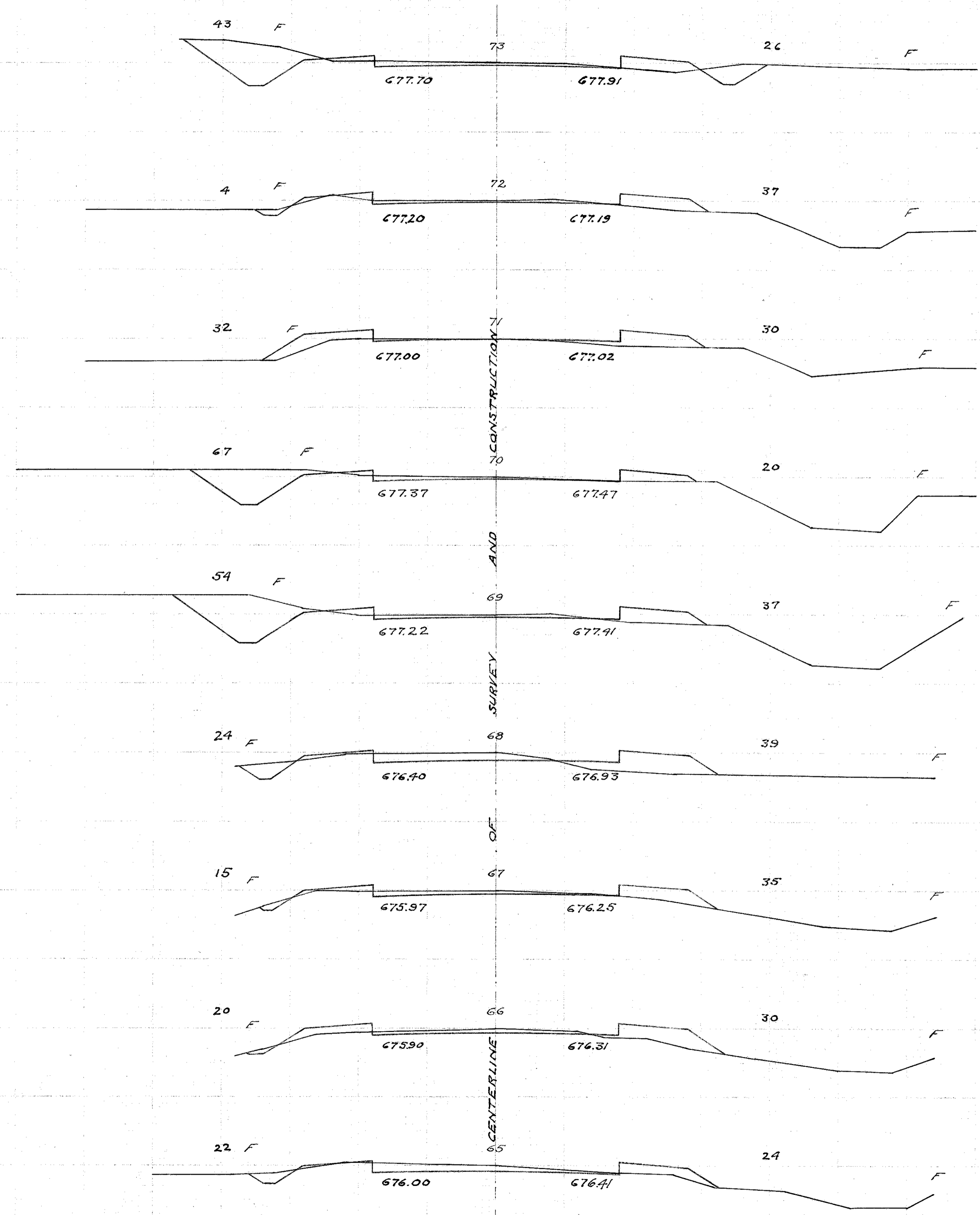
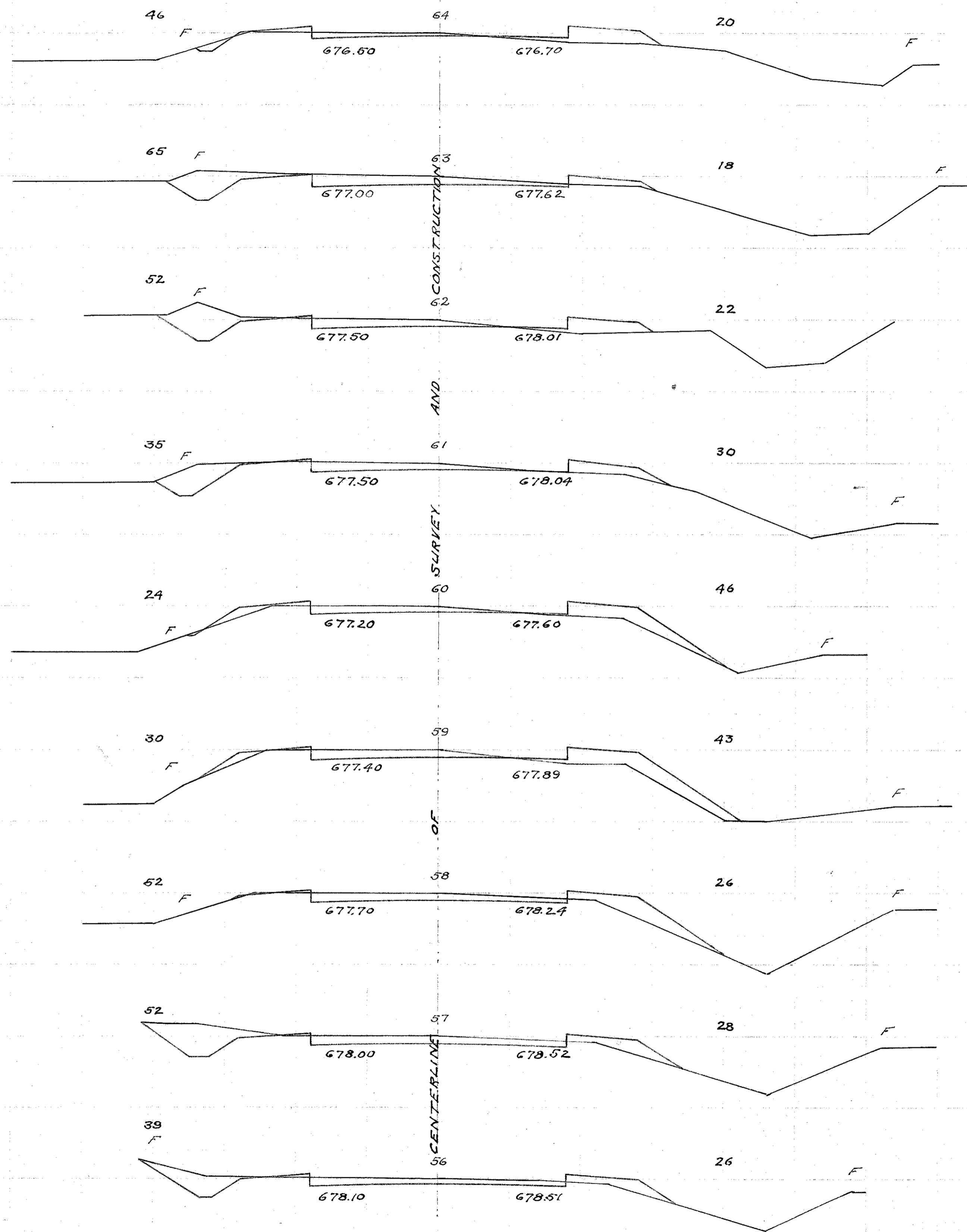

CROSS-SECTIONS CU YDS.
1 CH 286 Sec. 8. CUT
SHEET No 5

SUB-GRADE
ELEVATION

SURFACE
ELEVATION

CU YDS
FILL

CU YDS
CUT

SUB-GRADE
ELEVATION

SURFACE
ELEVATION

CU YDS.
FILL

11
12

I. C. H. No 286 - Sec. B
Wood County.

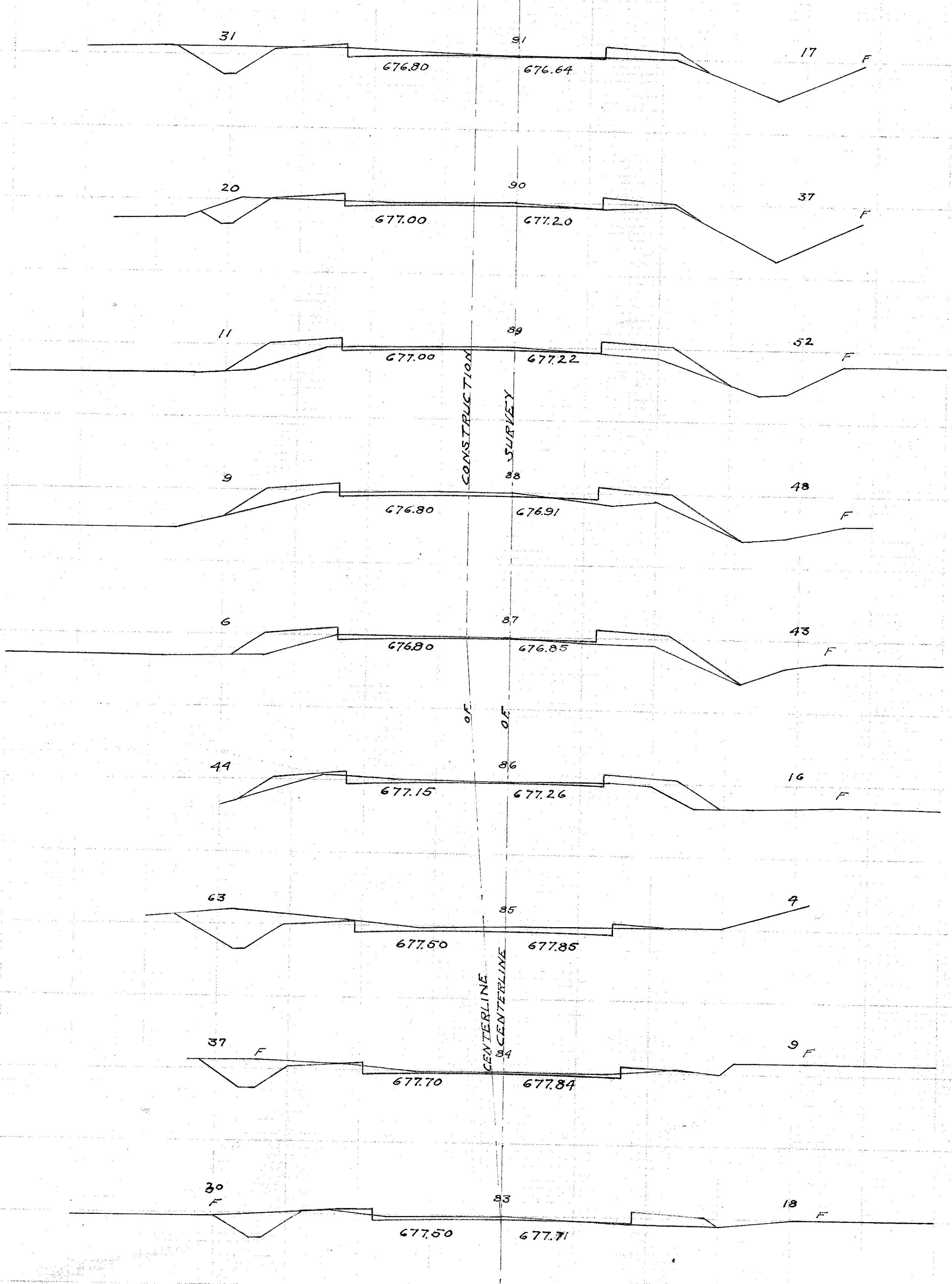
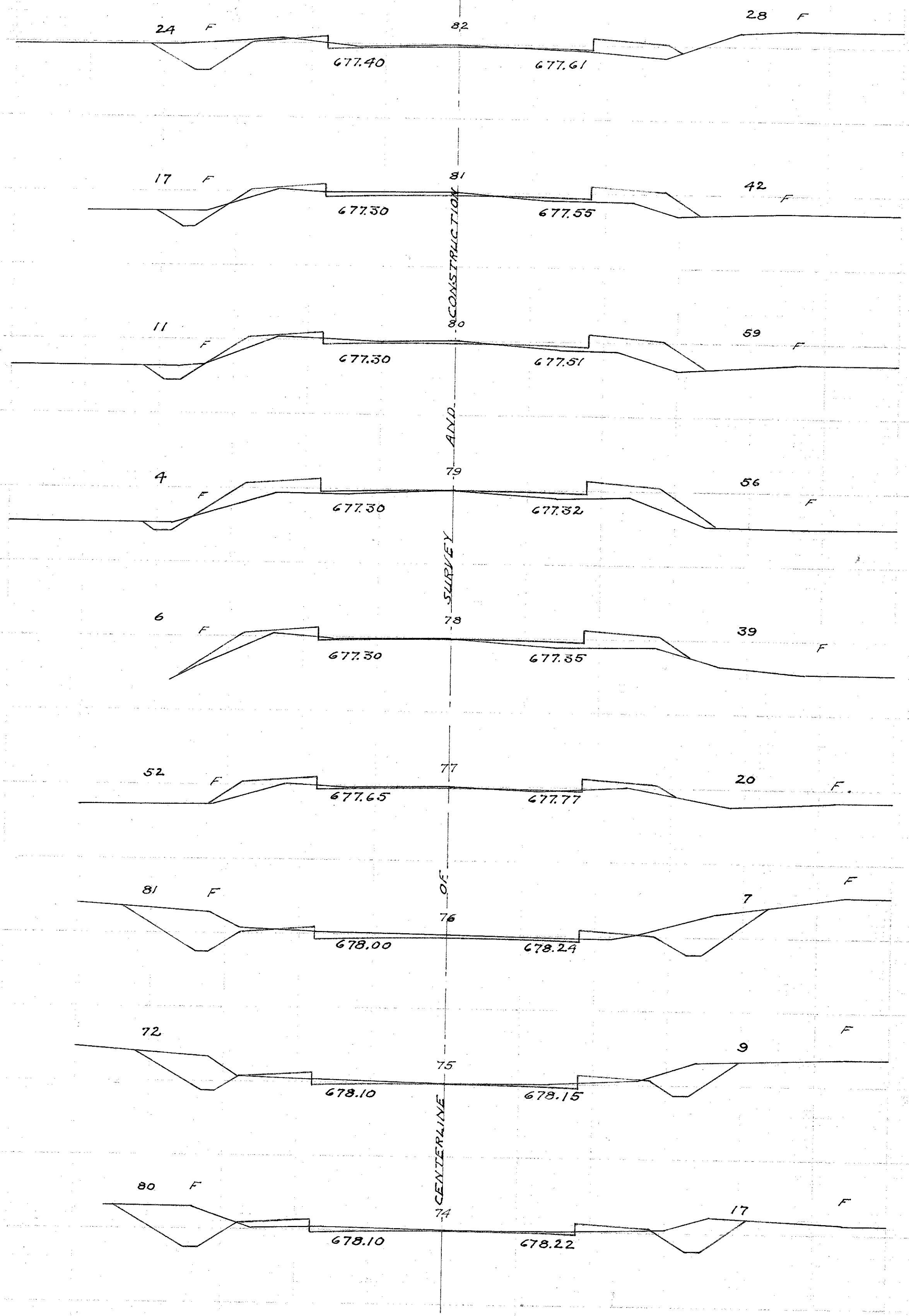

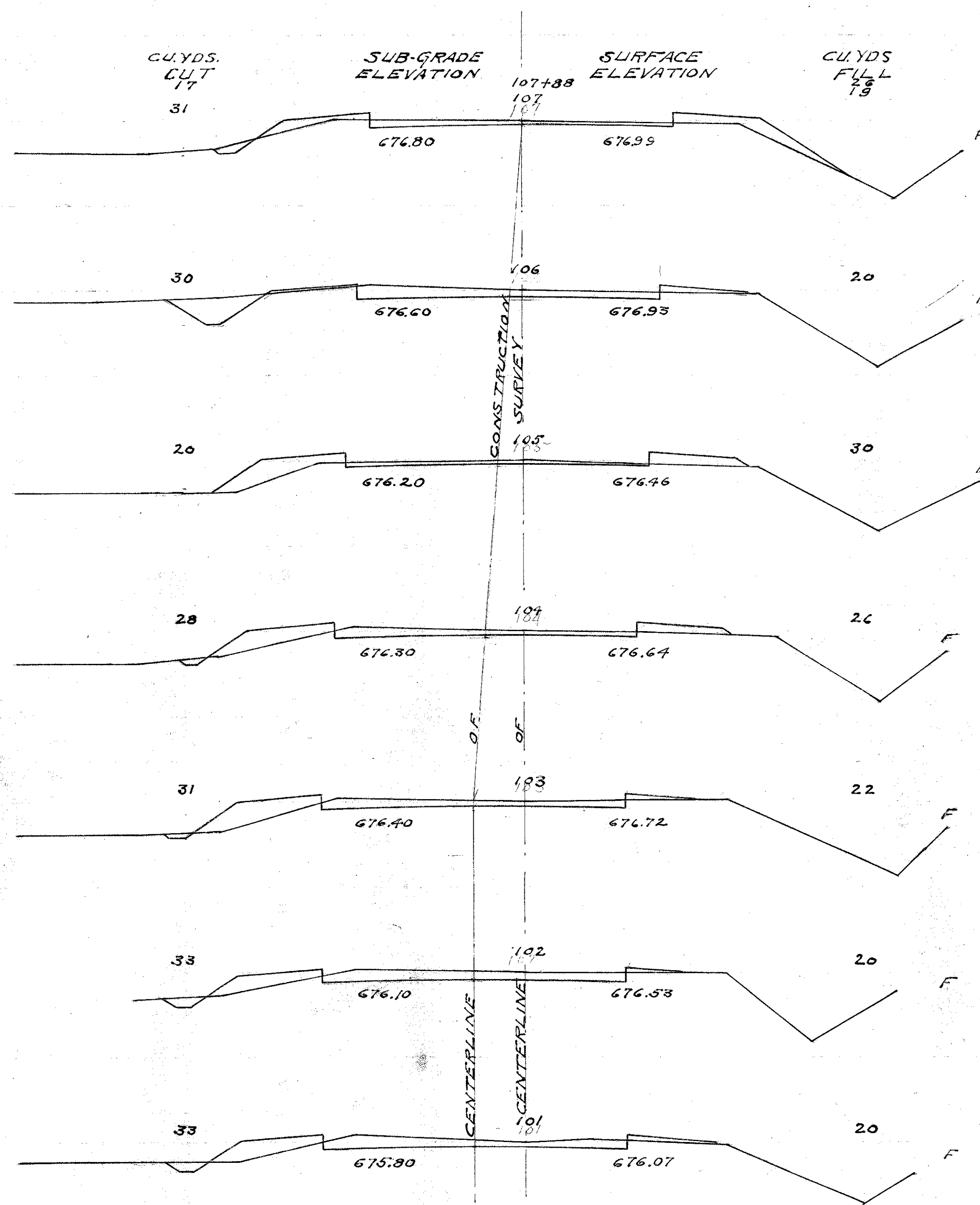
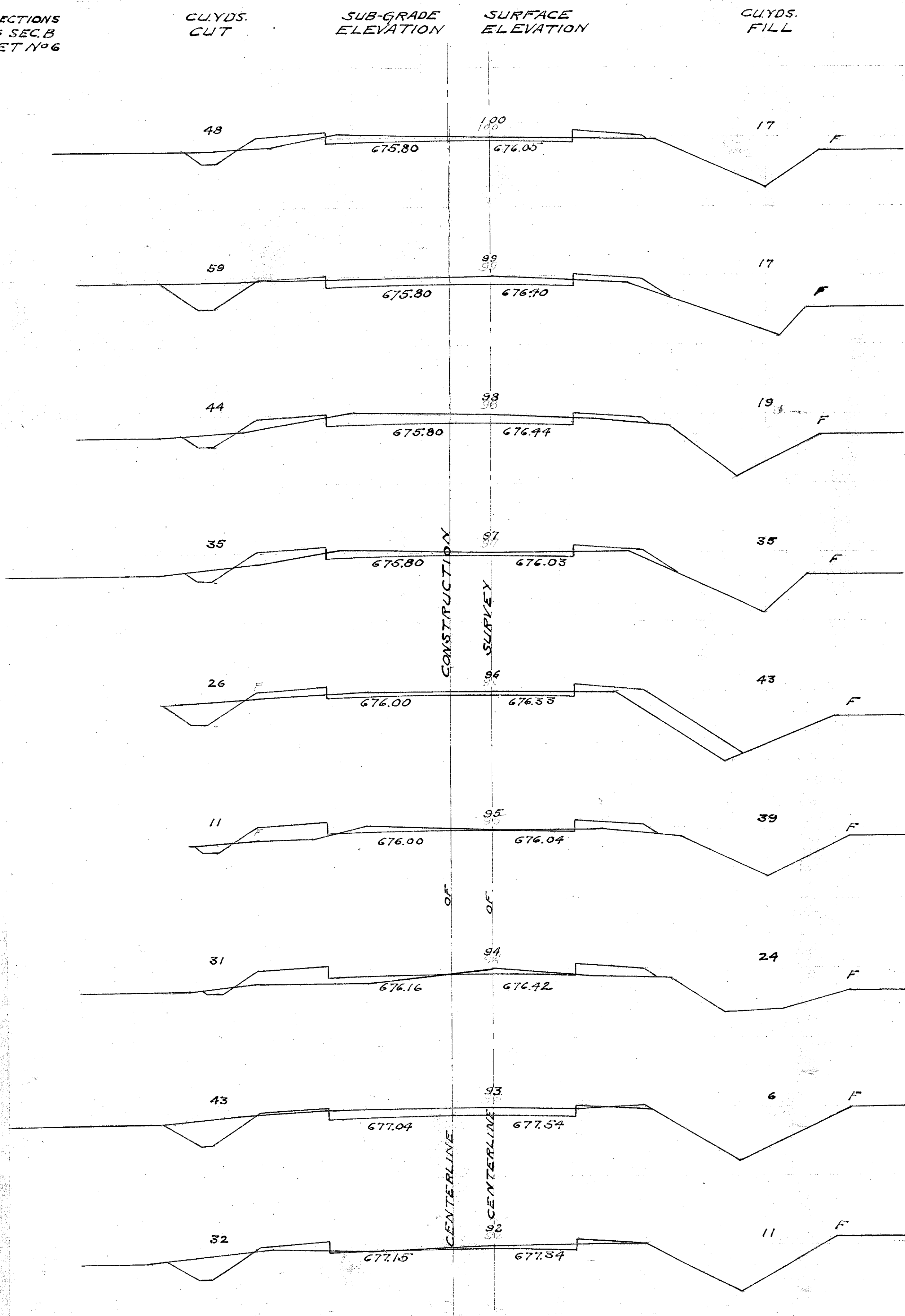

Handwritten notes on the right margin, including 'COVER' and other illegible text.