

Cronin

12/12, 15, 16/80 3 R

MAINTENANCE PROGRAM 1981

PART 1
OF 1

(TOP) TYPE 404 THICKNESS 1 1/2" PRIORITY

(BASE) TYPE _____ THICKNESS _____ PENETRATION

END LOG S.L.M. 17.52 (Const Joint = 925+05.60 (924+71 Meas))

BEGIN LOG S.L.M. ~~11.99~~ (Construction Joint (Rudolph Rd.) = 5 619+80)

TOTAL LENGTH 5.53 Rudolph Rd = 5 618+61

COUNTY WOOD SECTION 11.99 WIDTH (20'24') 2 see sheets BERM CURBED () ()

ROUTE US 6 SECTION 14.59 WIDTH (24') 2 of 3 of 4 () ()

SECTION 17.52 WIDTH () () () ()

ORDINANCE _____ SECTION _____ WIDTH () () () ()

END LOG _____ SECTION _____ WIDTH () () () ()

BEGIN LOG _____ SECTION _____ WIDTH () () () ()

EXISTING BERM TYPE Stabilized EXISTING BERM WIDTH 3' on the 24' width MAILBOX APPROACHES No. 0
(PAVED, STABILIZED, AGGREGATE) MANHOLES 0

PROPOSED BERM TYPE 404 PROPOSED BERM WIDTH 2" X INLETS CATCH BASINS 0

INTERSECTIONS 1 - ONE-way ASPHALT DRIVEWAYS 0 CONCRETE DRIVEWAYS 0
3 - Two-way Mon. Box 1

STRUCTURES

RAILROAD CROSSINGS

STRUCTURE NO.	WIDTH	LENGTH	APPR. SLABS	NAME R. R.	STATION	(*) () ()	No.	TRACKS
Wood 6-12.20	38'	145'	2 @ 25' - E. 13 (644+16)			() () ()		TRACKS
Wood 6-12.20	38'	145'	2 @ 25' - W. 13			() () ()		TRACKS
Wood 6-12.70	38'	172'	2 @ 25' - E. 13 (611+80)			() () ()		TRACKS
" " "	38'	172'	2 @ 25' - W. 13			() () ()		TRACKS
Wood 6-14.83	44'	138.3'	2 @ 25'			() () ()		TRACKS

*Indicate length of crossing along C Pav't.

1220
CB (E. Side)
1270 - 2 CB

NOTES

PERSONNEL	TITLE	PERSONNEL	TITLE
BRONIN		MOSSER	
BRIPPLE		BARKOUR	
GEYMAN			

COUNTY Wood DATE 12/16/80

S. R. U.S. #6 WEATHER SUNNY

SEC. 11.99-17.52 SLM TEMP. 26°

DESCRIPTION MAINTENANCE PROGRAM - 1981 JOB NO. _____

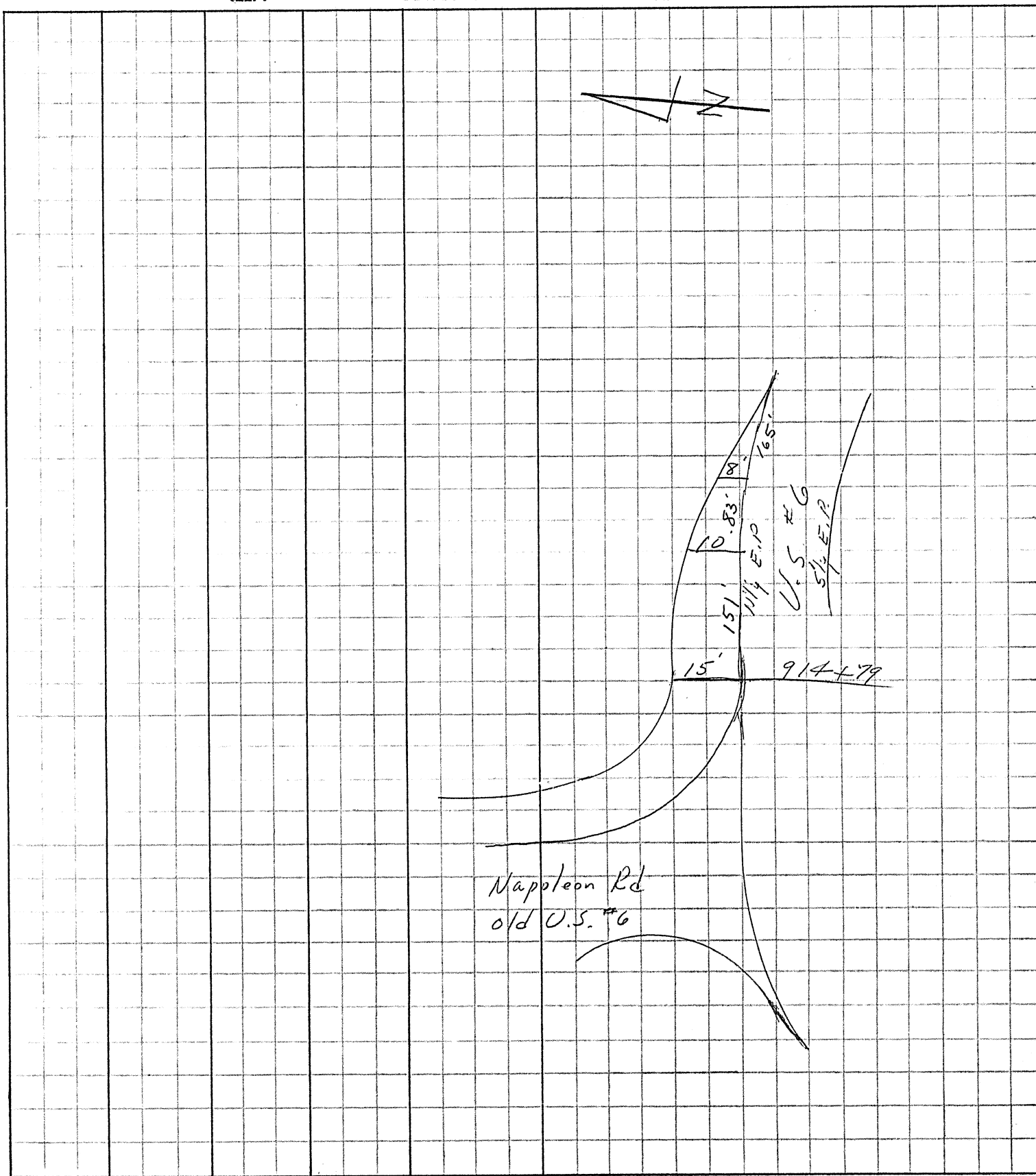

PERSONNEL	TITLE	PERSONNEL	TITLE	COUNTY	DATE
Schneider				Wood	3-9-81
Mosser				S. R. 6	WEATHER Fair
Barbour				SEC. 11.99	TEMP. 40'

DESCRIPTION Maint. Program Guardrail runs JOB NO. _____

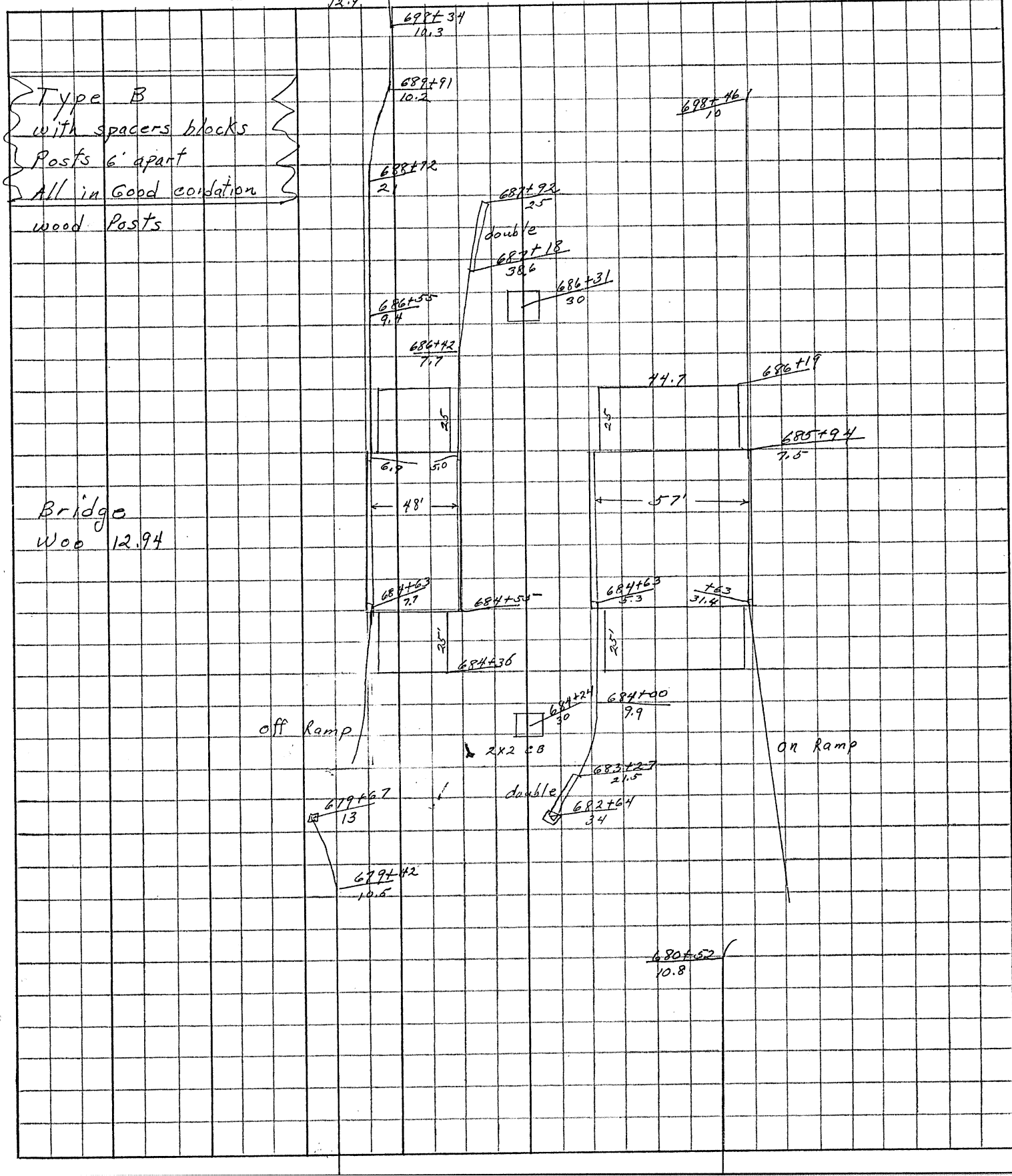

PERSONNEL	TITLE	PERSONNEL	TITLE	COUNTY	Wood	DATE	3-9-81
Schneider				S. R.	6	WEATHER	cloudy
Mosser				SEC.	11.99	TEMP.	36°
Barbour							

DESCRIPTION Maint. Program (Guardrail runs) JOB NO. _____

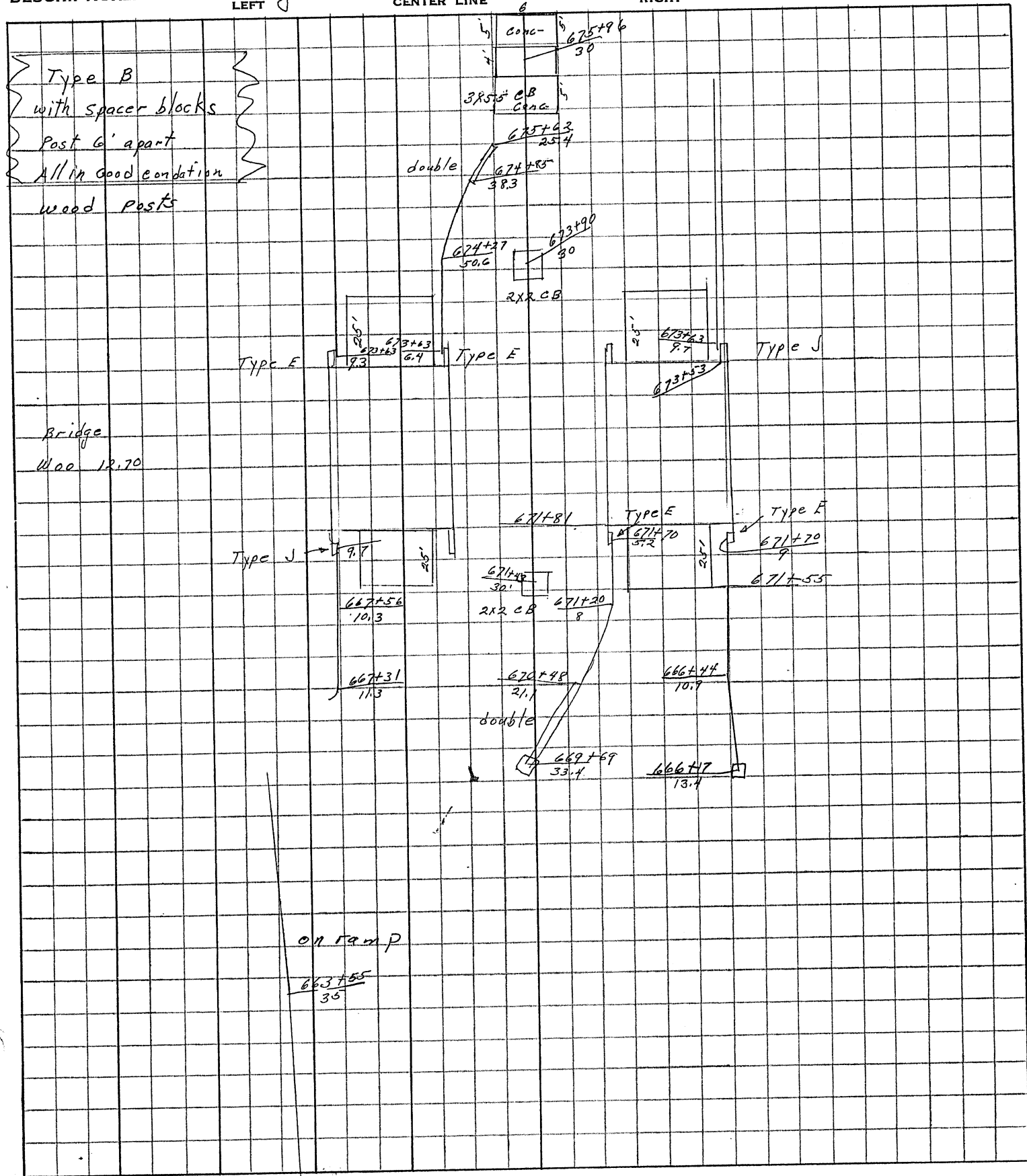

PERSONNEL TITLE PERSONNEL TITLE

Schneider _____

Mosser _____

Barbour _____

COUNTY Wood

DATE 3-9-81

S. R. 6

WEATHER cloudy

SEC. 11.99

TEMP. 35°

DESCRIPTION Maint. Program (Guardrail runs)

JOB NO.

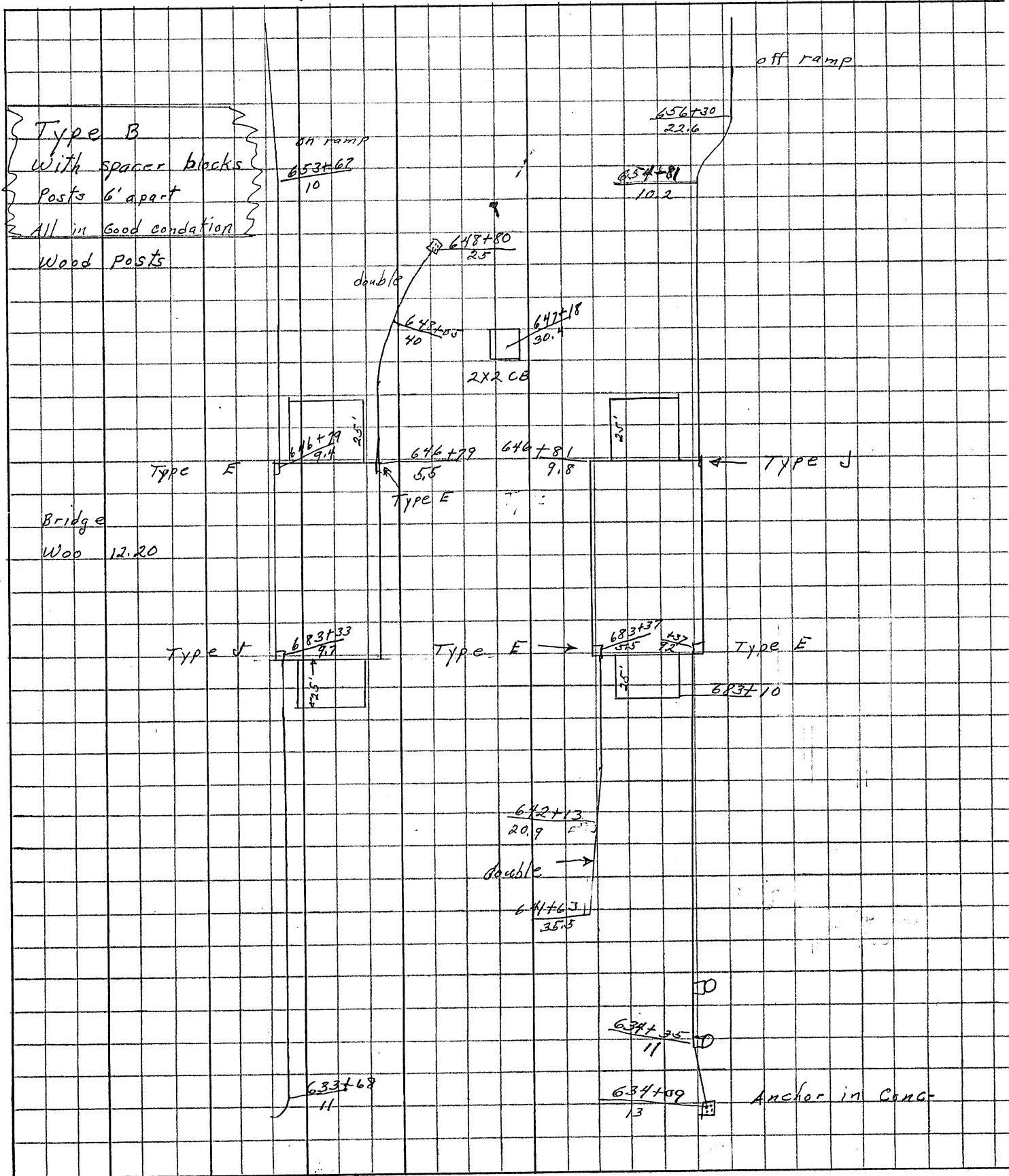

PERSONNEL	TITLE	PERSONNEL	TITLE
CROWIN			
RIPPLE			
GEYMAN			

COUNTY Wood

DATE 11/12/80

S. R. U.S. #6

WEATHER snow-wet

SEC. 11.99-17.52

TEMP. 26°

DESCRIPTION Maintenance Program -198'

JOB NO. _____

