

O.D.O.T. DISTRICT 2 SURVEY OFFICE (USE ONLY)

PERSONNEL _____ REFERENCE NO. 15 SHEET 1 OF 51

NOTES BARNHISEL DATE 3/19/91 ROUTE SR 18
 H.C. LOEHRKE WEATHER CLOUDY/WINDY COUNTY WOOD
 R.C. HOFFMAN TEMP. 45° TOWNSHIP JACKSON
 SECTION 26

DWG BY O'DONNELL PID PAVETRAIN

T 3 N R 9 E

TYPE MONUMENT 1/2" IPIN

~~ON SURFACE~~ - BELOW 2.0"

LEFT - ☉ PAV'T - RIGHT 11.0' S. OF ☉ E.

- TO - EDGE PAVEMENT NOTE: 2.5' W. OF ☉ SR 235

STATION: 343+18

HORZ.DATUM: NAD83 (2011)

GEOID: NAVD88-2012A

GRID: NORTHING: 554935.233

EASTING: 1614977.503

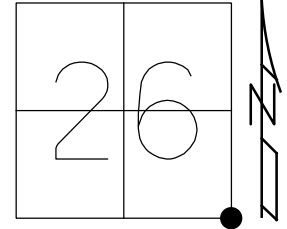

RECORD:
 FD MAG/WASHER
 SVD15
 6/16/10, BG
 FD MAG/WASHER
 REF15
 6/15/20, JFO

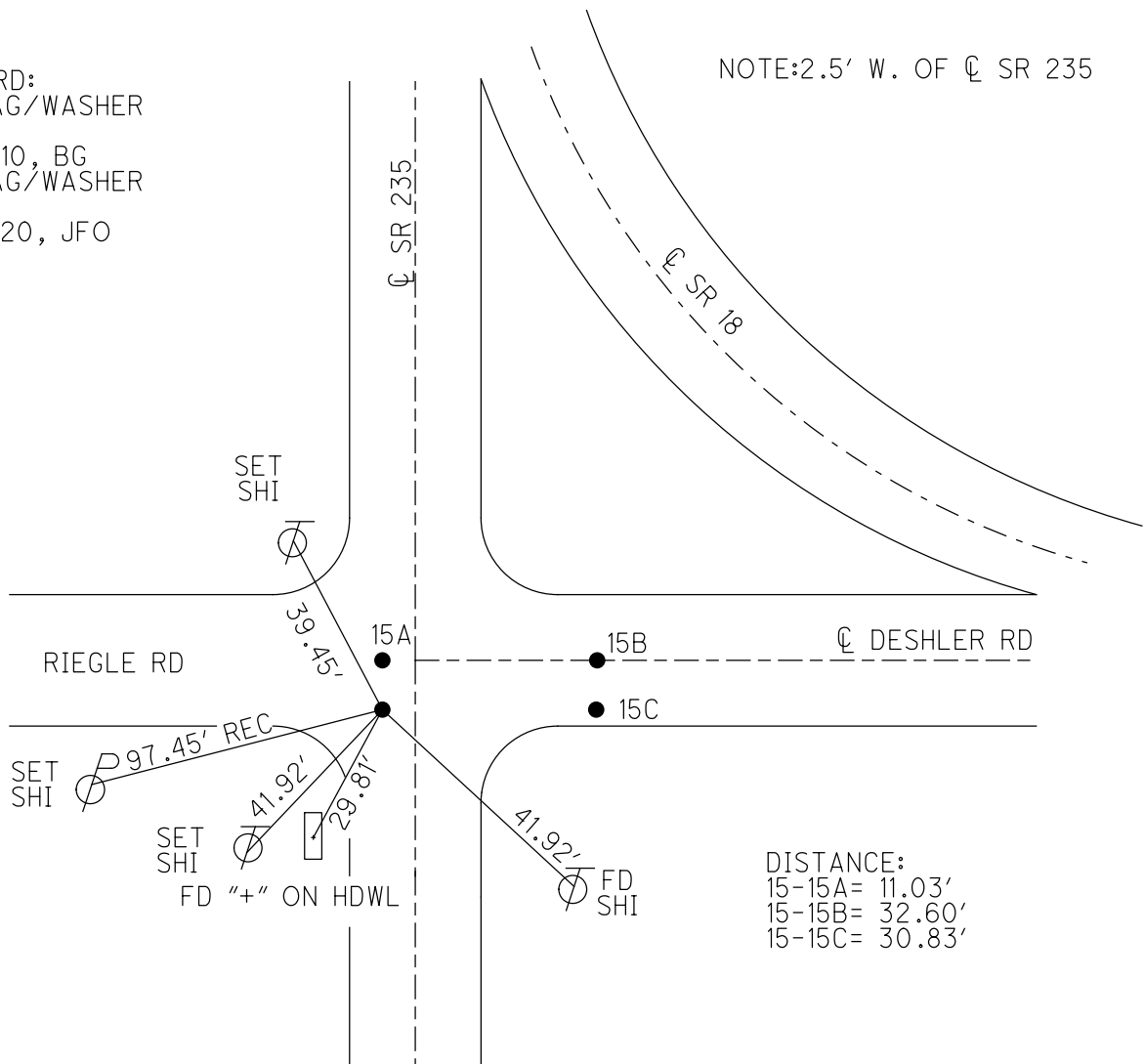

O.D.O.T. DISTRICT 2 SURVEY OFFICE (USE ONLY)

PERSONNEL _____ REFERENCE NO. 3 SHEET 5 OF 8

NOTES	<u>NUHFER</u>	DATE	<u>5-06-04</u>	ROUTE	<u>SR 235</u>
H.C.	<u>CANERBURY</u>	WEATHER	<u>SUNNY</u>	COUNTY	<u>WOOD</u>
R.C.	<u>ARMS</u>	TEMP.	<u>65°F</u>	TOWNSHIP	<u>JACKSON</u>
				SECTION	<u>25</u>
				T	<u>3</u> N
				R	<u>9</u> E

TYPE MONUMENT MAG/WASHER
 ON SURFACE - ~~BELOW~~ ON _____
 LEFT - ☉ PAV'T - ~~RIGHT~~ 2.5'
 - TO - EDGE PAVEMENT
 S.L.M. 53+76.82

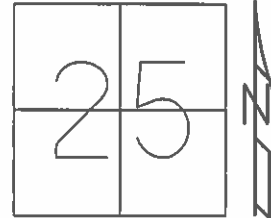

Grid: Northing: 554935.163 Easting: 1614977.299

RECORD:
 PK WASHER @SURFACE
 11.0 S. OF ☉ EAST
 2.5 LT. OF ☉ S.R. 235
 ON CL WEST

SET MAG/WASHER
 ALL FOUR POINTS
 08-03-04, MC

REF 3B TO REF 3C = 10.99'
 REF 3B TO REF 3A = 31.68'
 REF 3B TO REF 3 = 30.84'
 REF 3C TO REF 3A = 29.60'
 REF 3C TO REF 3 = 32.65'
 REF 3A TO REF 3 = 11.05'

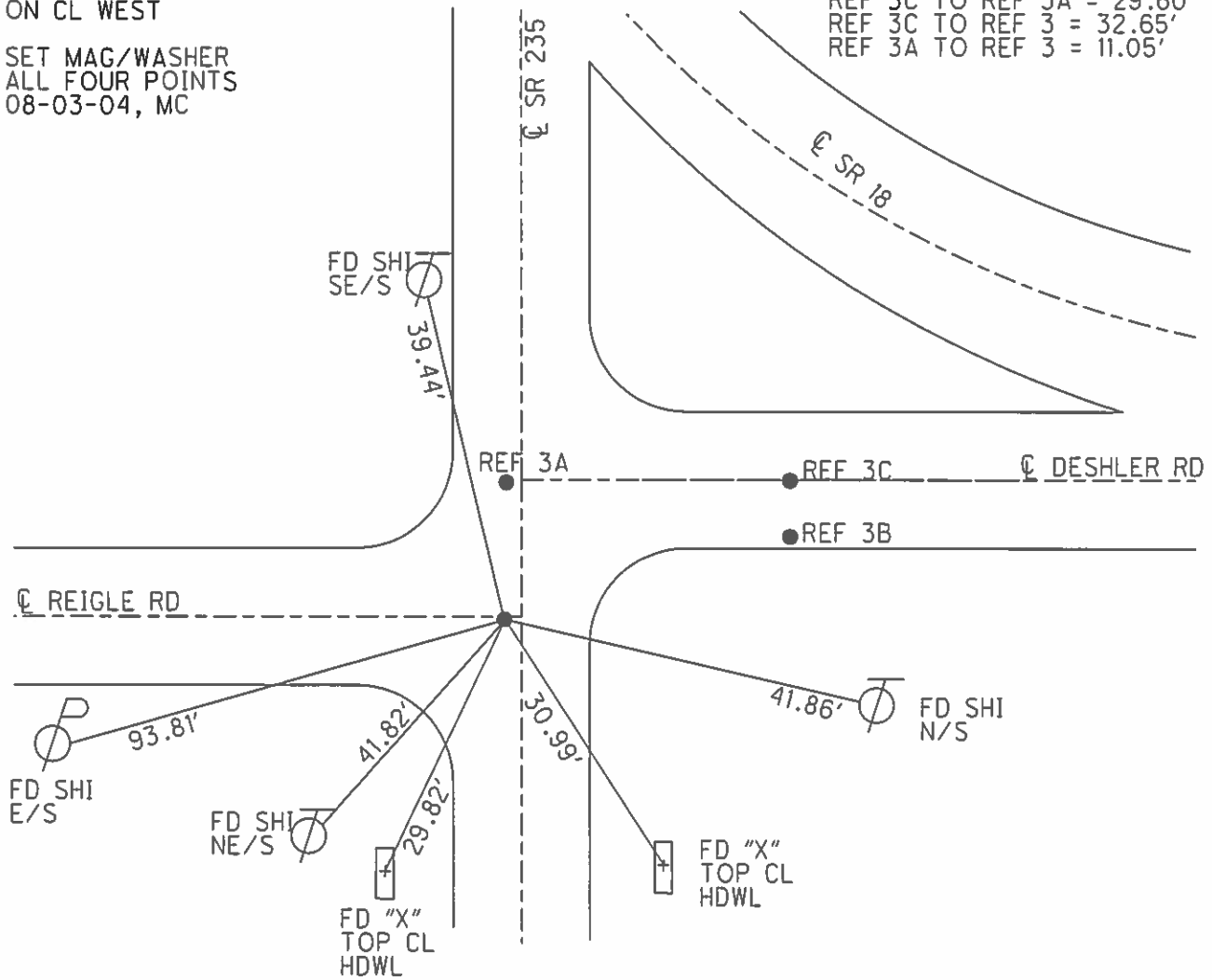

O.D.O.T. DISTRICT 2 SURVEY OFFICE (USE ONLY)

PERSONNEL _____ REFERENCE NO. 15 SHEET 1 OF 26
 NOTES BARNHISEL DATE 3/19/91 ROUTE SR 18
 H.C. LOEHRKE WEATHER CLOUDY/WINDY COUNTY WOOD
 R.C. HOFFMAN TEMP. 45° TOWNSHIP JACKSON
 _____ SECTION 26
 _____ T 3 N R 9 E

TYPE MONUMENT 1/2" IPIN
~~ON SURFACE~~ - BELOW 2.0"
 LEFT - ☉ PAV'T - RIGHT 11.0' S. OF ☉ E.
- TO - EDGE PAVEMENT
 S.L.M. 343+18

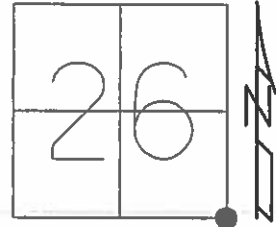

Grid: Northing: 554935.163 Easting: 1614977.299

NOTE:
 2.5' W. OF ☉ SR 235

FD MAG/WASHER
 GPS, SV D15
 6/16/10, BG

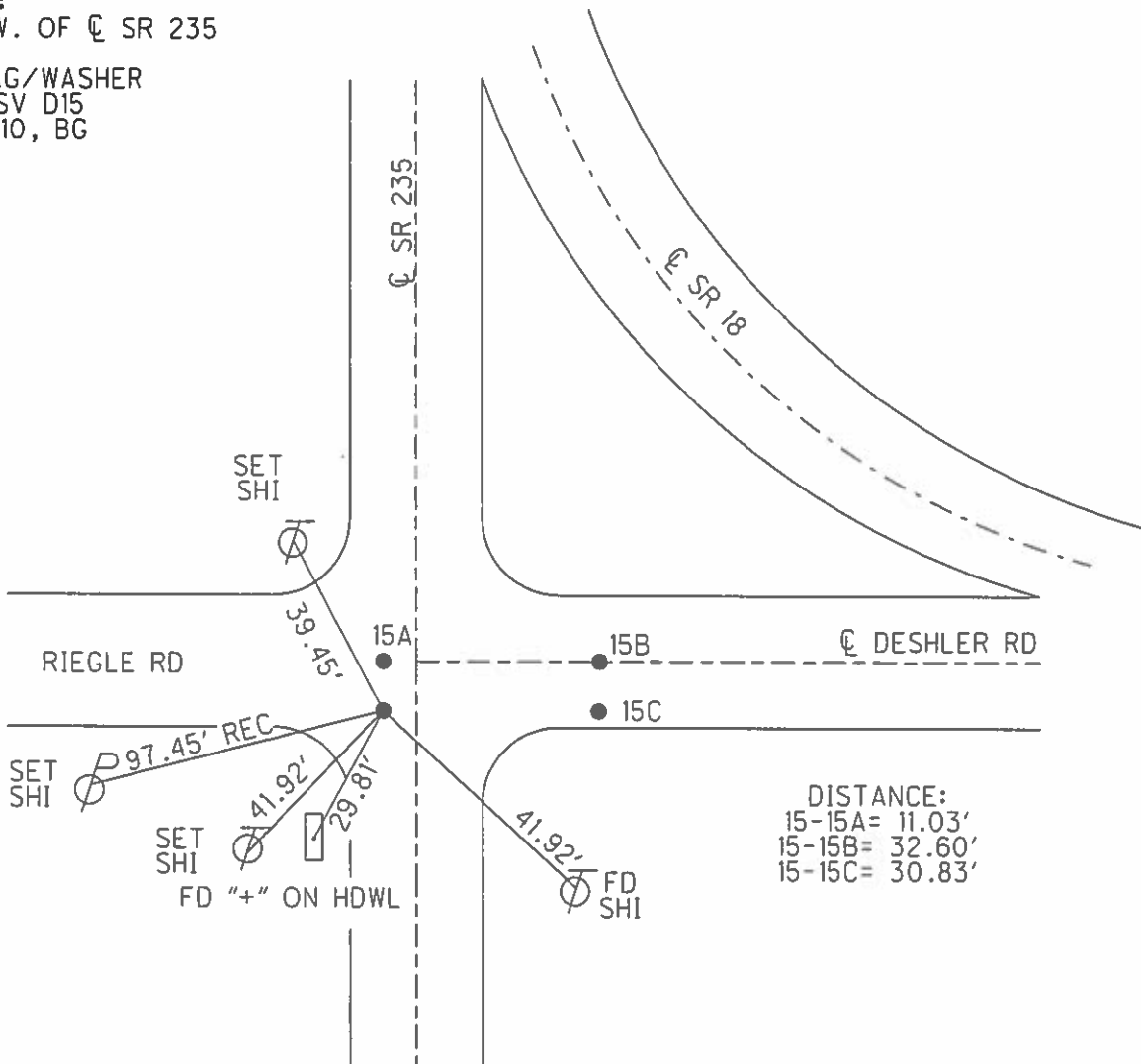

O.D.O.T. DISTRICT 2 SURVEY OFFICE (USE ONLY)

PERSONNEL	REFERENCE NO.	<u>15</u>	SHEET	<u>1</u>	OF	<u>26</u>
NOTES	<u>BARNHISEL</u>	DATE	<u>3/19/91</u>	ROUTE	<u>SR 18</u>	
H.C.	<u>LOEHRKE</u>	WEATHER	<u>CLOUDY/WINDY</u>	COUNTY	<u>WOOD</u>	
R.C.	<u>HOFFMAN</u>	TEMP.	<u>45°</u>	TOWNSHIP	<u>JACKSON</u>	
				SECTION	<u>26</u>	
				T	<u>3</u>	R
					<u>9</u>	<u>E</u>

TYPE MONUMENT 1/2" IPIN
~~ON SURFACE~~ - BELOW 2.0"
 LEFT - ☉ PAV'T - RIGHT 11.0' S. OF ☉ E.
- TO - EDGE PAVEMENT
 S.L.M. 343+18
 Grid: Northing: 1614977.299 Easting: 554935.163

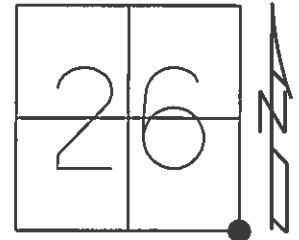

NOTE:
2.5' W. OF ☉ SR 235

FD MAG/WASHER
GPS, SV D15
6/16/10, BG

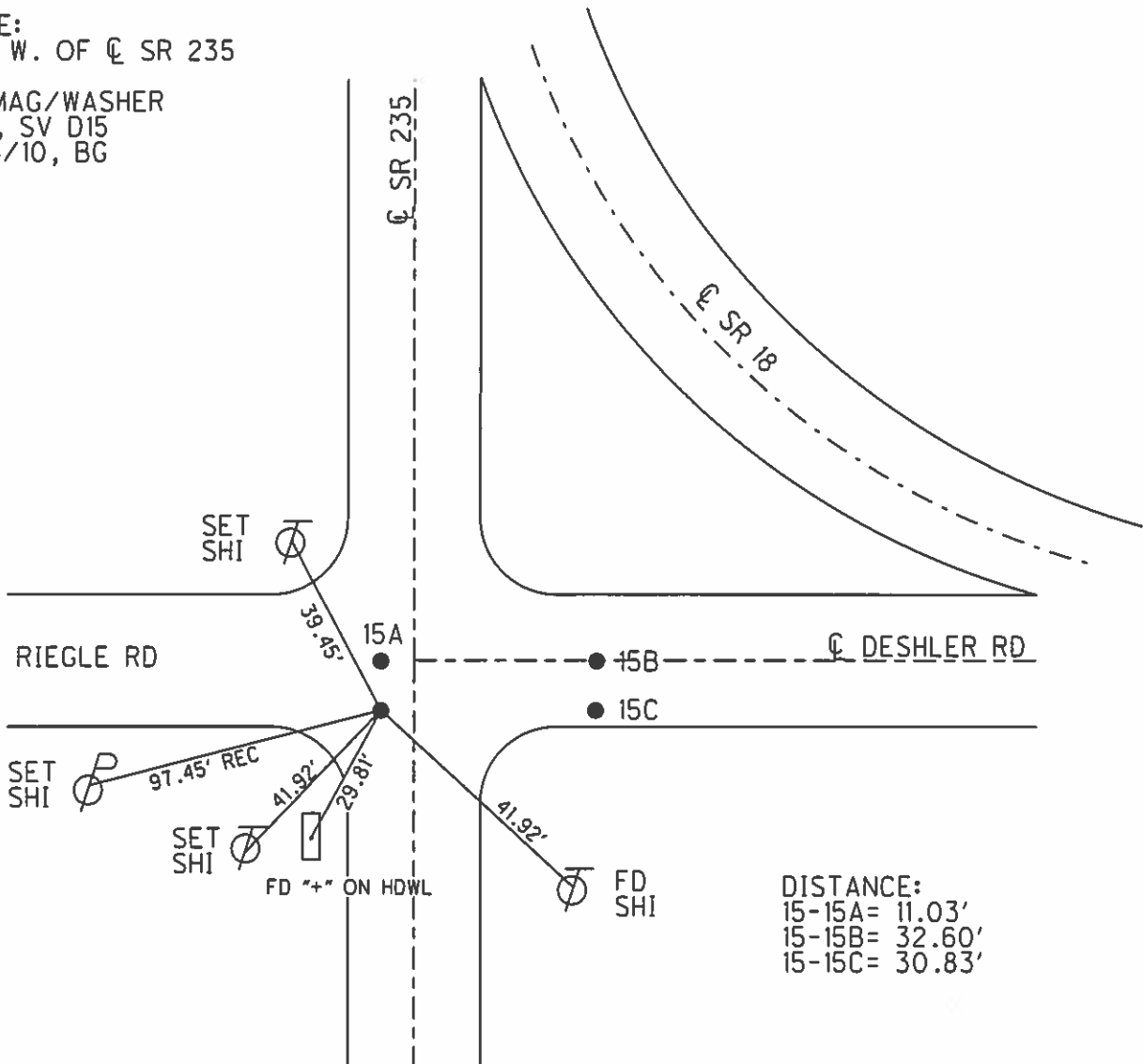

DISTANCE:
15-15A= 11.03'
15-15B= 32.60'
15-15C= 30.83'

O.D.O.T. DISTRICT 2 SURVEY OFFICE

PERSONNEL _____

REFERENCE NO. 15

SHEET _____ OF _____

NOTES BARNHISEL

H.C. Loehake

DATE 3-19-91

ROUTE 18 & 235

R.C. HOFFMAN

WEATHER cloudy - Windy

COUNTY Wood

TEMP. +45°

TOWNSHIP JACKSON

SECTION 26

T 3 N R 9 E

TYPE MONUMENT P.K.'s & Washers

ON SURFACE - BELOW YES (ALL)

LEFT- & PAV'T. - RIGHT INFORMATION Below

- TO - EDGE PAVEMENT

S.L.M. NOT COVERED IN 1991 RESURFACING OF S.R. 18

PT. "D"
1/2" IRON PIN
1 1/2" DOWN

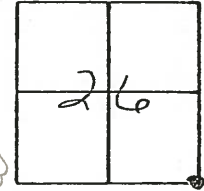

PT. "A"
11.0 S. OF & EAST,
27.5 E. OF & S.R. 235

PT. "B"
ON & PAVT E.
27.5 E. OF & S.R. 235

PT. "C"
ON & PAVT E.
2.2 W. OF & S.R. 235

PT. "D"
11.0 S. OF & E.
2.5 W. OF & S.R. 235
2" DOWN

A TO B	=	10.86
B TO C	=	29.58
A TO C	=	31.63
C TO D	=	11.03
D TO A	=	30.83
D TO B	=	32.60

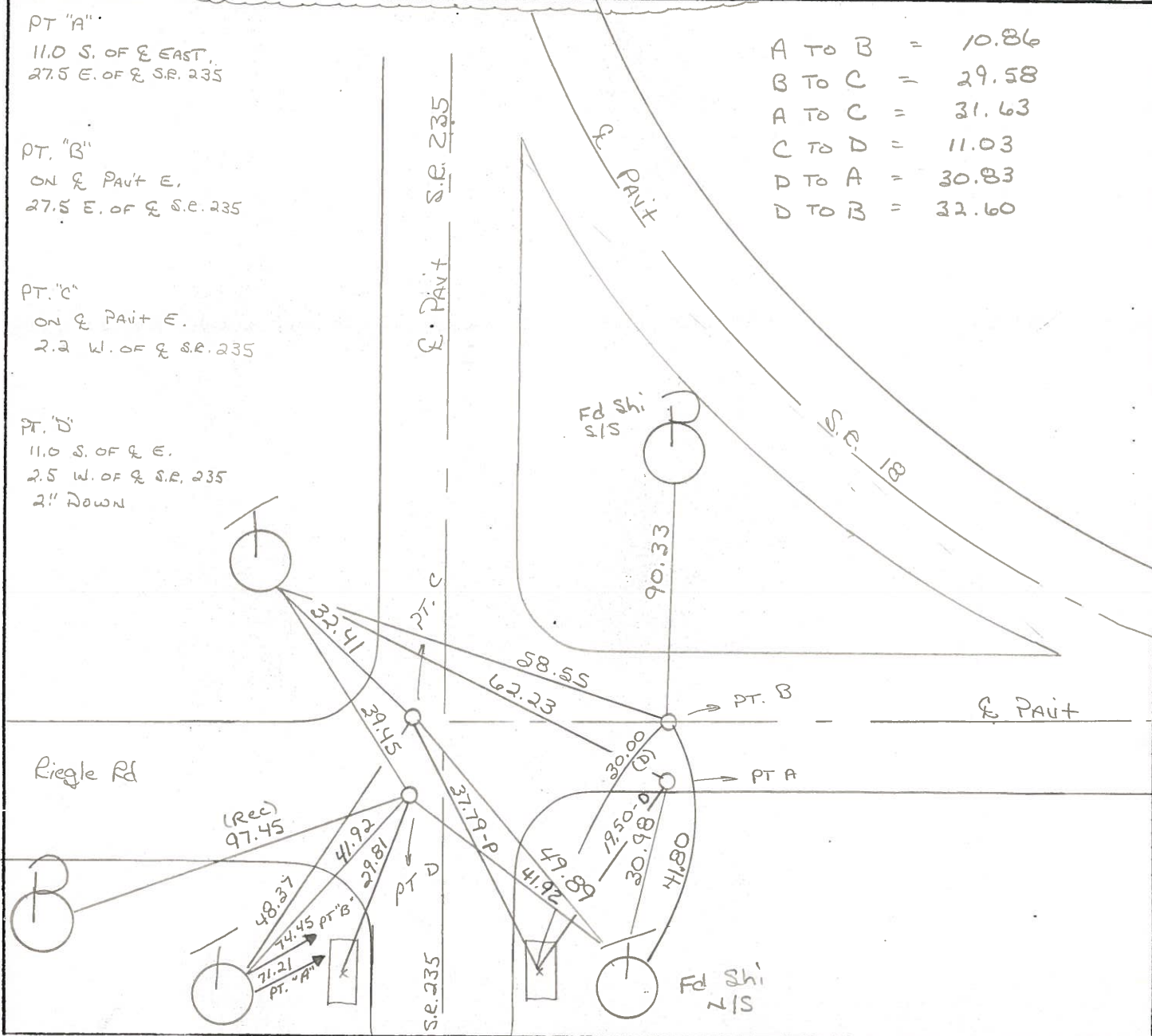

Ed "x" ON BOTH HDWS

County WOOD S.R. 18

Date 11-28-83

Township JACKSON

Weather RAIN, CLOUDY

Section 26

Temp. +40°

T N, R E

Personnel BARNHISEL H.C
HOUSEHOLDER R.C
LOEHRKE

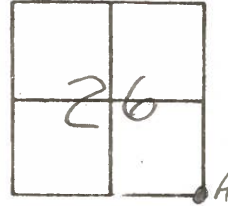

"A" RR SPIKE @ SURFACE OVER STONE
 SLM 53+75 (SR 235)
 10.9 S of & PAVT 18 #15
 27.1 E of & PAVT 235

"C" RR SPIKE @ SURFACE
 SLM 53+86 (SR 235)
 ON & PAVT SR 18 E
 2.5' W of & PAVT 235

#15

"B" BOAT SPIKE @ SURFACE
 SLM 53+86 (SR 235)
 ON CL PAVT 18
 27.1 E of & PAVT 235

SET PK+WASHEN
 @ ALL PTS
 7-25-85
 C.L.

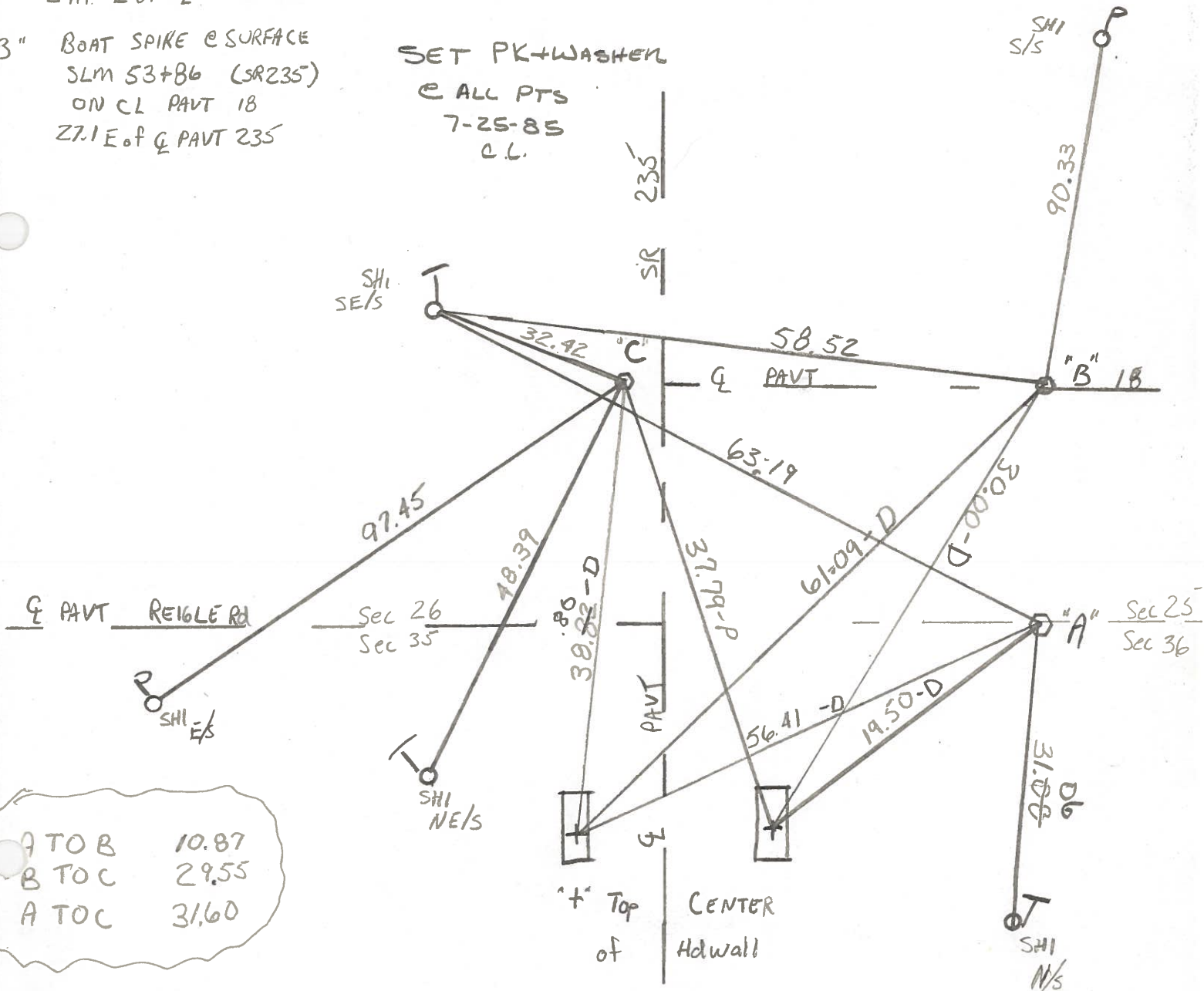

ATO B 10.87
 B TO C 29.55
 A TO C 31.60

County WOOD S.R. 18

Date 6-18-71

Township JACKSON

Weather CLEAR

Section 26

Temp. 88°

T3N, R9E

Personnel BURNSIDE

SMITH

BOWERS

HOLCOMBE

ROCCHINI

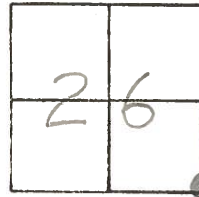

#15

STONE 30' E. OF P.I. &
11'-S. OF E OF SURVEY

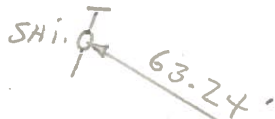

FD. 1" IRON ROD
OVER STONE

REIGLE ROAD

S.R. 18

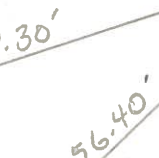

"+" ON CONC.
HOWL IN CTR.

EDGE PAVT.
S.R. 235