

O.D.O.T. DISTRICT 2 SURVEY OFFICE (USE ONLY)

PERSONNEL

REFERENCE NO. 16 D

SHEET 9 OF 52

NOTES AUBLE

DATE 5-23-23

ROUTE SR 18

H.C. NIESE

WEATHER CALM

COUNTY WOOD

R.C. AUBLE

TEMP. 79°

TOWNSHIP JACKSON

DWG BY NIESE

PID PAVETRAIN

SECTION 25

T 3 N R 9 E

TYPE MONUMENT MAG/WASHER

ON SURFACE - ~~BELOW~~ ON

OFFSET  $\odot$  PAVEMENT 3.4' LT : ~~RT~~

5.7' TO LT EDGE PAVEMENT

STATION: 394+24.51

HORZ. DATUM: NAD83(2011)

GEOID: NAVD88 2012A

GRID: NORTHING: 554955.024

EASTING: 1620083.350

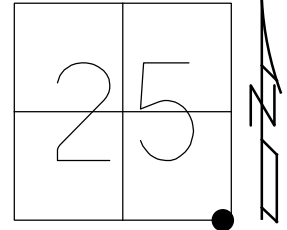

RECORD:  
 FD SM.P.K.NAIL  
 SET BY OTHERS  
 6/16/87  
 FD P.K. NAIL  
 6/16/10, BG  
 SET MAG/WASHER  
 9/1/11, MC  
 FD MAG/WASHER  
 REFD16  
 6/15/20, JFO  
 4/30/21, JFO  
 1/21/22, TDN  
 8-10-23, TDN

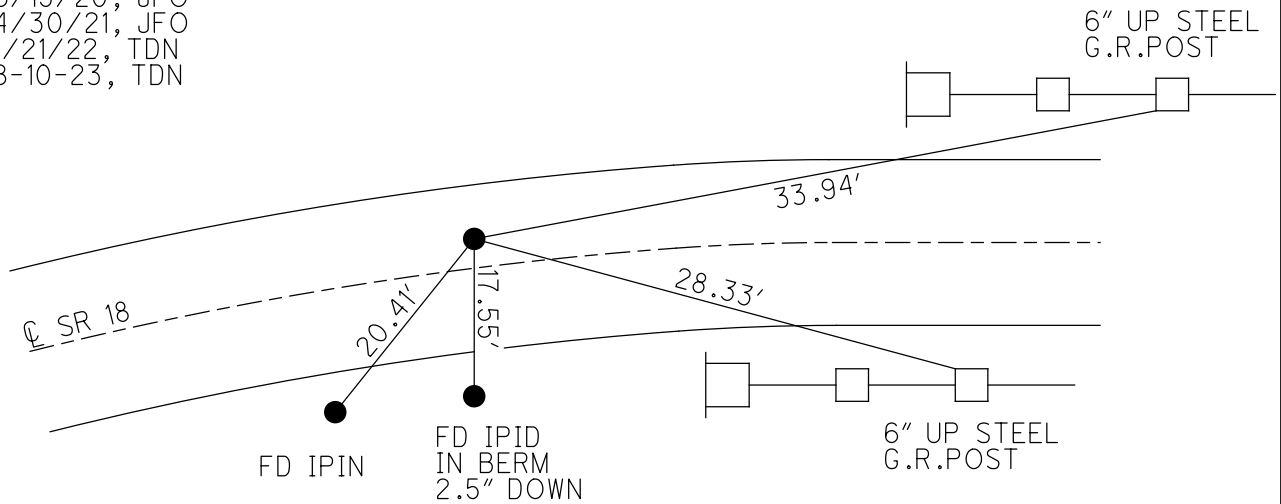

O.D.O.T. DISTRICT 2 SURVEY OFFICE (USE ONLY)

PERSONNEL

REFERENCE NO. 16 D

SHEET 9 OF 52

NOTES RHOADES  
 H.C. O'DONNELL  
 R.C. RHOADES

DATE 4/30/21  
 WEATHER CLOUDY  
 TEMP. 48°

ROUTE SR 18  
 COUNTY WOOD  
 TOWNSHIP JACKSON  
 SECTION 25

DWG BY NIESE PID PAVETRAIN

T 3 N R 9 E

TYPE MONUMENT MAG/WASHER

ON SURFACE - ~~BELOW~~ ON

OFFSET  $\text{C}$  PAVEMENT 3.4' LT : ~~RT~~

5.7' TO LT EDGE PAVEMENT

STATION: 394+24.51

HORZ.DATUM: NAD83(2011)

GEOID: NAVD88 2012A

GRID: NORTHING: 554955.024

EASTING: 1620083.350

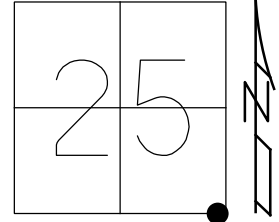

RECORD:  
 FD SM.P.K.NAIL  
 SET BY OTHERS  
 6/16/87  
 FD P.K. NAIL  
 6/16/10, BG  
 SET MAG/WASHER  
 9/1/11, MC  
 FD MAG/WASHER  
 REFD16  
 6/15/20, JFO  
 4/30/21, JFO  
 1/21/22, TDN

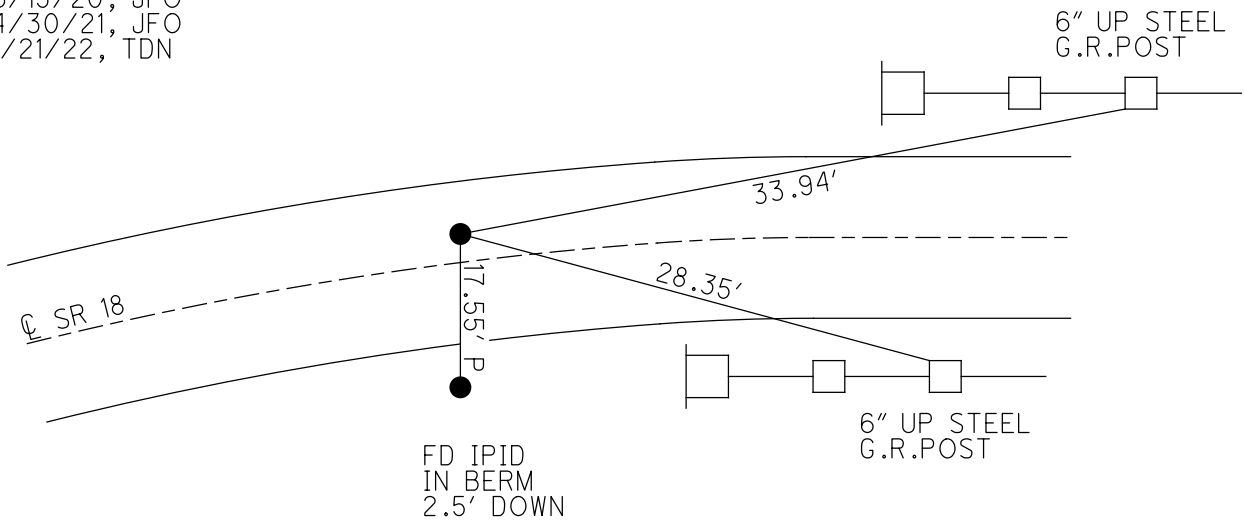

O.D.O.T. DISTRICT 2 SURVEY OFFICE (USE ONLY)

PERSONNEL \_\_\_\_\_ REFERENCE NO. 16 D SHEET 9 OF 51

NOTES CANTERBURY DATE 7/28/11 ROUTE SR 18  
 H.C. HUSS WEATHER CLOUDY COUNTY WOOD  
 R.C. HARBAUGH TEMP. 78° TOWNSHIP JACKSON  
 SECTION 25

DWG BY O'DONNELL PID PAVETRAIN T 3 N R 9 E

TYPE MONUMENT P.K./WASHER

ON SURFACE - ~~BELOW~~ ON \_\_\_\_\_

LEFT - ☉ PAV'T - ~~RIGHT~~ 3.4'

5.7' TO LT EDGE PAVEMENT

STATION: 394+24.51

HORIZ.DATUM: NAD83 (2011) GEOID: NAVD88-2012A

GRID: NORTHING: 554955.024 EASTING: 1620083.350

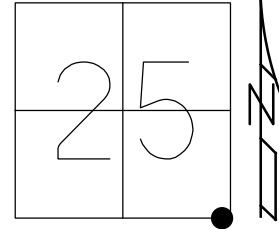

FD SM.P.K.NAIL FOR P.I.  
 SET BY OTHERS  
 FOR BRIDGE SURVEY  
 6/16/87

FD P.K.NAIL  
 6/15/10  
 GPS, SVE16  
 6/16/10, BG

SET MAG/WASHER  
 9/1/11, MC  
 FD MAG/WASHER  
 REFD16  
 6/15/20, JFO

183.79' TO ☉ OF  
 RANGE LINE RD

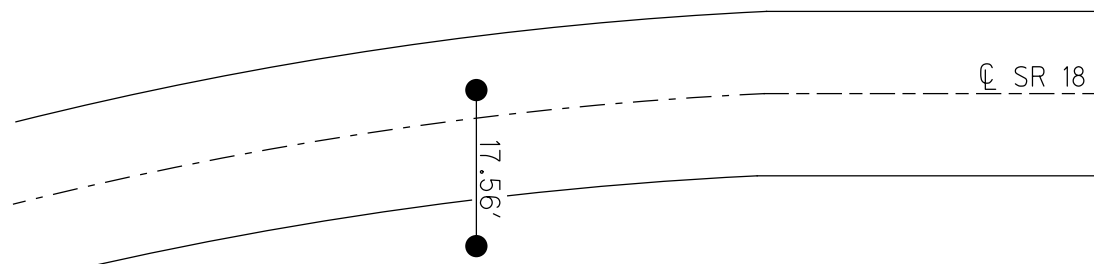

SET CAPPED  
 IPIN IN BERM  
 STONE

O.D.O.T. DISTRICT 2 SURVEY OFFICE (USE ONLY)

PERSONNEL \_\_\_\_\_ REFERENCE NO. 16 D SHEET 9 OF 26  
 NOTES CANTERBURY DATE 7/28/11 ROUTE SR 18  
 H.C. HUSS WEATHER CLOUDY COUNTY WOOD  
 R.C. HARBAUGH TEMP. 78° TOWNSHIP JACKSON  
 \_\_\_\_\_ SECTION 25  
 \_\_\_\_\_ T 3 N R 9 E

TYPE MONUMENT P.K./WASHER  
 ON SURFACE - ~~BELOW~~ ON  
 LEFT - ☉ PAV'T - ~~RIGHT~~ 3.4'  
5.7' TO LT EDGE PAVEMENT  
 S.L.M. 394+24.51

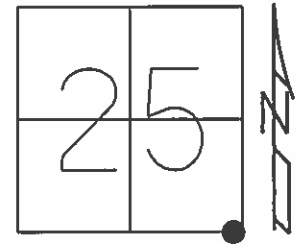

Grid: Northing: 554955.073 Easting: 1620083.277

FD SM.P.K.NAIL FOR P.I.  
 SET BY OTHERS  
 FOR BRIDGE SURVEY  
 6/16/87  
  
 FD P.K.NAIL  
 6/15/10  
 GPS, SVE16  
 6/16/10, BG  
  
 SET MAG/WASHER  
 9/1/11, MC

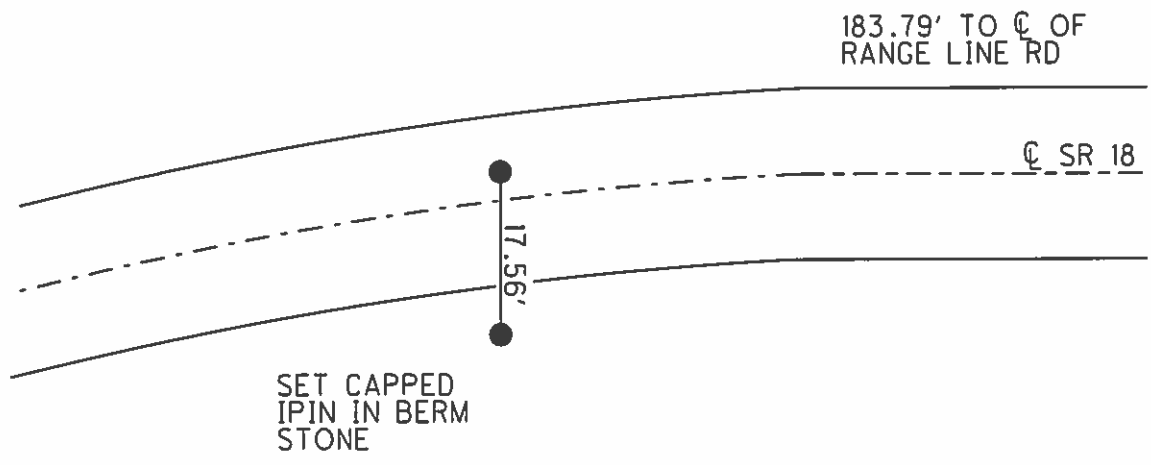

# O.D.O.T. DISTRICT 2 SURVEY OFFICE

PERSONNEL

REFERENCE NO. 16D

SHEET 2B OF \_\_\_\_\_

NOTES HOFFMAN

H.C. LOEHRKE

DATE 6-16-87

ROUTE SR 18

R.C. BARNHISEL

WEATHER CLEAR

COUNTY WOOD

SOCKMAN

TEMP. 85°

TOWNSHIP JACKSON

SECTION 25

T 3 N R 9 E

TYPE MONUMENT SMALL P.K. Nail - By OTHERS

ON SURFACE - BELOW YES

LEFT- & PAV'T. - RIGHT 3.6'

4.6 TO LT EDGE PAVEMENT

S.L.M. 395 +17

*Set PK/washer  
7-7-87  
C.L.*

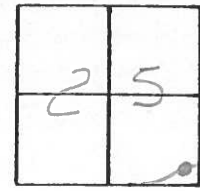

FD SMALL P.K. FOR P.I. FOR BRIDGE SURVEY - By OTHERS -

