

O.D.O.T. DISTRICT 2 SURVEY OFFICE (USE ONLY)

PERSONNEL

REFERENCE NO. 18

SHEET 13 OF 52

NOTES RHOADES DATE 4/30/21

H.C. O'DONNELL WEATHER CLOUDY

R.C. RHOADES TEMP. 48°

ROUTE SR 18

COUNTY WOOD

TOWNSHIP HENRY

SECTION 30

DWG BY NIESE PID PAVETRAIN

T 3 N R 10 E

TYPE MONUMENT MAG/WASHER

ON SURFACE - ~~BELOW~~ ON

OFFSET \odot PAVEMENT 6.4' ~~LT~~ : RT

3.2' TO RT EDGE PAVEMENT

STATION: 422+75.33

HORZ.DATUM: NAD83(2011)

GEOID: NAVD88 2012A

GRID: NORTHING: 554903.637

EASTING: 1622933.535

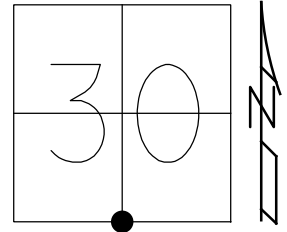

RECORD:
 SET P.K./WASHER
 7/7/87, CL
 FD P.K.NAIL
 6/16/10, BG
 7/28/11, MC
 SET MAG/WASHER
 1/25/12, SAH
 FD MAG/WASHER
 REF18
 6/15/20, JFO
 4/30/21, JFO
 1/21/22, TDN
 8-10-23, TDN

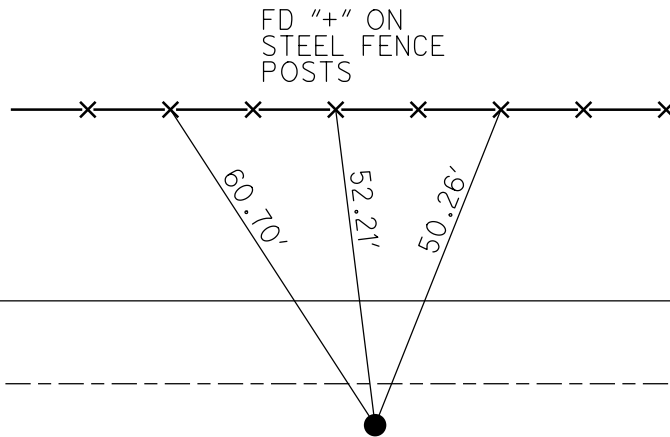

O.D.O.T. DISTRICT 2 SURVEY OFFICE (USE ONLY)

PERSONNEL _____

REFERENCE NO. 18

SHEET 13 OF 52

NOTES RHOADES DATE 4/30/21
 H.C. O'DONNELL WEATHER CLOUDY
 R.C. RHOADES TEMP. 48°

ROUTE SR 18
 COUNTY WOOD
 TOWNSHIP HENRY
 SECTION 30

DWG BY NIESE PID PAVETRAIN

T 3 N R 10 E

TYPE MONUMENT MAG/WASHER

ON SURFACE - ~~BELOW~~ ON

OFFSET 6.4' ~~ET~~ : RT

3.2' TO RT EDGE PAVEMENT

STATION: 422+75.33

HORIZ.DATUM: NAD83(2011)

GEOID: NAVD88 2012A

GRID: NORTHING: 554903.637

EASTING: 1622933.535

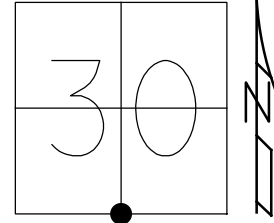

RECORD:
 SET P.K./WASHER
 7/7/87, CL
 FD P.K.NAIL
 6/16/10, BG
 7/28/11, MC
 SET MAG/WASHER
 1/25/12, SAH
 FD MAG/WASHER
 REF18
 6/15/20, JFO
 4/30/21, JFO
 1/21/22, TDN

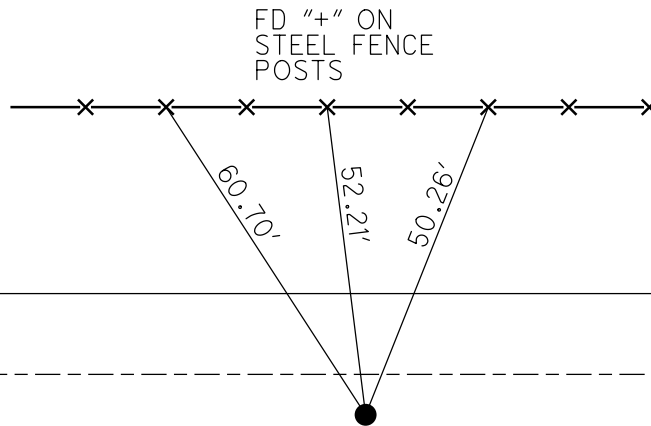

☉ SR 18

O.D.O.T. DISTRICT 2 SURVEY OFFICE (USE ONLY)

PERSONNEL _____ REFERENCE NO. 18 SHEET 13 OF 26
 NOTES CANTERBURY DATE 7/28/11 ROUTE SR 18
 H.C. CANTERBURY WEATHER CLEAR COUNTY WOOD
 R.C. HARBAUGH TEMP. 85° TOWNSHIP HENRY
 _____ SECTION 30
 _____ T 3 N R 10 E

TYPE MONUMENT P.K./NAIL
 ON SURFACE - ~~BELOW~~ ON _____
~~LEFT~~ - CL PAV'T - RIGHT 6.4'
3.2' TO RT EDGE PAVEMENT
 S.L.M. 422+75.33
 Grid: Northing: 554903.725 Easting: 1622933.635

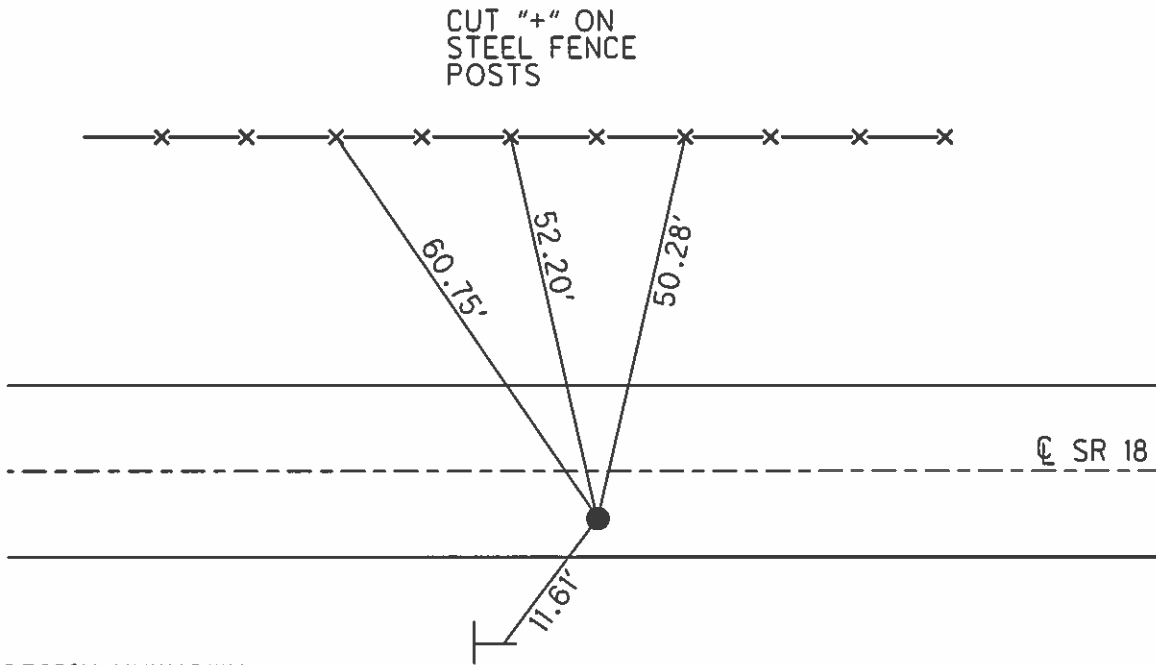
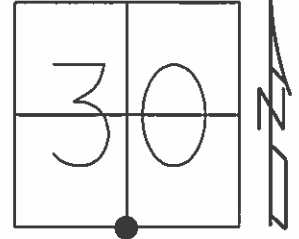

ORIGIN UNKNOWN
 APPARENT 1/4 COR.

SET P.K./WASHER
 7/7/87, CL

FD P.K.NAIL
 6/15/10
 GPS, SV18
 6/16/10, BG

SET MAG/WASHER
 1/25/12, SAH

CUT NOTCH
 2.5' UP
 SIGN POST
 8 MM

O.D.O.T. DISTRICT 2 SURVEY OFFICE

PERSONNEL

REFERENCE NO. 18

SHEET 4 OF _____

NOTES HOFFMAN

H.C. LOSHRKE

R.C. BARNHISEL

Sockman

DATE 6-17-87

WEATHER CLEAR

TEMP. 80°

ROUTE SR 18

COUNTY WOOD

TOWNSHIP HENRY

SECTION 30

T.3 N/R 10 E

TYPE MONUMENT P.K. Nail

ON SURFACE - ~~BELOW~~ YES

LEFT - C. PAV'T. - RIGHT S.G.

3A TO RT EDGE PAVEMENT

S.L.M. 423 + 68

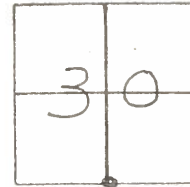

ORIGINAL UNKNOWN ON P.K.
APPARENT 1/2 CORNER

STA 424 + 01.06 BY OTHERS FOR BRIDGE SURVEY

SET P.K./WASHER
7-7-87 C.L.

