

O.D.O.T. DISTRICT 2 SURVEY OFFICE (USE ONLY)

PERSONNEL \_\_\_\_\_ REFERENCE NO. 31 SHEET 2 OF 35  
 NOTES BARNHISEL DATE 9/11/92 ROUTE SR 18  
 H.C. VAN DUSEN WEATHER SUNNY COUNTY WOOD  
 R.C. KUSZ TEMP. 70° TOWNSHIP BLOOM  
 SECTION 31  
 DWG BY MILLER PID 93417 T 3 N R 11 E

TYPE MONUMENT SMALL R.R. SPIKE  
 ON SURFACE - ~~BELOW~~ ON  
 OFFSET 14.5' TO LT EDGE PAVEMENT 1.0' LT : ~~RT~~  
 STATION: 752+78.75

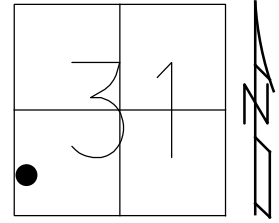

HORZ.DATUM: NAD83 (2011) GEOID: 2012A  
 GRID: NORTHING: 550726.948 EASTING: 1652663.278

RECORD: P.C.  
 STA 753+13.15  
 FD SM R.R. SPIKE  
 9/11/92, MB  
 FD MONBOX W/IPIN  
 REF31  
 8/4/14, DCH

NOTE:  
 P.I. CURVE DATA  
 STA = 755+36.59  
 $\Delta = 6^{\circ}41'45''$   
 $D = 1^{\circ}30'00''$   
 $L = 446.39'$   
 $T = 223.45'$   
 $R = 3819.72'$

SET SHI'S  
 GR POSTS

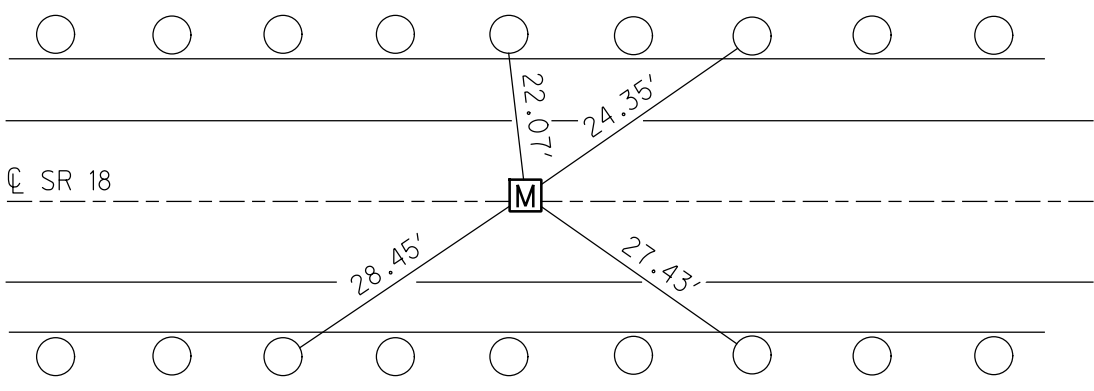

# O.D.O.T. DISTRICT 2 SURVEY OFFICE

PERSONNEL \_\_\_\_\_

REFERENCE NO. \_\_\_\_\_

SHEET \_\_\_\_\_ OF \_\_\_\_\_

NOTES BARNHISEL

H.C. VAN DUSEN

R.C. KUSZ

DATE 9-11-92

WEATHER SUNNY

TEMP. +70°

ROUTE 18

COUNTY WOOD

TOWNSHIP Bloom

SECTION 31

T3 N R 11 E

TYPE MONUMENT Sm RR Spk

ON SURFACE - ~~BELOW~~ yes

LEFT-~~☉~~ PAV'T. - ~~RIGHT~~ 1.0

14.5 TO LT EDGE PAVEMENT

S.L.M. 753+13.15

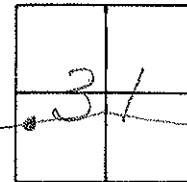

RECORD:  
P.C. = 753+13.15

CURVE DATA  
P.I. 755+36.59  
 $\Delta = 6^{\circ}-41'-45''$   
 $D = 1^{\circ}-30'-00''$   
 $L = 446.39$   
 $T = 223.45$   
 $R = 3819.72$

