

O.D.O.T. DISTRICT 2 SURVEY OFFICE (USE ONLY)

PERSONNEL

REFERENCE NO. 39 A

SHEET 25 OF 36

NOTES ASTON

DATE 8/10/23

ROUTE SR 18

H.C. NIESE

WEATHER CLOUDY

COUNTY WOOD

R.C. AUBLE

TEMP. 74°

TOWNSHIP BLOOM

SECTION 35

DWG BY RHOADES PID 95796

T 3 N R 11 E

TYPE MONUMENT MAG WASHER

ON SURFACE - ~~BELOW~~ ON

OFFSET  $\text{C}$  PAVEMENT 0.9' LT : ~~RT~~  
9.8' TO LT EDGE PAVEMENT

STATION: 992+06.60

HORZ. DATUM: NAD83 (2011)

GEOID: NAVD88 2018

GRID: NORTHING: 550678.900

EASTING: 1675643.817

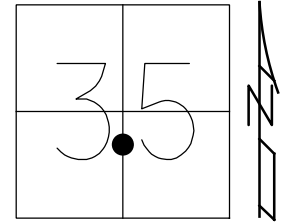

RECORD:  
 FD P.K./WASHER  
 6/8/99, MB  
 SET P.K./WASHER  
 7/20/99, TR  
 FD MAG SPIKE  
 REFA39  
 8/26/14, DCH  
 SET MAG/WASHER  
 3" DOWN  
 11/5/20, JFO  
 SET MAG/WASHER  
 REFA39  
 8-10-23, TDN

WOOD LDP:  
 N: 372827.996  
 E: 187767.260

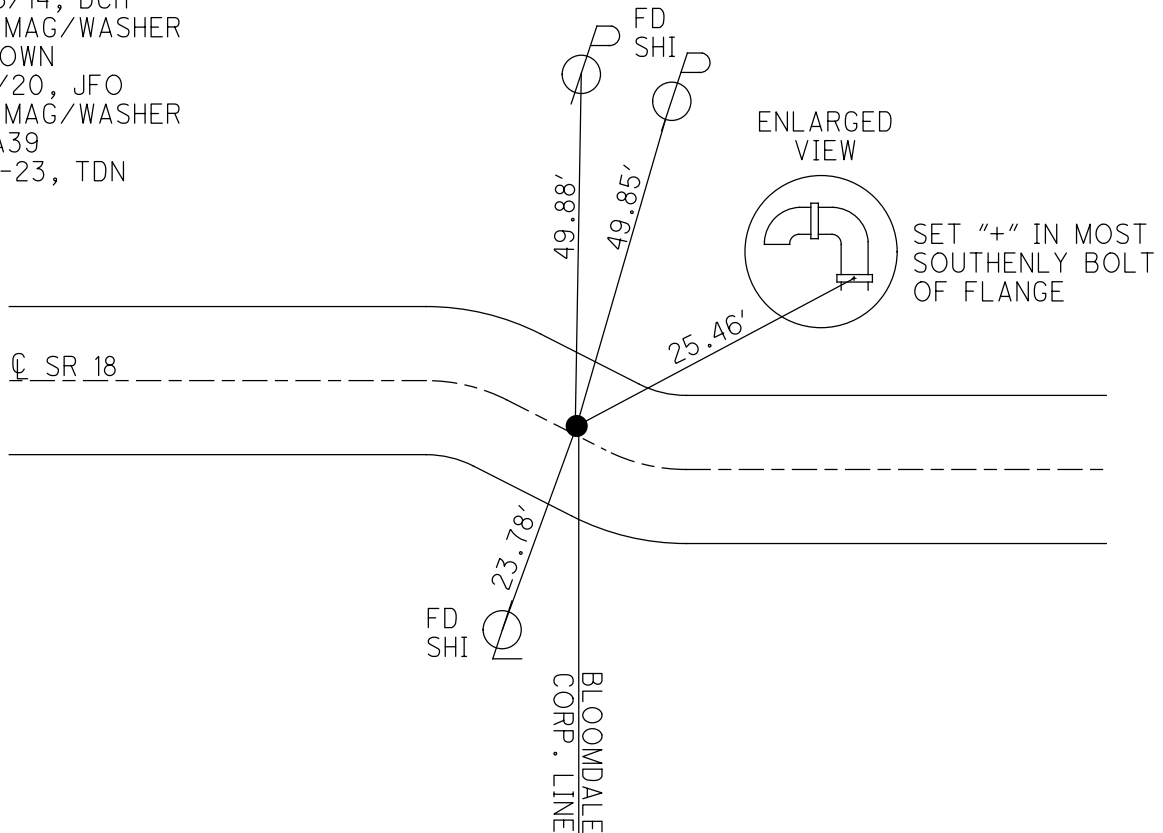

O.D.O.T. DISTRICT 2 SURVEY OFFICE (USE ONLY)

PERSONNEL	REFERENCE NO. <u>39 A</u>	SHEET <u>25</u> OF <u>35</u>
NOTES <u>HOMAN</u>	DATE <u>8/26/14</u>	ROUTE <u>SR 18</u>
H.C. <u>LEU</u>	WEATHER <u>SUNNY</u>	COUNTY <u>WOOD</u>
R.C. <u>HOMAN</u>	TEMP. <u>80°</u>	TOWNSHIP <u>BLOOM</u>
		SECTION <u>35</u>
DWG BY <u>MILLER</u>	PID <u>93417</u>	T <u>3</u> N R <u>11</u> E

TYPE MONUMENT MAG SPIKE  
 ON SURFACE - ~~BELOW~~ 3"  
 OFFSET  $\text{C}$  PAVEMENT 0.9' ~~LT~~ : RT  
9.8' TO LT EDGE PAVEMENT  
 STATION: 992+06.60

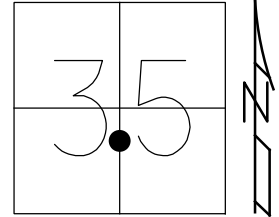

HORIZ.DATUM: NAD83 (2011) GEOID: 2012A  
 GRID: NORTHING: 550678.874 EASTING: 1675643.814

RECORD:  
 FD P.K./WASHER  
 6/8/99, MB  
 SET P.K./WASHER  
 7/20/99, TR  
 FD P.K./ WASHER  
 REFA39  
 8/26/14, DCH

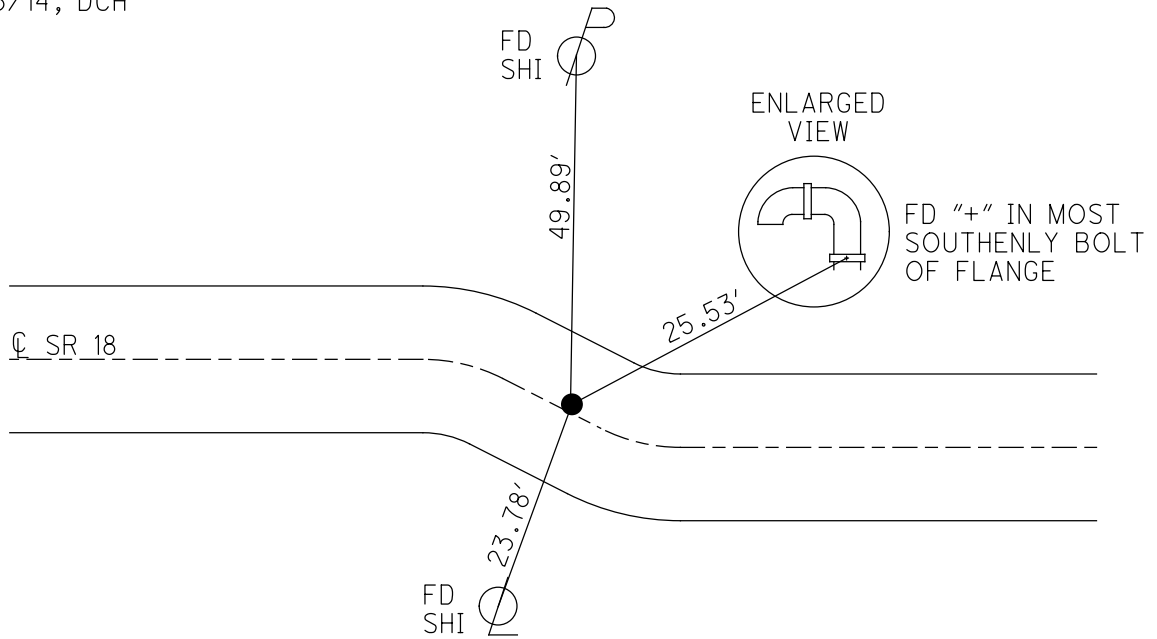

# O.D.O.T. DISTRICT 2 SURVEY OFFICE

PERSONNEL \_\_\_\_\_

REFERENCE NO. 39A

SHEET 19 OF 29

NOTES Barthol

H.C. Canterbury

R.C. Rouses III

DATE 6.8.99

WEATHER Sunny

TEMP. +90°

ROUTE SR 18

COUNTY Wood

TOWNSHIP Bloom

SECTION 35

T 3 N R 11 E

TYPE MONUMENT PK + WASHER

ON SURFACE - ~~BELOW~~ Surface

LEFT - ~~0~~ PAV'T. - RIGHT 0.9'

9.8 TO Lt EDGE PAVEMENT

S.L.M. 991+80

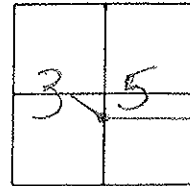

Reset  
PK + Washer  
7.20.99  
TR

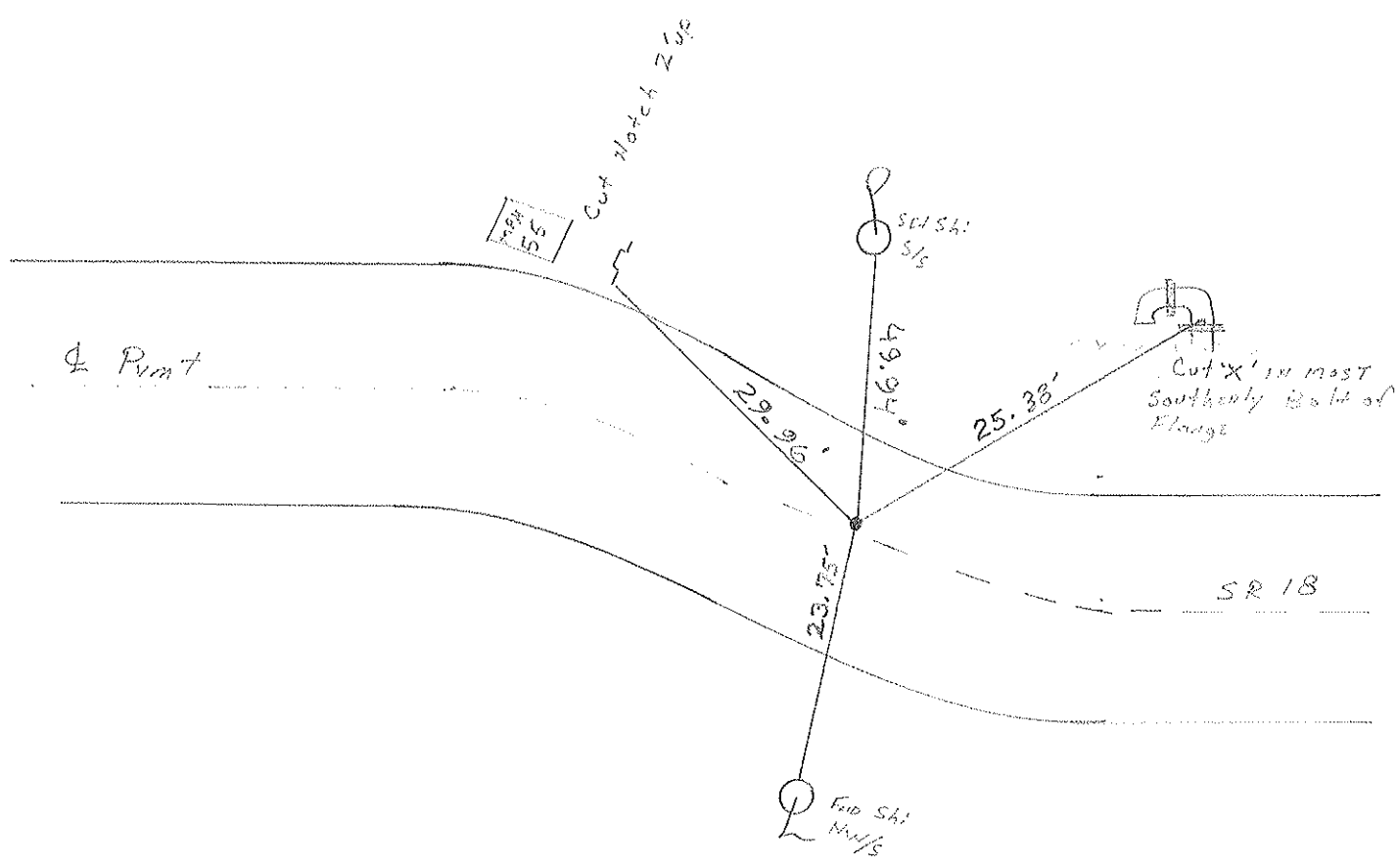

# O.D.O.T. DISTRICT 2 SURVEY OFFICE

PERSONNEL \_\_\_\_\_

REFERENCE NO. 39-A

SHEET \_\_\_\_\_ OF \_\_\_\_\_

NOTES Hoffman

H.C. BARNHISEL

R.C. LOSHRAGE

DATE 5-14-86

WEATHER cloudy

TEMP. 65°

ROUTE SR 18

COUNTY WOOD

TOWNSHIP Bloom

SECTION 35

T3 N R 11 E

TYPE MONUMENT P.K. nail By OTHERS

ON SURFACE - ~~BELOW~~ yes

LEFT-~~C~~ PAV'T. - ~~RIGHT~~ 0.9

9.6 TO LT EDGE PAVEMENT

S.L.M. 990 + 96

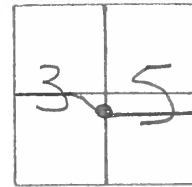

Possibly on section line

Set P/K + washer  
 6-17-86  
 TTD B

