

8016

STATE OF OHIO
DEPARTMENT OF TRANSPORTATION

FED. RD. DIVISION	STATE	PROJECT
2	OHIO	STATE

W00-20-2.18
Plan No. BR-2-72

1
6

MICROFILMED
1978
REPRODUCTION

MICROFILMED
MAR 15 1979
REPRODUCTION

MICROFILMED
MAR 15 1979
REPRODUCTION

W00-20-2.18
CITY OF PERRYSBURG
WOOD COUNTY

ISSUE 1

1973 SPECIFICATIONS

The standard specifications of the State of Ohio, Department of transportation, including changes and supplemental specifications listed in the proposal shall govern this improvement. The right of way for this improvement will be provided by the State of Ohio. I hereby approve these plans and declare that the making of this improvement will require the closing to traffic of the highway and that detours will be provided as indicated on the plans.

- Approved Lloyd H. Wadsworth
Date 9-20-72 Mayor of Perrysburg
- Approved Gene M. Carleton
Date 7-26-72 District Deputy Director of Transportation
- Approved H. Krause
Date 11-2-72 Engineer, Bureau of Bridges
- Approved E. J. Schaefer
Date 11-1-72 Engineer, Bureau of Roadway Design
- Approved H. Krause
Date 11-2-72 Assistant Deputy Director for Highway Design
- Approved _____
Date _____ Assistant Deputy Director for Real Estate
- Approved William Bunkley
Date 11-2-72 Assistant Deputy Director for Program Development
- Approved _____
Date _____ Chief Engineer, Division of Highways
- Approved R. M. Neelings
Date 11-2-72 Deputy Director, Division of Highways
- Approved William P. McKenna
Date 11-3-72 Assistant Director, Department of Transportation
- Approved Philip Bunkley
Date 11-6-72 Director, Department of Transportation

CONVENTIONAL SIGNS

County Line	-----	Limited Access (only)	-----	LA
Township Line	-----	Right of Way (only)	-----	RW
Section Line	-----	Limited Access & Right of Way	-----	LA&RW
Corporation Line	----- or -----	Existing Right of Way	-----	
Fence Line (existing)	----- (proposed) -----	Property Line (in existing fence)	-----	
Center Line	-----	Railroad	-----	
Trees, Stumps (to be removed)	-----	Guardrail (existing)	----- (proposed) -----	
Utility Poles: Telephone, Power, Light	-----			

INDEX OF SHEETS

Title sheet	1
Typical section	2
General notes	2
Sub-summaries	3 & 4
Calculations	3
General summary	3
Plan and profile	4
Cross sections	5
Channel sections	6

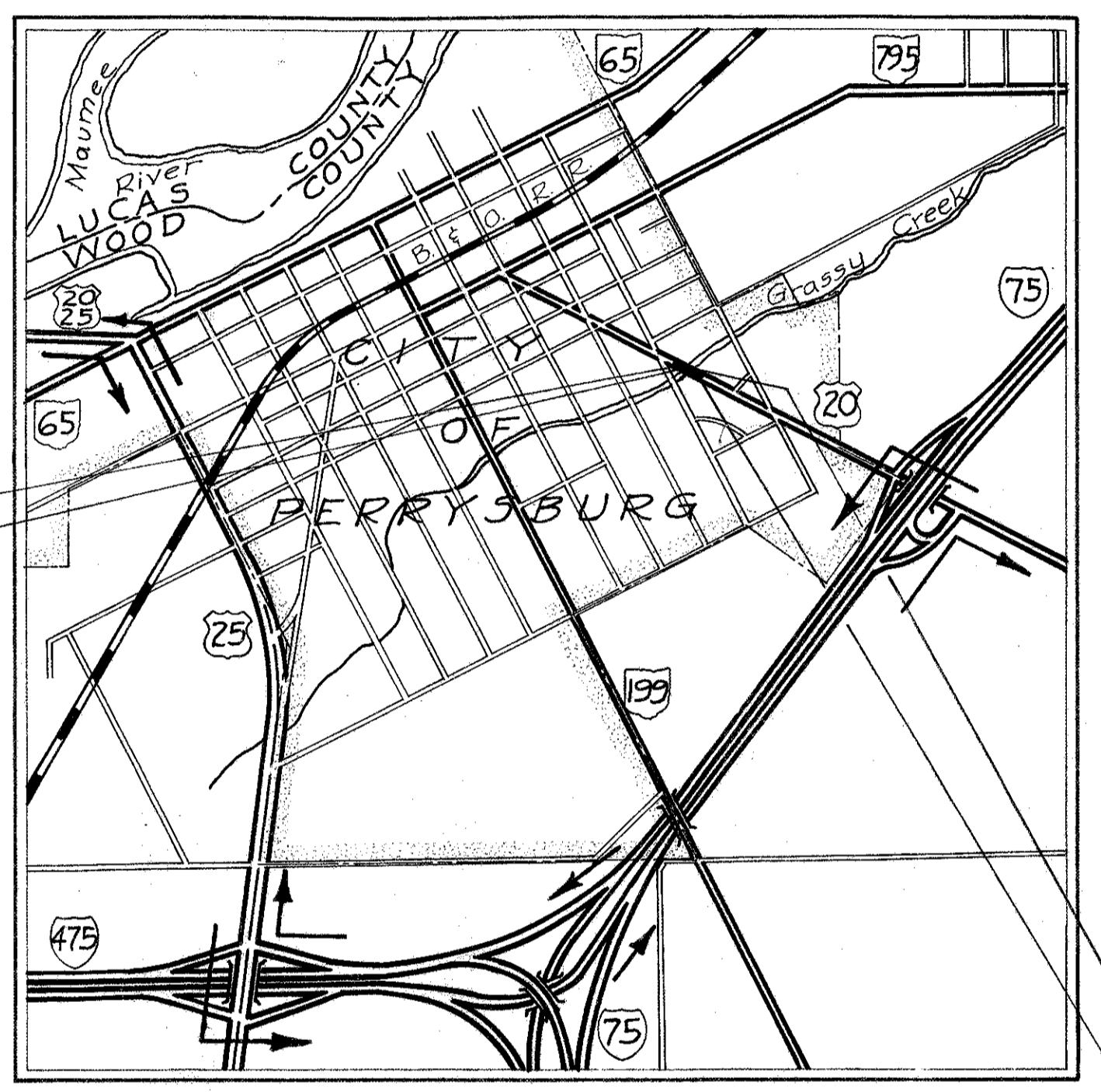

LOCATION MAP

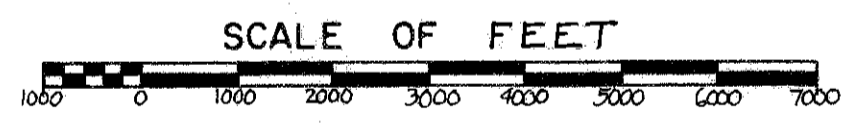

Portion to be improved -----

State Roads -----

Other Roads -----

Detour shown thus -----

SCALES

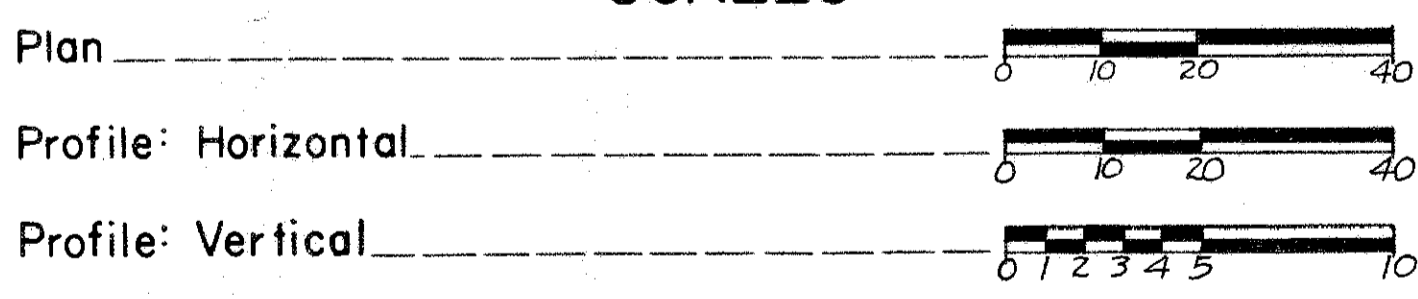

LINE DATA

Begin Project 2+11
End Project 2+58.5
Net Length Project = 47.5 Lin. Ft. = .008 Miles

Begin Work 1+75
End Work 3+38
Net Length Work = 163 Lin. Ft. = 0.030 Miles

STANDARD CONSTRUCTION DRAWINGS			
CB 2-2-A&B	6-1-65	BP-2	12-1-68
CB 2-3&2-4	6-1-65		
GR-2A	1-1-71		
GR-2B	11-9-71		
GR-4	11-9-71		
MC-3	6-20-69		
SP-53	6-30-61		
BP-5	6-1-72		
L-1	6-1-65		
MC-4	6-13-69		

Supplemental Specifications	1-1-69
1000	1-1-69

Project: WOOD COUNTY W00-20-2.18
Date of Letting 19, Contract No.

JSL 6/19/71
222 6/10/71

W00-20-2.18
Plan No. BR-2-72

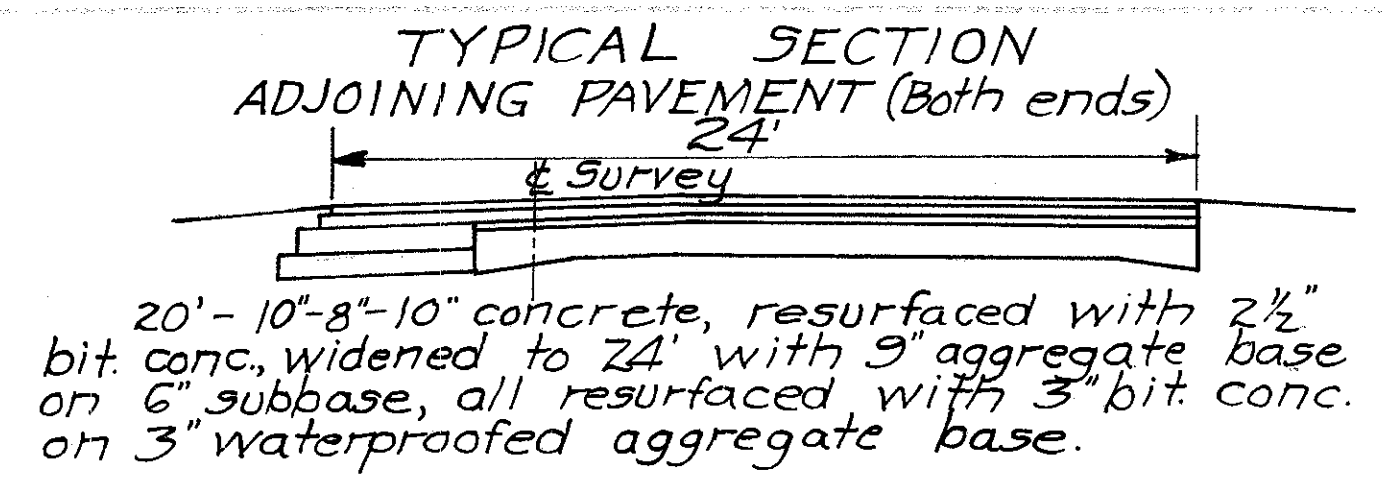

EXISTING STRUCTURE DATA
Bridge No W00 20-0218
Sta: 2+34.5 & Survey
Type: Reinf. conc. slab with original 4" conc. wearing surface resurfaced with 3" bit conc., type RR-4 conc. rail and conc. sub structure
Span: 24'-0"
Roadway: 34'-0"
Approach Slabs: 11'-0"
Skew: None
Condition: Poor - to be removed-202.

PROPOSED STRUCTURE DATA
Sta: 2+38 & Survey
Type: 84' Reinforced concrete elliptical concrete pipe 87"x136" (108" equivalent round) with SP-53 endwalls and reinforced concrete slope protection each end.
Skew: None
Roadway: 44'-0"

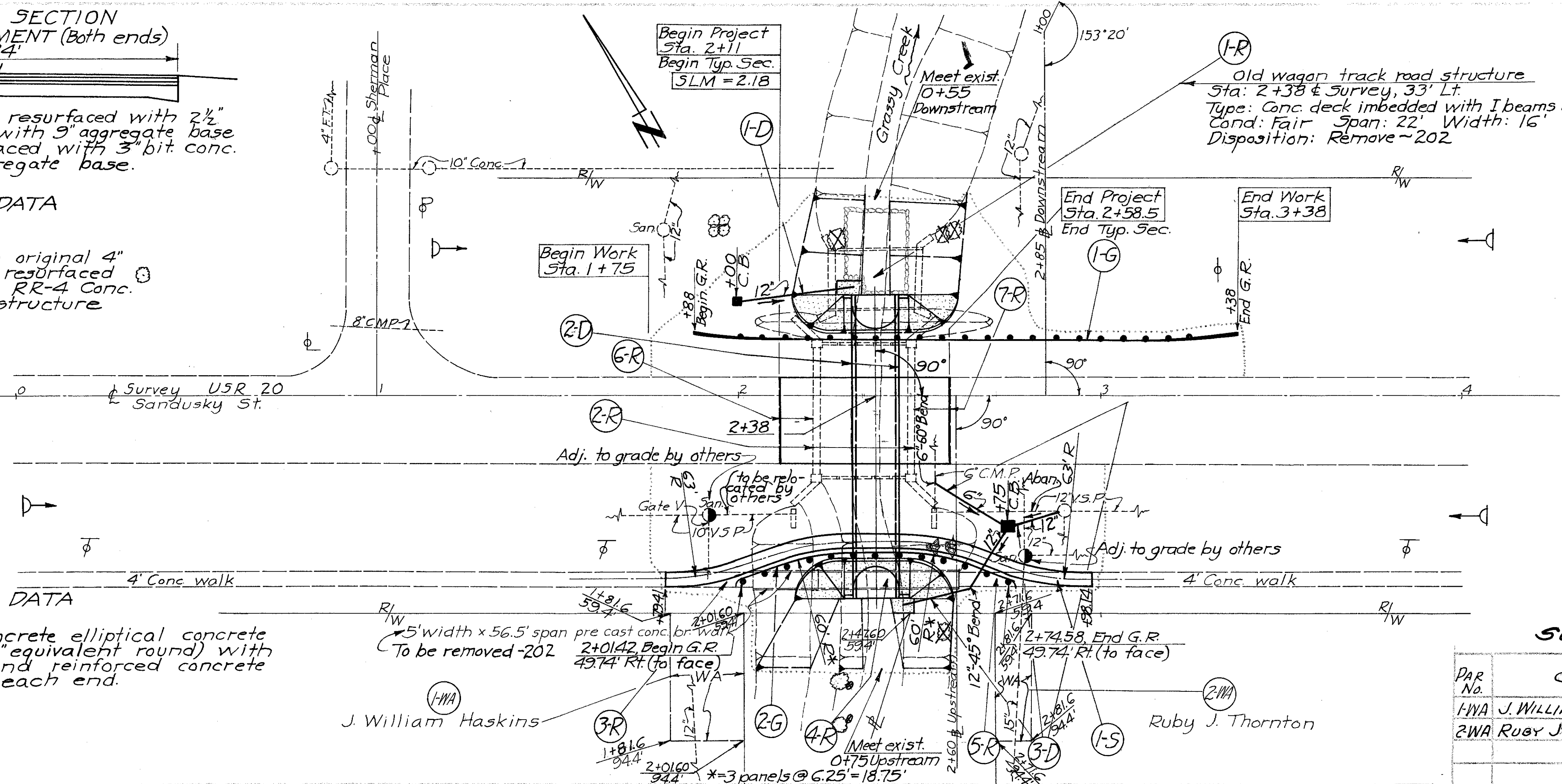

SUMMARY OF ADDITIONAL R/W

PAR No.	OWNER	DEED RECORD		DEED AREA	TOTAL \$ NET PRO	TOTAL \$ NET TAKE	REMARKS
		VOL.	PAGE				
1-WA	J. WILLIAM HASKINS	479	565	47,900±	0	700 S.F.	To Adjust to grade 50'±
2-WA	RUBY J. THORNTON	437	439	30,000±	0	350 S.F.	To Adjust and Grade 50'±

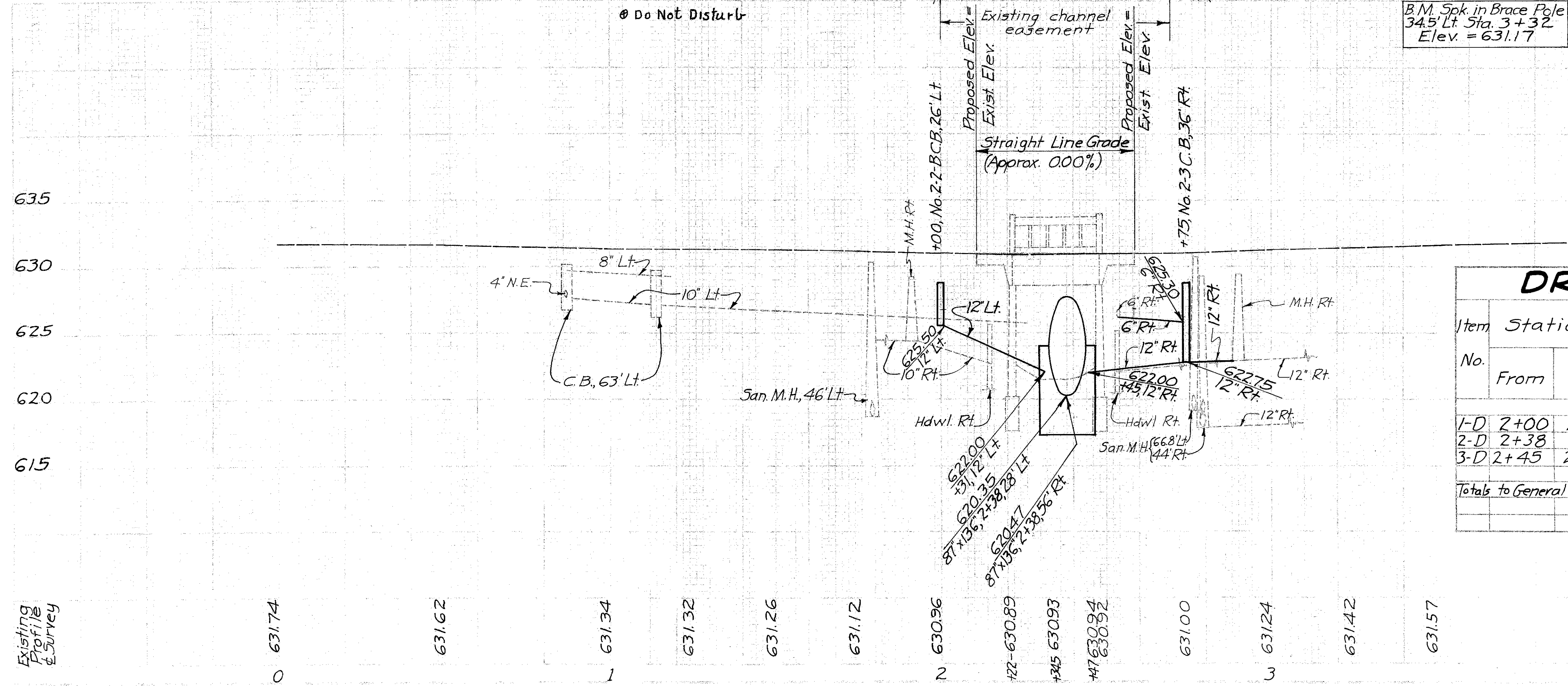

DRAINAGE SUMMARY 'D'

Item No.	Station	603 - Conduit				604 Catch Basins
		6" Rock Masonry Side Reinf. Conc. Riprapion	602 Class 87"x136" Conc. Ellip.	Type A	Type C	
1-D	2+00	2+31	Lt 356			
2-D	2+38	Rt 8393	38 954	84		
3-D	2+45	2+90	Rt 289		44 22 12	
Totals to General Summary			9038	38 954	84 44 22 44	1 1