

O.D.O.T. DISTRICT 2 SURVEY OFFICE (USE ONLY)

PERSONNEL

REFERENCE NO. 28 A

SHEET 35 OF 46

NOTES RHOADES

DATE 4/20/22

ROUTE US 23

H.C. O'DONNELL

WEATHER SUNNY

COUNTY WOOD

R.C. KETNER

TEMP. 38°

TOWNSHIP MONTGOMERY

AUBLE

DWG BY RHOADES PID 102922

SECTION 24

T 4 N R 12 E

TYPE MONUMENT MAG NAIL

ON SURFACE - ~~BELOW~~ ON

OFFSET ☉ PAVEMENT ON LT : RT

11.8 TO RT EDGE PAVEMENT

STATION: 452+74.47

HORZ.DATUM: NAD83(2011)

GEOID: NAVD88 2018

GRID: NORTHING: 592986.864

EASTING: 1716040.019

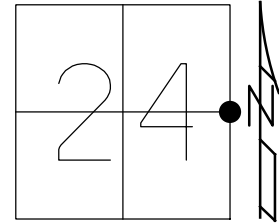

RECORD:  
FD MAG NAIL  
REFA28  
3/24/20, JFO  
SET MAG/WASHER  
9/23/22, DSA

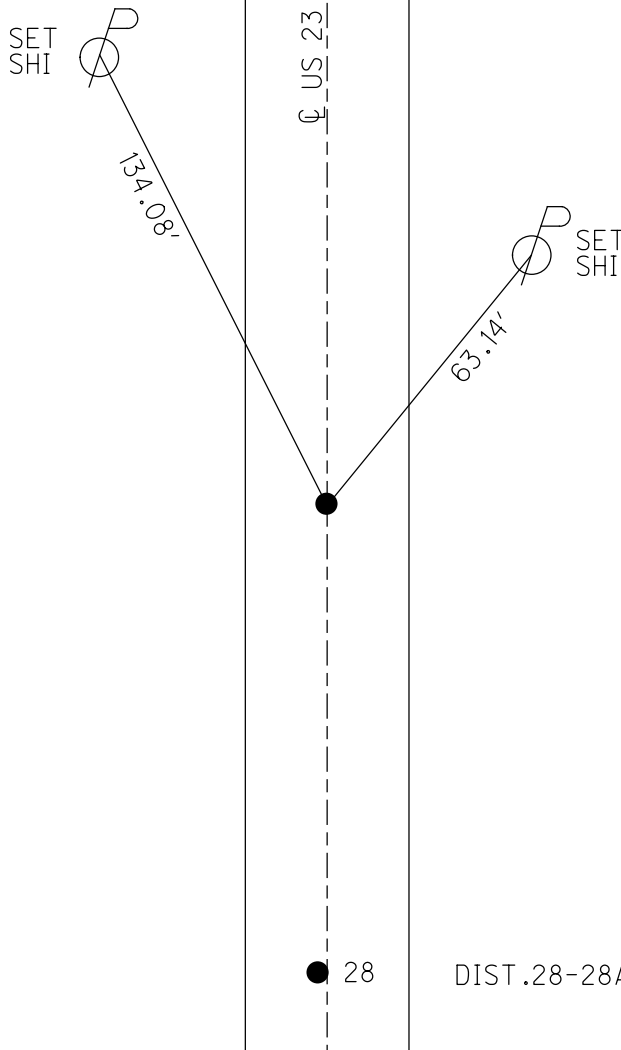

DIST .28-28A= 116.57'

O.D.O.T. DISTRICT 2 SURVEY OFFICE (USE ONLY)

PERSONNEL

REFERENCE NO. 28 A

SHEET 35 OF 46

NOTES RHOADES

DATE 4/20/22

ROUTE US 23

H.C. O'DONNELL

WEATHER SUNNY

COUNTY WOOD

R.C. KETNER

TEMP. 38°

TOWNSHIP MONTGOMERY

AUBLE

SECTION 24

DWG BY RHOADES PID 102922

T 4 N R 12 E

TYPE MONUMENT MAG NAIL

ON SURFACE - ~~BELOW~~ ON

OFFSET 0 PAVEMENT ON LT : RT

11.8 TO RT EDGE PAVEMENT

STATION: 452+74.47

HORIZ.DATUM: NAD83(2011)

GEOID: NAVD88 2018

GRID: NORTHING: 592986.864

EASTING: 1716040.019

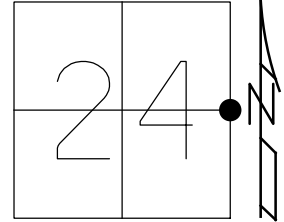

RECORD:  
FD MAG NAIL  
REFA28  
3/24/20, JFO  
SET MAG/WASHER  
9/23/22, DSA

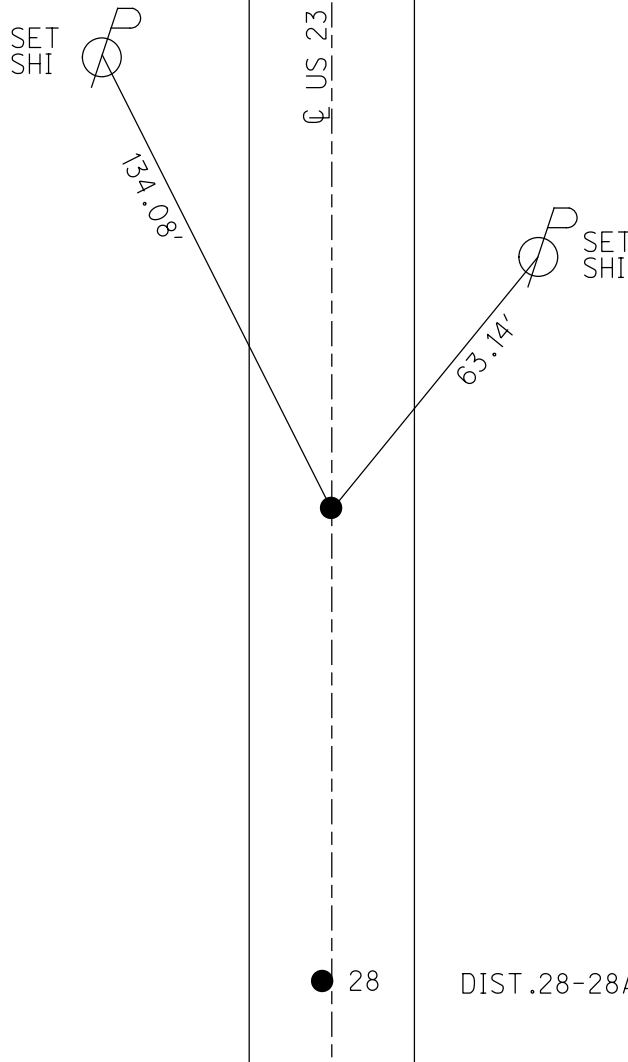

DIST.28-28A= 116.57'