

O.D.O.T. DISTRICT 2 SURVEY OFFICE (USE ONLY)

PERSONNEL \_\_\_\_\_ REFERENCE NO. 5 A SHEET 14 OF 36  
 NOTES HUSS DATE 4/12/01 ROUTE SR 25  
 H.C. ROUSOS WEATHER CLOUDY/WINDY COUNTY WOOD  
 R.C. VAN DUSEN TEMP. 72° TOWNSHIP LIBERTY  
 SECTION 25  
 DWG BY MILLER PID NO PID T 4 N R 10 E

TYPE MONUMENT \_\_\_\_\_ CNPT \_\_\_\_\_  
 ON SURFACE - ~~BELOW~~ ON \_\_\_\_\_  
 OFFSET  $\phi$  PAVEMENT \_\_\_\_\_ LT : ~~RT~~  
 ON TO LT EDGE PAVEMENT \_\_\_\_\_  
 STATION: 160+80

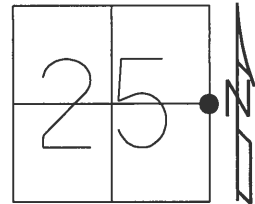

HORZ. DATUM: NAD83(2011) GEOID: NAVD88 2012A  
 GRID: NORTHING: 588294.444 EASTING: 1652370.927

RECORD:  
 ORIGIN UNKNOWN  
 FD P.K. NAIL  
 4/12/01, TMR  
 SET P.K./WASHER  
 10-31-01, SAH  
 D.N.F. POINT  
 FD HOLE  
 REFA5  
 5-30-18  
 10-1-18, JFO

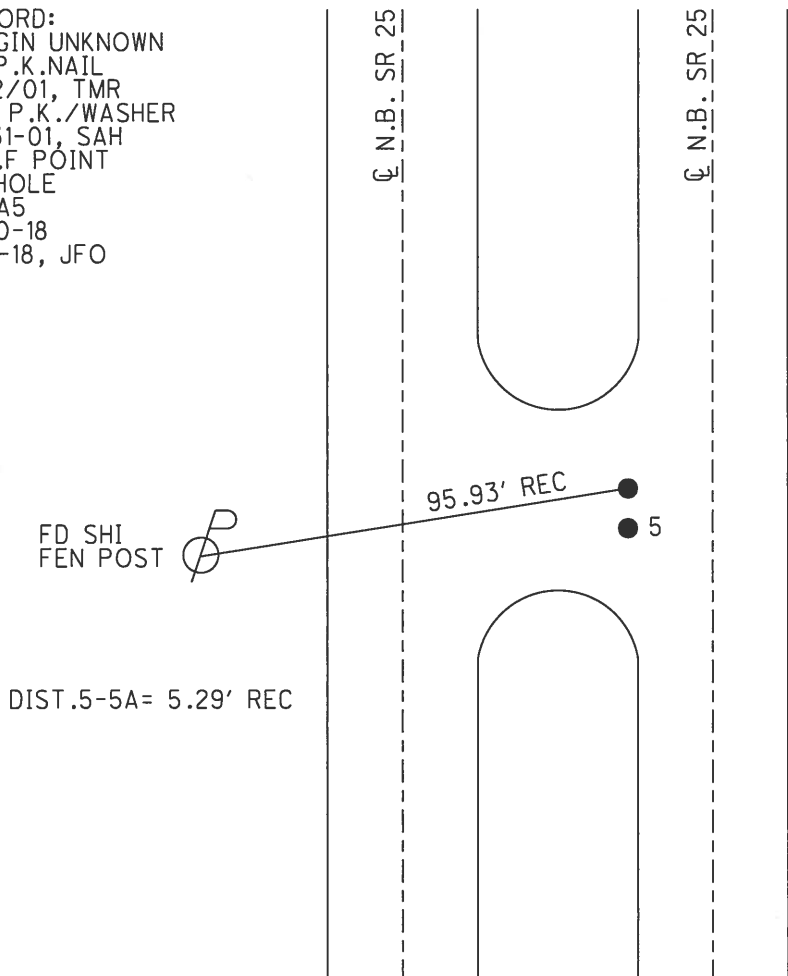

# O.D.O.T. DISTRICT 2 SURVEY OFFICE

PERSONNEL \_\_\_\_\_

REFERENCE NO. 5

SHEET 8 OF 23

NOTES Huss

H.C. Rousos

R.C. VanDusen

DATE 4-12-01

WEATHER Pt Cldy. Windy

TEMP. +72°F

ROUTE SR-25

COUNTY Wood

TOWNSHIP Liberty

SECTION 25

T 4 N R 10 E

TYPE MONUMENT (A) PK/W (B) PK

ON SURFACE - ~~BELOW~~ Surface

LEFT - & PAV'T - RIGHT On Lt. EOP

TO Lt. EDGE PAVEMENT

S.L.M. (A) 160+75 (B) 160+25

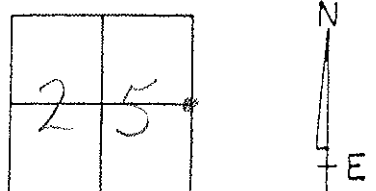

Record:  
Point (A) - Brass Mon.  
Sta 403+07.8  
Point (B) Origin  
Unknown

Set PK/W  
Both Points  
10-31-01  
SAH

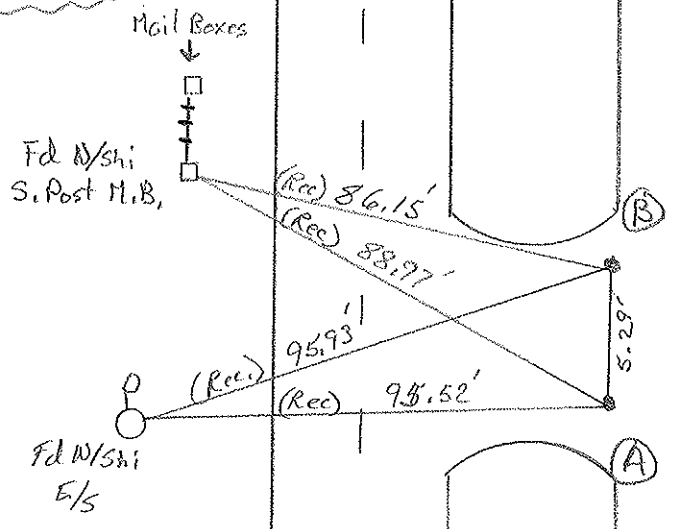

W Post. SR-25  
S.B.

E Post. SR-25  
N.B.

# O.D.O.T. DISTRICT 2 SURVEY OFFICE

PERSONNEL

REFERENCE NO. 5

SHEET 8 OF 23

NOTES HOFFMAN

H.C. LOENRKE

R.C. BARNISEL

DATE 3-22-91

WEATHER CLOUDY

TEMP. 55°

ROUTE SR 25

COUNTY WOOD

TOWNSHIP LIBERTY

SECTION 25

T 4 N R 10 E

TYPE MONUMENT P.K. WASHER & P.K. (ORIGINAL UNKNOWN)

ON SURFACE - BELOW YES

LEFT - & PAV'T. - RIGHT

ON TO LT. EDGE PAVEMENT

S.L.M. 160+75 - PT "A"

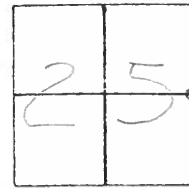

Set P.K. & Washer  
6-5-91  
MB

RECORD: POINT "A"  
BRASS MONUMENT  
Sta 403+07.8

