

O.D.O.T. DISTRICT 2 SURVEY OFFICE

PERSONNEL

REFERENCE NO. 11 H

SHEET 25 OF 32

NOTES WESTFALL

DATE 06-04-13

ROUTE S.R. 64

H.C. ROUSOS

WEATHER CLEAR

COUNTY WOOD

R.C. RHOADES

TEMP. 63° F

TOWNSHIP MIDDLETON

SECTION 27

T 6 N R 10 E

TYPE MONUMENT _____ PK _____

~~ON SURFACE~~ - BELOW 0.1'

LEFT - ~~C PAV'T~~ - RIGHT 3.0'

6.4' TO LT. EDGE PAVEMENT

S.L.M. 419+91

Grid: Northing: 650,080.210 Easting: 1,640,268.948

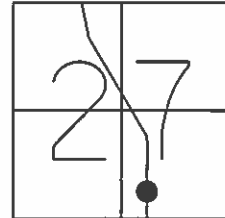

RECORD

PI 53+96.5

$\Delta = 01^\circ - 56' \text{ RT.}$

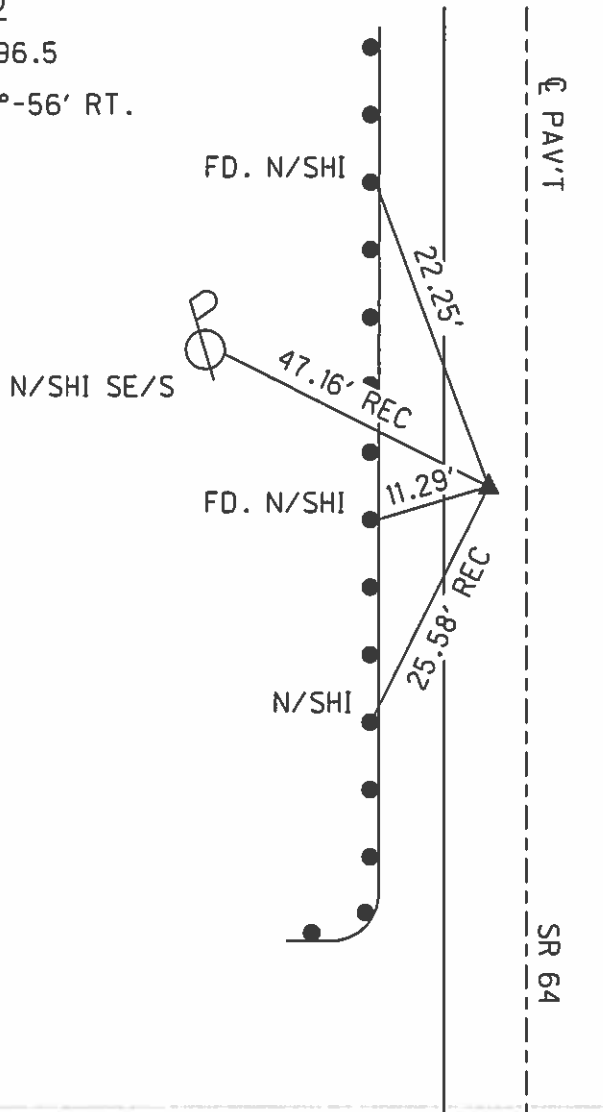

RECORD

06-08-88 SWH
SET SM. RRSPK

08-25-97 BVD
FD. SM. RRSPK

12-01-97 SAH
SET PK/W

06-29-02 KPM
FD. PK/W

04-23-12 SAH
FD. SHANK

09-25-13 EBW
SET MAG/W

PREVENTIVE MAINTENANCE
MICROSURFACED 2002
EXISTING POINT UNCOVERED
DATE 12-09-02

O.D.O.T. DISTRICT 2 SURVEY OFFICE

PERSONNEL

REFERENCE NO. 11-H

SHEET 21 OF 27

NOTES Moser

H.C. Van Duern

R.C. Moser

DATE 8-25-97

WEATHER Pt Cldy

TEMP. +75°F

ROUTE SR-64

COUNTY Wood

TOWNSHIP Middleton

SECTION 27

T 6 N R 10 E

TYPE MONUMENT Small RR Spike

~~ON SURFACE~~ BELOW Yes

LEFT-CL PAV'T. - RIGHT 3.0' Lt.

6.4 TO Lt. EDGE PAVEMENT

S.L.#K. 12+813.5 419+91

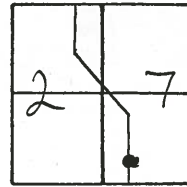

Record
PI - 53+96.5
 $\Delta = 1^\circ - 56' \text{ Rt.}$

Set Small RR Sph.
6-8-88
SWH

Set PK/W
12-01-97
KPM

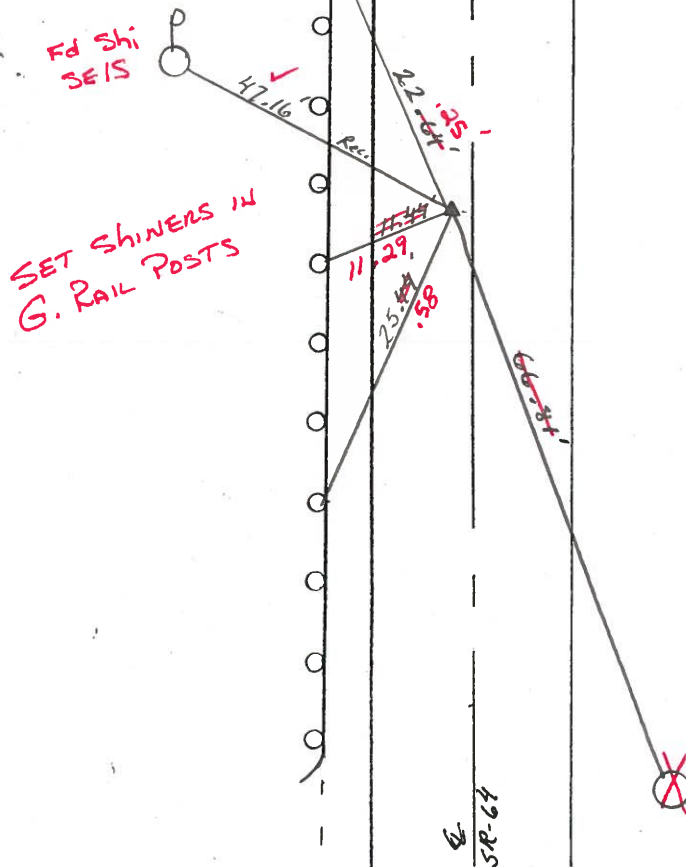

SET SHINERS IN
G. RAIL POSTS

Fd PK Shank
6-29-02
KML

Preventive Maintenance
Microsurfaced 2002
Existing Point Uncovered
Date 12-09-02

~~Fd N/shi~~
~~1x Stub Pole~~
~~w. Water Meter~~

O.D.O.T. DISTRICT 2 SURVEY OFFICE

PERSONNEL _____

REFERENCE NO. 11-H

SHEET _____ OF _____

NOTES Hoffman

H.C. LOSHRICE

DATE 4-20-88

ROUTE SR 64

R.C. BARNHISEL

WEATHER windy - Cloudy

COUNTY WOOD

REED

TEMP. 53°

TOWNSHIP MIDDLETON

SECTION 27

T6 NR 10 E

TYPE MONUMENT RR SPIKE

Set small
RR SPIKE
6-8-88 SWM

ON SURFACE - BELOW YES

LEFT - PAV'T. - RIGHT 2.4

6.8 TO LT EDGE PAVEMENT

S.L.M. 419 + 91

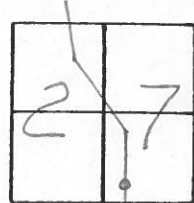

Records:
P.I. 53+96.5
 $\Delta = 1^\circ - 56' RT.$

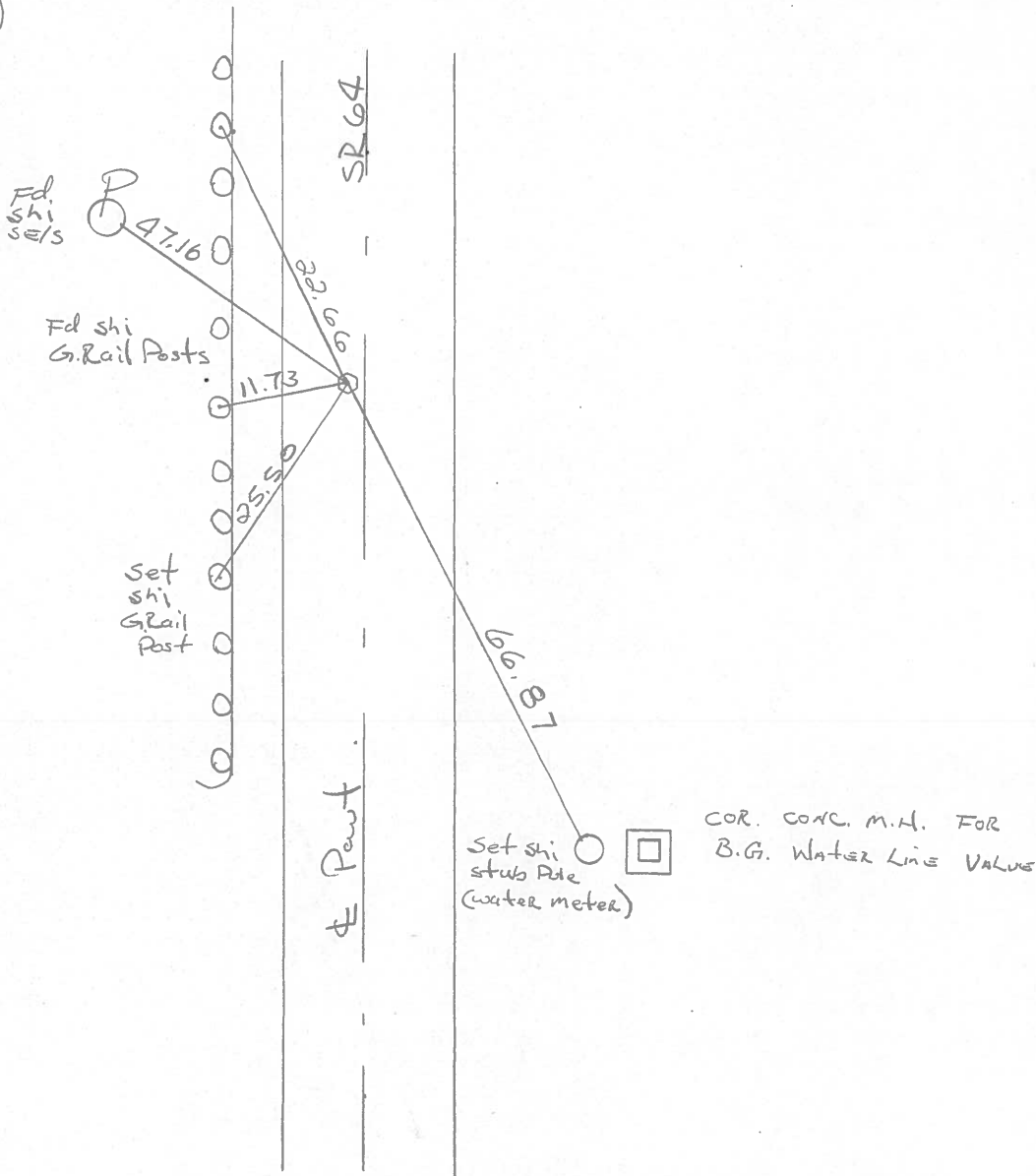

County WOOD S.R. 64

Date 7-11-79

Township MIDDLETON

Weather MOSTLY CLOUDY

Section 27

Temp. +75°

T6N, R10E

Personnel BURNSIDE
KNAPE
MEAD

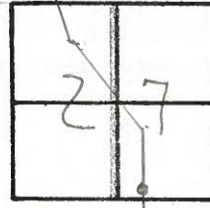

#

11-H

P.I. STA. 53+96.5
 $\Delta = 1^{\circ} 56' RT.$
P.K. NAIL FD. - 6-1671

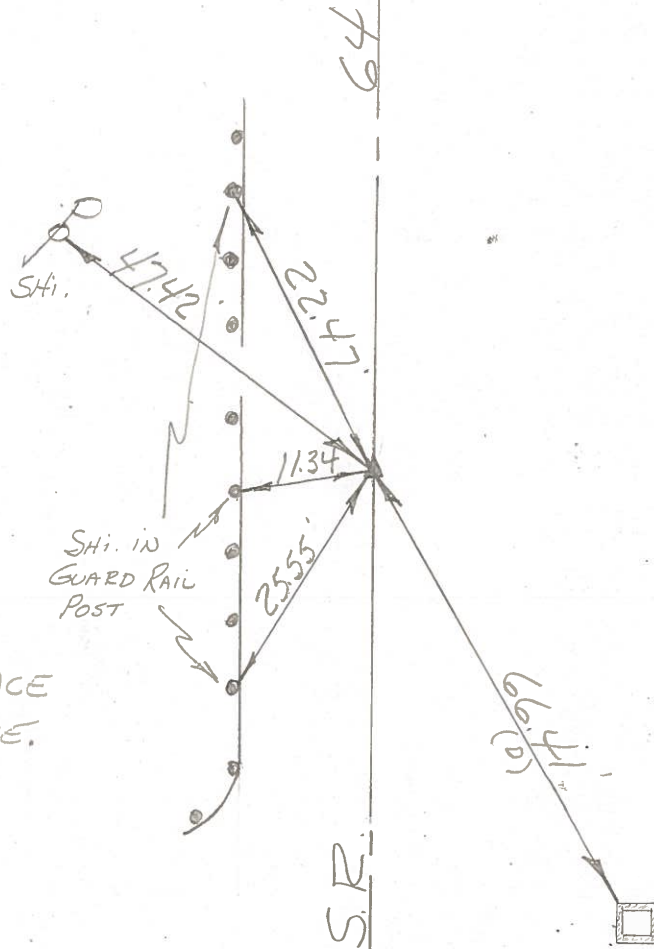

FD. R.R. SPK @ SURFACE
& 2 1/2' LT. OF CTR. PAVE.

COR. CONC. M.H.
FOR B.G. WATER
LINE VALVE

PERSONNEL	TITLE	PERSONNEL	TITLE
		COUNTY	<u>WOOD</u>
		DATE	<u>6-16-71</u>
		S. R.	<u>64</u>
		WEATHER	<u>CLEAR</u>
		SEC.	
		TEMP.	<u>+85°</u>

