

O.D.O.T. DISTRICT 2 SURVEY OFFICE (USE ONLY)

PERSONNEL _____ REFERENCE NO. 13 C SHEET 25 OF 28
 NOTES RHOADES _____ DATE 5/31/17 ROUTE SR 105
 H.C. O'DONNELL _____ WEATHER WINDY COUNTY WOOD
 R.C. RHOADES _____ TEMP. 65° TOWNSHIP WEBSTER
 _____ SECTION 14
 _____ T 5 N R 11 E

TYPE MONUMENT 3/4" MAG/WASHER
 ON SURFACE - ~~BELOW~~ ON
 LEFT - ☐ PAV'T - ~~RIGHT~~ 2.3'
9.45' TO LT EDGE PAVEMENT
 S.L.M. 157+36.31
 GRID: NORTHING: 628020.125 EASTING: 1674589.487

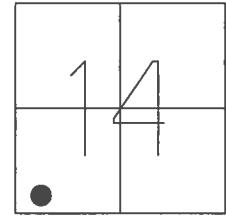

RECORD:
 FD MAG/WASHER
 FINRE17
 7/25/12, SDC
 FD MAG NAIL
 REFC13
 6/3/16, JFO
 SET 1" MAG/WASHER
 5/31/17, JFO

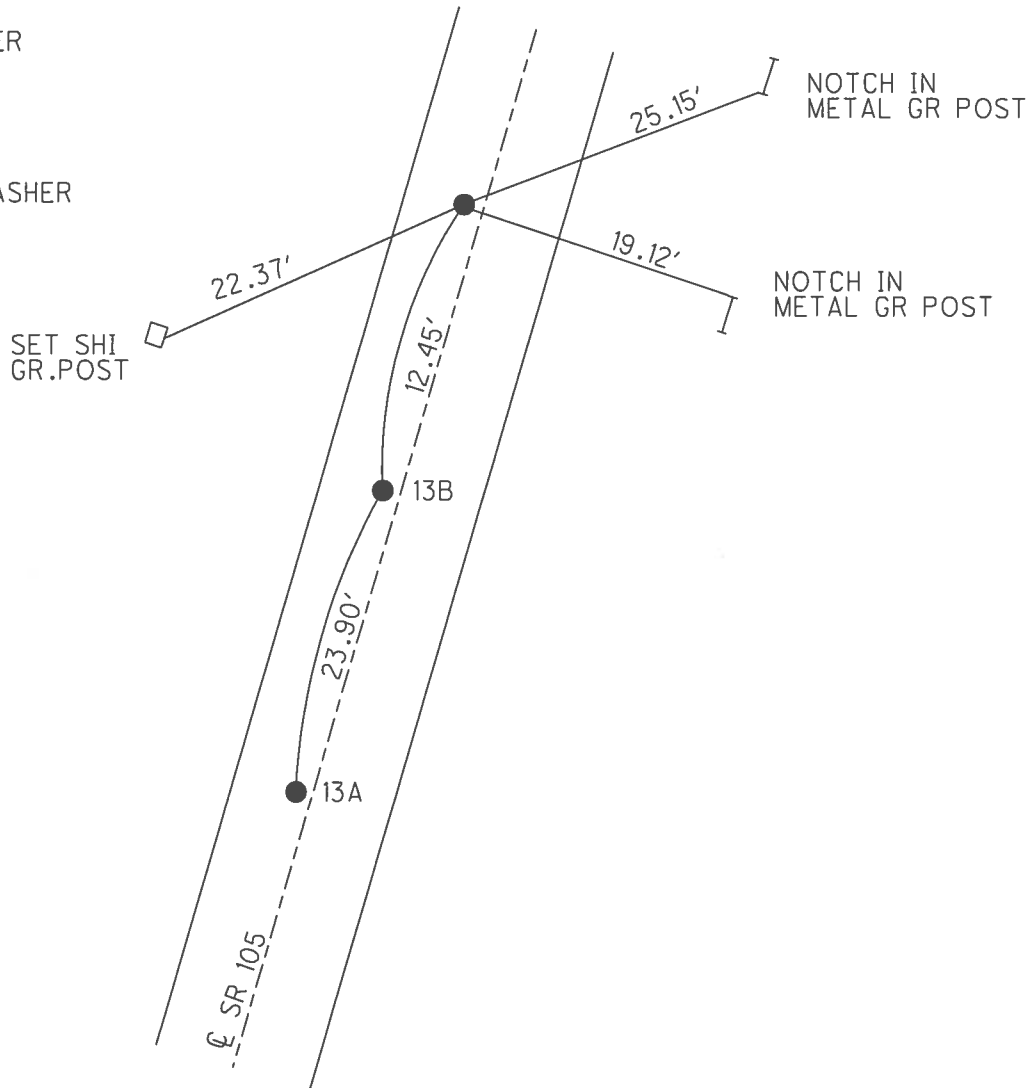

O.D.O.T. DISTRICT 2 SURVEY OFFICE (USE ONLY)

PERSONNEL	REFERENCE NO.	<u>13 C</u>	SHEET	<u>4</u>	OF	<u>7</u>
NOTES	CODER	DATE	<u>7/25/12</u>	ROUTE	<u>SR 105</u>	
H.C.	<u>RHOADES</u>	WEATHER	<u>CLEAR</u>	COUNTY	<u>WOOD</u>	
R.C.	<u>COUTCHER</u>	TEMP.	<u>80°</u>	TOWNSHIP	<u>WEBSTER</u>	
				SECTION	<u>14</u>	
				T	<u>5</u>	N
				R	<u>11</u>	E

TYPE MONUMENT MAG NAIL
 ON SURFACE - ~~BELOW~~ ON
 LEFT - ☉ PAV'T - ~~RIGHT~~ 2.3'
9.45' TO LT EDGE PAVEMENT
 S.L.M. 157+36.31

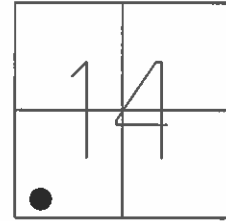

GRID: NORTHING: 628020.155 EASTING: 1674589.390

GPS, FINRE17
 SDC, 7-25-12

