

O.D.O.T. DISTRICT 2 SURVEY OFFICE (USE ONLY)

PERSONNEL	REFERENCE NO. <u>56 A</u>	SHEET <u>11</u> OF <u>33</u>
NOTES <u>HOMAN</u>	DATE <u>6/11/13</u>	ROUTE <u>SR 105</u>
H.C. <u>HOMAN</u>	WEATHER <u>FAIR</u>	COUNTY <u>WOOD</u>
R.C. <u>CODER</u>	TEMP. <u>65°</u>	TOWNSHIP <u>WEBSTER</u>
		SECTION <u>8</u>
		T <u>5</u> N R <u>12</u> E

TYPE MONUMENT P.K./WASHER
 ON SURFACE - ~~BELOW~~ ON
 LEFT - ☉ PAV'T - RIGHT ON
- TO - EDGE PAVEMENT
 S.L.M. 340+70

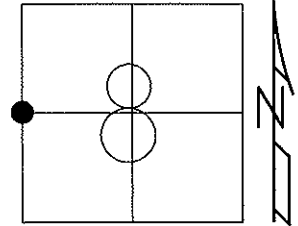

Grid: Northing: 635037.754 Easting: 1690801.309

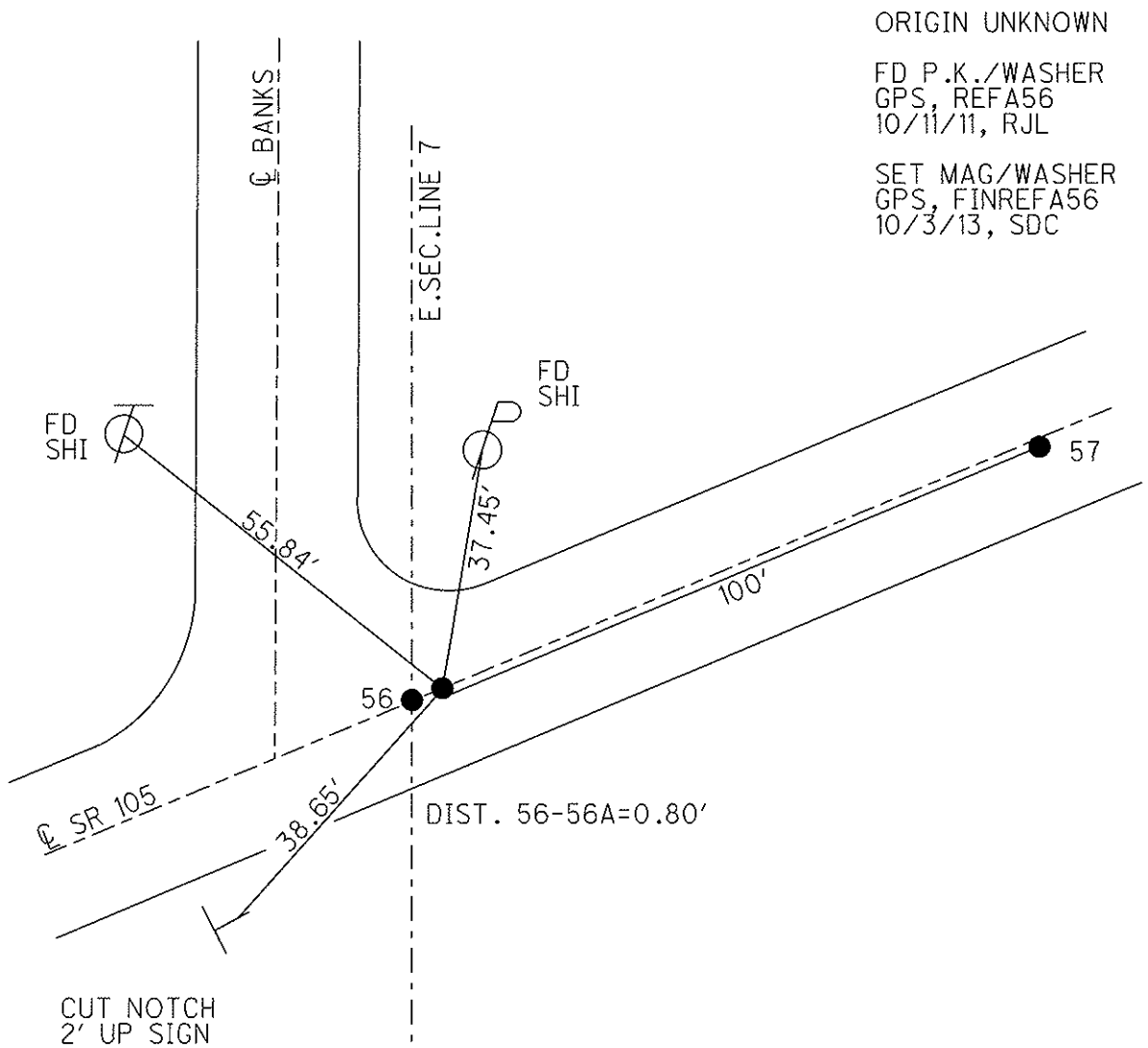

County WOOD S.R. 105

Township WEBSTER

Section 7

T5N, R12E

Personnel AFFMAN

House _____ RC

BARNEY _____ HC

LOEHRKE _____ □

Date 7-10-84

Weather CLEAR HUMID

Temp. + 92

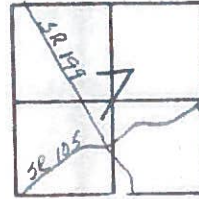

56

RECORDED
P.I. # 49

340+69.50

Δ = 30-17'-00" Lt.

Fd. PK @ SURFACE 27' E of E PAUL BANKS Rd
9.8 to REP

SLM 339+33

ON W. LINE SEC. 8

"B" Boat Spoke @ SURFACE

9.8 to REP

SLM 339+34

"B" to P.I. 0.80'

SET PK

9-27-84

A=56

B=56A

