

O.D.O.T. DISTRICT 2 SURVEY OFFICE (USE ONLY)

PERSONNEL \_\_\_\_\_

REFERENCE NO. 58

SHEET 14 OF 33

NOTES CHANEY

DATE 8/1/94

ROUTE SR 105

H.C. RIPPLE

WEATHER FAIR

COUNTY WOOD

R.C. BARBOUR

TEMP. 80°

TOWNSHIP WEBSTER

DWG BY RHOADES PID \_\_\_\_\_

SECTION 8

T 5 N R 12 E

TYPE MONUMENT STAKE

ON SURFACE - ~~BELOW~~ ON

OFFSET  $\oslash$  PAVEMENT - LT : ~~RT~~

143.5' TO LT EDGE PAVEMENT

STATION: 354+87.01

HORZ.DATUM: \_\_\_\_\_ GEOID: \_\_\_\_\_

GRID: NORTHING: \_\_\_\_\_ EASTING: \_\_\_\_\_

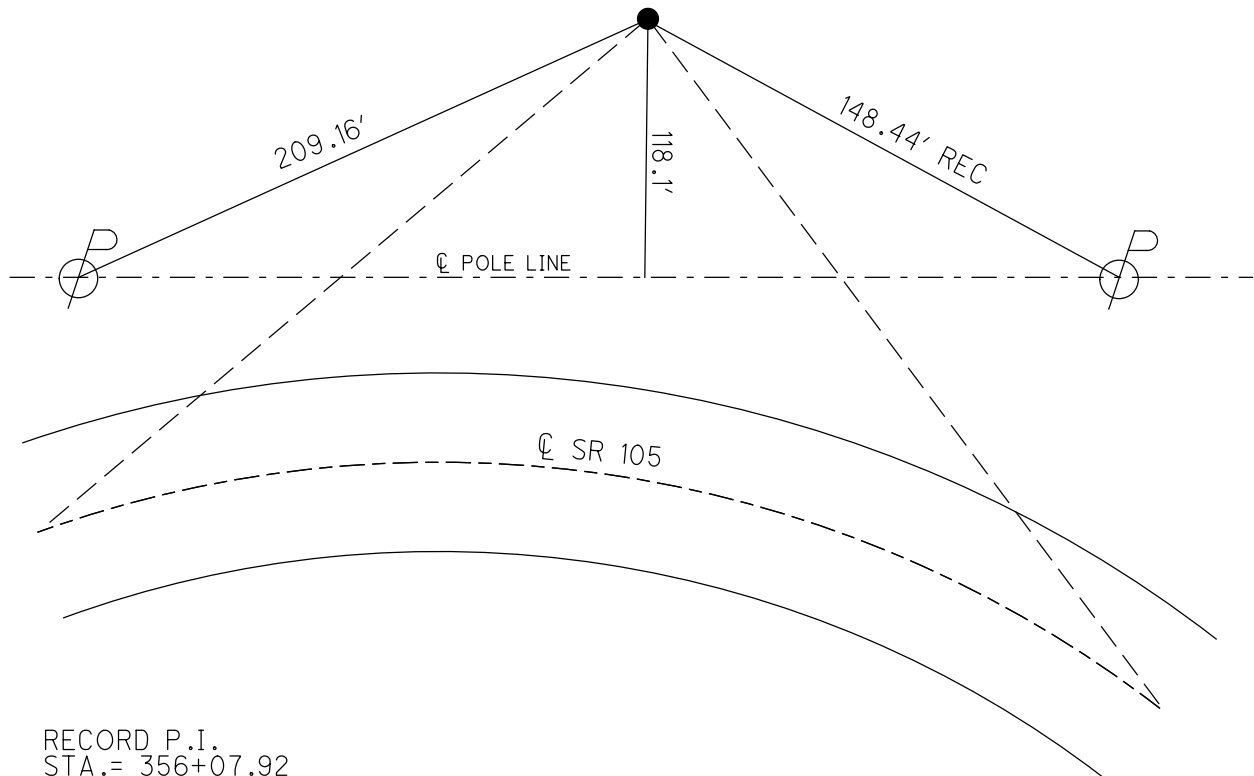
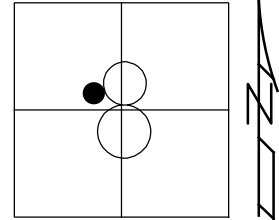

RECORD P.I.  
 STA.= 356+07.92  
 DNF POINT, HOWEVER  
 RECORD TIES DID CROSS  
 WHEN PULLED. SET STAKE,  
 143.5' S. TO N. EP. 8/1/94  
 D.N.F.  
 10/20/11, RJL

O.D.O.T. DISTRICT 2 SURVEY OFFICE (USE ONLY)

PERSONNEL \_\_\_\_\_

REFERENCE NO. 58

SHEET 14 OF 33

NOTES CHANEY

DATE 8/1/94

ROUTE SR 105

H.C. RIPPLE

WEATHER FAIR

COUNTY WOOD

R.C. BARBOUR

TEMP. 80°

TOWNSHIP WEBSTER

SECTION 8

T 5 N R 12 E

TYPE MONUMENT STAKE

ON SURFACE - BELOW ON

LEFT - Q PAV'T - ~~RIGHT~~

143.5' TO LT EDGE PAVEMENT

S.L.M. 356+07.92

Grid: Northing: \_\_\_\_\_ Easting: \_\_\_\_\_

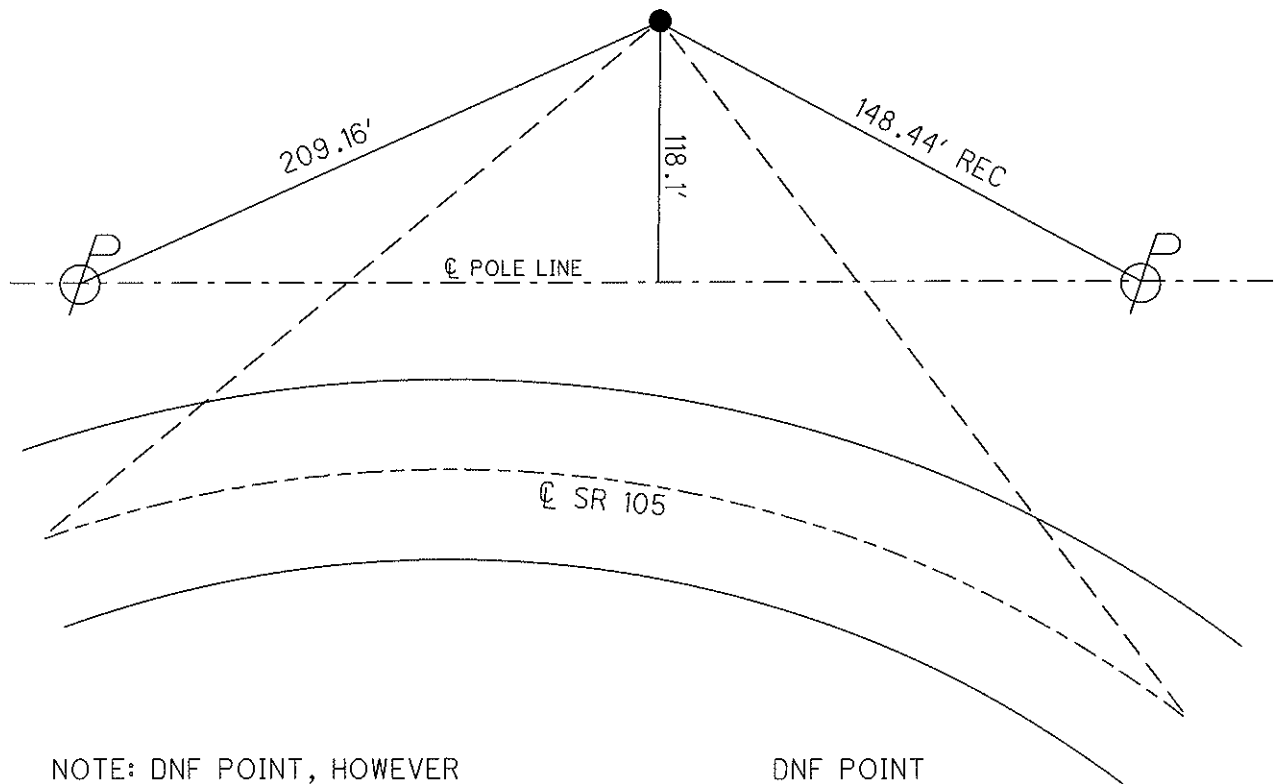
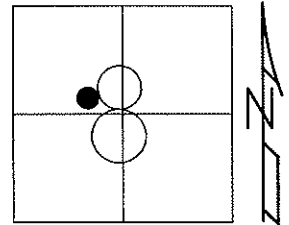

NOTE: DNF POINT, HOWEVER  
RECORD TIES DID CROSS  
WHEN PULLED. SET STAKE,  
143.5' S. TO N. EP. 8/1/94

DNF POINT  
10/20/11, RJL

NOTE: ALL DISTANCES  
ARE FROM 8/1/94

RECORD P.I. #51  
STA.= 356+07.92

# O.D.O.T. DISTRICT 2 SURVEY OFFICE

PERSONNEL \_\_\_\_\_

REFERENCE NO. 58

SHEET 8 OF 49

NOTES CHANEY

H.C. RIPPLE

R.C. BARBOUR

DATE 8-1-94

WEATHER FAIR

TEMP. +80°

ROUTE S.R. 105

COUNTY WOOD

TOWNSHIP WEBSTER

SECTION 8

T \_\_\_\_\_ R \_\_\_\_\_

TYPE MONUMENT STAKE

ON SURFACE - ~~BELOW~~ YES

LEFT-~~C~~ PAV'T. - ~~RIGHT~~ Yes

143.5' TO LT EDGE PAVEMENT

S.L.M. 356 + 07.92

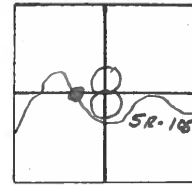

NOTE: DID NOT FIND POINT; HOWEVER, RECORD TIES DID CROSS WHEN PULLED.

Record P.I. #51, STA 356+07.92

SET STAKE (PULLED)  
143.5' S. TO N. EDGE PAVT.

POLE LINE

148.44' (Rec.)

118.1'

209.16'

105

S.R.

County WOOD S.R. 105

Date OCT.-16-73

Township WEBSTER

Weather CLOUDY

Section 8

Temp. 52°

T N, R E

Personnel STONE

MICHALAK

CURTIS

DENNO

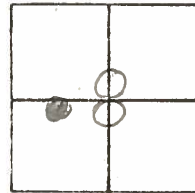

#58

356+07.92

P.I. #51

♀ POLE LINE

148.44'

118.1'

209.16'

105

S.R.

SET STAKE (PULLED)  
143.5' S. TO N. EDGE PVT.

